

PREPARED BY  
HIGHWAY PLANNING SURVEY  
IN COOPERATION WITH  
U.S. PUBLIC ROADS ADMINISTRATION

STATE OF MINNESOTA  
DEPARTMENT OF HIGHWAYS  
ROAD LIFE STUDIES  
CONSTRUCTION PROJECT LOG RECORD

CONTROL SECTION 8504  
TRUNK HIGHWAY 61  
COUNTY Winona  
DISTRICT 6A

LIMITS: S.Co.Line- Jct.T.H.43inWinona

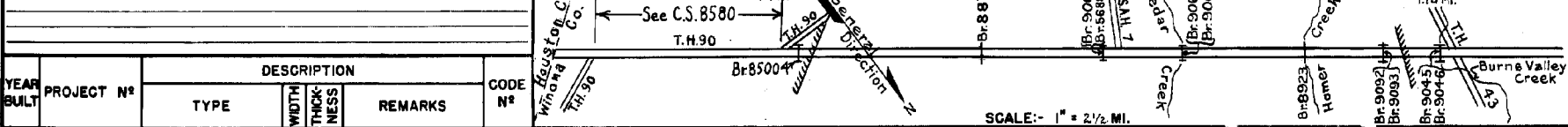

YEAR BUILT	PROJECT N <sup>o</sup>	DESCRIPTION			CODE N <sup>o</sup>
		TYPE	WIDTH	THICKNESS	
		Concrete	8' 7"		No Record of Constr.
		Gravel	8'	1"	No Record of Constr.
		Br. ?	20'		60' Wood Pile.
		Brick	16'		No Record of Constr.
		Br. 4161	24'		60' B.S.
		Grading	32'		
1924	61-3-34A&B	Br. 3941, 3942, 3944, 3938 & 3939	27'		30' B.S., 30' B.S., 40' T.P.G., 30' B.S. & 50' T.P.G.
1925	61-3-34A&B	Gravel	24'	1 1/4"	600 C.Y./Mile. Maint. Dept.
1926	61-3-48-1	Grading	32'		
		Br. 4462	27'		75' L.T.
1926	61-3-48-1	Concrete	18'	8-7-8	
		Grading	32'		
1927	61-3-48-2A&B	Gravel	28'	1 1/2"	600 C.Y./Mile.
		6-Bridges (2)	27'		
1927	61-3-34A&B	Concrete	18'	9-7-9	
1929	61-3-48-2A&B	Concrete	20'	9-7-9	
		Grading	40'		
1929	61-3-35-3	Concrete	20'	9-7-9	
		Br. 4844	30'		60' B.S.
		Grading			
1936	61-3-48-1A	Concrete	20'		
		61-3-35-3D			
1937	61-3-34	Br. 5688	27'		90' B.S.
		61-3-48-2A	27'		84' B.S.
1937	(3)	Misc. Grading			
		Shoulder Widened	36'		Maint. Dept.

YEARS FROM	TO	TOTAL MILES	UNINCORPORATED		INCORPORATED		RURAL		URBAN	
			RDWY. MI.	BR. MI.	RDWY. MI.	BR. MI.	RDWY. MI.	BR. MI.	RDWY. MI.	BR. MI.
1924	1925	22.62	2.13	0.03	2.6	0.02	2.13	0.03	2.6	0.02
1926	1926	22.62	2.13	0.03	2.5	0.03	2.13	0.03	2.5	0.03
1927	1928	22.36	2.10	0.07	2.5	0.03	2.10	0.07	2.5	0.03
1929	1935	22.34	2.10	0.07	2.3	0.03	2.10	0.07	2.3	0.03
1936	1950	22.32	2.100	0.08	2.1	0.03	2.100	0.08	2.1	0.03
1951	1957	22.32	18.18	0.07	3.03	0.04	21.00	0.08	2.1	0.03
1958	1963	22.21	19.15	0.06	2.94	0.04	20.96	0.10	1.13	0.02

REMARKS: Layout is to scale as of 1936

(1) This work not done under this project number but lies within the limits of this project. (2) Br. 4634, 52' C.D.G.; Br. 4635, 110' OT; Br. 4636, 30' C.D.G.; Br. 4637, 50' C.D.G.; Br. 4648, 30' C.D.G. & Br. 4649, 30' C.D.G. (3) Work covered by S.P. 61-3-34, S.P. 61-3-48-2, Maint. Dist. 17, 1936 A.F.E.s. 28 & 30, 1937 A.F.E.s. 21, 22, 28 & 30; 1938 A.F.E.s. 28 & 30. (4) Work covered by S.P. 61-3-34, S.P. 61-3-48-2, Maint. Dist. 17, 1937 A.F.E.s. 21 & 22.

PREPARED BY  
HIGHWAY PLANNING SURVEY  
IN COOPERATION WITH  
U. S. PUBLIC ROADS ADMINISTRATION

STATE OF MINNESOTA  
DEPARTMENT OF HIGHWAYS  
ROAD LIFE STUDIES  
CONSTRUCTION PROJECT LOG RECORD

CONTROL SECTION 8504  
TRUNK HIGHWAY 61  
COUNTY Winona  
DISTRICT 6A

LIMITS: S. Co. Line - Jct. T.H. 43 in Winona

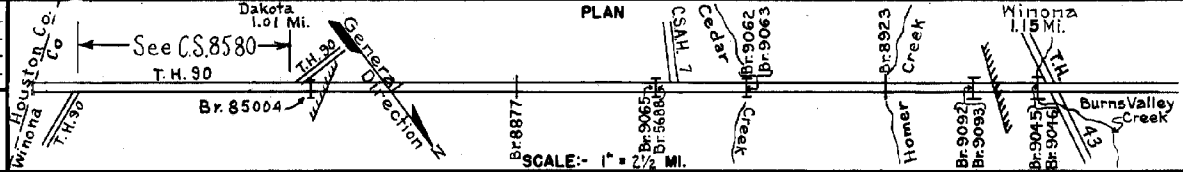

YEAR BUILT	PROJECT N°	DESCRIPTION		REMARKS	CODE N°
		TYPE	WIDTH THICKNESS		
1937	(4)	Grade Lift Concrete	36' 7.0	9-7-9	Maint. Dept.
1938	61-3-48-2	Roadside Develop.			
1939	Dist. 17 1939 A.F.E. 31 1939 A.F.E. 5	Slope & Grade Widening			Maint. Dept.
1939	61-3-35-3B	Roadside Devel.			
1939	8504-02	Roadside Devel.			
1942 1943	A.F.E. 35	Widen Shoulders & Flatten Slopes			Maint. Dept.
1946	A.F.E. 38	Crushed Rock Shoulders		422 C.Y.	
1951	8504-11	Crib Wall			
C 1958	8504-14 8504-19	Grading Crushed Rock Base Mixed Bit.	6.88 6.88 5.2	3'-4 1/2" 12' Granular Mat'l. 1/2"	Divided Highway on 12' Granular Mat'l. Br. 8877 (C1010D) & C1210
C 1958	8504-16 8504-35	Grading Crushed Rock Base Plant Mix Bit.	6.88 6.88 4.8	9' 21' Granular Mat'l. 3"	Divided Highway on 21' Granular Mat'l. Br. 8923 (C128 D)
C 1958	8504-27 8504-25	Br. 9065 Br. 9062 & 9063	30' 29'0"		96 PC (Parallel) to Br. 5688 145' PPG (Parallel)
C 1958	8504-21 8504-20 8503-39	Br. 9092 & 9093 Br. 9045 & 9046 Topsoil & Seeding	29'0" 29'0"		165' B.S. (Parallel) 132' B.S. (Parallel)
1959	8504-37	Concrete	29'4"	8"	
C 1960	8504-38 8504-40	P.C. Concrete Intersection Imp.	224'	8"	

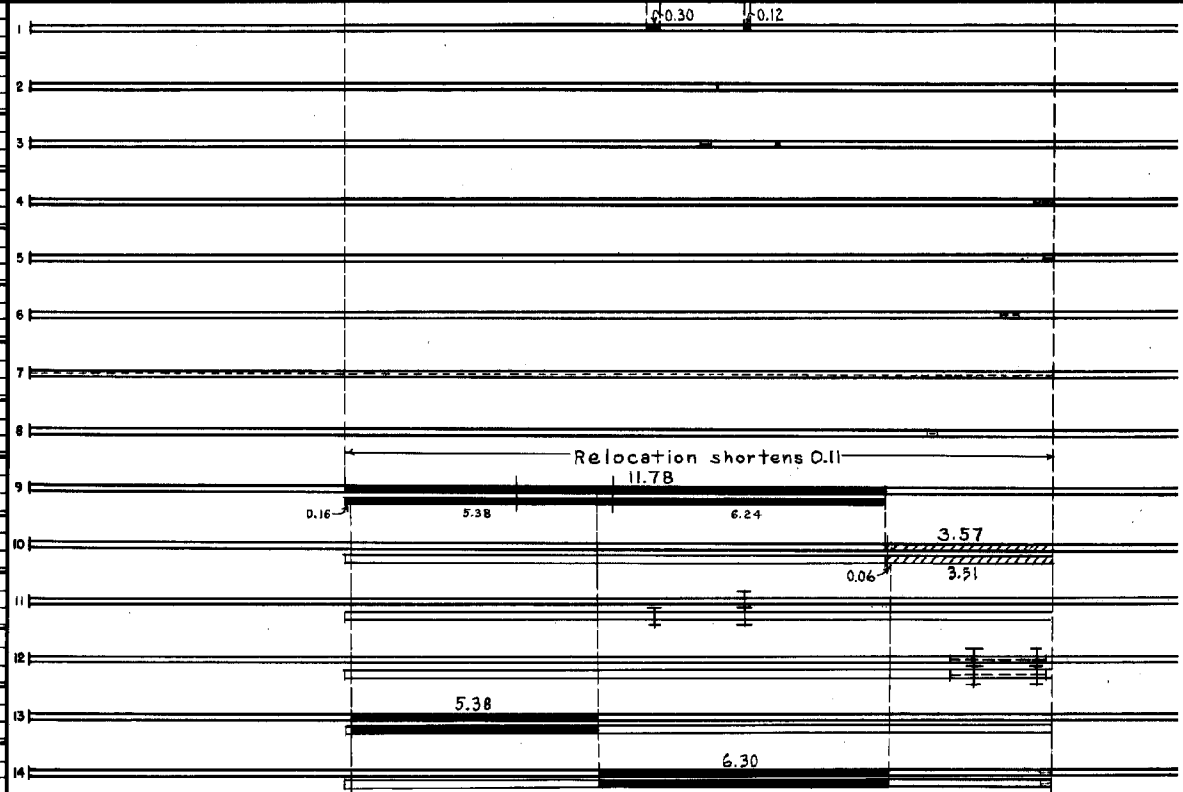

YEARS FROM	TOTAL MILES	UNINCORPORATED		INCORPORATED		RURAL		URBAN	
		RDWY. MI.	BR. MI.	RDWY. MI.	BR. MI.	RDWY. MI.	BR. MI.	RDWY. MI.	BR. MI.
1964	17.57	15.33	0.08	2.75	0.03	16.34	0.08	1.12	0.03

REMARKS: See Sheet N°1

PREPARED BY  
TRAFFIC AND PLANNING DIVISION  
IN COOPERATION WITH  
U.S. DEPARTMENT OF COMMERCE  
BUREAU OF PUBLIC ROADS

STATE OF MINNESOTA  
DEPARTMENT OF HIGHWAYS  
ROAD LIFE STUDIES  
CONSTRUCTION PROJECT LOG RECORD

CONTROL SECTION 8504  
TRUNK HIGHWAY 61  
COUNTY Winona  
DISTRICT 6A

LIMITS: S. Co. Line - Jct. T.H. 43 in Winona  
Ref. Pt. 003+00.258 - 004+00.074  
008+00.736 - 025+00.688

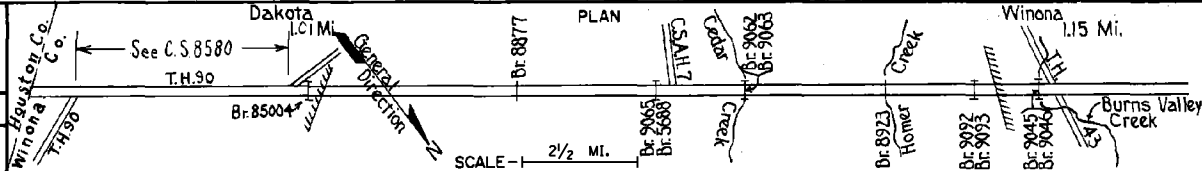

YEAR BUILT	PROJECT NO	DESCRIPTION			REMARKS
		TYPE	WIDTH	THICKNESS	
M 1962		Light Bit. Seal	2'-25"		RS-2, 12658 Gal. Agg. 450 C.Y.
C 1964	8504-12 & 8580-01	Grading Cr. rock base P.C. Concrete	36'-52"	3" 9"	Divided Highway
C 1964	8504-85004 & 8580-01	Grading, Base* P.C. Concrete	48'-52"	3" 9"	195' P.P.G. - U.P. Divided Highway
M 1964	S.F.	Spot Treat Bit. Surf. Repair	24'	3/4"	MC-2, 50 Gal. Agg. 31 Tons
M 1964	S.F.	Light Bit. Seal			RS-1Z, 22361 Gal. FA-1, Agg. 820 C.Y.
M 1966	C	Light Bit. Seal	50'		CRS-1, 12745 Gal. Agg. 462 C.Y.
M 1968	SF	Bit. Seal Coat	11'		Bit Mat'l. 13730 Gal. Agg. 1091 Tons 4 Lanes
M 1971	SF	Joint Seal			
C 1972	8580-92	Grade Base* P.C. Concrete	24'	3" 9"	
M 1975	SF	Shoulder Repair	2'	1/2"	AC 2361 WEAR. 952.4 T. RC 250 Tack 900 Gal
C 1976	-50 -51	Bit. Surf. Shoulders Turn Lane Const.	2@24'	2 3/4"	Bit. CSAH 15 & Jer. TH 43
M 1981	8104-9045	Dr. Deck Restoration			Dr. NR WITH - 61 Br. No's 2082, 2062 2082, 2045
C 1982	8504-55 F003-4(56)	Left Turn Lanes	12'		
M 1989	M3356	Conc. Repair			

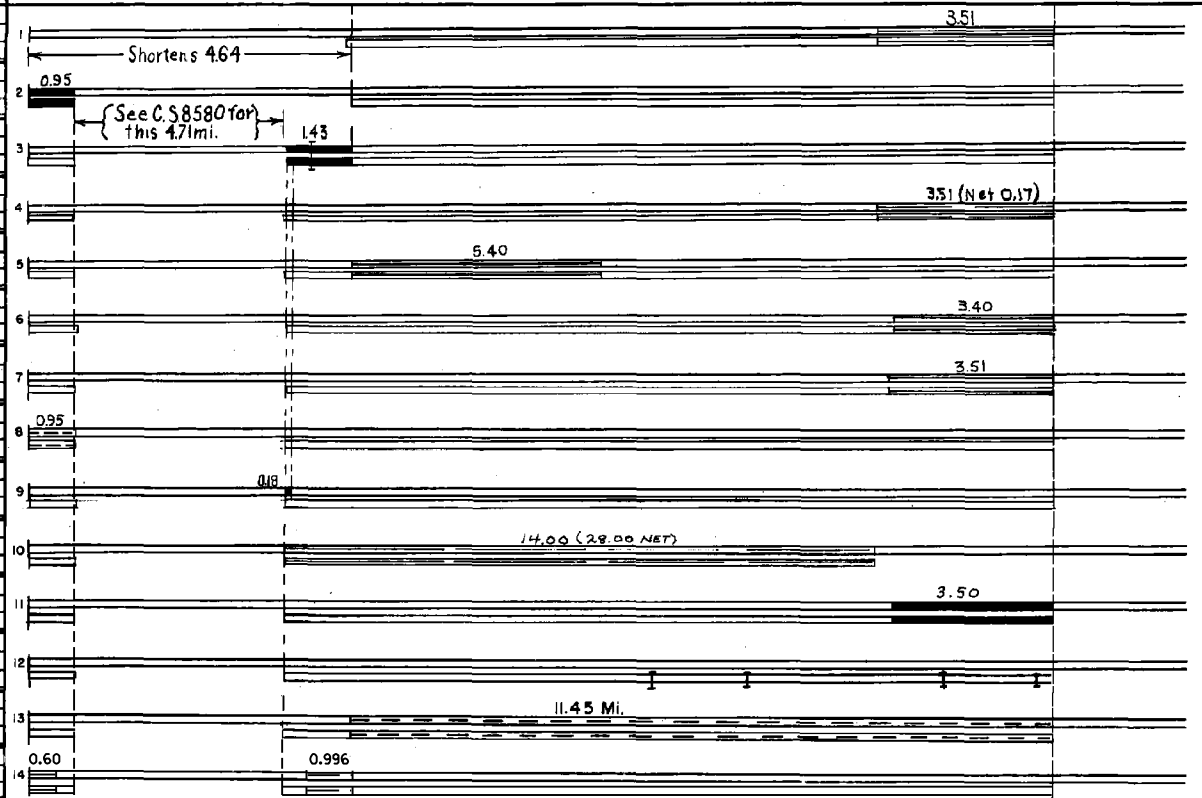

YEARS		TOTAL MILES	UNINCORPORATED		INCORPORATED		RURAL		URBAN	
FROM	TO		RDWY. MI.	BR. MI.	RDWY. MI.	BR. MI.	RDWY. MI.	BR. MI.	RDWY. MI.	BR. MI.

REMARKS: See Sheet No. 1

