

PREPARED BY  
HIGHWAY PLANNING SURVEY  
IN COOPERATION WITH  
U. S. PUBLIC ROADS ADMINISTRATION

STATE OF MINNESOTA  
DEPARTMENT OF HIGHWAYS  
ROAD LIFE STUDIES  
CONSTRUCTION PROJECT LOG RECORD

CONTROL SECTION 8409  
TRUNK HIGHWAY 9  
COUNTY Wilkin  
DISTRICT 4A

LIMITS: Jct. T.H. 210 - N. Co. Line

YEAR BUILT	PROJECT N°	DESCRIPTION			CODE N°
		TYPE	WIDTH	THICK-NESS	
		Gravel	24'	1"	No Record of Constr. Added in 1934. 23' B.S.
		Br 2043	18'		
1925		Gravel	24'	2 1/4"	Co. Job 2504. Added in 1934. 1000 C.Y./Mi. 20' B.S. & 35' B.S.
		Br X-35 & 2862	24'		
1926		Gravel	24'	2 1/2"	Co. Job 2605. Added in 1934. 1200 C.Y./Mi. 22' B.S. 25' B.S. & 36' W.S.
		Br X-38, 1780 & X-40	17'		
1926		Gravel	24'	2 1/2"	Co. Job 2604. Added in 1934. 1200 C.Y./Mi. 50' L.T. & 10' B.S.
		Br 2041 & 2042	17'		
1927		Gravel	24'	2 1/2"	Co. Job 2701. Added in 1934. 1200 C.Y./Mi. 27' B.S.
		Br 1838	23'		
1927		Gravel	24'	2 1/2"	Co. Job 2702. Added in 1934. 1200 C.Y./Mi. 20' C.S. & 50' L.T.
		Br 3082 & 2467	17'		
1934		Br 1005	23'		20' B.S. Maint. Dept.
1934		Br 2043	25'		Br Widening. 25' B.S. Maint. Dept.
1935	82-21-21	Gravel	24'	1"	20' B.S., 23' B.S.
		Br 1495, 1780 (1)	23'		
		1791 & 1838 (1)	23'		24' B.S. & 27' B.S.
1939	A.F.E. 35	Grading	28'		
		Gravel	24'	1"	Maint. Dept.
M	1942	A.F.E. 6	Regraveling		111 C.Y./Mile. Maint. Dept.
M	1943	A.F.E. 6	Grav. Resurface		280 C.Y./Mi. Maint. Dept.
C	1947	A.F.E. 27	Grading	28'	(S.P. 8409-03)
1948	1948	A.F.E. 27	Gravel	25'	
		A.F.E. 7	Seeding	1 1/2"	
M	1948	A.F.E. 6	Grav. Resurfacing		290 Tons
			(Spots)		

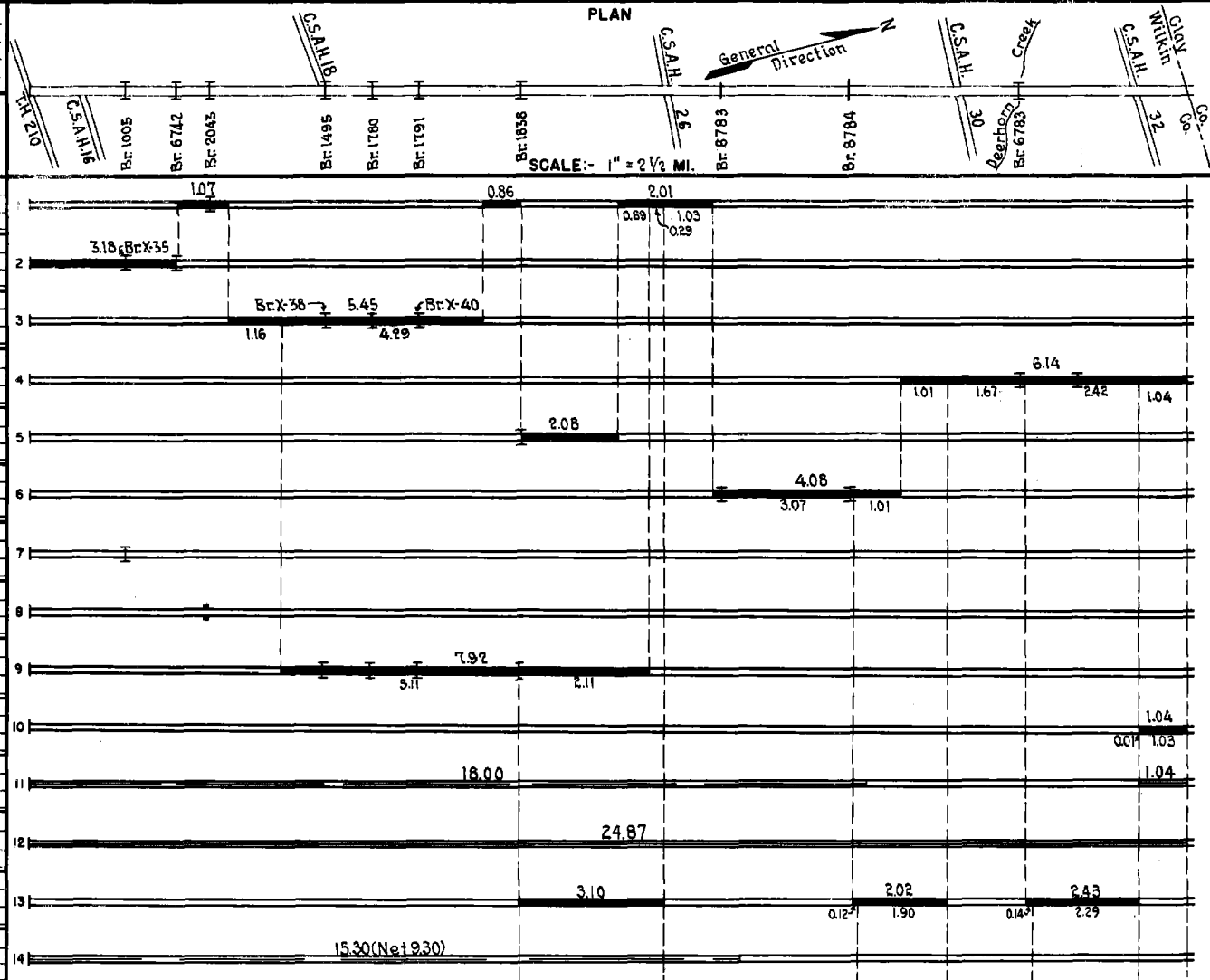

YEARS		TOTAL MILES	UNINCORPORATED		INCORPORATED		RURAL		URBAN	
FROM	TO		RDWY. MI.	BR. MI.	RDWY. MI.	BR. MI.	RDWY. MI.	BR. MI.	RDWY. MI.	BR. MI.
1934	1949	24.87	24.81	0.06	0.00	0.00	24.81	0.06	0.00	0.00
1950	1951	24.92	24.86	0.06	0.00	0.00	24.86	0.06	0.00	0.00
1952		24.93	24.86	0.05	0.00	0.00	24.86	0.05	0.00	0.00

REMARKS: Layout is to scale as of 1934.  
(1) Br 1780 & 1838 reconstructed.

PREPARED BY  
HIGHWAY PLANNING SURVEY  
IN COOPERATION WITH  
U.S. PUBLIC ROADS ADMINISTRATION

STATE OF MINNESOTA  
DEPARTMENT OF HIGHWAYS  
ROAD LIFE STUDIES  
CONSTRUCTION PROJECT LOG RECORD

CONTROL SECTION 8409  
TRUNK HIGHWAY 9  
COUNTY Wilkin  
DISTRICT 4A

LIMITS: Jct. T.H. 210-N. Co. Line

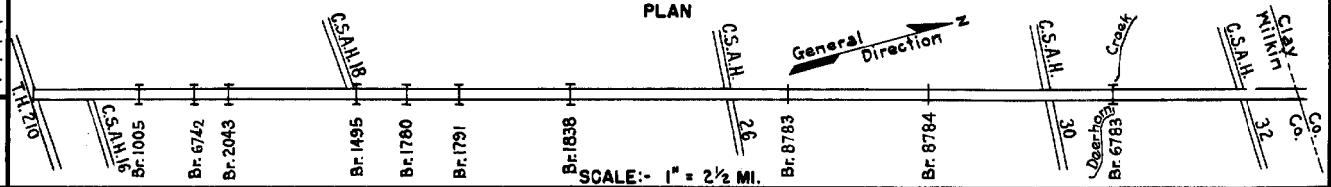

YEAR BUILT	PROJECT N°	DESCRIPTION			CODE N°
		TYPE	WIDTH	THICKNESS	
M	1949 A.F.E. 6	Grav. Resurfacing			4228 Tons
C	1950 8409-05	Grading	28'		1.0' Select Mat'l.
	(2) 8409-06	Gravel	24'	3"	
		Br. 6742	30'		36' B.S.
M	1951 A.F.E. 6	Grav. Resurfacing			12225 Tons
C	1952 8409-08	Grading & Select Mat'l	28'		2-C106D (Br. 8783 & Br. 8784)
	8409-09	Gravel	24'	2"	81' C.S.
		Br. 6783	30'		
C	1952 8409-10	Gravel Base	26'	6"	
		Plant Mix Bit.	24'	1 1/2"	
C	A.F.E. 827	S.C. Culvert			2-48" x 56"
1953	A.F.E. 822	C.M. Culvert			48" x 56"
		S.C. Culv (48" x 60')			Replaces Br. 2042
C	1955 8409-11	Stab. Sand-fn. Sub-base	28'	3-6"	9.93 Mi. of Shoulder
		Stab. Gravel Base	28'	3"	Grading
		Plant Mix Bit.	22'	1 1/2"	
M	1956 A.F.E. 817	Spot Grade & Base Repair			MC-2, 27142 Gal. Agg. 1321 Tons
		Restore Bit. Surf.	24'		
M	1957 A.F.E. 604	Spot Treat			MC-3, 46178 Gal. Agg. 3552 Tons
		Bit. Surf. Repair	24'		
M	1959 A.F.E. 604	Spot Treat			MC-3, 19265 Gal. Agg. 1350 Tons
		Bit. Surf. Repair	24'		
M	1960	Spot Treat			Bit. Mat'l 18942 Gal. Agg. 1362 Tons
		Bit. Surf. Repair	24'		
M	1963 SF	Spot Treat			Bit. Mix 764 Tons MC-3 Prime, 2320 Gal.
		Bit. Surf. Repair			
M	1964 c	Light Bit. Seal	25'		RS-2K, 19966 Gal. Agg. 690 C.Y.
C	1968 8409-12	Pt. Mix. Bit. Surf.	22'	1 1/2"	Bit. Mat'l, 876 Ton
		Gravel Shldcs.			

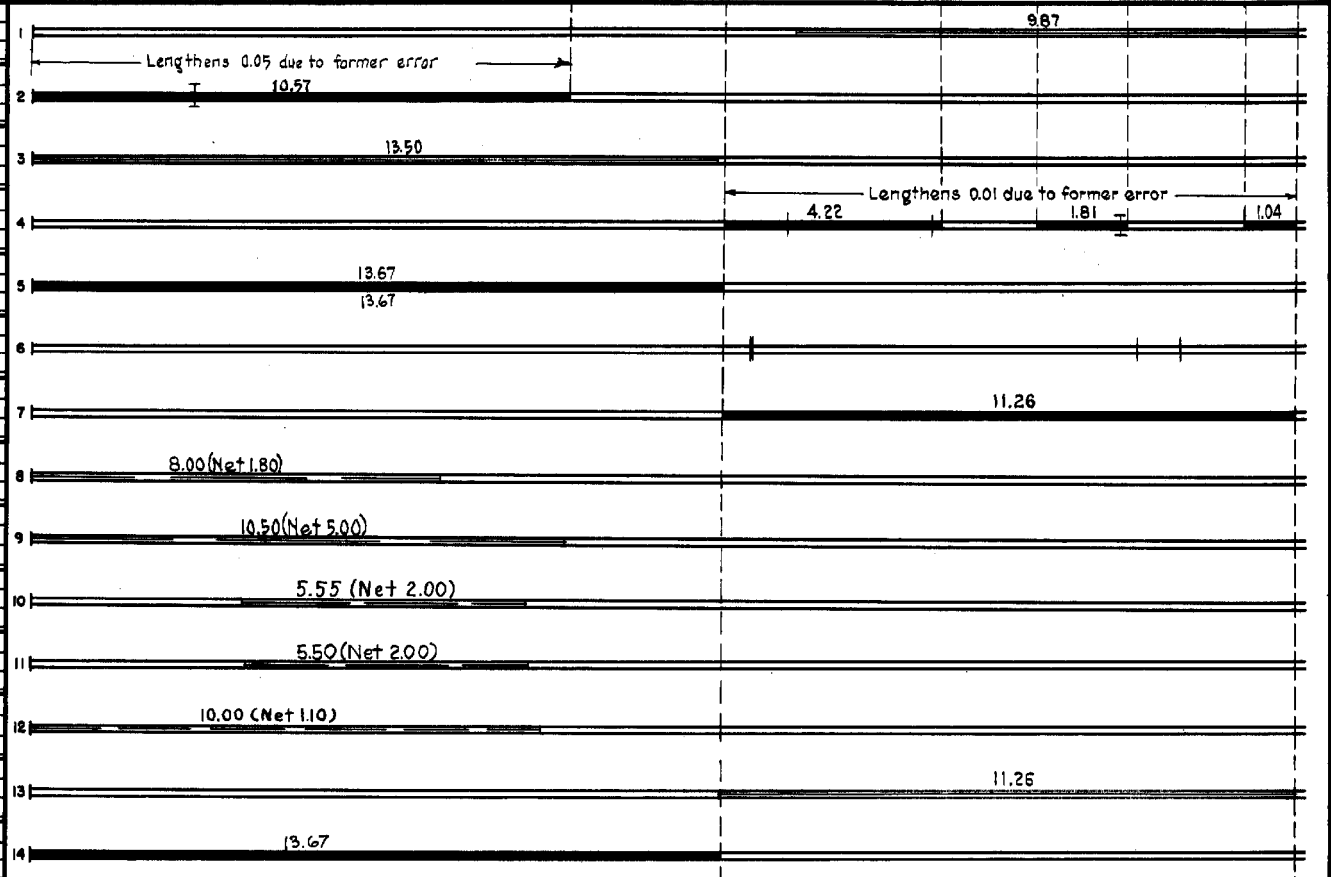

YEARS FROM	TOTAL MILES TO	UNINCORPORATED		INCORPORATED		RURAL		URBAN	
		RDWY. MI.	BR. MI.	RDWY. MI.	BR. MI.	RDWY. MI.	BR. MI.	RDWY. MI.	BR. MI.

REMARKS: See Sheet No. 1  
(2) Contracts not final but work substantially complete in 1950

