

PREPARED BY
TRAFFIC AND PLANNING DIVISION
IN COOPERATION WITH
U.S. DEPARTMENT OF COMMERCE
BUREAU OF PUBLIC ROADS

STATE OF MINNESOTA
DEPARTMENT OF HIGHWAYS
ROAD LIFE STUDIES
CONSTRUCTION PROJECT LOG RECORD

CONTROL SECTION 8280
INTERSTATE TRUNK HIGHWAY 35
COUNTY Washington
DISTRICT Metro

LIMITS: Anoka - Washington Co. Line To Washington - Chisago Co. Line
Ref. Pt. 129+00.955 - 132+00.939

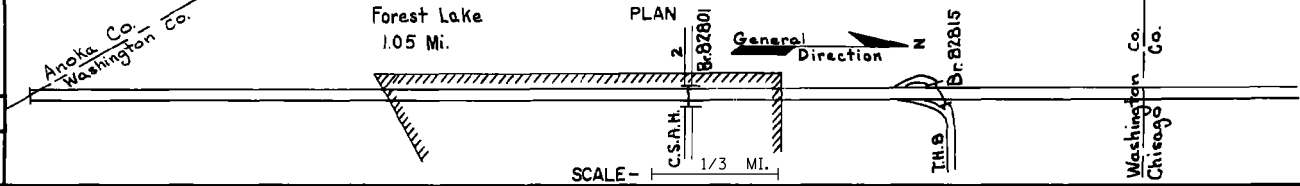

YEAR BUILT	PROJECT NO	DESCRIPTION			
		TYPE	WIDTH	THICKNESS	REMARKS
C	1969 8280-06	Grading Br. 82801 Br. 82815	Var.		Divided Highway 231.2' B.S. - U.P. 355.9' B.S. - U.P.
C	1969 8280-08	Gravel Base P.C. Concrete Pl. Mix. Bit. Shldrs.	20' 3'	5 1/2" B"	10' in E out.
C	1969 1380-04	Grading			Divided Highway
C	1969 1380-14	Base, Asph. Conc. Surf. Pl. Mix. Bit. Shldrs.	20' 2'	3 1/2"	10' out, 3' in.
C	1984 8280-28	Conc. Median Rehabilitation	20'	4"	
C	1984 8280-29	Bit. Base (Inplace) P.C. Concrete Pl. Mix. Bit. Shldrs.	27' 27' 3' 8'	4" 8 1/2" 2"	Cl. 5, Sp. 2204 Reinforced Conc. Sp. 2331
C	1987 8280-30	Bit. Overlay Edge Drains	36-48'	3" 1"	Spec. 2331 Spec. 2361
C	1991 8280-32	Bit. Crack Repair			
C	1997 8280-32	Bit. Milling Resurfacing	36'	2 1/2" 1 1/2"	61WEA75100 41B1B50070
D	2001 8825-102	Rout & Seal			Spec. 3725
R	2009 8280-41	Milling Bit. Overlay Conc. Rehab.	var.	4" 4"	Spec. 2360
S	2011 1380-63	Milling Bit. Overlay Bit. Overlay	24' 24' 24'	2 1/2" 5/8" 4"	Ultrathin SB Spec. 2360 NB
	2013 8280-45	Grading Tension Cable Guardrail			

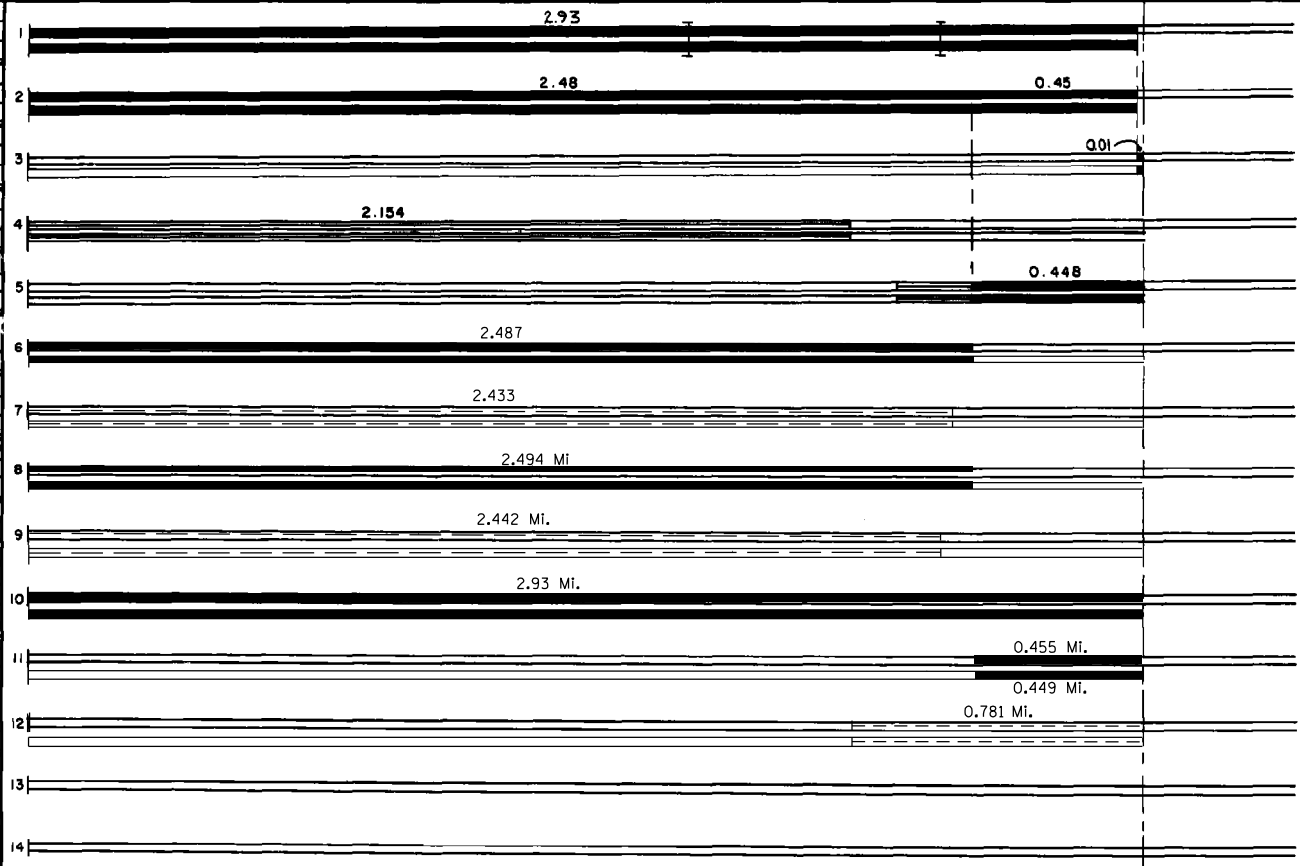

YEARS		TOTAL MILES	UNINCORPORATED		INCORPORATED		RURAL		URBAN		REMARKS
FROM	TO		RDWY. MI.	BR. MI.	RDWY. MI.	BR. MI.	RDWY. MI.	BR. MI.	RDWY. MI.	BR. MI.	
1969	1970	2.94	2.14	0.00	0.80	0.00	2.14	0.00	0.80	0.00	REMARKS: Layout is to scale as of 1969
1971		2.94	1.89	0.00	1.05	0.00	1.89	0.00	1.05	0.00	