

PREPARED BY  
HIGHWAY PLANNING SURVEY  
IN COOPERATION WITH  
U. S. PUBLIC ROADS ADMINISTRATION

STATE OF MINNESOTA  
DEPARTMENT OF HIGHWAYS  
ROAD LIFE STUDIES  
CONSTRUCTION PROJECT LOG RECORD

CONTROL SECTION 7803  
TRUNK HIGHWAY 27  
COUNTY Traverse  
DISTRICT 48

LIMITS: S. Jct T.H. 75 in Wheaton - E. Co. Line.

Wheaton  
0.25 Mi.

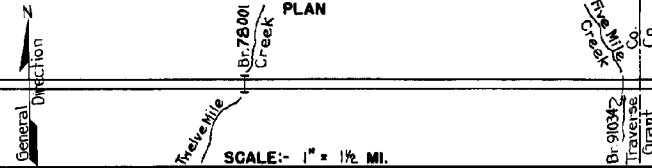
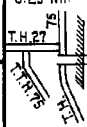

YEAR BUILT	PROJECT N <sup>o</sup>	DESCRIPTION			CODE N <sup>o</sup>
		TYPE	WIDTH	THICKNESS	
		Gravel	25'	2"	No Record of Constr.
		Earth	22'		No Record of Constr.
		Br. M-266 & 320	18'		10 B.S. & 61 B.S.
1924	27-10-51-1	Grading	30'		Br. M-266 Rep. by Culv.
		Br. 4258	23'		100 T.P.G.
		Br. 4259	23'		20 B.S.
1925	27-6-20N	Asphalt			Concrete Base.
1925	27-10-51-1	Gravel	24'	4"	1900 C.Y./Mile.
1931		Oil Tr. Gravel	23'		Maint. Dept.
1932		Oil Tr. Gravel	23'	2"	12114 Gal./Mile Maint. Dept.
(1)					
1932	27-10-51-1	Oil Tr. Gravel	25'	2"	12114 Gal./Mile Maint. Dept.
M		Spot Treat.			MC3, 2834 Gal./Mi.
1940	A.F.E. 48	Bit. Surf. Repair			Grav. 113 C.Y./Mi. Maint. Dept.
M		Spot Treat.			MC2 Ass. 2385 Gal./Mi.
1942	A.F.E. 12	Bit. Surf. Repair			Grav. 196 C.Y./Mi. Maint. Dept.
M		Spot Treat.			MC2, 2719 Gal./Mi.
1943	A.F.E. 4	Bit. Surf. Repair			Grav. 86 C.Y./Mi. Maint. Dept.
M		Spot Treat.			Bit. 4880 Gal./Mi.
1944	A.F.E. 5	Bit. Surf. Repair & Spot Seal Coat	24'		Grav. 173 C.Y./Mi. Maint. Div.
M		Spot Treat.			MC2, 3945 Gal./Mi.
1945	A.F.E. 4	Bit. Surf. Repair	25'		Grav. 193 C.Y./Mi. Maint. Div.
C		Bit. Resurfacing			SC-3, 125660 Gal.
1946	A.F.E. 16	Mixed Bit.	24'	1"	Avg. 6710 C.Y. added

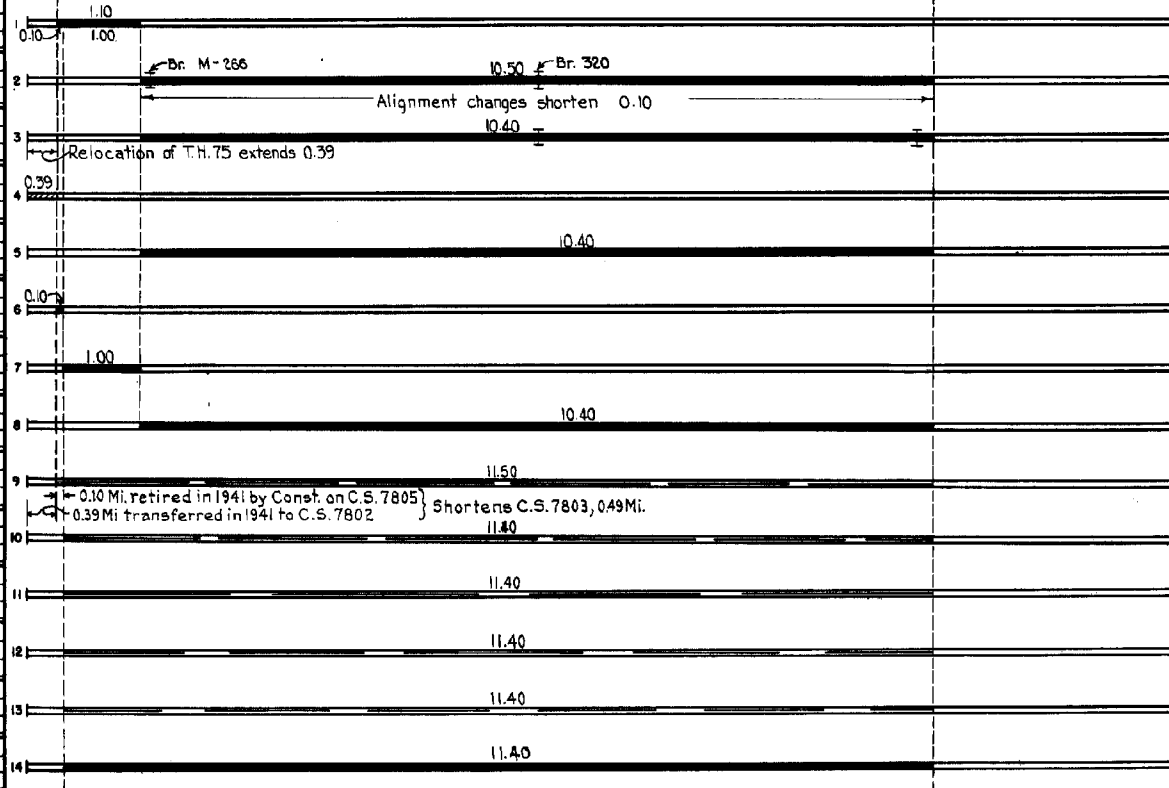

YEARS FROM	TO	TOTAL MILES	UNINCORPORATED		INCORPORATED		RURAL		URBAN	
			RDWY. MI.	BR. MI.	RDWY. MI.	BR. MI.	RDWY. MI.	BR. MI.	RDWY. MI.	BR. MI.
1927	1925	11.60	11.24	0.01	0.35	0.00	11.24	0.01	0.35	0.00
1924	1924	11.50	11.13	0.02	0.35	0.00	11.13	0.02	0.35	0.00
1929	1940	11.85	11.13	0.02	0.74	0.00	11.13	0.02	0.74	0.00
1941		11.40	11.13	0.02	0.25	0.00	11.13	0.02	0.25	0.00

REMARKS: Layout is to scale as of 1925. Plan revised for 1941 relocation of T.H. 75

(1) This work not done under this project number but lies within the limits of this project.

PREPARED BY  
HIGHWAY PLANNING SURVEY  
IN COOPERATION WITH  
U. S. PUBLIC ROADS ADMINISTRATION

STATE OF MINNESOTA  
DEPARTMENT OF HIGHWAYS  
ROAD LIFE STUDIES  
CONSTRUCTION PROJECT LOG RECORD

CONTROL SECTION 7803  
TRUNK HIGHWAY 27  
COUNTY TRAVERSE  
DISTRICT 4B

LIMITS: S. Jct. T.H. 75 in Wheaton - E. Co. Line

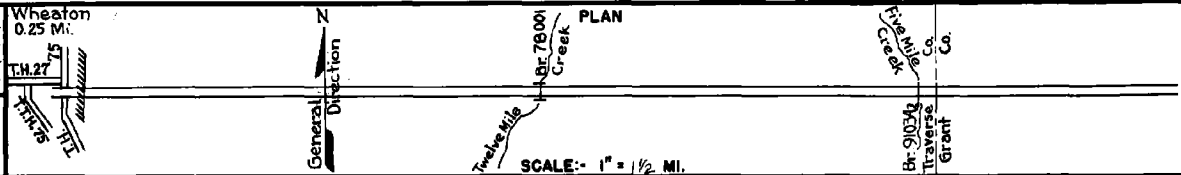

YEAR BUILT	PROJECT N <sup>o</sup>	DESCRIPTION			CODE N <sup>o</sup>
		TYPE	WIDTH	THICKNESS	
M 1947	A.F.E. 4	Spot Treat. Bit. Surf. Repair & Fog Seal	24'	SC-3 MC-2 35306 Gal. Agg. 1124 Tons	1
M 1948	A.F.E. 4	Gravel Base (Spots) Spot Treat. Bit. Surf. Repair	25' 24'	SC3&MC2 35740 Gal. Agg. 2069 Tons	2
M 1949	A.F.E. 4	Spot Treat. Bit. Surf. Repair	24'	Bit. 14944 Gal. Agg. 647 C.Y.	3
M 1970	A.F.E. 4	Spot Treat. Bit. Surface Repair	24'	SC-3, 40699 Gal. Agg. 2120 C.Y.	4
M 1951	A.F.E. 4	Spot Treat. Bit. Surf. Repair	24'	SC3&MC2 20736 Gal. Agg. 1082 C.Y.	5
M 1952	A.F.E. 4	Spot Treat. Bit. Surf. Repair	24'	SC-3, 27937 Gal. Agg. 1125 C.Y.	6
M 1953	A.F.E. 604	Spot Treat. Bit. Surf. Repair	24'	SC3&MC2 29900 Gal. Agg. 1453 C.Y.	7
M 1954	A.F.E. 604	Spot Treat. Bit. Surf. Repair	24'	SC3&MC3 21275 Gal. Agg. 1379 Tons	8
M 1955	A.F.E. 604	Spot Treat. Bit. Surf. Repair	24'	MC-2 15574 Gal. Agg. 1002 Tons	9
M 1956	A.F.E. 604 A.F.E. 605	Spot Treat. Bit. Surf. Repair Light Bit. Seal	24' 24'	MC2 34862 48704 Gal. Agg. 2444 Tons 6269 C.Y.	10
M 1957	A.F.E. 604	Spot Treat. Bit. Surf. Repair	24'	MC-2 10759 Gal. Agg. 674 Tons	11
M 1958	A.F.E. 604	Spot Treat. Bit. Surf. Repair	24'	MC-2 6452 Gal. Agg. 420 Tons	12
C 1962	7803-02	Grading Sub base Road Mix Bit. (Base) Br. 91034	26'	11" Sand-Gravel Sub base over 3" 5" Gravel Base C108D	13
C 1964	7803-03	Plant mix bit Gravel Shoulders	24'	6" rt. & lt.	14

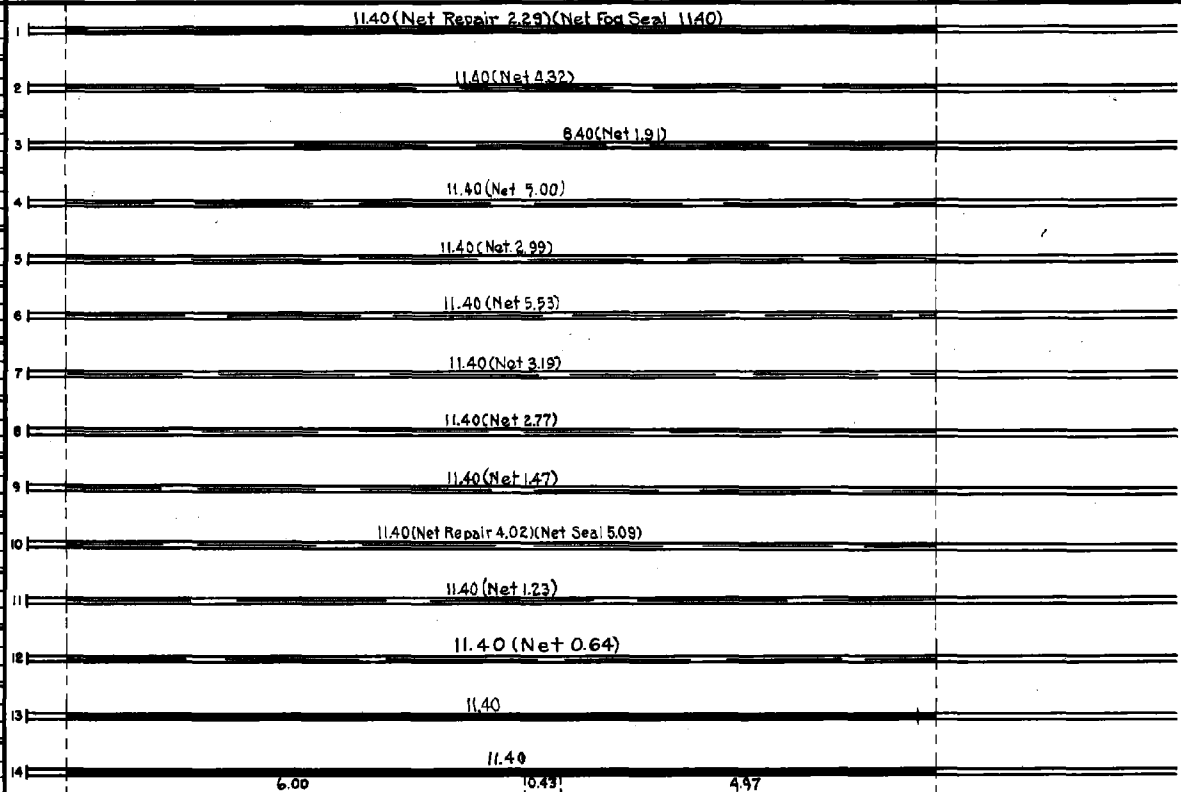

YEARS FROM	TOTAL TO	UNINCORPORATED		INCORPORATED		RURAL		URBAN	
		RDWY. MI.	BR. MI.	RDWY. MI.	BR. MI.	RDWY. MI.	BR. MI.	RDWY. MI.	BR. MI.

REMARKS: See Sheet N<sup>o</sup> 1

PREPARED BY  
TRAFFIC AND PLANNING DIVISION  
IN COOPERATION WITH  
U.S. DEPARTMENT OF COMMERCE  
BUREAU OF PUBLIC ROADS

STATE OF MINNESOTA  
DEPARTMENT OF HIGHWAYS  
ROAD LIFE STUDIES  
CONSTRUCTION PROJECT LOG RECORD

CONTROL SECTION 7803  
TRUNK HIGHWAY 27  
COUNTY Traverse  
DISTRICT 4B

LIMITS: S. Jct. T.H. 75 in Wheaton - E. Co. Line  
Ref. Pt. 024+00.108 - 035+00.521

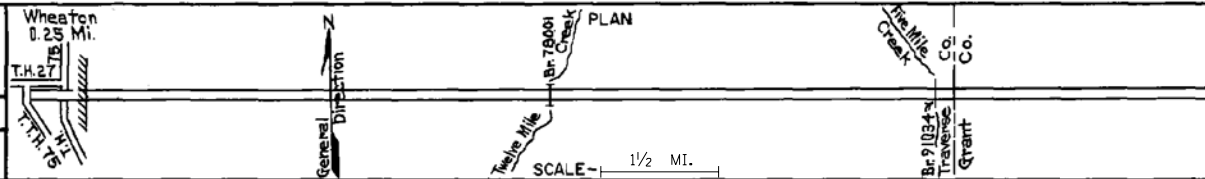

YEAR BUILT	PROJECT NO.	DESCRIPTION			REMARKS
		TYPE	WIDTH	THICKNESS	
M 1966	C	Light Bit Seal	25'		CRS-1 24612 Gal. Agg. 788 C.Y.
C 1970	7803-06	Grade, Base, Pl. Mix Bit Surf. Br. 78001	24'	6" 1 1/2"	Remove Br. 4258 16' B.S.
C 1984	7803-08	Remove Incl. Bit. Bit. Surfacing Agg. Shoulders	24'	4 1/2" 5-6" Var.	
M 1995	7803-95145	Aggregate Seal			Fine Aggregate 3
S 2000	7803-12	Milling Bit. Overlay	24'	2" Var.	Spec. 2350
M 2002	8824-31	Major Crack Repair	var	var	
M 2005	8824-49	Bituminous Seal Coat	24'		Spec 2356

1	11.40	
2		0.43
3	11.152	
4	11.41 MI	
5	11.41 MI	
6	11.413 MI	
7	11.413 MI	
8		
9		
10		
11		
12		
13		
14		

YEARS FROM	TOTAL TO	MILES	UNINCORPORATED		INCORPORATED		RURAL		URBAN	
			RDWY. MI.	BR. MI.	RDWY. MI.	BR. MI.	RDWY. MI.	BR. MI.	RDWY. MI.	BR. MI.

REMARKS: See sheet No 1