

PREPARED BY  
HIGHWAY PLANNING SURVEY  
IN COOPERATION WITH  
U.S. PUBLIC ROADS ADMINISTRATION

STATE OF MINNESOTA  
DEPARTMENT OF HIGHWAYS  
ROAD LIFE STUDIES  
CONSTRUCTION PROJECT LOG RECORD

CONTROL SECTION 7202  
TRUNK HIGHWAY 15  
COUNTY Sibley  
DISTRICT 7A

LIMITS: S.Co. Line - E. Jct. T.H. 19 in Winthrop

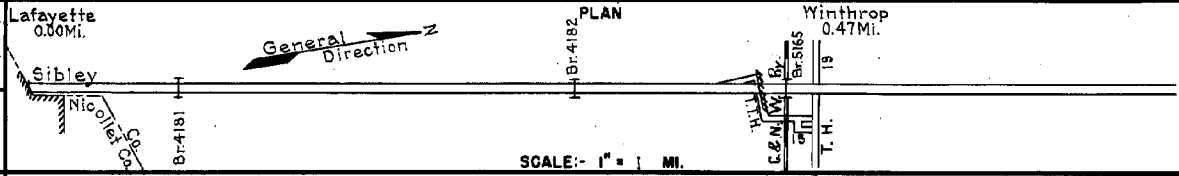

YEAR BUILT	PROJECT N°	DESCRIPTION			CODE N°
		TYPE	WIDTH	THICKNESS	
		Grading	24'		No Record of Constr.
1921	15-14-2	Gravel	40'		
		Gravel	36'	3 1/2"	2400 C.Y./Mile.
1924	15-15-30 B&C	Grading	30'		
		Br. 4182	27'		30' B.S.
		Br. 4181	27'		23' B.S.
1925	15-15-30 B&C	Gravel	26'	3 1/2"	1600-1700 C.Y./Mile.
1926		Oil Tr. Gravel			Maint. Dept.
1931	15-15-30 A&B	Concrete	20'	9-9"	
1931		Concrete	V.M.		
1931	15-15-30 Ext.	Grading	40'		Not in use as T.H. until 1938.
1937	15-15-30	Br. 5165	26'		184' B.S.-0.H.
1938	7202-02	Concrete	40'	9-9"	
		Mixed Bit. (1)	16'	1 1/2"	8' R&L of Conc.
1945	A.F.E. 20	Ditch Grading			Maint. Div.
1940	C	Light Bit Seal	Var.		RC-2, 286 Gal.
1962	SF	Bit. Repair of Pav't.	27'		Agg. 17 Tons Plant Mix 137 Tons
1963	SF	Spot Treat			
		Bit. Surf. Repair			Plant mix 70 Tons
1972	7202-19	Gravel Shoulders			Remove integral Curbs & Shoulder Drains 6.84 mi.

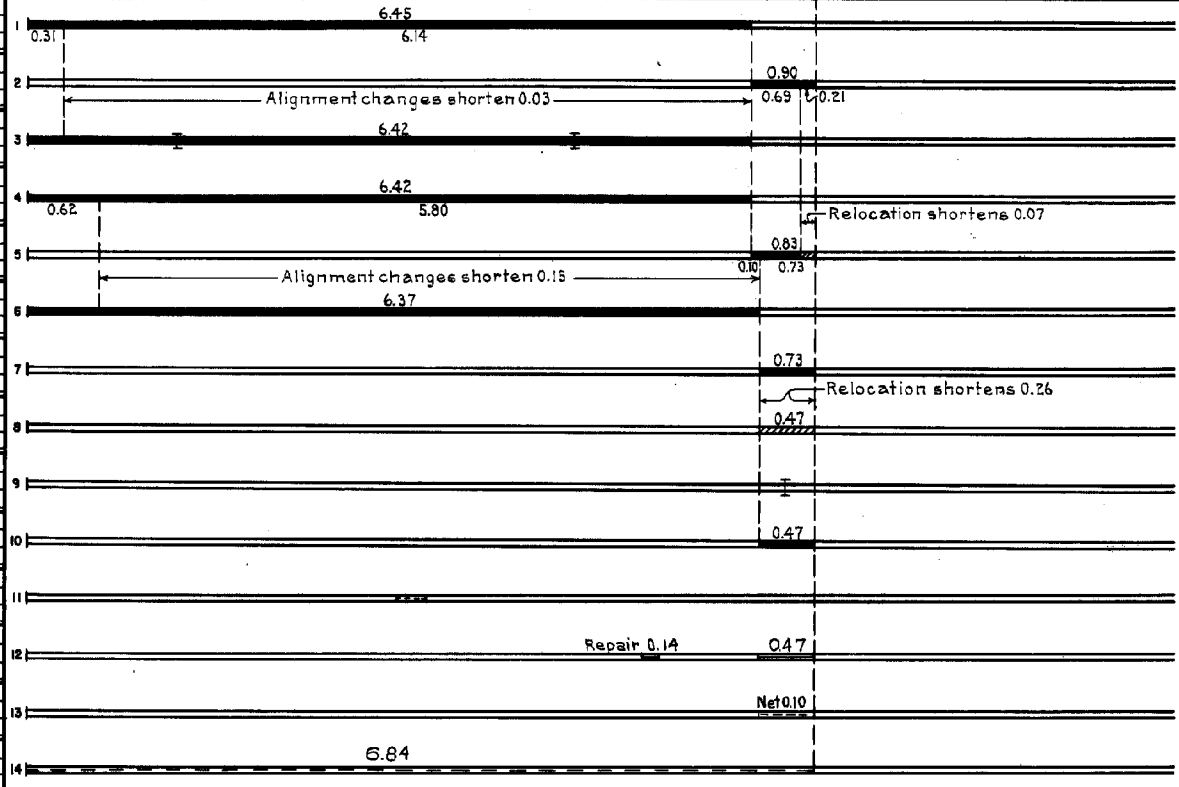

YEARS FROM	TO	TOTAL MILES	UNINCORPORATED		INCORPORATED		RURAL		URBAN	
			ROWY. MI.	BR. MI.	ROWY. MI.	BR. MI.	ROWY. MI.	BR. MI.	ROWY. MI.	BR. MI.
1921	1923	7.35	5.4	0.00	1.2	0.00	6.45	0.00	0.90	0.00
1924	1925	7.32	6.10	0.00	1.2	0.00	6.41	0.01	0.90	0.00
1926	1930	7.25	6.10	0.00	1.14	0.00	6.41	0.01	0.83	0.00
1931	1937	7.10	6.05	0.00	1.04	0.00	6.36	0.01	0.73	0.00
1938		6.84	6.36	0.00	0.48	0.04	6.35	0.01	0.43	0.04

REMARKS: Layout is to scale as of 1938

(1) Mixed Bit. placed on 3" Sta. 5 Gravel Base.

6-73

PREPARED BY  
 TRANSPORTATION & TRANSIT PLANNING & PROGRAMMING DIVISION  
 IN COOPERATION WITH  
 U.S. DEPARTMENT OF TRANSPORTATION-BUREAU OF PUBLIC ROADS

STATE OF MINNESOTA  
 DEPARTMENT OF HIGHWAYS  
 ROAD LIFE STUDIES  
 CONSTRUCTION PROJECT LOG RECORD

CONTROL SECTION 7202  
 TRUNK HIGHWAY 15  
 COUNTY Sibley  
 DISTRICT 7A

LIMITS: Nicollet-Sibley Co line - Jct MNTH-19; W Limits of Winthrop  
 Ref. Pt. 070+00.344 - 076+00.876

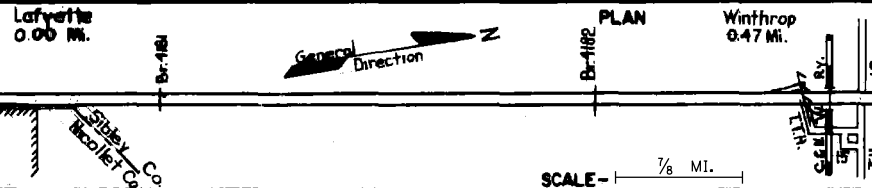

YEAR BUILT	PROJECT NR	DESCRIPTION			
		TYPE	WIDTH	THICKNESS	REMARKS
M 1972	SF	Spot Bit Repair	20'		MC-250 2006 Gal. Agg. 191 Ton
M 1973	SF	Spot Bit Repair	20'		270 Gals. Agg.
M 1978	SF	Bit Spot Overlay	24'	1 1/2"	Pl. Mix AC - 370 Tons
M 1980	SF	Bit Surf. Repair	20'	3/4"	Pl. Mix AC Fines 211.50 Ton 100 Gal. RC Tack
C 1983	7202-12	Grading, App Base Concrete Surface App. & Bit. Shldr	33' 27' 8.5'	8" 7.5" 2"	
C 1986	7202-13	Grading, App Base Concrete Surface App. & Bit. Shldr	33' 27' 8.5'	8" 7.5" 2"	
M 1991	4484	Edge Drains			
M 1993	93129	Edge Drains			
2010	7202-20	Bit. Overlay	24'	2"	Spec. 2360
2012	7202-22 (5204-112)	Bit. Mill & Overlay Bit. Shldr Reclamation UTBWC	var. var. .63	2'-3" 7.5" 2"	Spec. 2360 Spec. 2360 Spec. 2353

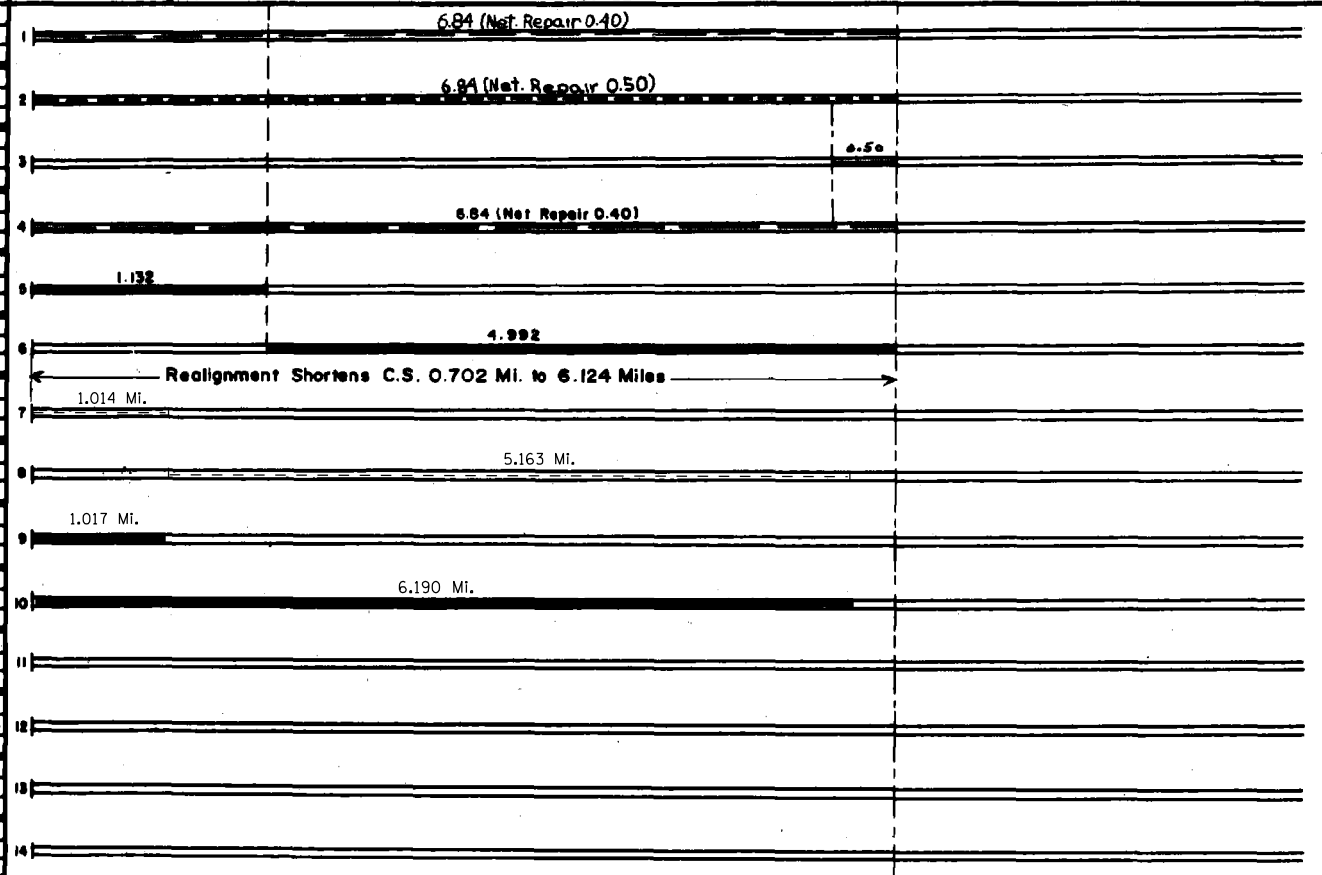

YEARS		TOTAL MILES	UNINCORPORATED		INCORPORATED		RURAL		URBAN	
FROM	TO		ROWY. M.	BR. M.	ROWY. M.	BR. M.	ROWY. M.	BR. M.	ROWY. M.	BR. M.

REMARKS: See Sheet No. 1