

PREPARED BY  
HIGHWAY PLANNING SURVEY  
IN COOPERATION WITH  
U.S. PUBLIC ROADS ADMINISTRATION

STATE OF MINNESOTA  
DEPARTMENT OF HIGHWAYS  
ROAD LIFE STUDIES  
CONSTRUCTION PROJECT LOG RECORD

CONTROL SECTION 6002  
TRUNK HIGHWAY 2  
COUNTY Polk  
DISTRICT 28

LIMITS: N.Jct.T.H.75 - Jct.T.H.9

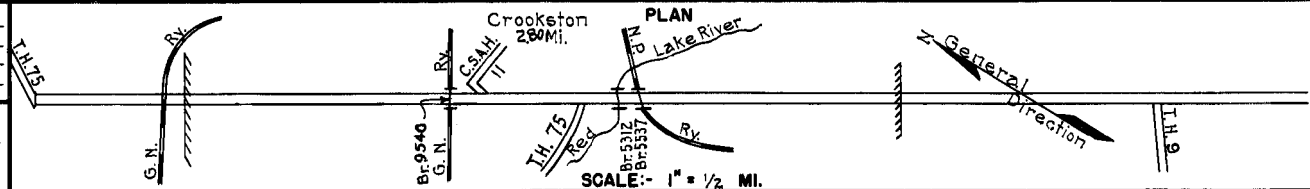

YEAR BUILT	PROJECT N <sup>o</sup>	DESCRIPTION			CODE N <sup>o</sup> D
		TYPE	WIDTH	THICKNESS	
		Gravel Br.5525	35'		
1920	2-6-15	Concrete	18'	6 7/8"	
1921	2-6-20G	Concrete	24'		
1921		Concrete	30'		No Record of Constr. Maint. Dept.
1921	2-6-20M	Concrete	50'		
1922	2-6-33	Grading	30'		
1922	2-6-33	Gravel			Maint. Dept.
1923	2-6-23	Concrete Br. M-126 Br.	30' 20'		275' H.T. & D.G. Underpass.
1930	2-8-50-1	Grading Concrete	40' 20'	9-7-9	229 230
1931	2-8-23-2	Concrete	20'	9-7-9	
1934	2-6-23	Br.5312	32'		198' H.T. 1334
1936	2-6-62	Grading Concrete	40'		2135 1536
1936	2-6-62 2-6-63	Concrete	10'		2135 1536
1937	2-6-62	Br.5537	40'		W.R.T.-B.S.&D.P.G.-U.P. 2236

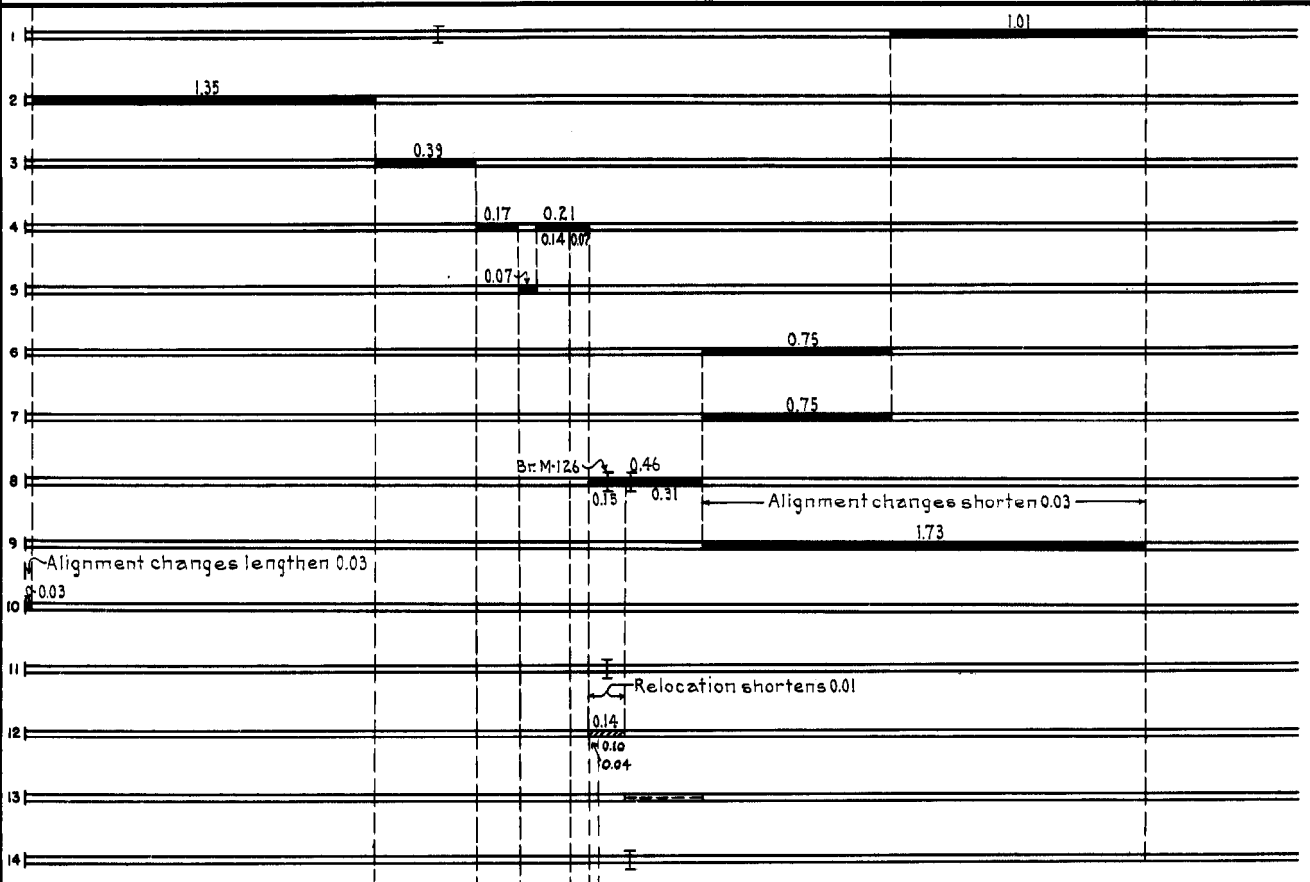

YEARS		TOTAL MILES	UNINCORPORATED		INCORPORATED		RURAL		URBAN	
FROM	TO		RDWY. MI.	BR. MI.	RDWY. MI.	BR. MI.	RDWY. MI.	BR. MI.	RDWY. MI.	BR. MI.
1923	1929	4.41	1.80	0.00	2.56	0.05	1.80	0.00	2.56	0.05
1930	1930	4.38	1.79	0.00	2.54	0.05	1.79	0.00	2.54	0.05
1931	1935	4.41	1.82	0.00	2.54	0.05	1.82	0.00	2.54	0.05
1936	1952	4.40	2.19	0.00	2.17	0.04	2.19	0.00	2.17	0.04
1953	1955	4.40	1.82	0.00	2.54	0.04	1.82	0.00	2.54	0.04
1956	1963	4.41	1.82	0.00	2.55	0.04	1.82	0.00	2.55	0.04
1964	1970	4.39	1.82	0.00	2.53	0.04	1.82	0.00	2.53	0.04

REMARKS: Layout is to scale as of 1931  
(1) This work not done under this project number but lies within the limits of this project.

PREPARED BY  
HIGHWAY PLANNING SURVEY  
IN COOPERATION WITH  
U.S. PUBLIC ROADS ADMINISTRATION

STATE OF MINNESOTA  
DEPARTMENT OF HIGHWAYS  
ROAD LIFE STUDIES  
CONSTRUCTION PROJECT LOG RECORD

CONTROL SECTION 6002  
TRUNK HIGHWAY 2  
COUNTY Polk  
DISTRICT 2B

LIMITS: N. Jct. T.H. 75 - Jct. T.H. 9

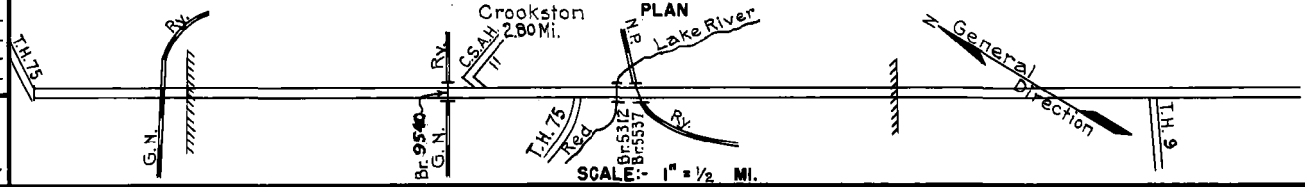

YEAR BUILT	PROJECT N°	DESCRIPTION			CODE N° DIST
		TYPE	WIDTH	THICKNESS	
1938	2-6-63	King Signals			1737
1939	6002-02	Widening			
M	A.F.E. 24	Bit. Resurfacing on old Concrete	24'	1/2"	
1952	6002-06	Traffic Signals			1352
M	A.F.E. 822	Shoulder Repair			
C	A.F.E. 604	Bit. Surfacing Mixed Bit.	42.50'	1"	
		Concrete (0.38 Mi.)	50.50'		
		Bit. Conc. on Conc. (0.07 Mi.)	38'		
C	6002-07	Grading Base (3)	72'		1855
	6002-11 *	Plant Mix Bit.	48'	3"	
C	1956 A.F.E. 817	Install Guard Rail			
M	1957 A.F.E. 605	Heavy Bit. Seal Coat	50'		
C	1958 A.F.E. 823	(Service Drives) Bit. Stab. Grav. Base Mixed Bit.	24'	2" / 1 1/2"	
C	1962	Replace Portals & Raise Cross Frames on Br. 5312 Service Drive	24'		
C	1964 6002-10	Grading* Gravel & Conc. Base Pl. mix. Bit.		3"	363
C	1964 6002-20	Traffic Signals			264
	6002-9540	Br. 9540 Handrail *			

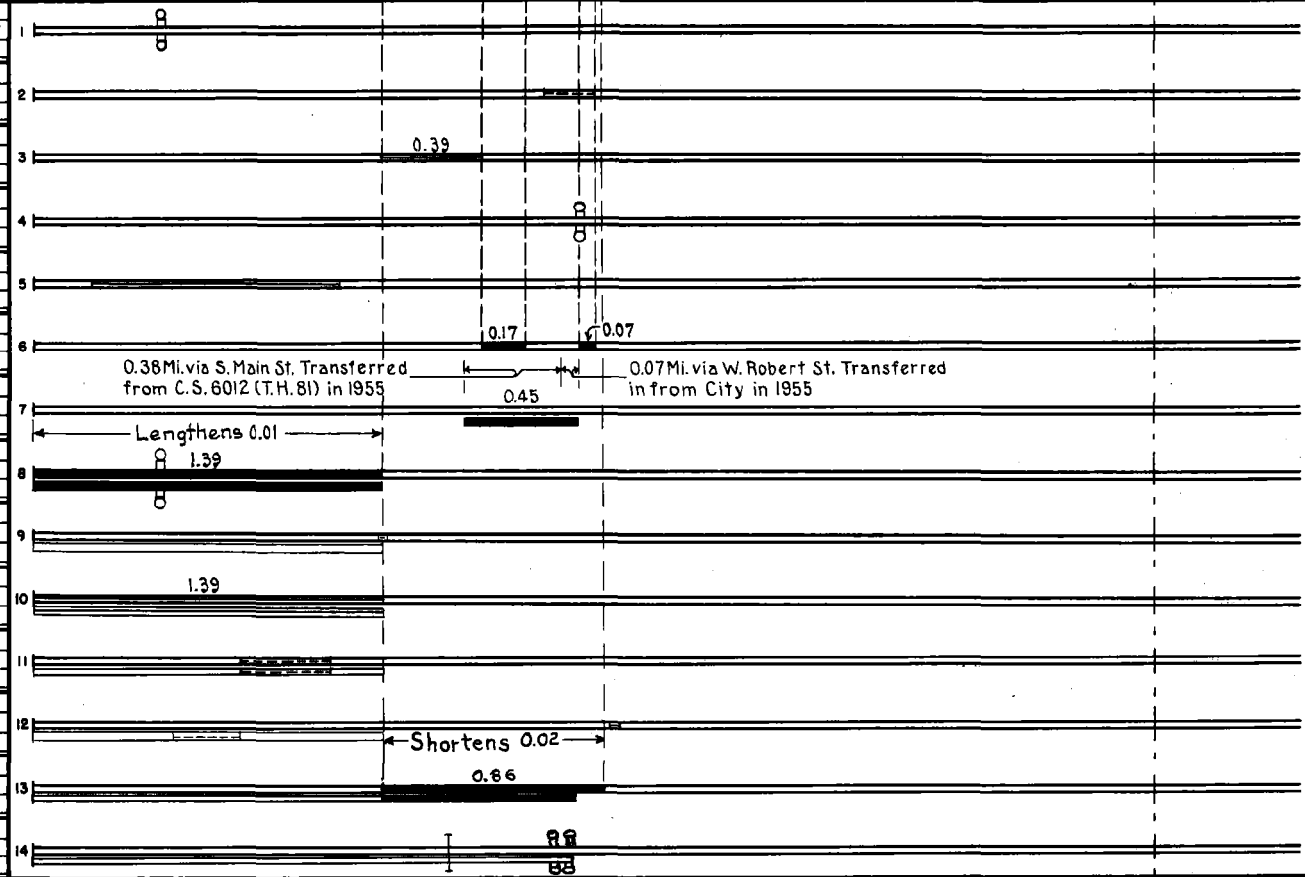

YEARS		TOTAL MILES	UNINCORPORATED		INCORPORATED		RURAL		URBAN	
FROM	TO		RDWY. MI.	BR. MI.	RDWY. MI.	BR. MI.	RDWY. MI.	BR. MI.	RDWY. MI.	BR. MI.
1971		4.39	1.57	0.00	2.76	0.04	1.59	0.00	2.76	0.04

REMARKS: See Sheet No. 1  
(2) S.E. Bound Rdwy. of two one way streets. (3) S. bound rdwy. new 24"x8" conc. base, N. bound rdwy. old conc. removed or buried with bit. stab. grav. base.  
FOR OTHER PROJECTS SEE DIST. No. 1658, 562, 1562, 765, 1565

PREPARED BY  
TRAFFIC AND PLANNING DIVISION  
IN COOPERATION WITH  
U.S. DEPARTMENT OF COMMERCE  
BUREAU OF PUBLIC ROADS

STATE OF MINNESOTA  
DEPARTMENT OF HIGHWAYS  
ROAD LIFE STUDIES  
CONSTRUCTION PROJECT LOG RECORD

CONTROL SECTION 6002  
TRUNK HIGHWAY 2  
COUNTY Polk  
DISTRICT 28

LIMITS: N. Jct. T.H. 75 - Jct. T.H. 9

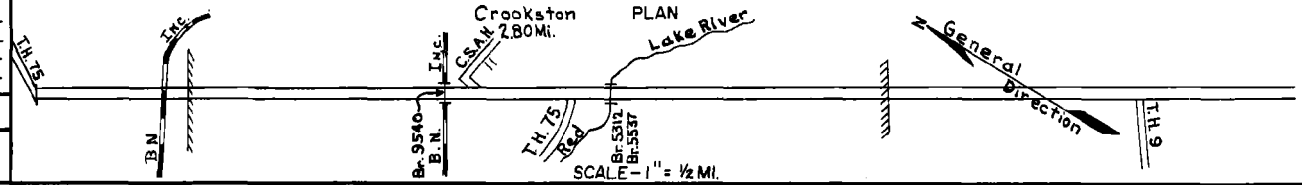

DIST No.	YEAR BUILT	PROJECT NO.	DESCRIPTION			REMARKS
			TYPE	WIDTH	THICKNESS	
966	1969	6002-21	Grading, Base, Pl. Mix Bit. Surf. P.C. Concrete Surf.	Var.	Var.	1.31 mi. Divided Highway
	M		Joint seal			5,272 Lin. Ft.
1674	C	-32	Traffic Signal System			At 2nd St., T.H. 75 & Ash
375	1975	6002-29	Grading, Agg. Base, Pl. Mix Bit. Base & Surf. Pl. Mix Bit. Shoulders & Turn Lanes	30'	20"	
	C		Misc. Grading			Shoulders Pl. Mix Bit. 3' W & 12' OUT
375	1976	6002-30	Misc. Grading, Pl. Mix Bit. Shoulders & Turn Lanes			Shoulders Pl. Mix Bit. 3' W & 12' OUT
	C		Misc. Grading, Pl. Mix Bit. Shoulders & Turn Lanes			Shoulders Pl. Mix Bit. 3' W & 10' OUT
2077	1978	6002-34	Bit. Resurfacing and Shoulders	2 @ 24' 10' OUT	2 1/2" 3/4"	RETIREMENT FOR W.B. LA. ONLY FROM STA. 1204+90 TO 87+78.0
	C		TURN LANE AT Jct. CSAH 11			COOP. AGREE.
1869	C	1969 6002-25	P. Mix Bit. Surf.	24'	5/8"	SPEC. 2331
1879	1979	6002-39	P. Mix Bit. Surf.	40'-20'	3/4"	SPEC. 2331
	M		GRAV. SHLDR. REPAIR EBLANE			250 C.Y.
3678	M	1978 SF	BIT. SHOULDERING EBLANE			540 TON P. MIX
780	1980	SF	Clean, Saw & Reseal Joints in Concrete Pavement			
	M	1982 6002-9540	Painting Br. 9540			Contract No. 18447

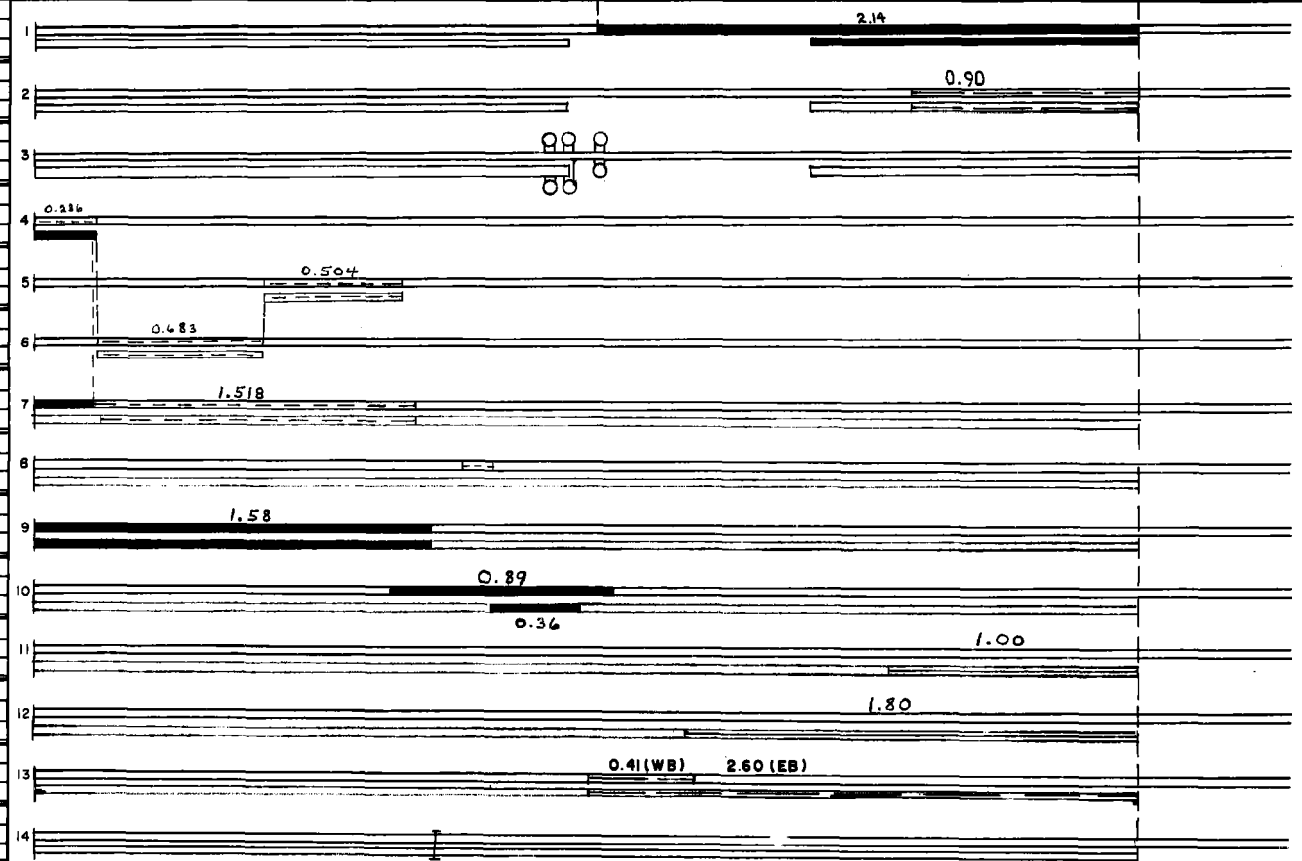

YEARS		TOTAL MILES	UNINCORPORATED		INCORPORATED		RURAL		URBAN		REMARKS: See Sheet No. 1
FROM	TO		RDWY. MI.	BR. MI.	RDWY. MI.	BR. MI.	RDWY. MI.	BR. MI.	RDWY. MI.	BR. MI.	

FOR OTHER PROJECTS SEE DIST. NO. 3269, 3669, 4069, 1278



