

PREPARED BY
HIGHWAY PLANNING SURVEY
IN COOPERATION WITH
U.S. PUBLIC ROADS ADMINISTRATION

STATE OF MINNESOTA
DEPARTMENT OF HIGHWAYS
ROAD LIFE STUDIES
CONSTRUCTION PROJECT LOG RECORD

CONTROL SECTION 5622
TRUNK HIGHWAY 106
COUNTY Otter Tail
DISTRICT 4A

LIMITS: Jct. T.H. 29 in Deer Creek - Jct. T.H. 10

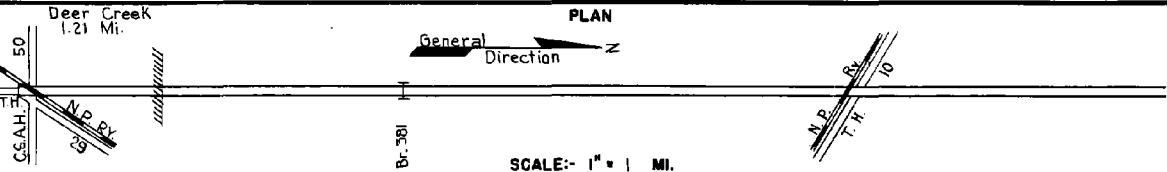

YEAR BUILT	PROJECT N ^o	DESCRIPTION			CODE N ^o
		TYPE	WIDTH	THICKNESS	
		Oil Tr. Gravel	22'	1"	No Record of Constr.
					Added in 1934.
		Gravel	24'	4"	No Record of Constr.
		Br. 381	20'		Added in 1934.
		Grading	30'		70' W.P.T.
1938	A.F.E. 19	Gravel (Pit Run)	30'	1"	
					Maint. Dept.
1939		Br. 381	24'		Br. Widening.
					68' W.P.T.
					Maint. Dept.
C		Grading	3448		0.91 mi. Divided
1942	5622-03	Stab. Gravel			1355 C.Y./Mile.
C					Seed supplied by
1942	A.F.E. 7	Seeding			R.S.R. (S.F. 5622-04)
					Maint. Dept.
C		Bit Surfacing			MC2, 111244 Gal.
1948	A.F.E. 26	Mixed Bit.	24'	1 1/2"	Agg. 6412 Tons
M					MC2, 1578 Gal.
1951	A.F.E. 4	Light Bit. Seal	24'		Agg. 56 C.Y.
C		Gravel Base	28'	8"	SC3, 17312 Gal.
1951	A.F.E. 17	Bit. Surfacing			Agg. 1470 Tons
		Mixed Bit.	24'	1"	
M		Spot Treat.			MC3, 18367 Gal.
1952	A.F.E. 4	Bit. Surf. Repair	24'		Agg. 1378 Tons
M		Spot Treat.			MC3, 35906 Gal.
1954	A.F.E. 604	Bit. Surf. Repair	24'		Agg. 2632 Tons
M		Spot Treat.			MC3, 8769 Gal.
1957	A.F.E. 604	Bit. Surf. Repair	24'		Agg. 624 Tons
M		Spot Treat.			MC3, 9682 Gal.
1958	A.F.E. 604	Bit. Surf. Repair	24'		Agg. 692 Tons
M		Light Bit. Seal			RS-10, 18388 Gal.
1965	C		25'		Agg. 203 C.Y.

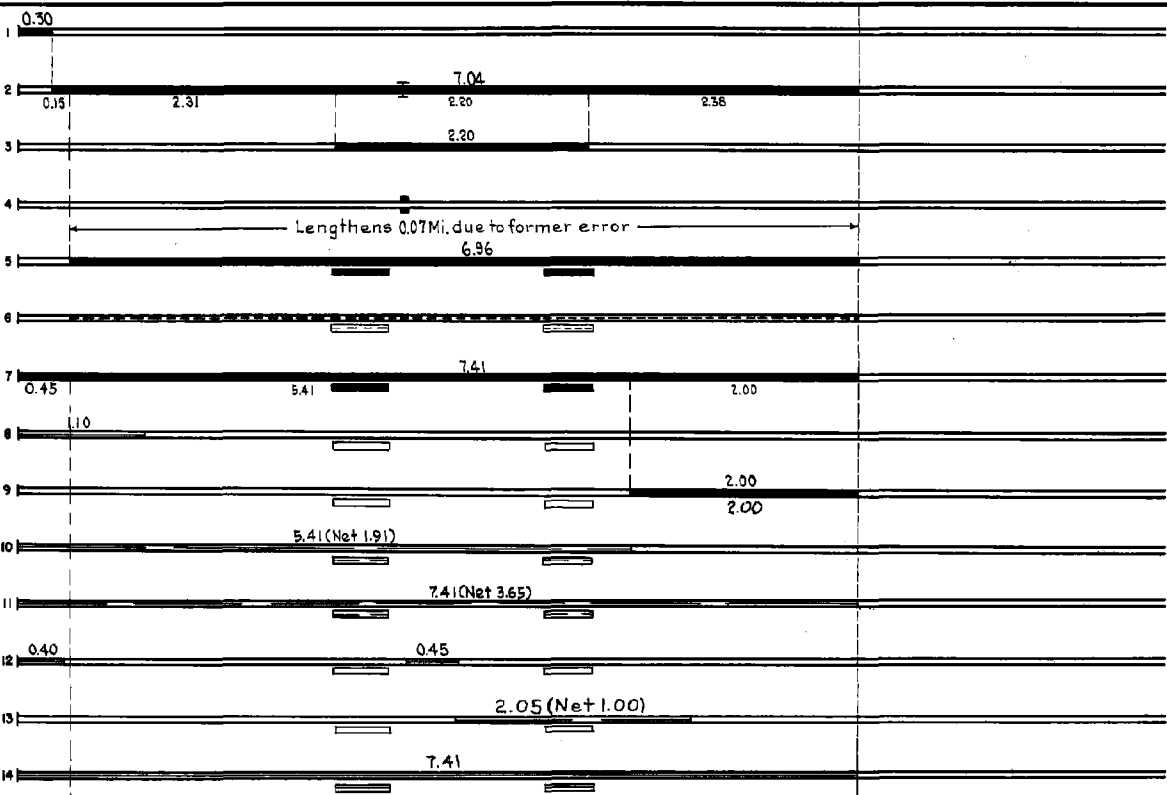

YEARS FROM	TO	TOTAL MILES	UNINCORPORATED		INCORPORATED		RURAL		URBAN	
			RDWY. MI.	BR. MI.	RDWY. MI.	BR. MI.	RDWY. MI.	BR. MI.	RDWY. MI.	BR. MI.
1934	194	7.34	5.07	0.0	1.26	0.00	7.33	0.01	0.00	0.00
1942	1973	7.4	6.14	0.0	1.26	0.00	7.40	0.0	0.00	0.00
1974		7.36	6.14	0.0	1.21	-	7.35	0.01	-	-

REMARKS: Layout is to scale as of 1934.

PREPARED BY
TRANSPORTATION & TRANSIT PLANNING & PROGRAMMING DIVISION
IN COOPERATION WITH
U.S. DEPARTMENT OF TRANSPORTATION-BUREAU OF PUBLIC ROADS

STATE OF MINNESOTA
DEPARTMENT OF HIGHWAYS
ROAD LIFE STUDIES
CONSTRUCTION PROJECT LOG RECORD

CONTROL SECTION 5622
TRUNK HIGHWAY 106
COUNTY Otter Tail
DISTRICT 4A

LIMITS: Jct. T.H. 29 in Deer Creek - Jct T.H. 10

Ref. Pt. 000+00.000 - 007+00.403

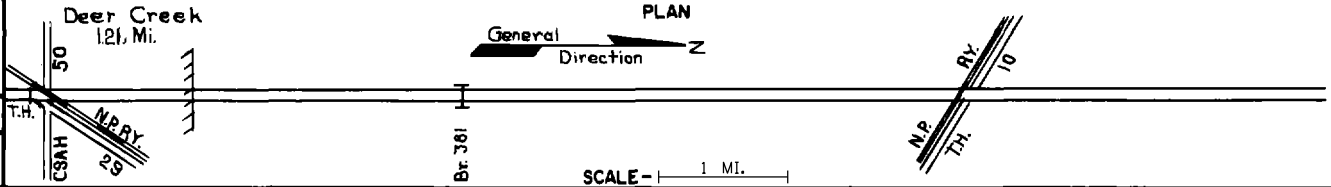

YEAR BUILT	PROJECT NO	DESCRIPTION			REMARKS
		TYPE	WIDTH	THICKNESS	
C	1970 5622-05	Pl. Mix Bit. Resurface	24'40"	1 1/2"	
C	1974 -09	Grading, Agg. Base Pl. Mix Bit. Surf.	24'	1 1/2" 3/4"	
M	1983 SF	Bit. Resurfacing	12'	1 1/2"	Contract # 4000
M	1988 M4296	Bit. Overlay	24'	2"	Spec. 2331
C	1990 5622-12	Grading Bit. Surfacing	Var.	5" 1 1/2"	Spec. 2331 Spec. 2341
M	2006 8824-55	Bit. Seal Coat			
M	2013 8824-85	Rumble Stripes			Profile
C	2018 5622-16	Bit. Mill & Overlay Cold in place recycle As Builts & ADA	var.	3" var.	Bit. surf., widen shldr. to 8' paved w/ agg. base 1.5' add RTL's at Csh 52

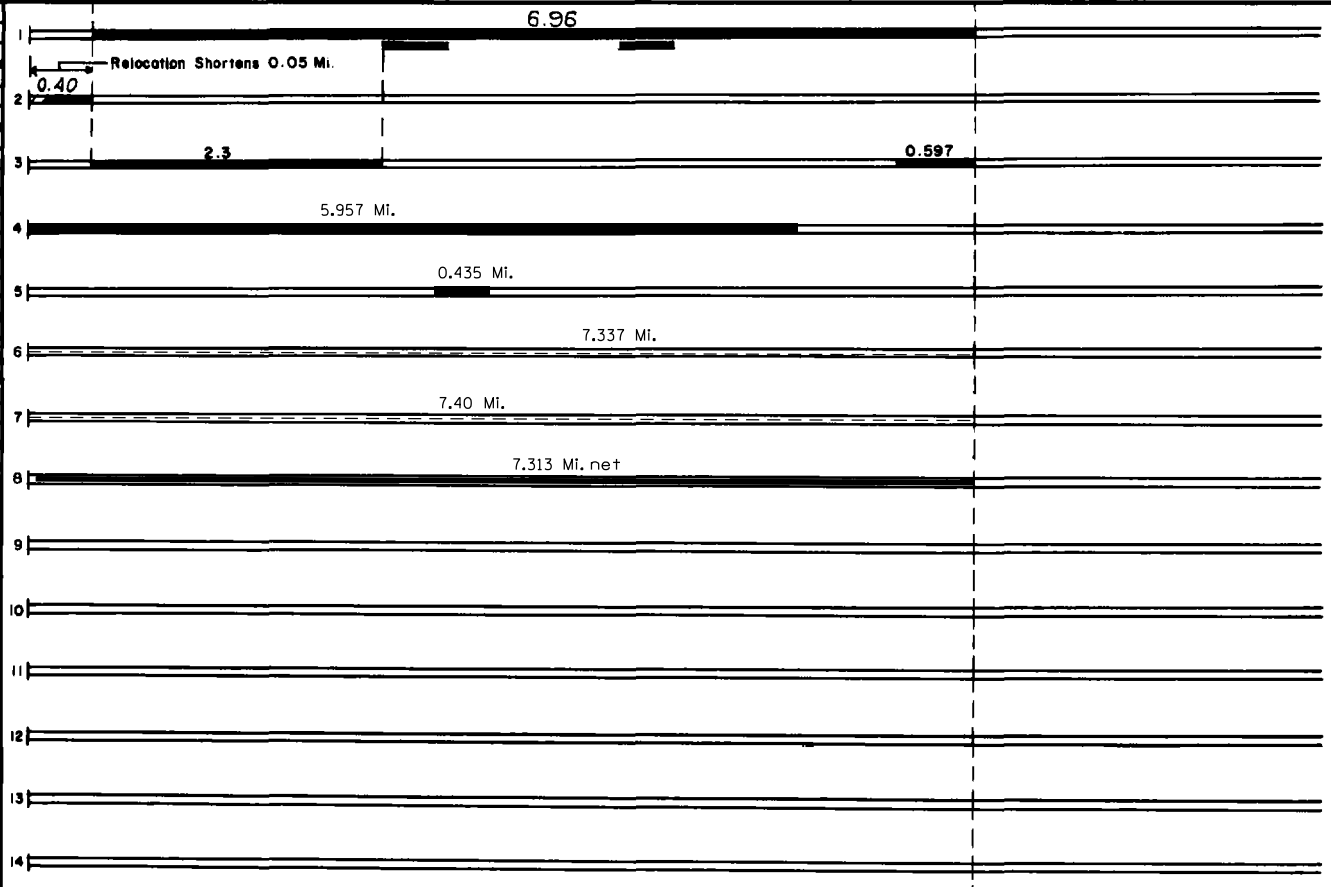

YEARS		TOTAL MILES	UNINCORPORATED		INCORPORATED		RURAL		URBAN	
FROM	TO		RDWY. MI.	BR. MI.	RDWY. MI.	BR. MI.	RDWY. MI.	BR. MI.	RDWY. MI.	BR. MI.

REMARKS: See Sheet No. 1