

PREPARED BY
HIGHWAY PLANNING SURVEY
IN COOPERATION WITH
U.S. PUBLIC ROADS ADMINISTRATION

STATE OF MINNESOTA
DEPARTMENT OF HIGHWAYS
ROAD LIFE STUDIES
CONSTRUCTION PROJECT LOG RECORD

CONTROL SECTION 5610
TRUNK HIGHWAY 29
COUNTY Otter Tail
DISTRICT 4A

LIMITS: Jct. T.H. 106 in Deer Creek - E. Co. Line.

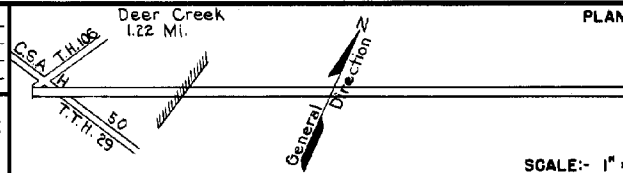

YEAR BUILT	PROJECT N ^o	DESCRIPTION				CODE N ^o
		TYPE	WIDTH	THICKNESS	REMARKS	
		Earth	20' 24"		No Record of Constr.	
1928		Gravel	20' 30"	3/4"	300 C.Y./Mile. Maint. Dept.	
1933	29-29-24-2A	Grading Gravel Br. 6080	32' 30'	2"	1200 C.Y./Mile. W 106 D	
1935	29-29-24-2A	Tar Tr. Gravel	24'	1"	21730 Gal./Mile. Maint. Dept.	
M	1940 A.F.E. 16	Bit Seal Coat			Tar 3518 Gal./Mi. Agg. 79 C.Y./Mi. Maint. Dept.	
M	1941 A.F.E. 29	Subgrade Corr. & Grade Lifts in Spots			Maint. Dept.	
M	1944 A.F.E. 5	Bit Seal Coat	24'		RC3, 2739 Gal./Mi. Agg. 239 C.Y./Mi. Maint. Div.	
C	1945 5610-02	Gravel Base Bit Surf. Treat. (Mixed Prime)	37' 32'	6"	(2) MC1or2, 100 Gal./SqYd	
C	1947 A.F.E. 18	Bit Surfacing Mixed Bit.	24'	1"	MC3, 74194 Gal. Agg. 6384 Tons	
M	1950 A.F.E. 4	Bit. Fog Seal	24'		RC3-1, 12340 Gal. Agg. 453 C.Y.	
M	1953 A.F.E. 605	Bit Sand Seal (Spot)	27'		MC3, 11516 Gal. Agg. 368 C.Y.	
C	1954 5610-03	Spot Base Repair Plant Mix Bit.	24'	2" added		
C	1960	Concrete Cattle Pass			By Maint. Dist.	
M	1964 c	Light Bit. Seal	25'		RS-2K, 15945 Gal. Agg. 558 C.Y.	

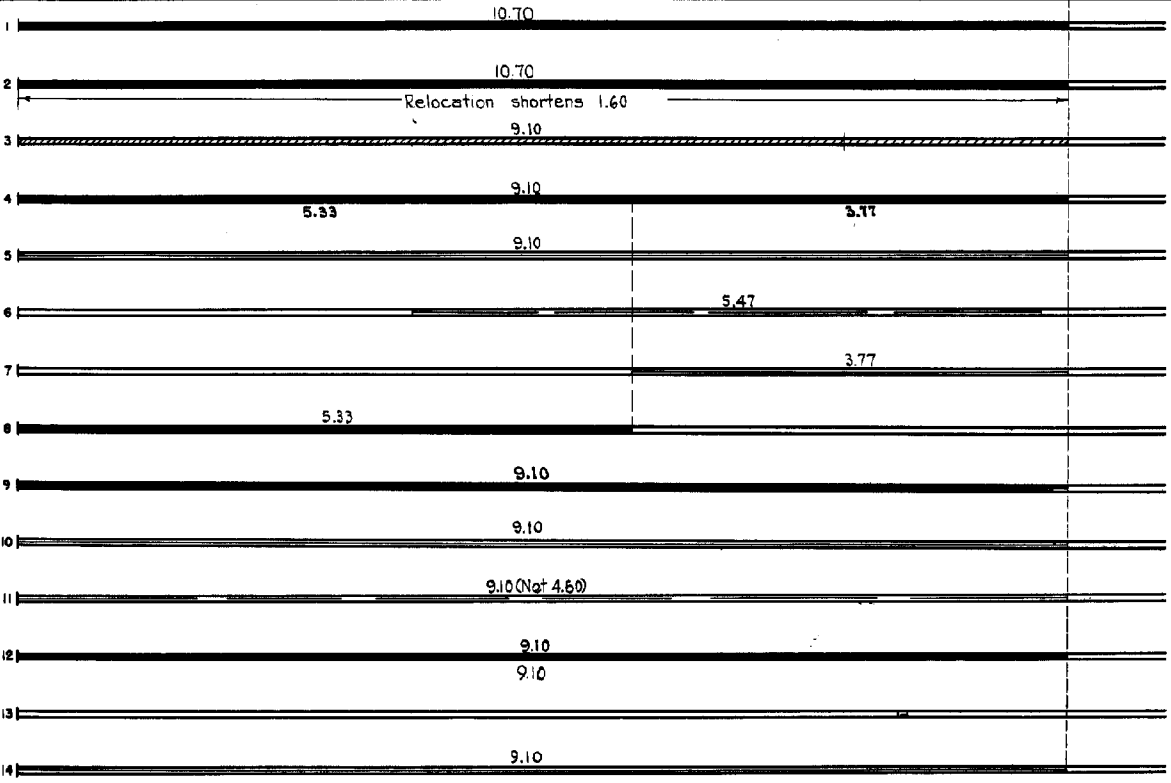

YEARS		TOTAL MILES	UNINCORPORATED		INCORPORATED		RURAL		URBAN	
FROM	TO		RDWY. MI.	BR. MI.	RDWY. MI.	BR. MI.	RDWY. MI.	BR. MI.	RDWY. MI.	BR. MI.
1921	1932	10.70	9.20	0.00	1.50	0.00	10.70	0.00	0.00	0.00
1933		9.10	7.82	0.00	1.28	0.00	9.10	0.00	0.00	0.00
1974		9.04								

REMARKS: Layout is to scale as of 1935.

(1) This work not done under this project number but lies within the limits of this project. (2) There were short exceptions on this job and the gravel base thickness varied.

Co. Co.
Otter Tail
Wadena

4-75

PREPARED BY
TRANSPORTATION PLANNING AND PROGRAMMING DIVISION
IN COOPERATION WITH
U.S. DEPARTMENT OF TRANSPORTATION - FEDERAL HIGHWAY ADMINISTRATION

STATE OF MINNESOTA
DEPARTMENT OF HIGHWAYS
ROAD LIFE STUDIES
CONSTRUCTION PROJECT LOG RECORD

CONTROL SECTION 5610
TRUNK HIGHWAY 29
COUNTY Tall
DISTRICT 4A

LIMITS: Jct. I.H. 106 in Deer Creek - E. Co. Line
Ref. Pt. 116+00.654 - 125+00.681

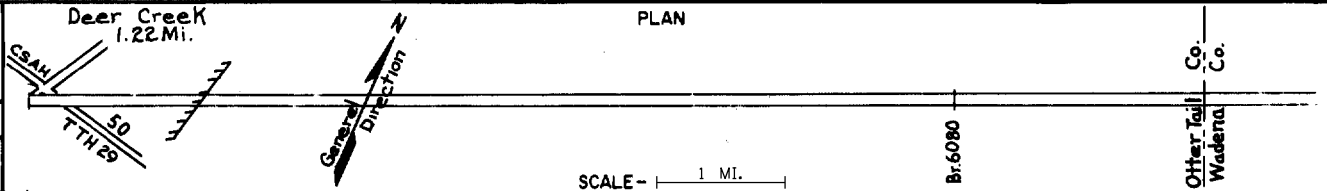

YEAR BUILT	PROJECT NO	DESCRIPTION			
		TYPE	WIDTH	THICKNESS	REMARKS
		Transferred out to C.S. 5609 in 1974			
1974	C -07	Grading, Agg Base	30'	16"	
		Plant Mix Bit. Surf.	24'	3"	
1988	SF	Spot Overlay		1 1/2"	Spec. 2331
				1 1/2"	Spec. 2341
1989	SF	Spot Overlay	24'	1 1/2"	Spec. 2341
1990	5610-10	Grading		6 1/2"	Spec. 2331
		Bit. Surfacing	28'	1 1/2"	Spec. 2341
1991	SF	Bit. Overlay	24'	1 1/2"	Spec. 2331
1992	5610	Bit. Overlay	24'	2"	Spec. 2341
1997	5610-12	Bit. Overlay	28'	1 1/2"	Spec. 2331
2011	5610-13	Milling	28'	3"	
		Bit. Overlay	32'	3"	Spec 2360
		Comb. Shldr's - Bit.	4'	3"	Agg. Cl-1, 1'-var wide
2017	8824-136	Rumble Strips			
		Centerline			
2019	8824-153	Bit. Sealcoat	24'		

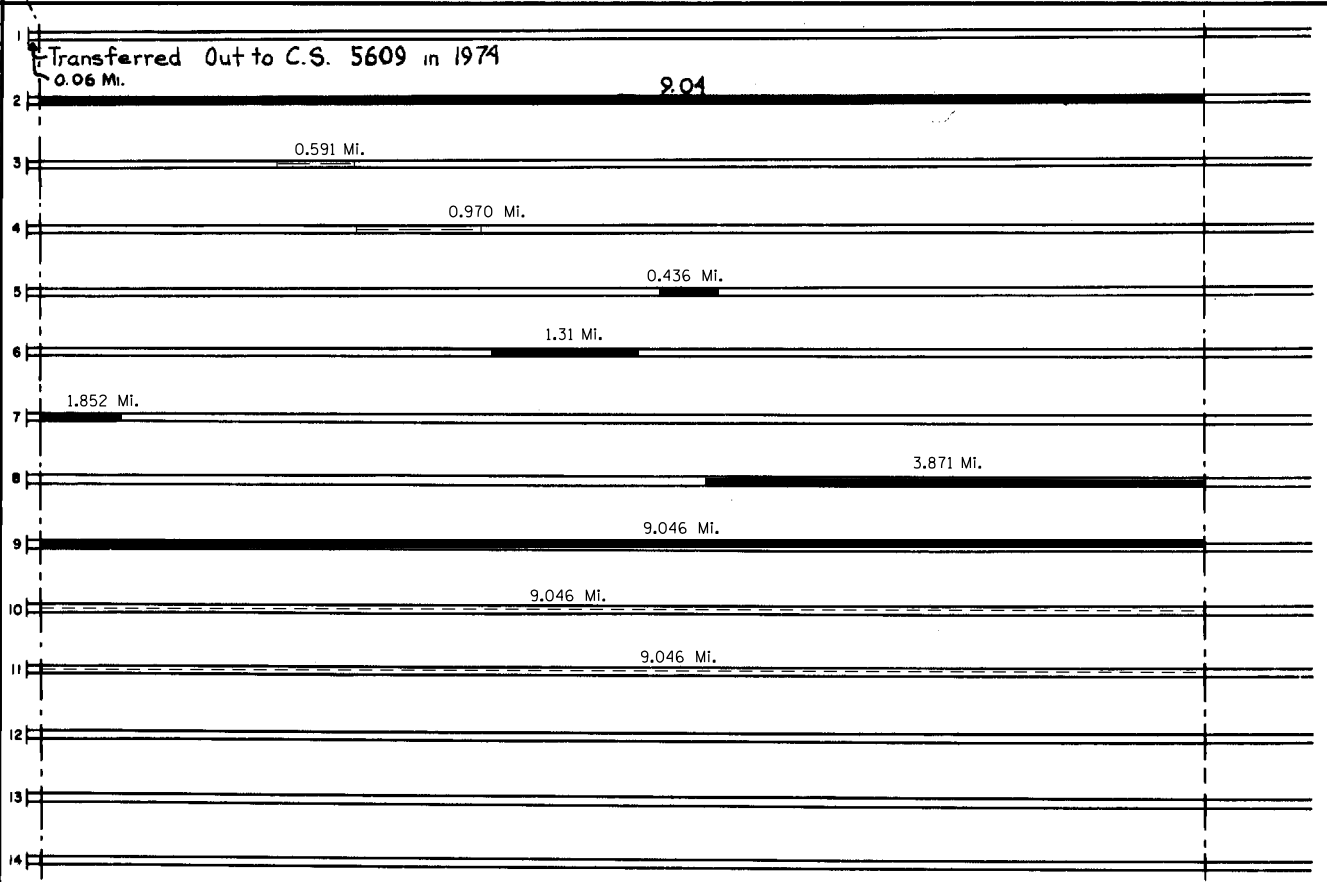

YEARS		TOTAL MILES	UNINCORPORATED		INCORPORATED		RURAL		URBAN	
FROM	TO		RDWY. MI.	BR. MI.	RDWY. MI.	BR. MI.	RDWY. MI.	BR. MI.	RDWY. MI.	BR. MI.

REMARKS: See Sheet No. 1