

PREPARED BY  
HIGHWAY PLANNING SURVEY  
IN COOPERATION WITH  
U.S. PUBLIC ROADS ADMINISTRATION

STATE OF MINNESOTA  
DEPARTMENT OF HIGHWAYS  
ROAD LIFE STUDIES  
CONSTRUCTION PROJECT LOG RECORD

CONTROL SECTION 5510  
TRUNK HIGHWAY 63  
COUNTY Olmsted  
DISTRICT 6A

LIMITS: Jct. T.H. 14 at S. Corp. Limits of Rochester - N. Co. Line.

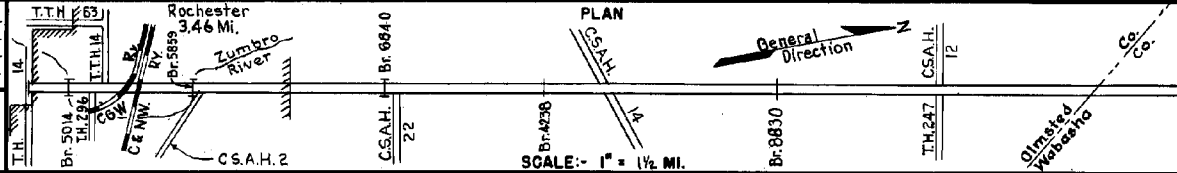

YEAR BUILT	PROJECT N°	DESCRIPTION			CODE N°
		TYPE	WIDTH	THICKNESS	
		Wood Block	70		No Record of Constr.
		Bit. Concrete Concrete Base	40		No Record of Constr.
1924	63-59-22A	Grading Br. 4238, 4238, 1511, 6205 & 6206	23		40' B.S. W108D. 12' B.S. & 2'-W105D.
1924	63-59-23	Br. 4138	20		195' L.T.
1926	63-59-22A	Gravel	24'	5 1/2"	1600 C.V./Mile.
1930	63-59-22A	Oil Tr. Gravel	22'	1 1/2"	11979 Gal./Mile. Maint. Dept.
		Block Pavement (Wood)	N.W.		No Record of Constr. Transferred from T.H. 14 in 1931.(2)
1931	63-59-27-1A	Grading	40'		Not used as T.H. until 1932.
1931	63-59-27-1B	Grading Br. 5014	60'	40'	Not used as T.H. until 1932. 160' C.D.G.
1932	63-59-27-1A&B	Oil Tr. Gravel			15800 Gal./Mile. Maint. Dept.
1933	63-59-27-1A&B	Concrete	40'	9-7-9	
1935	63-59-27-1A&B	Roadside Development			
1938	63-59-28	Concrete on old Conc. Base	70'	5" / 6"	Spec. Agree with city for portion out side of center 20'
1938		Concrete	30'	7 1/2"	Widening by city. 15' R.L. & L.T.

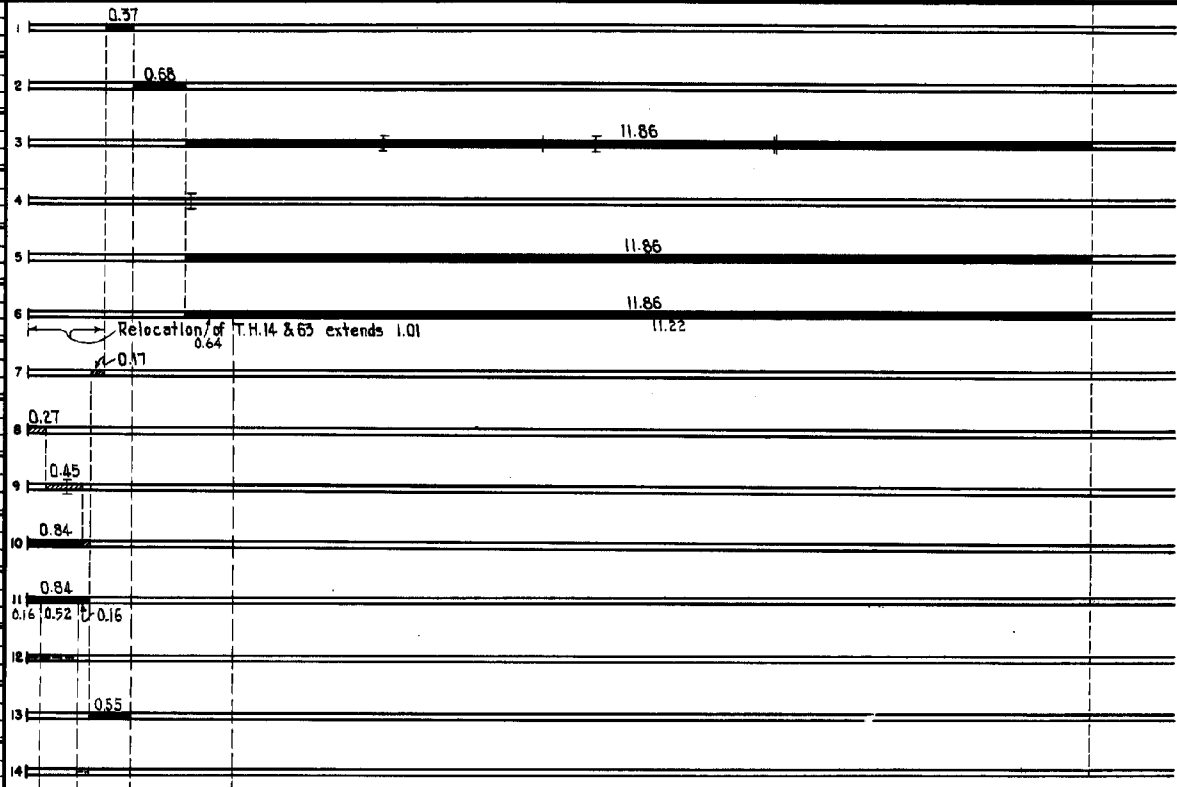

YEARS FROM	TO	TOTAL MILES	UNINCORPORATED		INCORPORATED		RURAL		URBAN	
			RDWY. MI.	BR. MI.	RDWY. MI.	BR. MI.	RDWY. MI.	BR. MI.	RDWY. MI.	BR. MI.
1924	1931	7.31	11.4	0.0	1.45	0.04	11.4	0.0	1.45	0.04
1932	1940	8.97	11.4	0.0	2.45	0.07	11.4	0.0	2.45	0.07
1941	1953	13.85	11.32	0.0	2.45	0.07	11.32	0.0	2.45	0.07
1954	1960	6.59	11.06	0.0	2.45	0.07	11.06	0.0	2.45	0.07
1961	1961	3.59	10.51	0.0	3.00	0.07	10.51	0.0	3.00	0.07
1962		13.59	10.12	0.0	3.39	0.07	10.12	0.0	3.39	0.07

REMARKS: Layout is to scale as of 1932.  
 (1) This work not done under these project numbers but lies within the limits of these projects.  
 (2) Not used as T.H. 63 until 1932.









