

PREPARED BY  
HIGHWAY PLANNING SURVEY  
IN COOPERATION WITH  
U.S. PUBLIC ROADS ADMINISTRATION

STATE OF MINNESOTA  
DEPARTMENT OF HIGHWAYS  
ROAD LIFE STUDIES  
CONSTRUCTION PROJECT LOG RECORD

CONTROL SECTION 5005  
TRUNK HIGHWAY 56  
COUNTY MONROE  
DISTRICT 6B

LIMITS Jct. C.S.A.H. 46 (Old T.H. 16) - E. Co. Line

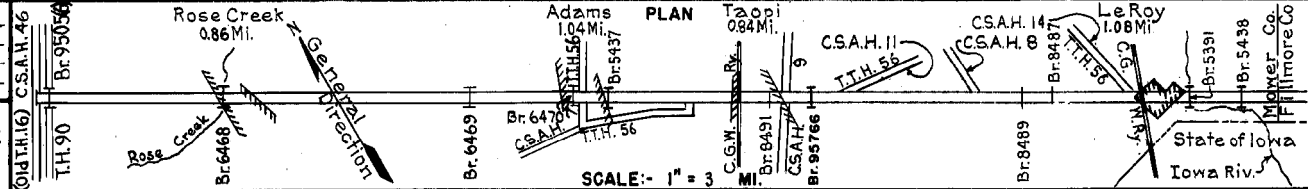

YEAR BUILT	PROJECT N°	DESCRIPTION			CODE N°
		TYPE	WIDTH	THICKNESS	
		Gravel	18'30"	1 1/2"	No Record of Constr.
		5 Bridges (1)	16'24"		Added in 1934.
		Gravel	24'	1 1/2"	No Record of Constr.
					Added in 1934.
1920		Gravel	24'	2 1/2"	Co. Job 2003. 1200 C.Y./Mile. Added in 1934.
1923		Gravel	22'	3"	Co. Job 2307. 1200 C.Y./Mile. 90' H.T.
1930		Gravel	24'	2 1/2"	Co. Job 3001. Added in 1934. 1200 C.Y./Mile. 6 B.S. 80' H.T. & 170' H.T. B.S.
1931		Oil Tr. Gravel	18'	1 1/2"	Co. Job 3104. 7 Bridges (2) Added in 1934.
1934		Oil Tr. Gravel	16'58"	1"	3212 Gal./Mile. Maint. Dept.
		Oil Tr. Gravel	55'	1"	No Record of Constr. Taken over in 1935.
		Gravel	58'	2"	No Record of Constr. Taken over in 1935.
1935	56-81-21-1A	Grading	28'		75' L.T.
1935	56-81-22A	Grading	26'		255' L.T. 40' B.S.
1936	56-81-21-1A	Gravel	24'	2"	1400 Tons/Mile.
1936	56-81-22A	Gravel	24'	2 1/4"	1500 Tons/Mile.
1936	56-81-21-1A (3)	Oil Tr. Gravel	24'	1"	Maint. Dept.

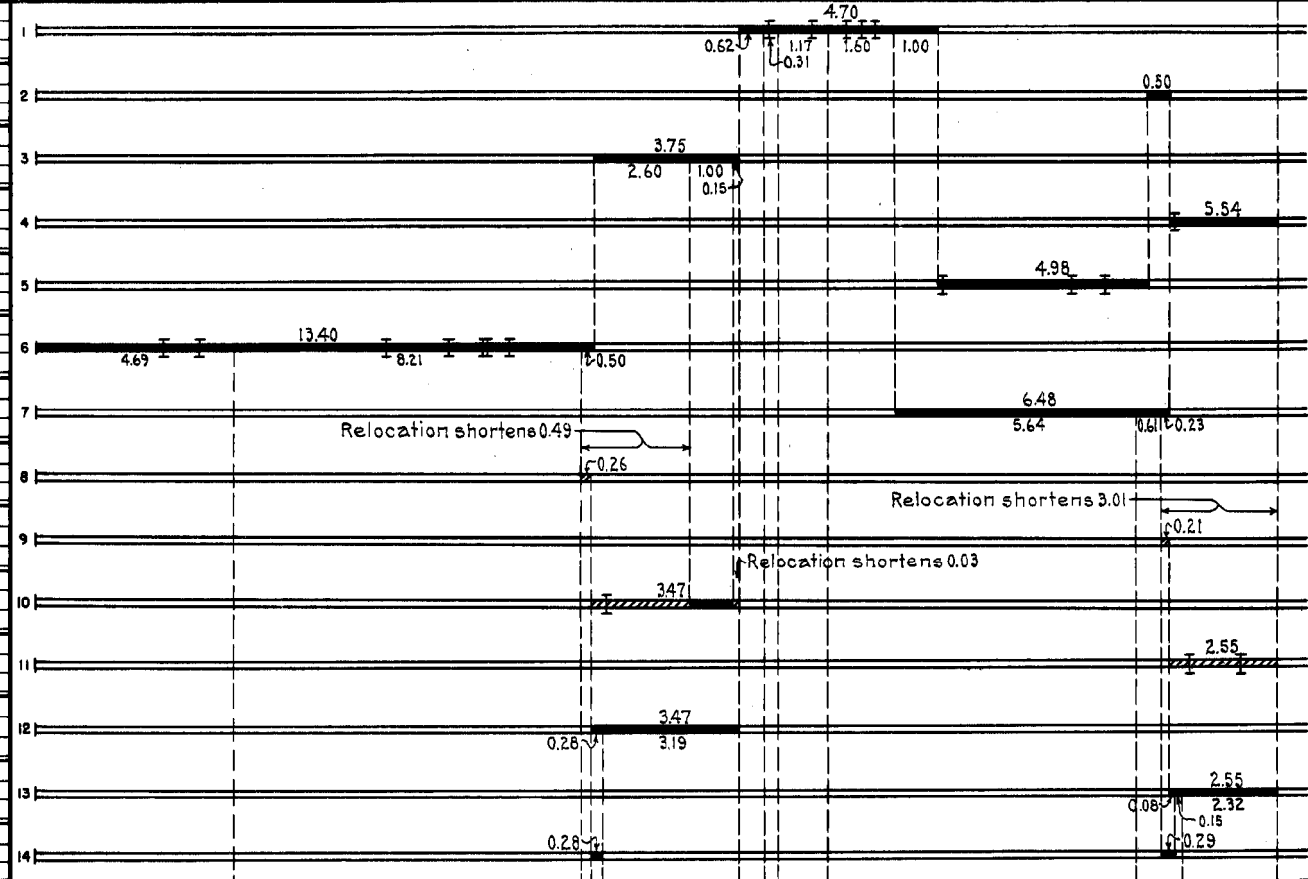

YEARS FROM	TO	TOTAL MILES	UNINCORPORATED		INCORPORATED		RURAL		URBAN	
			RDWY. MI.	BR. MI.	RDWY. MI.	BR. MI.	RDWY. MI.	BR. MI.	RDWY. MI.	BR. MI.
1934	1934	32.87	28.58	0.12	4.16	0.01	32.74	0.13	0.00	0.00
1935	1935	25.34	25.42	0.18	3.73	0.01	29.15	0.19	0.00	0.00
1940	1944	27.98	23.85	0.13	3.70	0.00	27.55	0.13	0.00	0.00
1945	1948	27.72	23.89	0.13	3.70	0.00	27.59	0.13	0.00	0.00
1949	1949	25.84	22.25	0.10	3.48	0.01	25.73	0.11	0.00	0.00
1950	1956	27.15	23.25	0.09	3.79	0.02	27.04	0.11	0.00	0.00
1957	1958	27.16	23.25	0.09	3.80	0.02	27.05	0.11	0.00	0.00

REMARKS: Layout is to scale as of 1935  
 (1) Br. 739, 28' B.S.; Br. 737, 24' B.S.; Br. 975, 26' B.S.; Br. 2232, 17' C.S.; & Br. 4866, 35' B.S.; (2) Br. 2276, 50' C.T.G.; Br. 8216, 14' W.S.; Br. 3141, 40' C.T.G.; Br. 4570, 23' B.S.; Br. 2532, 24' C.S.; Br. 738, 30' B.S.; & Br. 6147, 45' L.T. (3) This work not done under these project numbers but lies within the limits of these projects. (4) Br. 8489, C(11-14-11) BT; W86; Br. 8509, W106; Br. 8508, W106; W64; W64; Br. 8487, C106D; & Br. 8491, C106T. (5) 1" X 53 bit surf on 4" X 53 at ab. gravel base for 3/4 Mi. in Taopi; Balance 1" X 26 bit surf. with 5" sand-gravel shoulders Rt. & Lt. (6) Bridge 9505 is a 20' B.S. T.H. 56 over T.H. 90 see C.S. 5080.

PREPARED BY  
HIGHWAY PLANNING SURVEY  
IN COOPERATION WITH  
U.S. PUBLIC ROADS ADMINISTRATION

STATE OF MINNESOTA  
DEPARTMENT OF HIGHWAYS  
ROAD LIFE STUDIES  
CONSTRUCTION PROJECT LOG RECORD

CONTROL SECTION 5005  
TRUNK HIGHWAY 56  
COUNTY Mower  
DISTRICT 6B

LIMITS: Jct. C.S.A.H. 46 (Old T.H.16) - E. Co. Line

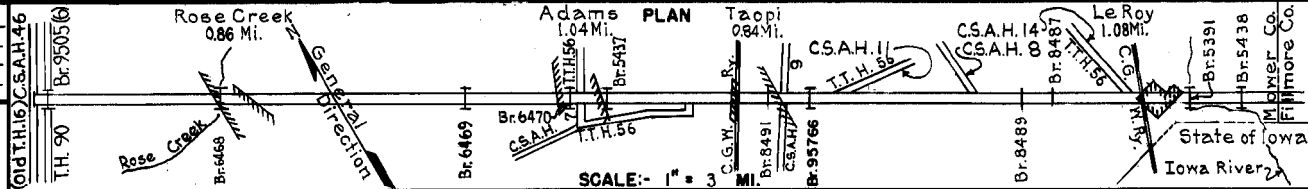

YEAR BUILT	PROJECT N°	DESCRIPTION			CODE N°
		TYPE	WIDTH	THICKNESS	
1939	A.F.E.14	Mixed Bit.	26'	1"	
					Maint. Dept.
C	5005-03	8 Mono Culv. (4)			
1940	5005-09	Br. 5913	27'		72' B.S.
C		Grading	60'		
1940	5005-04	Selected Matl.	60'	16"24"	
C		Grading	36'		
1940	5005-04	Selected Matl.	36'	16"	
C	5005-05				
1940	5005-06	Xing Signals			
C	A.F.E.63				
1940	5005-15	Seeding			Maint. Dept.
C					
1940	A.F.E.75	Mixed Bit.	60'	1"	
					Maint. Dept.
C					
1940	A.F.E.75	Mixed Bit.	26'	1"	
					Maint. Dept.
M					SC 2 & 3, 1825 Gal./Mi.
1940	A.F.E.22	Bit Retreat			Grav. 32 C.Y./Mi. Maint. Dept.
M					SC 3, 2508 Gal./Mi.
1941	A.F.E.14	Bit Retreat	26'		Grav. 116 C.Y./Mi. Maint. Dept.
M					SC 2 & 3, 3273 Gal./Mi.
1941	A.F.E.15	Bit Retreat	22'		Grav. 72 C.Y./Mi. Maint. Dept.
C		(5)			
1941	5005-19	Mixed Bit.	26 1/2'	1"	
M		Spot Treat.			Bit. 1792 Gal./Mi.
1942	A.F.E.16	Bit Surf Repair	22 1/2'		
	A.F.E.4				Maint. Dept.
M					RT 10, 2499 Gal./Mi.
1942	A.F.E.5	Bit Seal Coat	26'		Grav. 23 C.Y./Mi. Maint. Dept.

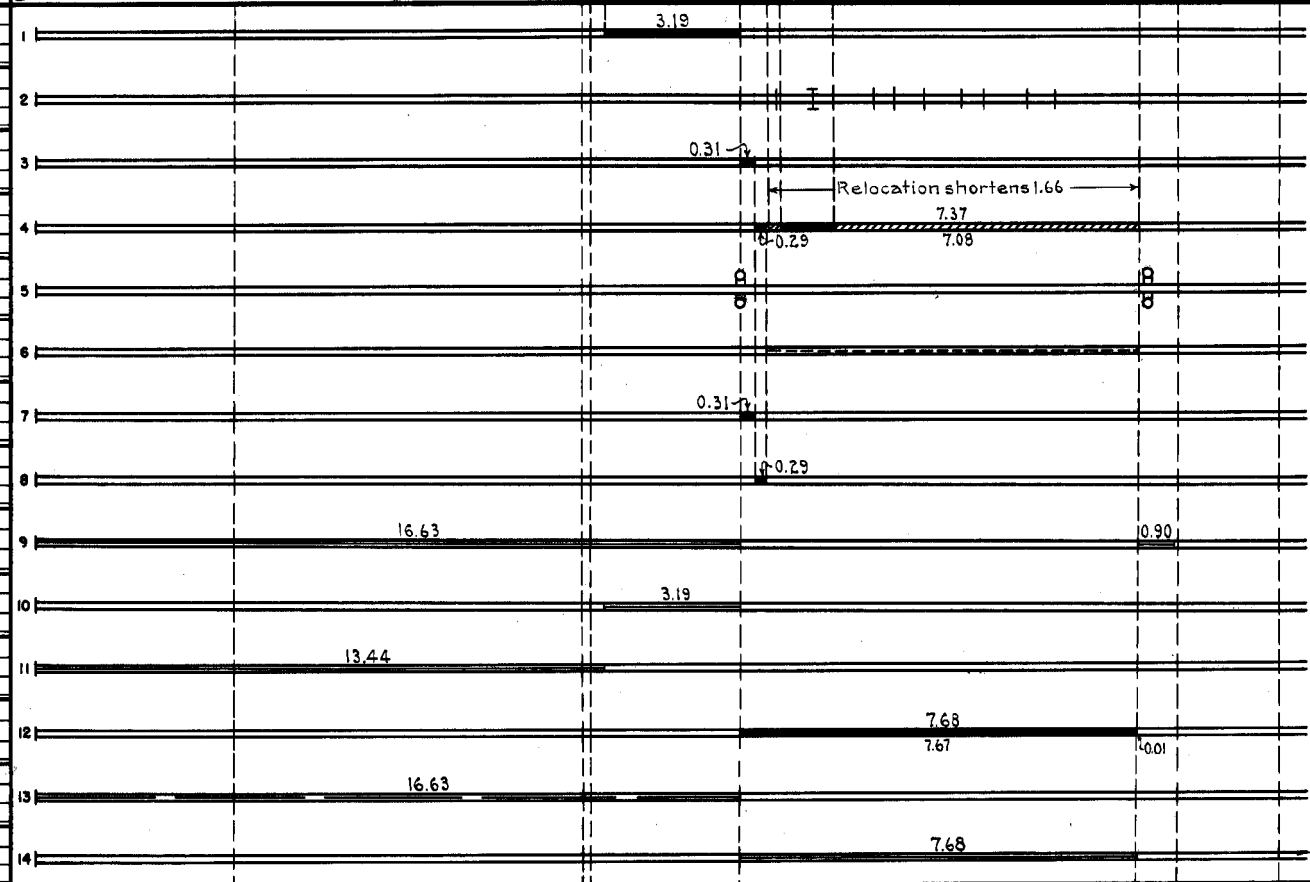

YEARS		TOTAL MILES	UNINCORPORATED		INCORPORATED		RURAL		URBAN	
FROM	TO		RDWY. MI.	BR. MI.	RDWY. MI.	BR. MI.	RDWY. MI.	BR. MI.	RDWY. MI.	BR. MI.
1959	1960	27.16	23.07	0.09	3.98	0.02	27.05	0.11	0.00	0.00
1960	1961	27.16	23.25	0.09	3.80	0.02	27.05	0.11	0.00	0.00
1962		27.16	23.23	0.11	3.80	0.02	27.03	0.13	0.00	0.00

REMARKS: See Sheet N°1

PREPARED BY  
HIGHWAY PLANNING SURVEY  
IN COOPERATION WITH  
U.S. PUBLIC ROADS ADMINISTRATION

STATE OF MINNESOTA  
DEPARTMENT OF HIGHWAYS  
ROAD LIFE STUDIES  
CONSTRUCTION PROJECT LOG RECORD

CONTROL SECTION 5005  
TRUNK HIGHWAY 56  
COUNTY Mower  
DISTRICT 65

LIMITS: Jct. C.S.A.H. 46 (Old T.H. 16) - E. Co. Line

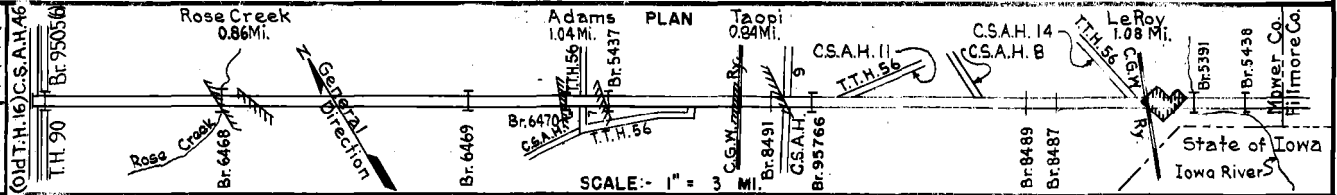

YEAR BUILT	PROJECT N <sup>o</sup>	DESCRIPTION			CODE N <sup>o</sup>
		TYPE	WIDTH	THICKNESS	
M 1942	A.F.E. 6	Spot Graveling			
M 1943	A.F.E. 4	Spot Treat Bit. Surf. Repair	20' 24"		
M 1943	A.F.E. 6	Grav. Resurface (Spots)			
M 1944	A.F.E. 4	Spot Treat Bit. Surf. Repair	22' 24"		
C 1945	5005-20	Grading Cr. Rock Base	28'	6"	
M 1945	A.F.E. 4	Spot Treat Bit. Surf. Repair	22' 24"		
M 1946	A.F.E. 4	Spot Treat Bit. Surf. Repair & Seal Coat	21' 16"		
C 1946	5005-32 A.F.E. 7	Mixed Bit Seeding	16'	1 1/2"	
M 1947	A.F.E. 4	Spot Treat Bit. Surf. Repair			
C 1947	A.F.E. 18	Grav. Lifts (Spots) Bit. Resurfacing Mixed Bit.	24'	1" added	
M 1948	A.F.E. 4 A.F.E. 5	Spot Treat Bit. Surf. Repair Bit. Seal Coat	20' 26'		
C 1948	5005-31	Concrete	22' 5' 9"	9"	
M 1949	A.F.E. 4	Spot Treat Bit. Surf. Repair	24'		
C 1949	5005-24 5005-26	Grading Sand-Gravel Br. 8702, 8469, 8470	32' 56" 32' 56" 30'	12"	

1					2.47
2			16.63		
3					2.47
4			16.63		
5				Lengthens 0.04 Mi. due to former error	2.36
6				24.31	
7			16.63 (Net 6.45)	Bit Surf. Repair → Seal	7.68
8					1.36
9			13.16 (Net 6.69)		
10				3.47	
11			15.70 (Net Repair 7.10)		2.36 (Seal)
12					1.06
13			16.63 (Net 6.95)		
14			0.03	Relocation shortens 1.88 6.33	

YEARS FROM	TOTAL TO	MILES	UNINCORPORATED		INCORPORATED		RURAL		URBAN	
			RDWY. MI.	BR. MI.	RDWY. MI.	BR. MI.	RDWY. MI.	BR. MI.	RDWY. MI.	BR. MI.

REMARKS: See Sheet No. 1  
 @ 0.03 mi. not in use until Br. 6468 is completed.

PREPARED BY  
HIGHWAY PLANNING SURVEY  
IN COOPERATION WITH  
U. S. PUBLIC ROADS ADMINISTRATION

STATE OF MINNESOTA  
DEPARTMENT OF HIGHWAYS  
ROAD LIFE STUDIES  
CONSTRUCTION PROJECT LOG RECORD

CONTROL SECTION 5005  
TRUNK HIGHWAY 56  
COUNTY Mower  
DISTRICT 6B

LIMITS: Jct. C.S.A.H. 46 (Old T.H. 16) - E. Co. Line

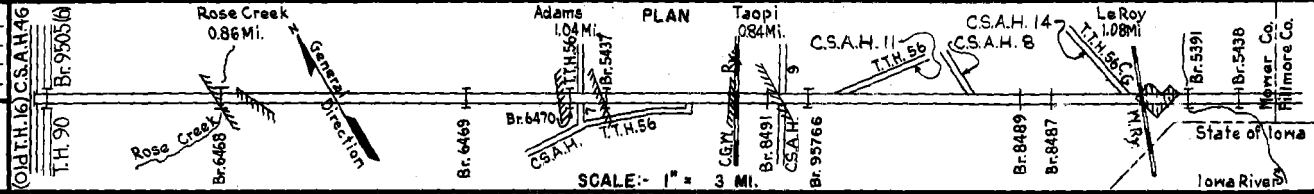

YEAR BUILT	PROJECT N°	DESCRIPTION			CODE N°
		TYPE	WIDTH	THICKNESS	
C	5005-33	Grading	32'		
1949	5005-33	Sand-gravel Br. 8726	32'	12"	Not in use until Br. 6468 is built. C106D x 41'
M	A.F.E. 4	Spot Treat. Bit. Surf. Repair	24'		MC2#563, 22121 Gal. Agg. 1076 C.Y.
1950	A.F.E. 4	Spot Treat. Bit. Surf. Repair	24'		MC2#563, 22121 Gal. Agg. 1076 C.Y.
C	5005-21	Grading (3.76 Mi.)	36'	9'-12"	Br. 6468 (60'x30' C.D.G.) Ext. W. 44
1950	5005-21	Gravel Base (3.76 Mi.)	36'	9'-12"	Ext. W. 44
(7)	5005-25	Plant Mix Bit.	24'	2'-3"	
C	5005-27	Cr. Rock Base	30'	3"	added Base
1951	5005-27	Plant Mix Bit.	24'	1 1/2"	
M	A.F.E. 4	Spot Treat. Bit. Surf. Repair	24'		MC3, 10408 Gal. Agg. 600 C.Y.
1951	A.F.E. 4	Spot Treat. Bit. Surf. Repair	24'		MC3, 10408 Gal. Agg. 600 C.Y.
M	A.F.E. 4	Spot Treat. Bit. Surf. Repair	24'		RS-2#MC2, 33471 Gal. Agg. 1046 C.Y.
1952	A.F.E. 4	Spot Treat. Bit. Surf. Repair	24'		RS-2#MC2, 33471 Gal. Agg. 1046 C.Y.
A.F.E. 5		Light Bit. Seal	24'		
M	A.F.E. 604	Spot Treat. Bit. Surf. Repair	24'		MC2 & RC2, 22982 Gal. Agg. 896 C.Y.
1953	A.F.E. 604	Spot Treat. Bit. Surf. Repair	24'		MC2 & RC2, 22982 Gal. Agg. 896 C.Y.
A.F.E. 605		Light Bit. Seal (597 Mi.)	24'		
M	A.F.E. 604	Spot Treat. Bit. Surf. Repair	24'		MC2, 14249 Gal. Agg. 1075 Tons
1954	A.F.E. 604	Spot Treat. Bit. Surf. Repair	24'		MC2, 14249 Gal. Agg. 1075 Tons
M	A.F.E. 604	Spot Treat. Bit. Surf. Repair	24'		MC2, 25020 Gal. Agg. 1831 Tons
1955	A.F.E. 604	Spot Treat. Bit. Surf. Repair	24'		MC2, 25020 Gal. Agg. 1831 Tons
C	5005-37	Widening Gravel Base	20'	6"	16' Rt. & Lt. on 6" Salv. Sub-base
1957	5005-37	Widening Gravel Base	20'	6"	16' Rt. & Lt. on 6" Salv. Sub-base
C	5005-38	Cr. Rock Base (9.72 Mi.)	34'	4'-8"	Added thickness
1957	5005-38	Cr. Rock Base (9.72 Mi.)	34'	4'-8"	Added thickness
M	A.F.E. 604	Spot Treat. Bit. Surf. Repair	24'		MC2, 18764 Gal. Agg. 1428 Tons
1957	A.F.E. 604	Spot Treat. Bit. Surf. Repair	24'		MC2, 18764 Gal. Agg. 1428 Tons
M	A.F.E. 604	Spot Treat. Bit. Surf. Repair	24'		MC-2, 4340 Gal. Agg. 348 Tons
1959	A.F.E. 604	Spot Treat. Bit. Surf. Repair	24'		MC-2, 4340 Gal. Agg. 348 Tons
M	1961	Light Bit. Seal	25'		RS-2, 27269 Gal. Agg. 930 C.Y.
1961	1961	Light Bit. Seal	25'		RS-2, 27269 Gal. Agg. 930 C.Y.

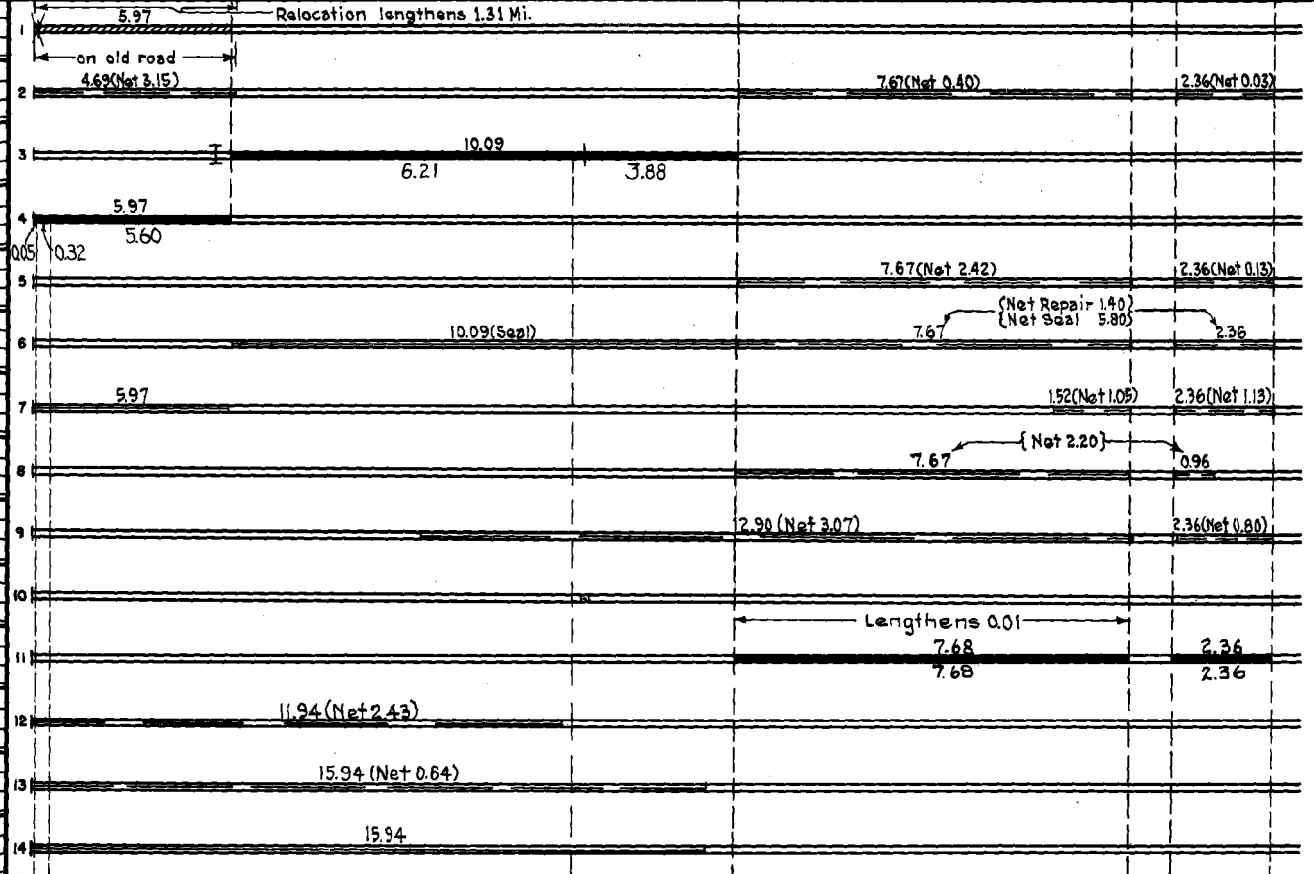

YEARS FROM	TOTAL MILES TO	UNINCORPORATED		INCORPORATED		RURAL		URBAN	
		RDWY. MI.	BR. MI.	RDWY. MI.	BR. MI.	RDWY. MI.	BR. MI.	RDWY. MI.	BR. MI.

REMARKS: See Sheet No. 1  
(7) Contract not final on S.P. 5005-21 but work substantially complete in 1950.

PREPARED BY  
TRAFFIC AND PLANNING DIVISION  
IN COOPERATION WITH  
U.S. DEPARTMENT OF COMMERCE  
BUREAU OF PUBLIC ROADS

STATE OF MINNESOTA  
DEPARTMENT OF HIGHWAYS  
ROAD LIFE STUDIES  
CONSTRUCTION PROJECT LOG RECORD

CONTROL SECTION 5005  
TRUNK HIGHWAY 56  
COUNTY Mower  
DISTRICT 6B

LIMITS: Jct. C.S.A.H. 46 (Old T.H. 16) - E. Co. Line

Ref. Pt. 003+01.006 - 031+00.167

YEAR BUILT	PROJECT NO	DESCRIPTION			
		TYPE	WIDTH	THICKNESS	REMARKS
C	5080-02&52	Grading Sub-base Gravel & Rd. mix bit base Rd. mix & Plant mix bit.	40'±	5 1/2"	12" Sand-Gravel Sub-base
C&M	1984 C	Plant Mix Bit Grav. Shldr. (728) Light Bit Seal	24'	1 1/2"	Bit. Mix 15733 Tons 2223 Tons RS-2K, 17207 Gal.
M	1966 C	Light Bit Seal	25'		CRS-1 Bit. 7755 Gal. FA-1 Agg. 284 C.Y.
C	1969 5005-44	Pl. Mix. Bit. Surf. Gravel Shoulders	24'-50'	1 1/2"	A' Rt. & Lt.
C	1970 5005-42	Pl. Mix Bit Surface Gravel Shoulders	24'-60'	2 1/4"	6'-8' Right & Left
M	1975 SF	SEAL COAT WITH Agg.	24'	3/8"	RC-800 9185 GAL Poa Rock 617 Ton
M	1980 SF	Spot Bit Overlay	24'	1"	521.88 Ton 78.0 Gal. CSS1H Pl. Mix 2331 Wearing AC-1
C	1981 5005-48 F054-1(34)	Bit. Surfacing Agg. Shoulders	24'	3 1/2"	Pl. Mix Bit - 2331 Class 1-2221
M	1981 5005-SF	Spot Bit Surf. Repair Spot Gravel Shldr. Treatment	24'	1 1/2"	233 Ton AC-1-2331 4575 Ton Topp CSS1H 56 Gal.
M	1981 SF	Bit. Shoulders	8'	1 1/2"	148 Ton Pl. Mix 2331 Fines
M	1983 SF	Spot Bit. Overlays	24'	1 1/2"	Pl. Mix 2331 1186 Ton
C	1983 5005-51 BRC 054-1(31)	Grading Bit. Surfacing B Br. # 95766	44'	3"	7' Agg. Shldr. Rt. B. 1.1 Spec. 2331 Remove Br. # 9913
M	1986 4187	Conc. Repair			
M	1986 SF	Spot Overlay		1 1/4"	Spec. 2341

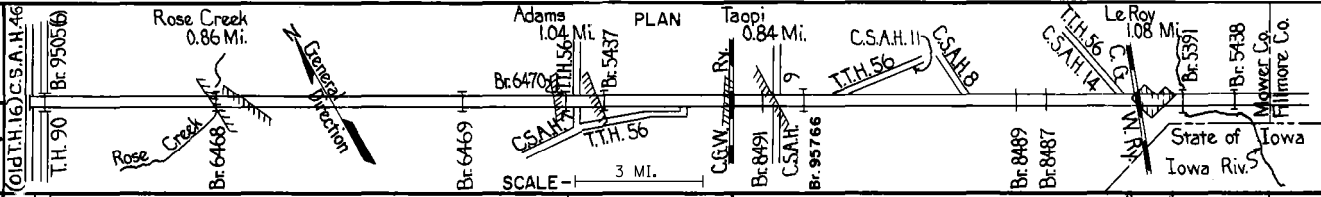

1	0.32			
2	11.81	7.68		2.36
3		3.85		
4			7.68	2.36
5	16.06			
6				2.40
7				18.0 (Net 0.53)
8			8.70	1.14 1.28
9			6.48 (Net 0.3)	
10				0.1
11				Gross 2.3 Mi.
12				
13	1.069 Mi.			
14				0.856 Mi.

YEARS FROM	TOTAL MILES TO	UNINCORPORATED		INCORPORATED		RURAL		URBAN	
		RDWY. MI.	BR. MI.	RDWY. MI.	BR. MI.	RDWY. MI.	BR. MI.	RDWY. MI.	BR. MI.

REMARKS: See Sheet No. 1

