

PREPARED BY
HIGHWAY PLANNING SURVEY
IN COOPERATION WITH
U.S. PUBLIC ROADS ADMINISTRATION

STATE OF MINNESOTA
DEPARTMENT OF HIGHWAYS
ROAD LIFE STUDIES
CONSTRUCTION PROJECT LOG RECORD

CONTROL SECTION 5004
TRUNK HIGHWAY 56
COUNTY Mower
DISTRICT 6B

LIMITS: N. Co. Line - C.S.A.H. 46 (Old T.H. 16)

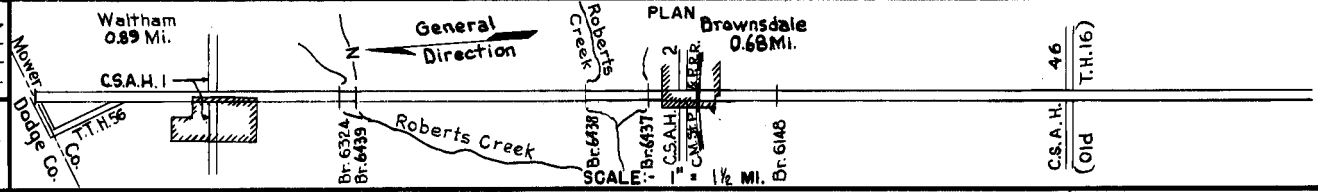

YEAR BUILT	PROJECT N ^o	DESCRIPTION			CODE N ^o
		TYPE	WIDTH	THICKNESS	
		Earth (1)	22		
		Br. 1929, 1930, & M-76	17/16		
1919	56-56-3	Gravel	22	3"	
					40 T.P.G., 30 B.S. 5462
					Co. Job 1903.
1922	56-56-22	Br. 3724	20		40 C.S.
1924	56-56-24	Br. 4331	19		50' L.T.
		Grading	28		
1930	56-56-24-2A	Gravel	24	1 1/4"	600-734 C.Y./Mile.
		Br. 6324			W1010D
		(2)			
1930	56-56-24-2A	Oil Tr. Gravel	24	1"	11360 Gal./Mile.
					Maint. Dept.
		(2)		(3)	
1931	56-56-24-2A	Oil Tr. Gravel	24	1 1/2"	5500 Gal./Mile.
					Maint. Dept.
		Grading	32		
1932	56-56-24-3	Gravel (4)	24	1 1/2"	800 C.Y./Mile.
		Br. 6149, 6148, & 3724	27		W106T, W1010T & 40CS
		(2)			
1933	56-56-24-3	Oil Tr. Gravel	20	1 1/2"	
					Maint. Dept.
1936	56-56-24-3	R.R. X'ing Signal			
M	1940	A.F.E. 21			SC2 & 3, 21656 G./Mi.
		Bit. Retreat.			Grav. 57 C.Y./Mi.
					Maint. Dept.
M	1941	A.F.E. 12			SC3, 2736 Gal./Mi.
		A.F.E. 13			Grav. 72 C.Y./Mi.
					Maint. Dept.
M	1942	A.F.E. 16			Bit. 2016 Gal./Mi.
		A.F.E. 4			
					Maint. Dept.
M	1943	A.F.E. 4			MC2, 2357 Gal./Mi.
		Spot Treat			
		Bit. Surf. Repair			Grav. 40 C.Y./Mi.
					Maint. Dept.

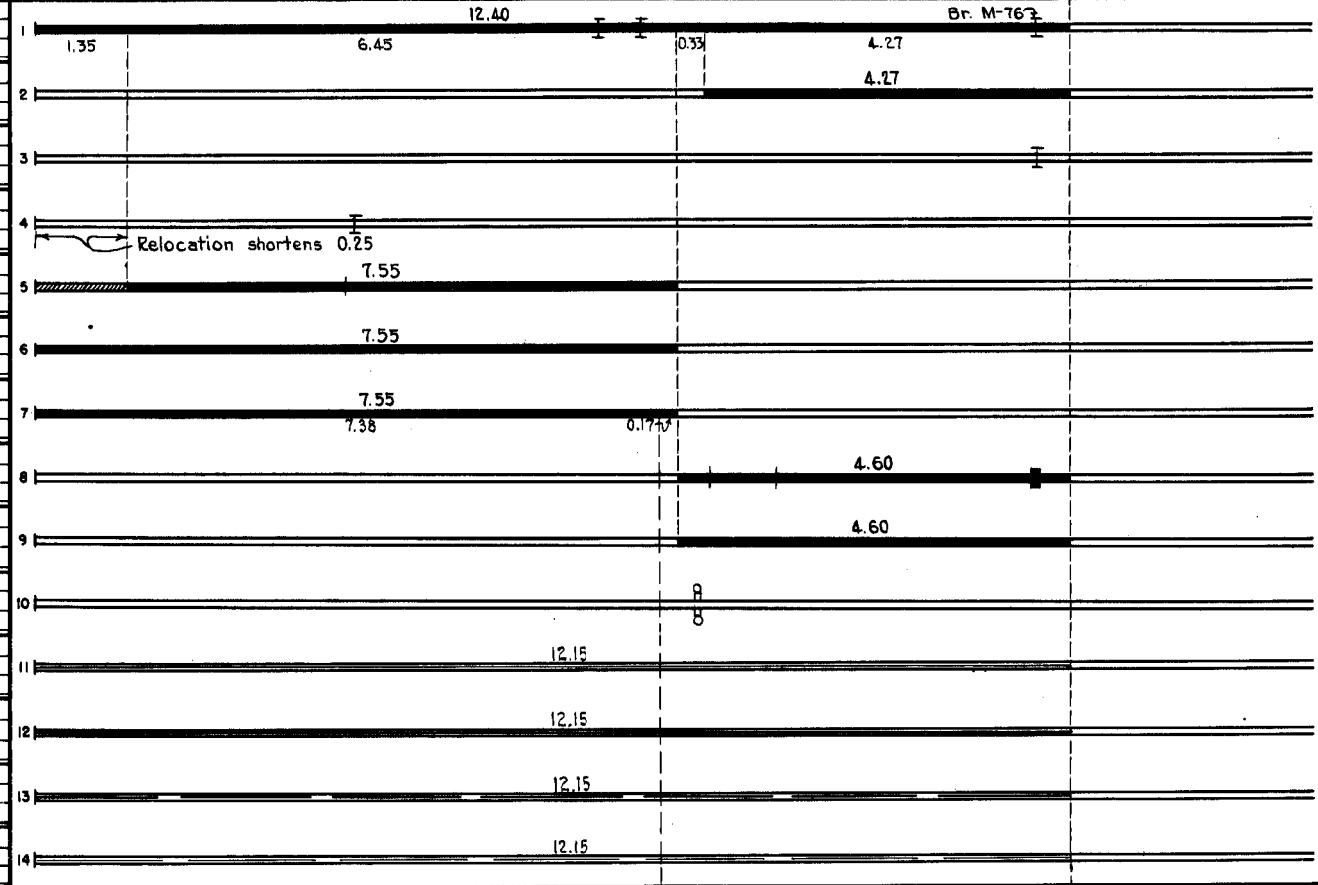

YEARS		TOTAL MILES	UNINCORPORATED		INCORPORATED		RURAL		URBAN	
FROM	TO		RDWY. MI.	BR. MI.	RDWY. MI.	BR. MI.	RDWY. MI.	BR. MI.	RDWY. MI.	BR. MI.
1921	1923	12.40	10.38	0.02	2.00	0.00	12.38	0.02	0.00	0.00
1924	1929	12.40	10.37	0.03	2.00	0.00	12.37	0.03	0.00	0.00
1930	1934	12.15	10.38	0.03	1.74	0.00	12.12	0.03	0.00	0.00
1935	1938	12.18	10.16	0.01	2.01	0.00	12.17	0.01	0.00	0.00
1939	1939	12.18	10.90	0.01	1.27	0.00	12.17	0.01	0.00	0.00
1940	1972	12.18	10.72	0.01	1.45	0.00	12.16	0.02	0.00	0.00
1973		12.18	10.61	0.00	1.57	0.00	12.18	0.00	0.00	0.00

REMARKS: Layout is to scale as of 1930

(1) Br. M-76 built in 1916. (2) This work not done under these project numbers but lies within the limit of these projects

(3) Accumulated thickness. (4) Br. 3724 widened in 1932.

PREPARED BY
HIGHWAY PLANNING SURVEY
IN COOPERATION WITH
U.S. PUBLIC ROADS ADMINISTRATION

STATE OF MINNESOTA
DEPARTMENT OF HIGHWAYS
ROAD LIFE STUDIES
CONSTRUCTION PROJECT LOG RECORD

CONTROL SECTION 5004
TRUNK HIGHWAY 56
COUNTY Mower
DISTRICT 46

LIMITS: N.Co.Line - C.S.A.H. 46 (Old T.H.16)

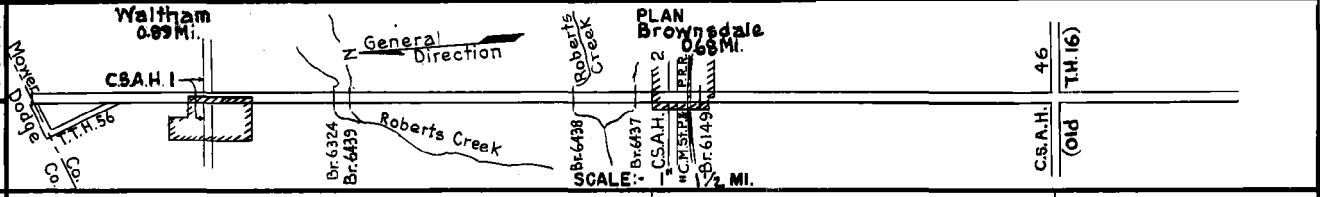

YEAR BUILT	PROJECT N°	DESCRIPTION			CODE N°
		TYPE	WIDTH	THICKNESS	
M	1944 A.F.E. 4	Spot Treat. Bit. Surf. Repair	22'x		
M	1945 A.F.E. 4	Spot Treat. Bit. Surf. Repair	22'x		
C	1945 A.F.E. 18	Bit. Resurfacing Mixed Bit.	22' 1 1/2" added		
M	1946 A.F.E. 4	Spot Treat. Bit. Surf. Repair	25'		
M	1947 A.F.E. 4	Spot Treat. Bit. Surf. Repair	24'		
C	1948 A.F.E. 23	Gravel Base Mixed Bit. (Mixed Prime)	25' 4 3/4" 1 3/4"		
C	1949 A.F.E. 17	Bit. Surfacing Mixed Bit.	22' 1"		
M	1949 A.F.E. 4	Spot Treat. Bit. Surf. Repair	26'		
M	1950 A.F.E. 4	Spot Treat. Bit. Surf. Repair Bit. Seal Coat	24'		
M	1951 A.F.E. 4	Spot Treat. Bit. Surf. Repair Light Bit. Seal (7.38 Mi.)	22' 24'		
C	1952 5004-07	Sand-Grav. Sub-base Crushed Rock Base Plant Mix Bit.	24'x 6" 6" 1 1/2" 2"		
C	1953 5004-03	Grade & Sand-Gr. Sub-base Crushed Rock Base Mixed Bit.	36' 4" 36' 4" 25' 1 1/2" added		
C	1956 5004-09	Plant Mix Bit.	24' 2" added		
M	1957 A.F.E. 605	Bit. Seal Coat	25'		

1	12.15		
2	7.38		
3		4.77	
4	12.15 (Net 4.25)		
5		4.77 (Net 2.52)	
6	7.38		
7	7.38		
8	7.35	0.03	4.77 (Net 2.00)
9	5.25 (Net Repair 1.70) (Seal 3.50)		
10	Seal		17.88 (Net Repair 0.47)
11			4.80
12	Alignment changes lengthen 0.03		7.38
13			7.38
14			12.18

YEARS FROM TO	TOTAL MILES	UNINCORPORATED		INCORPORATED		RURAL		URBAN	
		RDWY. MI.	BR. MI.	RDWY. MI.	BR. MI.	RDWY. MI.	BR. MI.	RDWY. MI.	BR. MI.

REMARKS: See Sheet N° 1

PREPARED BY
HIGHWAY PLANNING SURVEY
IN COOPERATION WITH
U.S. PUBLIC ROADS ADMINISTRATION

STATE OF MINNESOTA
DEPARTMENT OF HIGHWAYS
ROAD LIFE STUDIES
CONSTRUCTION PROJECT LOG RECORD

CONTROL SECTION 5004
TRUNK HIGHWAY 56
COUNTY Mower
DISTRICT 68

LIMITS: N. Co. Line - C.S.A.H. 46 (Old T.H. 16)
Ref. Pt. 043+00.364 - 031+00.167

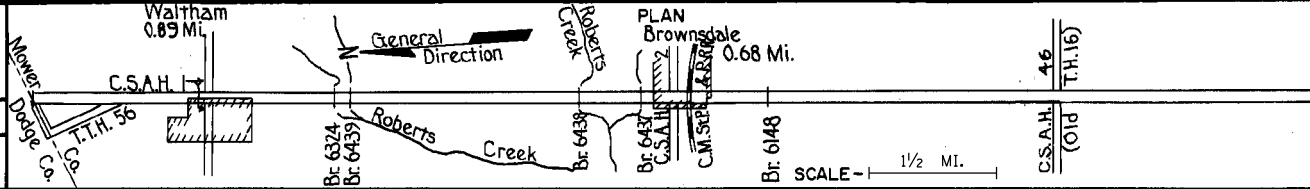

YEAR BUILT	PROJECT NO.	DESCRIPTION			
		TYPE	WIDTH	THICKNESS	REMARKS
M 1962		Light Bit. Seal	25'		RS-2,8312 Gal. Agg. 300 C.Y.
M 1963		Spot Treat Bit Surf. Repair Light Bit. Seal	24'		Bit Mix. 1132 Tons Seal Agg. 504 C.Y. RS-2K, 14225 Gal.
M 1966	C	Light Bit. Seal	25'		CRS-1 Bit. 8650 Gal. FA-1 Agg. 305 C.Y.
C 1973	5004-13	Grading Rt. & Lt. of Roadway in place Plant Mix Bit.	24'	3"	
C 1973	5004-12	Grading Rt. & Lt. Gravel Base PC Concrete	24'	7"	Portions Completely regraded (17 Bridges)
M 1971	SF	Pl. Mix Bit. Spot Overlay	24'	1"	AC-1 2331 903.91 Ton MC-800 Tack 400 Gal.
M 1979	SF	Seal Bituminous Shoulders	10'		7176 Gal. CSSIH
M 1984	SF	Mud Jack Low Section of Roadway			1.0 MI. N. of Jct. 1-90
M 1986	4187	Conc. Repair			
M 1987	SF	Wedge Paving			
M 1987	SF	Conc. Repair			
M 1988	SF	Bit. Overlay	24'	1 1/4"	Spec. 2331
M 1988	4322	Bit. Overlay	24'	1"	Spec. 2341
M 1989	SF	Gravel Shouldering	1 1/2'	1 1/4"	Rt. Only

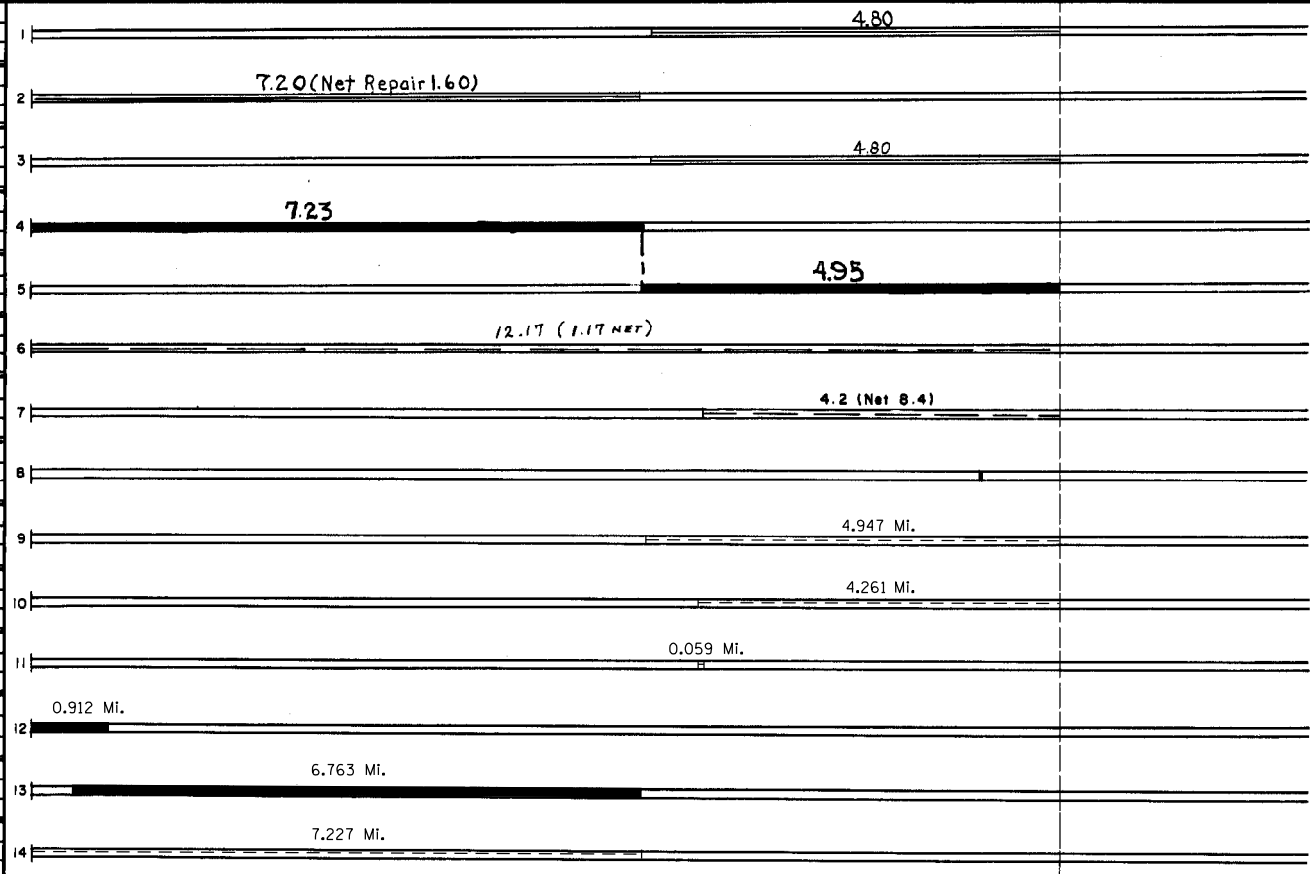

YEARS		TOTAL MILES	UNINCORPORATED		INCORPORATED		RURAL		URBAN	
FROM	TO		RDWY. MI.	BR. MI.	RDWY. MI.	BR. MI.	RDWY. MI.	BR. MI.	RDWY. MI.	BR. MI.

REMARKS: See Sheet No. 1 (1) Brs. 3724 & 6149 removed, Brs. 6148 & 6437 extended

