

PREPARED BY
HIGHWAY PLANNING SURVEY
IN COOPERATION WITH
U. S. PUBLIC ROADS ADMINISTRATION

STATE OF MINNESOTA
DEPARTMENT OF HIGHWAYS
ROAD LIFE STUDIES
CONSTRUCTION PROJECT LOG RECORD

CONTROL SECTION 4604
TRUNK HIGHWAY 15
COUNTY Martin
DISTRICT TB

LIMITS: Jct. T.H. 16 in Fairmont - N. Co. Line

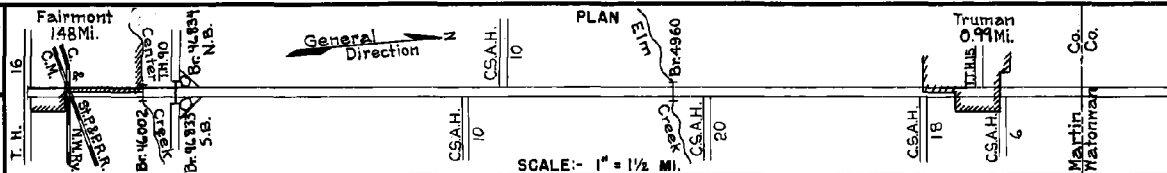

YEAR BUILT	PROJECT N ^o	DESCRIPTION			CODE N ^o
		TYPE	WIDTH	THICKNESS	
		Wood Block			No Record of Constr.
		Gravel	20		No Record of Constr.
		Gravel	20	2"	No Record of Constr.
1920	15-15-2&3	Grading	24'		40' R.C.D.G. & 50' C.D.G.
		Br. 3063 & 2971	24'		
1921	15-15-01	Gravel	20	2 1/4"	900 C.Y./Mile.
1921	15-15-02	Gravel	20	3"	1200 C.Y./Mile.
1923	15-15-27&28	Guard Rail			
1924	15-15-5	Concrete			No Record of Constr.
		Grading	30'		
1926	15-15-24	Gravel (1)	24	3 1/2"	1600 C.Y./Mile.
		Grading	40'		
1930	15-15-33-1&3	Br. 4960	33'		45' B.S.
		Br. 4960	33'		70' B.S.
1930	15-15-33-3	Gravel	32'	1 1/2"	900-1200 C.Y./Mile.
1932	15-15-33-1 (15-15-33-3A&B)	Concrete	20'	9-79	
		Widening			15' Rt. & Lt.
1952	4604-03	Bit Stab Base	30'	7"	
		Plant Mix Bit	30'	2"	
		Precast Concrete			
1953	4604-05	Cattle Pass			72" x 44'

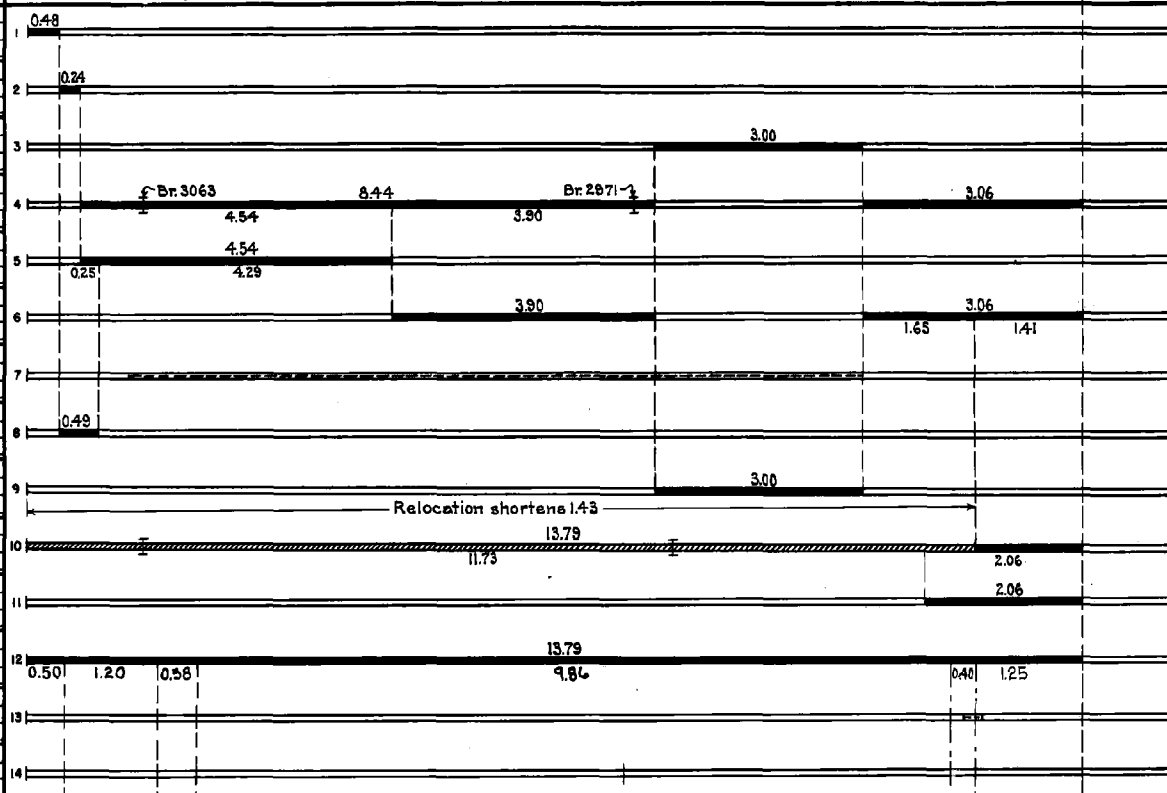

YEARS		TOTAL MILES	UNINCORPORATED		INCORPORATED		RURAL		URBAN	
FROM	TO		RDWY. MI.	BR. MI.	RDWY. MI.	BR. MI.	RDWY. MI.	BR. MI.	RDWY. MI.	BR. MI.
1921	1929	15.22	11.76	0.01	3.44	0.01	13.75	0.01	1.45	0.01
1930	1950	13.79	12.14	0.02	1.63	0.00	12.73	0.02	1.04	0.00
1951	1958	13.79	12.14	0.02	1.63	0.00	12.14	0.02	1.63	0.00
1959	1960	13.79	12.37	0.02	1.40	0.00	12.37	0.02	1.40	0.00
1961	1964	13.79	11.93	0.02	1.84	0.00	11.93	0.02	1.84	0.00
1965	1973	13.79	11.70	0.02	2.07	0.00	11.70	0.02	2.07	0.00
1974		13.79	11.30	0.02	2.47	0.00	11.30	0.02	2.47	0.00

REMARKS: Layout is to scale as of 1932

(1) Graveling done by Maint. Dept.

10-74

PREPARED BY
HIGHWAY PLANNING SURVEY
IN COOPERATION WITH
U.S. PUBLIC ROADS ADMINISTRATION

STATE OF MINNESOTA
DEPARTMENT OF HIGHWAYS
ROAD LIFE STUDIES
CONSTRUCTION PROJECT LOG RECORD

CONTROL SECTION 4604
TRUNK HIGHWAY 15
COUNTY Martin
DISTRICT 7B

LIMITS: Jct. T.H. 16 in Fairmont - N. Co. Line

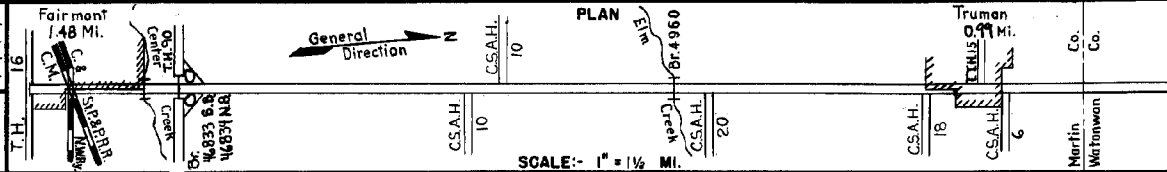

YEAR BUILT	PROJECT N ^o	DESCRIPTION		CODE N ^o
		TYPE	THICKNESS	
C 1954	A.F.E. 817	Place Stone Rip Rap		
C 1955	4604-04	Base * Plant Mix Bit.	5 1/2" 3"	*20 conc. in p. widened 18' Rt. & Lt. with 7" conc.
M 1966	SF	Bit Surface Repair	2 1/2" 1 1/2"	RC 2 Bit. 100 Gal Pl Mix Bit. 576 Ton
M 1971	4604-12	Bit Overlay	5/8"	
C 1972	4604-10	Gravel Shoulder		Removal of Curb and Should Drains Approx. 10mi.
C 1973	4604-1b	Bit Overlay Gravel Shoulders	2 1/2" 2 1/2"	
C 1974	4604-08	Grade Base RC Conc. Br 46002	5 1/2" 8"	M.P. 1.70 to 1.76 widening only 74 P.P.G.
C 1974	4680-12 I-16 090- 2(41)100	Grade Base RC Conc.	5 1/2" 8"	Br 46834 & 46833 Information on C.S. 4680
M 1978	SF	Bit Seal Coat		RC 800 & FA-2 Mod
M 1976	SF	Bit Spot Overlay	1 1/4"	P.Mix AC WEAR COURSE
M 1977	SF	Bit Spot Overlay	1 1/2"	P.Mix AC WEAR COURSE
M 1977	SF	RESTORE AGG. SHOULDERS		AGGREGATE 770 C.Y.

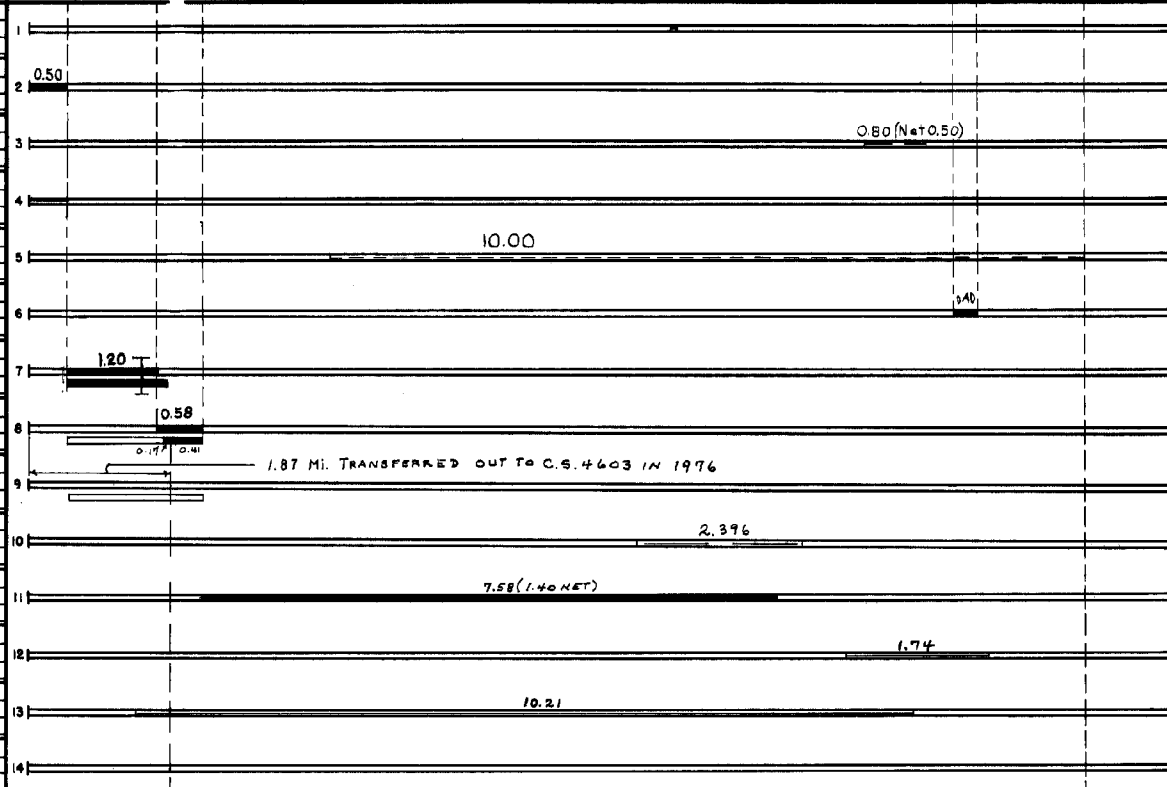

YEARS FROM	TO	TOTAL MILES	UNINCORPORATED		INCORPORATED		RURAL		URBAN	
			RDWY. MI.	BR. MI.	RDWY. MI.	BR. MI.	RDWY. MI.	BR. MI.	RDWY. MI.	BR. MI.

REMARKS: See Sheet No. 1

10-74

