

PREPARED BY
TRAFFIC AND PLANNING DIVISION
IN COOPERATION WITH
U.S. DEPARTMENT OF COMMERCE
BUREAU OF PUBLIC ROADS

Maple Grove

STATE OF MINNESOTA
DEPARTMENT OF HIGHWAYS
ROAD LIFE STUDIES
CONSTRUCTION PROJECT LOG RECORD

Eden Prairie
3.59 Mi

Interstate
Bloomington
9.14 Mi

CONTROL SECTION 2785
TRUNK HIGHWAY 494
COUNTY Hennepin
DISTRICT 5A

LIMITS: Jct. T.H. 94 - E. end Minnesota River Bridge at
Hennepin-Dakota Co. Line

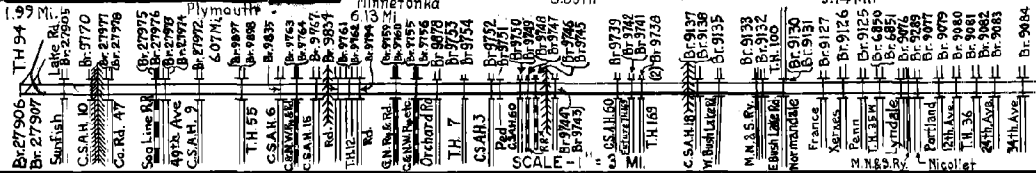

YEAR	PROJECT NO	DESCRIPTION			
		TYPE	WIDTH	THICKNESS	REMARKS
1959	2785-02104	Grade & Sub-Base	76'	12"	Divided Highway
	2785-05	Grav. Base	76'	3"	3 P. 2732-20 covers
	2785-32	Concrete	48'	10"	frontage roads
1959	2785-13	Br. 9127			200' B.S. - U.P.
	2785-14	Br. 9126			192' B.S. - U.P.
	2785-15	Br. 9125			182' B.S. - U.P.
1959	2785-18423	Br. 9077 & 9083			116' C.G. - U.P.
	2785-20121	Br. 9079 & 9080			118' C.G. - U.P.
	2785-22	Br. 9081 & 9082			164' C.G. - U.P.
1959	2785-03	Br. 9084	52' x 52'		133' C.G. - O.H.
	2785-16&17	Br. 9076 & 9085			167' C.G. U.P. & 124' P.G. - U.P.
	2785-19	Br. 9078			274' B.S. Ped. U.P.
1956	2732-03	Br. 6850 (W.B. Rdwy)	39'		178' B.S. - O.H.
	2732-12	Br. 6891 (E.B. Rdwy)	39'		178' B.S. - O.H.
					Transferred in 1959
1961	2785-24	Grading & Sub-Base	2-49'	6"	Divided Highway
		Br. 9137 & 9138			both 214' C.G. - U.P.
		Br. 9135			196' C.G. - U.P.
1961	2785-24	Br. 9132			200' C.G. - U.P.
	2785-09	Br. 9130 & 9131 (D)	2-39'		both 174' B.S. - O.H.
		Br. 9133			178' P.G. - U.P.
1961	2785-97	Gravel Base	2-47'	3"	
		Concrete	2-24'	10"	
1963	2785-34235	Grading	2-49'		Divided Highway
		Sub-base	2-47'	3"	
		Gravel Base	2-45'	3"	
1963	2785-85	P.C. Concrete	2-24'	9 1/2"	
	2785-88	Sand Blanket			at Minnesota River
1963	2785-9878	Br. 9778			194 P.C.G. - U.P.
	2785-9731, 54	Br. 9753 & 9754			Both 182' B.S. - U.P.
	2785-9732	Br. 9752			232' B.S. - U.P.
1963	2785-9731	Br. 9751			258' Pedestrian - U.P.
	2785-9750, 49	Br. 9750 & 9749	2-30'		Both 251' B.S. - O.H.
	2785-9748, 47	Br. 9748 & 9747	2-30'		Both 174' B.S. - O.H.
1963	2785-9746, 45	Br. 9746 & 9745	2-30'		Both 150' B.S. - O.H.
	2785-9744, 43	Br. 9744 & 9743	2-30'		Both 186' B.S. - O.H.
	2785-9739	Br. 9739			220' P.C.G. - U.P.
1963	2785-9742, 41	Br. 9742 & 9741	2-39'		219' & 226' P.C.G. - O.H.
	2785-9738	Br. 9738			203' P.C.G. - U.P.

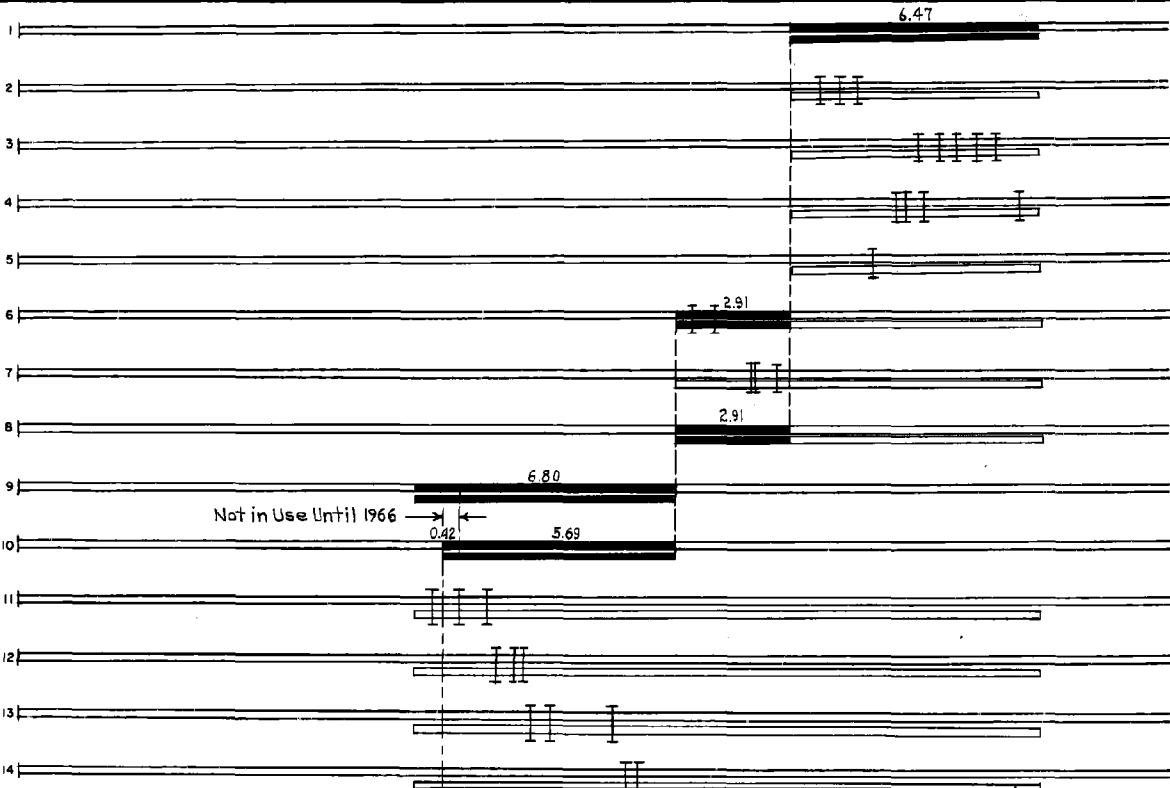

YEARS		TOTAL MILES	UNINCORPORATED		INCORPORATED		RURAL		URBAN	
FROM	TO		RDWY. MI.	BR. MI.	RDWY. MI.	BR. MI.	RDWY. MI.	BR. MI.	RDWY. MI.	BR. MI.
1939	1960	6.47	0.00	0.00	6.41	0.06	0.00	0.00	6.41	0.06
1961	1962	9.38	0.24	0.00	9.05	0.09	0.24	0.00	9.05	0.09
1963	1965	13.07	0.00	0.00	12.79	0.28	0.00	0.00	12.79	0.28
1966	1967	21.11	0.00	0.00	20.63	0.48	0.00	0.00	20.63	0.48
1968		27.08	0.00	0.00	26.53	0.55	0.00	0.00	26.53	0.55

REMARKS: Layout is to scale as of 1959
 (1) Br. 9130 W.B. rdwy. Br. 9131 E.B. rdwy. over T.H. 100 (Normandale road)
 (2) Br. 9738 at Present T.H. 169 no interchange or intersection at this bridge.

4-74

PREPARED BY
TRAFFIC AND PLANNING DIVISION
IN COOPERATION WITH
U.S. DEPARTMENT OF COMMERCE
BUREAU OF PUBLIC ROADS

STATE OF MINNESOTA Minnetonka Eden Prairie
DEPARTMENT OF HIGHWAYS
ROAD LIFE STUDIES
CONSTRUCTION PROJECT LOG RECORD

INTERSTATE CONTROL SECTION 2785
TRUNK HIGHWAY 494
COUNTY Hennepin
DISTRICT 5A

LIMITS: Jct. T.H. 94 - E end Minnesota River Bridge at
Hennepin-Dakota Co. Line

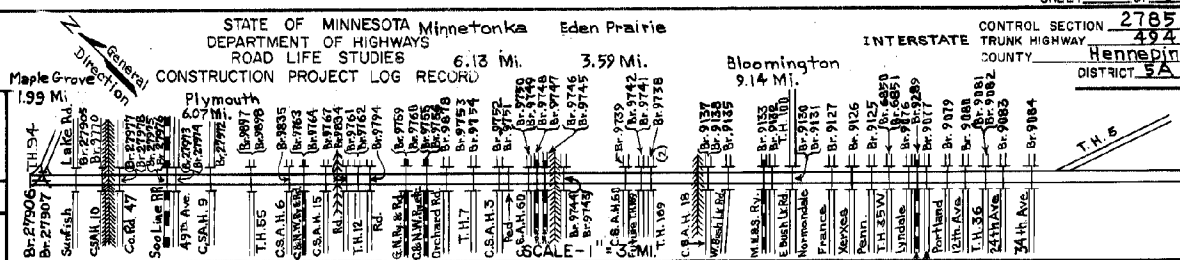

YEAR BUILT	PROJECT NO.	DESCRIPTION				REMARKS
		TYPE	WIDTH	THICKNESS		
1965	2785-11	Grading, Base P.C. Concrete	2@12'	10"	Widening, const. of inside lanes.	
	2785-6850-85	Widen Br's 6850 & 6851			Deck widths 2 @ 5'	
1966	2785-36	Grading	2@48'		Divided Highway	
	2785-9897-98	Br's 9897 & 9898			Both 227' P.P.G. - U.P.	
	2785-9835	Br. 9835			191' P.P.G. - U.P.	
1966	2785-108	Sub-base Gravel Base P.C. Concrete	2@28' 2@24'	3" 2 1/4" 9"	Base in place on portion graded under 2785-35	
1966	2785-9763-64	Br's 9763 & 9764	50' @ 30'		Both 231' B.S. - D.H.	
	2785-9767	Br. 9767			201' P.P.G. - U.P.	
	2785-9834	Br. 9834			182' B.S. - U.P.	
1966	2785-9761 & 62	Br's 9761 & 9762	59' @ 39'		Both 241' B.S. - D.H.	
	2785-9794	Br. 9794			227' B.S. - U.P.	
	2785-9759 & 60	Br's 9759 & 9760	50' @ 30'		Both 221' B.S. - D.H.	
1966	2785-9755 & 56	Br's 9755 & 9756	59' @ 39'		Both 337' B.S. - D.H.	
	(3)					
1968	2785-37	Grading Br. 27972 Br's 27973 & 27974	2@49' 3@83'		Divided Highway 211' B.S. - U.P. Both 112' B.S. - O.H.	
1968	2785-37	Br's 27975 & 27976 Br's 27977 & 27978 Br's 9770 & 27905	3@83' 3@83'		Both 132' B.S. - O.H. Both 139' P.P.G. - O.H. 208 - 239 B.S. - U.P.	
1968	2785-121	Gravel Base P.C. Concrete Pl. Mix. Bit. Shoulders	2@22' 2@24'	6" 9"	Divided Highway 3'in. & 10' out.	
1968	2786-29	Grading & Base Paving	24'	6" 9"	Temp. Conn. To T.H. 94 0.34 divided 0.58 single rdwy.	
1973	2785-172 1494-4(90) 221	Gravel Base P.C. Concrete Pl. Mix. Bit. Shoulders	2@ 24' 36'	10'	0.21 Mi. Widening	
1969	-124 1494-4(77) 238	TRAFFIC SIGNALS			AT FRANCE AVE. RAMP'S AT NO. FRONTAGE RD. + FRANCE AVE.	
1970	-147; -150 1494-4(84) 240	TRAFFIC SIGNALS			AT LYNDALE AVE AT NICOLET AVE	
1978	2785-202	TRAFFIC SIGNALS			AT THURM & THURM SOUTH RAMP'S, THE CANALS	

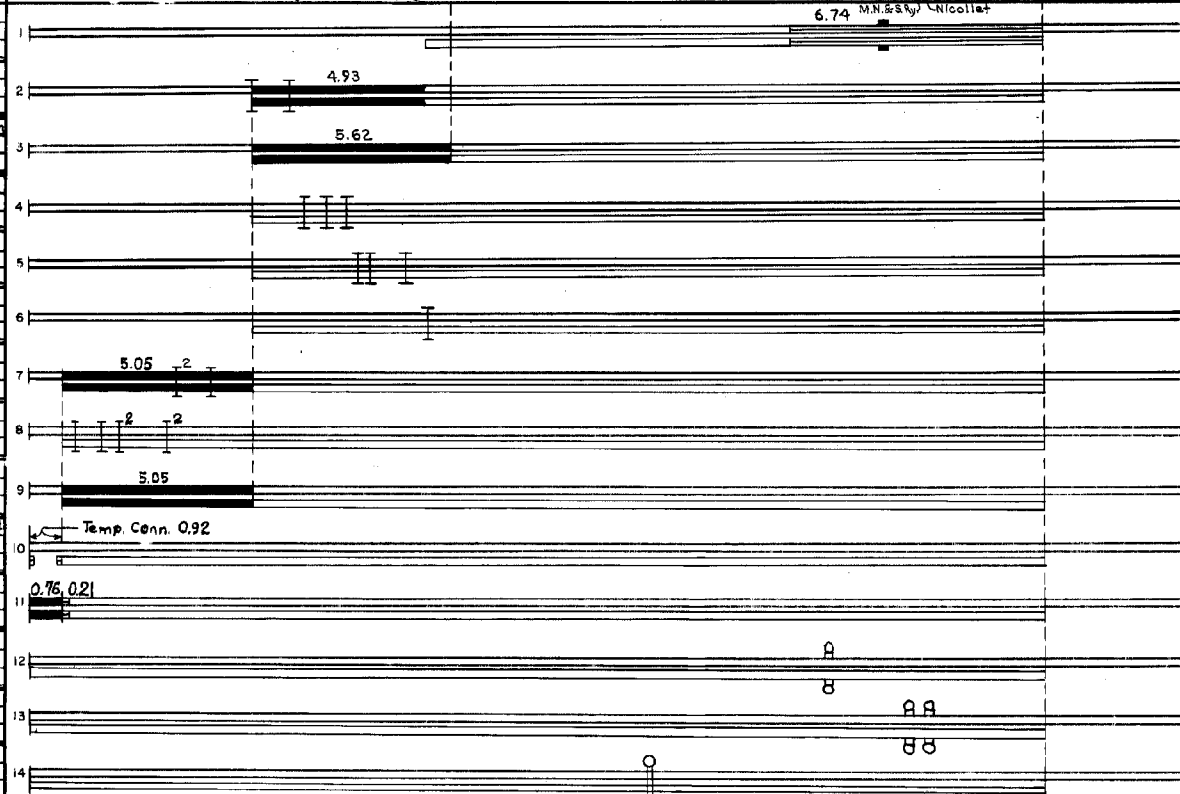

YEARS		TOTAL MILES	UNINCORPORATED		INCORPORATED		RURAL		URBAN	
FROM	TO		RDWY. MI.	BR. MI.	RDWY. MI.	BR. MI.	RDWY. MI.	BR. MI.	RDWY. MI.	BR. MI.

REMARKS See Sheet 1
 (3) S.P. 2785-91051 & 91052 both C10100 box culverts under ramps at C.S.A.H. 5.
 (4) See C.S. 2786 Line 110 for Bridge Information

