

PREPARED BY
HIGHWAY PLANNING SURVEY
IN COOPERATION WITH
U.S. PUBLIC ROADS ADMINISTRATION

STATE OF MINNESOTA
DEPARTMENT OF HIGHWAYS
ROAD LIFE STUDIES
CONSTRUCTION PROJECT LOG RECORD

CONTROL SECTION 2733
TRUNK HIGHWAY 100
COUNTY Hennepin
DISTRICT 5A

LIMITS: Jct. T.H. 494 in Bloomington - S. Jct. T.H. 169 in Edina

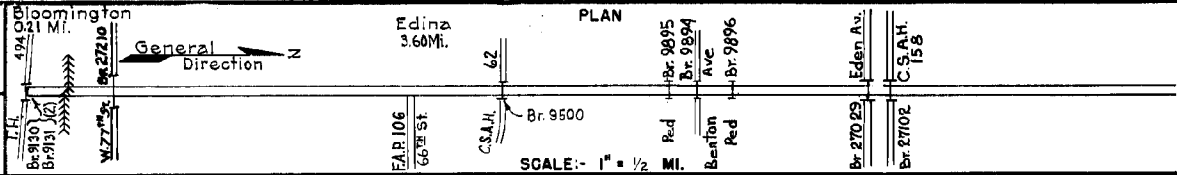

YEAR BUILT	PROJECT N°	DESCRIPTION			REMARKS	CODE N°
		TYPE	WIDTH	THICKNESS		
		Gravel	50'	2"	No Record of Constr.	
		Grading	50'		Added in 1934.	
1932		Gravel	30'	2"	Co. Job 3149.	
		Grading	50'		Added in 1934.	
1934		Gravel	50'		Maint. Dept.	
1935		Oil Tr. Gravel	50'	2"	Maint. Dept.	
1936	100-130-21-1A	Grading	60'			
	(1)					
1936	100-130-21-1A	Tar Tr. Gravel	60'	2 1/2"		
					Maint. Dept.	
1939	2733-02	Misc. Constr.			Grading & Gravel on Service Drives.	
C	1940 A.F.E. 40	Misc. Constr.			Bit. Treatment on Service Drives.	
					Maint. Dept.	
M	1941 A.F.E. 47	Spot Treat.			AE-18 MC3, 1076 IG / Mi.	
	A.F.E. 22	Bit. Surf. Repair	60'		Agg. 731 C.Y. / Mi.	
	A.F.E. 12	& Bit. Seal Coat			Maint. Dept.	
C	1945 A.F.E. 4	Bit. Resurfacing			* 24' each drive	
		Mixed Bit.	* 1"		Maint. Div.	
		On Service Drives	added			
M	1946 A.F.E. 4	Spot Treat.			RT6, 23721 Gal.	
		Bit. Surf. Repair			Agg. 1260 C.Y.	
C	1948 2733-05	Gravel Base	50' 6"-9"			
		Mixed Bit.	40'	1 1/2"		
C	1948 A.F.E. 34	Misc. Constr.			Grading & Gravel on Service Drives	
C	1949 A.F.E. 27	Misc. Constr.			Bit. Surfacing on Service Drive	

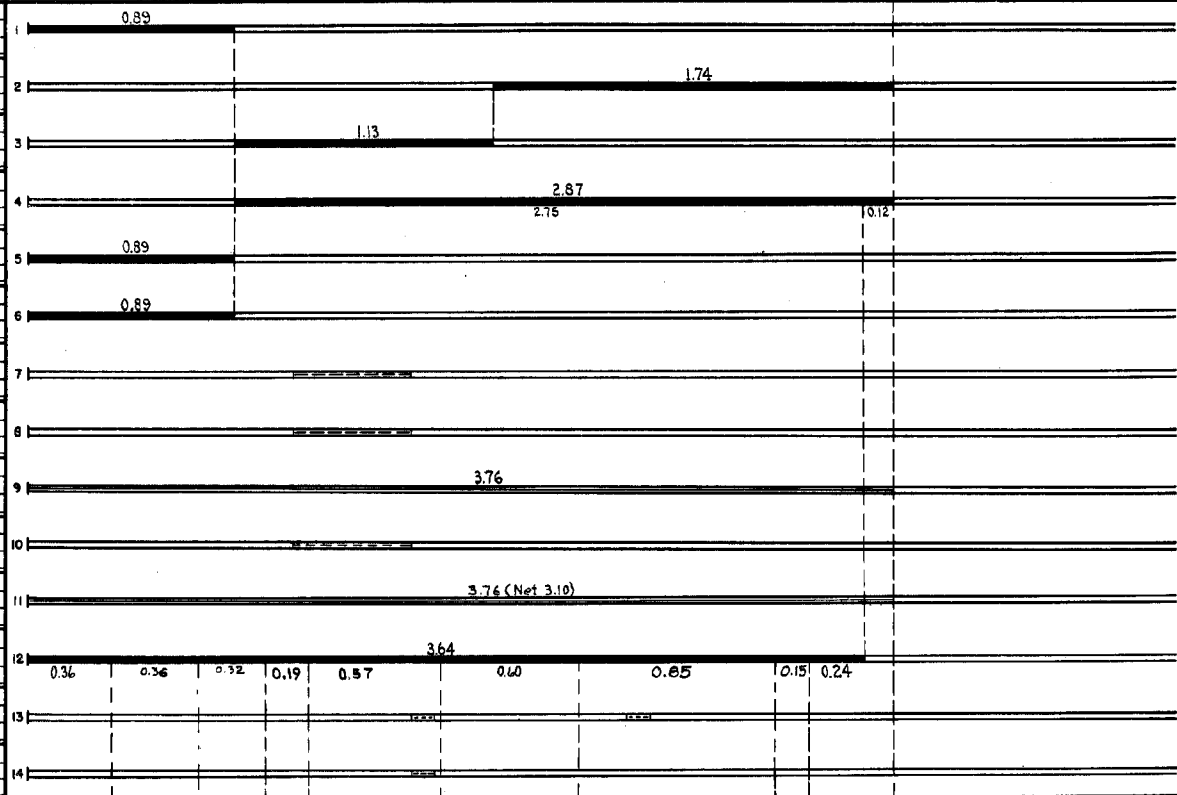

YEARS FROM	YEARS TO	TOTAL MILES	UNINCORPORATED		INCORPORATED		RURAL		URBAN	
			RDWY. MI.	BR. MI.	RDWY. MI.	BR. MI.	RDWY. MI.	BR. MI.	RDWY. MI.	BR. MI.
1934	1952	3.76	0.15	0.00	3.61	0.00	0.15	0.00	3.46	0.00
1963	1960	3.76	0.00	0.00	3.76	0.00	0.00	0.00	3.76	0.00
1961		3.81	0.00	0.00	3.77	0.04	0.00	0.00	3.77	0.04

REMARKS: Layout is to scale as of 1934

(1) This work not done under this project number but lies within the limits of this project.

(2) Br. 9130 W.B. T.H. 494, Br. 9131 E.B. T.H. 494 both under passes See C.S. 2785.

10-75

RL-7 REV. 2-40

PREPARED BY
HIGHWAY PLANNING SURVEY
IN COOPERATION WITH
U. S. PUBLIC ROADS ADMINISTRATION

STATE OF MINNESOTA
DEPARTMENT OF HIGHWAYS
ROAD LIFE STUDIES
CONSTRUCTION PROJECT LOG RECORD

CONTROL SECTION 2733
TRUNK HIGHWAY 100
COUNTY Hennepin
DISTRICT 5A

LIMITS: Jct. T.H. 494 in Bloomington - S. Jct. T.H. 169 in Edina

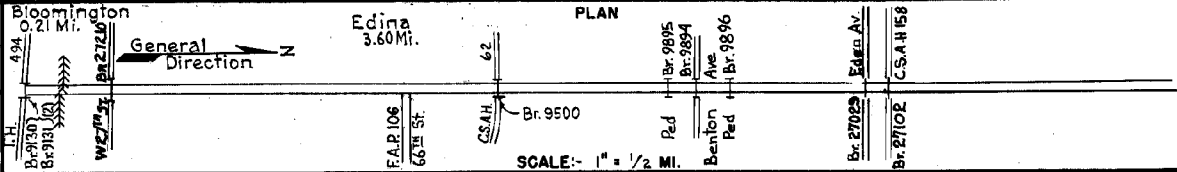

YEAR BUILT	PROJECT N ^o	DESCRIPTION			CODE N ^o
		TYPE	WIDTH	THICKNESS	
C	1952 2733-10	Concrete Base	44'	7"	Divided Highway
(2)	2733-07	Asphaltic Conc.	44'	3"	
M	1953 A.F.E. 605	Light Bit. Seal	40'		RC-2, 11217 Gal. Agg. 476 tons
C&M	1954 A.F.E. 626	Bit. Seal Coat	44'		RT-10, 2612 Gal. Agg. 131 C.Y.
(2)	2733-08	Traffic Signals			
M	1955 A.F.E. 604	On Service Drives			RC-2&MC 4, 801 Gal. Agg. 81 tons & 68 C.Y.
(2)		Bit. Surf. Repair (0.15 Mi.)	18'		
		Light Bit. Seal (0.60 Mi.)	18'		
C	1956 A.F.E. 826	Right-Turn Lanes			MC-0&2, 2102 Gal. Agg. 357 tons
		Grading Grav. Base			
		& Bit. Surfacing			
C	1957 2733-24	Traffic Signals			
(2)	2733-12				
M	1959 A.F.E. 605	Bit. Seal on Rdwy. & Service Drives			RC-3, RC-2&RT-10 15599 Gal. Agg. 859 tons
C	1960 2733-28	Br. 9500	2'38"		20' BS, not in use until completion of S.P. 2733-28
		By-Pass			
C	1961 2785-24	Grading Base			Divided Highway
	2733-29	Asphaltic Conc.	24'	4"	
		Grading & PC Conc*	22'	9"	*over gravel base
C	1963 2733-34	Lighting System			
(2)	2733-35	Fence & Guard Rail			
	1964 By Maint. Div.	Deceleration Lanes			at s. Jct. T.H. 169
C	(3)	Grading & Base			Rt. & Lt. of rdwy. Imp.
	1964 By Maint. Div.	Plant Mix Bit.			Approx. 2 @ 22' rdwys.
	2733-36	Traffic Signals			
C	1965 2733-38	Traffic Signals			at W. 50th St.
M	1966 SF	Bituminous Pedestrian Walk	6'	3 1/2"	Benton Ave. to 0.07 mi. So. A.C.
		Shoulder Class 2	2'	4"	2131
M	(4)	Bit. Turn Lane	24'	1 1/2"	65th to 66th
	1967 SF	Bit. Overlay			

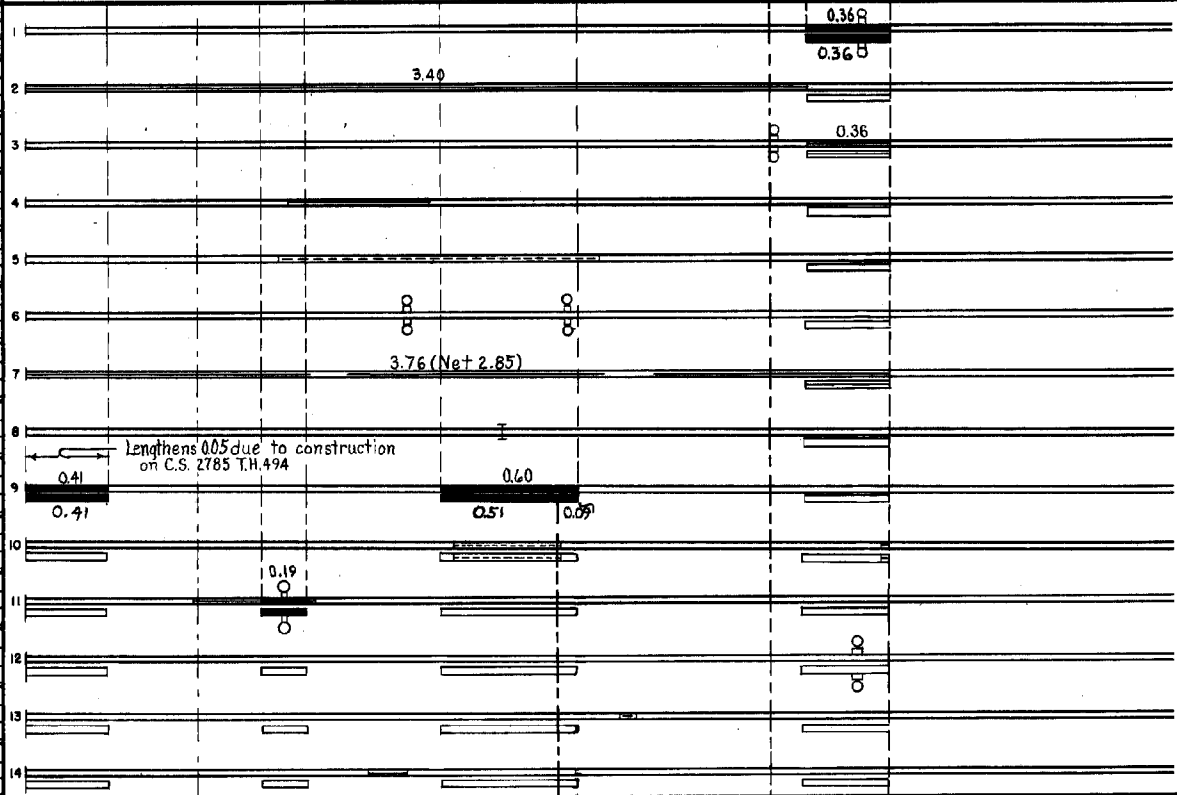

YEARS FROM	TO	TOTAL MILES	UNINCORPORATED		INCORPORATED		RURAL		URBAN	
			RDWY. MI.	BR. MI.	RDWY. MI.	BR. MI.	RDWY. MI.	BR. MI.	RDWY. MI.	BR. MI.

REMARKS: See Sheet No. 1
(2) Contract on S.P. 2733-10 not final but work substantially complete in 1952.
(3) Frontage road constructed on east side for 0.46 mile.
(4) Service Road Surfacing from 165th St. to 66th St.

10-75

PREPARED BY
TRANSPORTATION & TRANSIT PLANNING & PROGRAMMING DIVISION
IN COOPERATION WITH
U.S. DEPARTMENT OF TRANSPORTATION-BUREAU OF PUBLIC ROADS

STATE OF MINNESOTA
DEPARTMENT OF HIGHWAYS
ROAD LIFE STUDIES
CONSTRUCTION PROJECT LOG RECORD

CONTROL SECTION 2733
TRUNK HIGHWAY 100
COUNTY Hennepin
DISTRICT Metro

LIMITS: Jct. T.H. 494 in Bloomington - S. Jct. T.H. 169 in Edina
Ref. Pt. 000+00.000 - 003+00.896

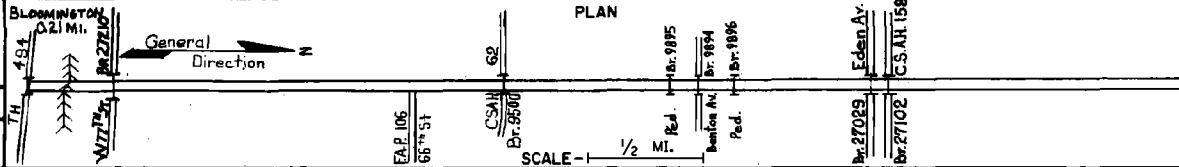

YEAR BUILT	PROJECT NO.	DESCRIPTION			REMARKS
		TYPE	WIDTH	THICKNESS	
C	1969 2733-49	Traffic Signals			Southview Lane
C	1973 2733-39	Grading Base Concrete Surf.	2038'	9"	Divided Highway 283' BS
C	1973 2733-48	Grading Base Concrete Surface	2036'	9"	Divided Highway PCG. 186'
C	1973 2733-51	Grading Base Surface	72'	9"	279' SBS-U.P.
C	1973 2733-39	Br. 27102			180' BS.
C	1973 -9895	Br. 9895 (Ped)			242' cont SBS
C	1973 -9896	Br. 9896 (Ped)			273' cont SBS
C	-56	Traffic Signal System			
C	-58	TRAFFIC SIGNAL SYSTEM			AT 50TH ST (CSAS/58)
C	1967 -47	Bituminous Resurfacing & Age Shoulders	Var. 10'-7 1/2" to 5'-10"	1 1/2" to 2"	THIS PROJ. OUT OF GENERAL CRACKS. NO RETIREMENT SHOWN
M	1981 2733 SF	Br. Repair			Br. 27029
C	1977 2733-61	Grading Misc. Surfacing	2036'	9"	Temp. Traffic Signals (T.M. 540219) Retaining Walls, Br. 9431, 9432
M	1984 2733 SF	Pavement Joint and Crack Repair			
M	1986 M4177	Joint Repair			
M	1992 M4547	Joint Repair			Mill LT Shoulder

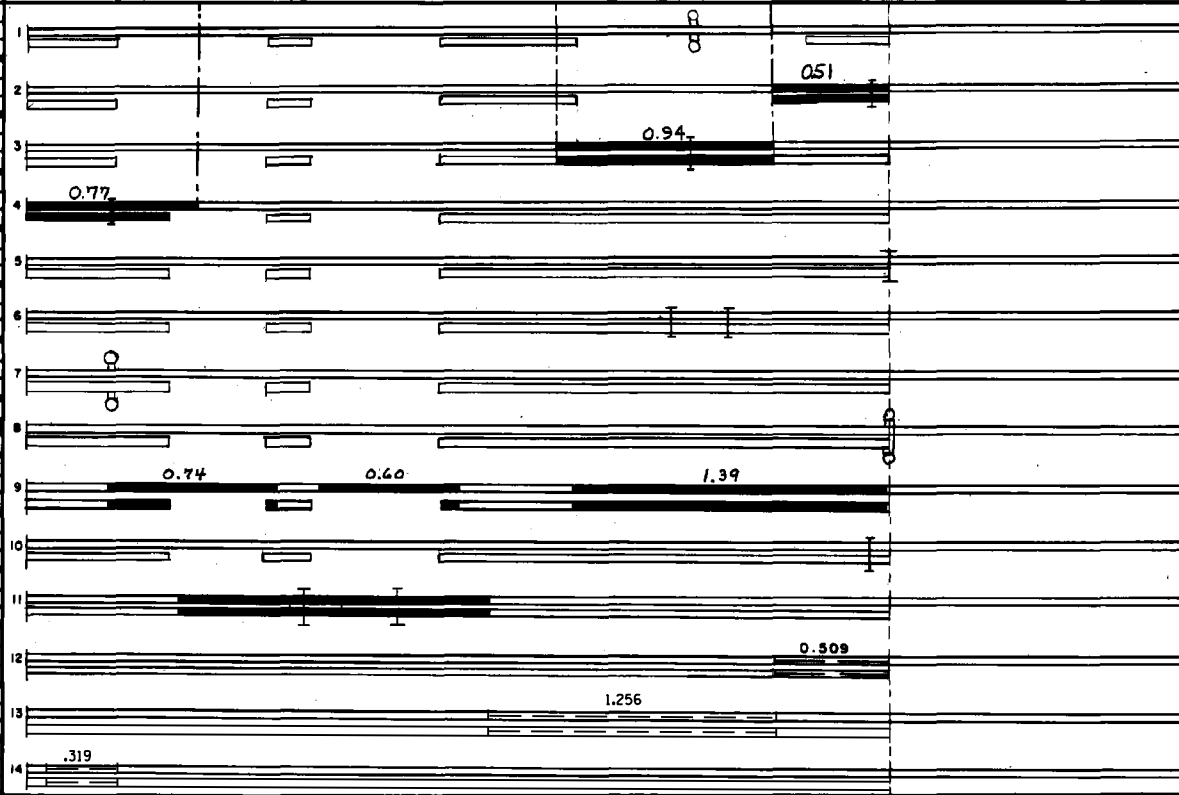

YEARS FROM	TOTAL TO	UNINCORPORATED		INCORPORATED		RURAL		URBAN	
		ROWY. MI.	BR. MI.	ROWY. MI.	BR. MI.	ROWY. MI.	BR. MI.	ROWY. MI.	BR. MI.

REMARKS: See Sheet No. 1

