

PREPARED BY
HIGHWAY PLANNING SURVEY
IN COOPERATION WITH
U. S. PUBLIC ROADS ADMINISTRATION

STATE OF MINNESOTA
DEPARTMENT OF HIGHWAYS
ROAD LIFE STUDIES
CONSTRUCTION PROJECT LOG RECORD

CONTROL SECTION 2514
TRUNK HIGHWAY 61
COUNTY Goodhue
DISTRICT 9A-6B

LIMITS: Jct. T.H. 58 in Red Wing - W. Co. Line

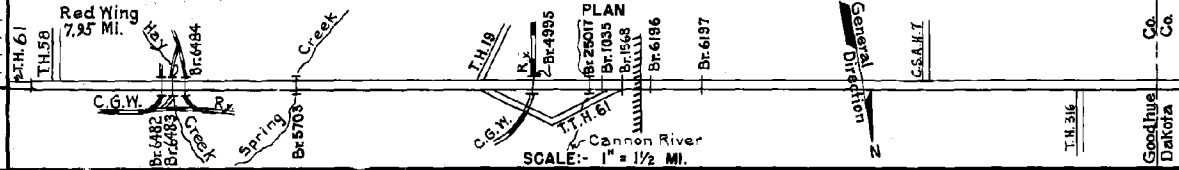

YEAR BUILT	PROJECT N ^o	DESCRIPTION			CODE N ^o
		TYPE	WIDTH	THICKNESS	
		Wood Block Concrete Base	V.W. 4"	6"	Width 56' & 68'. (2) No Record of Constr. 90' HT.
1918	61-3-2	Grading Gravel	24' 24'	1"	542 C.Y./Mile. 60' C.G.
1920	61-3-2	Grading Concrete	24' 19'		90' C.A.
1920		Grading Gravel	24' 24'	3"	Co. Job 1701 1400 C.Y./Mile
1920	61-3-2	Concrete	V.W. 24"		17 Mi. Divided Highway. Width 18' to 51'
1920	61-3-2	Grading Concrete	18'	22"	15' C.S.
1922	61-3-25	Br. 3481	22'		180' C.D.G.
1924	61-3-31C	Concrete	18'	7 1/2"	Widened to 47'-56' by City.
1927	61-3-2	Oil Tr. Gravel	22'	1"	8561 Gal./Mile. Maint. Dept.
1927		Oil Tr. Gravel	22'	1"	8561 Gal./Mile. Maint. Dept.
1927	61-3-54	Guard Rail			
1930	61-3-60-1	Grading Gravel	40' 28'	2"	1103 C.Y./Mile.
1931	61-3-60-2&3	Grading Br. 4995, 4993, 1035, 1568, 6196 & 6197	40' 27'		320 D.P.G. O.H. 280' HT. WIDTH W/1010 W/1010 W/1010 W/1010
1931	61-3-60-2&3	Gravel	28'	1 1/2"	993-222 C.Y./Mile.

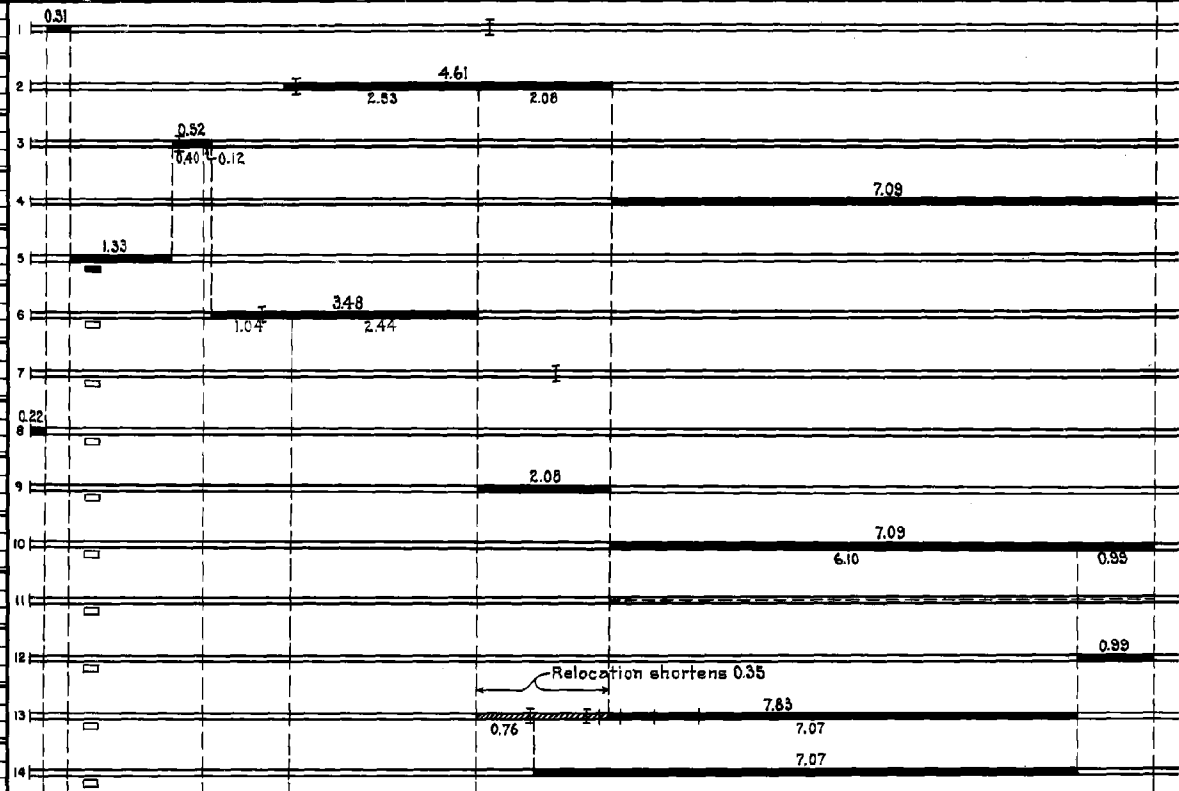

YEARS FROM	TO	TOTAL MILES	UNINCORPORATED		INCORPORATED		RURAL		URBAN	
			ROWY. MI.	BR. MI.	ROWY. MI.	BR. MI.	ROWY. MI.	BR. MI.	ROWY. MI.	BR. MI.
1924	1930	15.02	12.59	0.06	2.35	0.02	12.58	0.06	2.35	0.02
1931	1938	4.67	12.17	0.13	2.35	0.02	12.17	0.13	2.35	0.02
1939	1951	4.61	12.10	0.14	2.35	0.02	12.10	0.14	2.35	0.02
1952	1952	4.61	12.11	0.14	2.35	0.02	12.11	0.14	2.35	0.02
1953	1962	4.63	12.11	0.14	2.35	0.02	12.11	0.14	2.35	0.02
1963	1971	4.27	12.11	0.14	1.88	0.14	12.11	0.14	1.88	0.14
1972	1974	4.27	6.28		7.71	0.28	6.28		7.71	0.28

REMARKS: Layout is to scale as of 1931

(1) This work not done under these project numbers but lies within the limits of these projects. (2) 56' wide for .14 Mi. on Plum St. and 68' wide for .16 Mi. on Main St.

2-76

PREPARED BY
HIGHWAY PLANNING SURVEY
IN COOPERATION WITH
U. S. PUBLIC ROADS ADMINISTRATION

STATE OF MINNESOTA
DEPARTMENT OF HIGHWAYS
ROAD LIFE STUDIES
CONSTRUCTION PROJECT LOG RECORD

CONTROL SECTION 2514
TRUNK HIGHWAY 61
COUNTY Goodhue
DISTRICT 9A-68

LIMITS: Jct. T.H. 58 in Red Wing - W. Co. Line

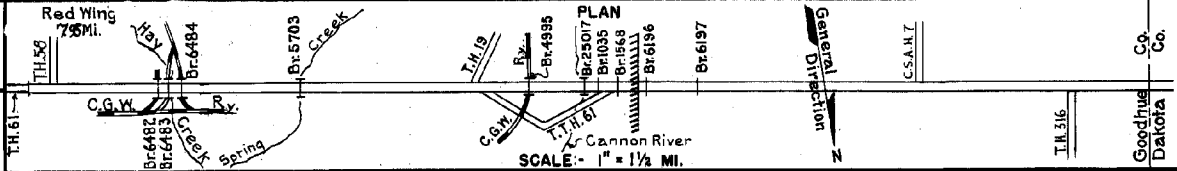

YEAR BUILT	PROJECT N ^o	DESCRIPTION			CODE N ^o
		TYPE	WIDTH	THICKNESS	
1931	61-3-60-2&3	Oil Tr. Gravel	24'	1"	9710 Gal./Mile Maint. Dept.
1931	61-3-60-1	Concrete	20'	9-7-9	
1932	61-3-60-2&3	Concrete	20'	9-7-9	
1934	61-3-60-3	Roadside Lands.			
1936	61-3-60-2	Misc. Drain Struct.			N.R.W.R. 25-2.
1938	A.F.E. 31	Retaining Wall			Maint. Dept.
1939	2514-02	Br. 5703	30'		159' B.S.
1939	2514-01	Grading	36'		
1939	2514-06	Concrete	20'	9-7-9	
1939	2514-05	Sodding			
1939	2514-07	Concrete Surf.	W.M. 5"		On old 6' Conc. Base. Width 56' & 68' (2)
1939	A.F.E. 27	Seeding			Maint. Dept.
1939	2514-08				
C	1940	A.F.E. 61	Masonry Dam & Wall		Maint. Dept.
C	1948	2514-21	Grading	63'	Not in use as T.H. 1.0' Selected soil
C	1950	A.F.E. 25	Channel Change & Erosion Control Dams		
C	1951	A.F.E. 25			
C	1951	2514-18	Br. 6482		Not in use 20x30x125 Conc. Tunnel

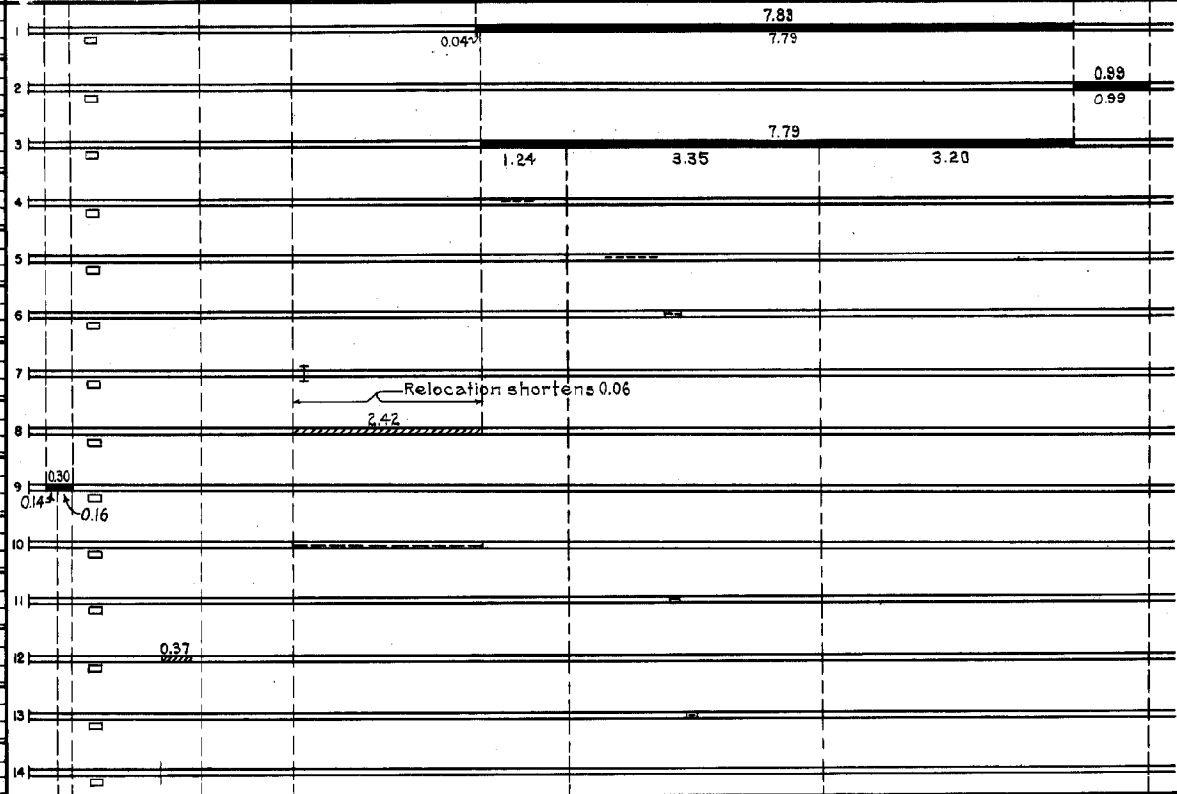

YEARS FROM TO	TOTAL MILES	UNINCORPORATED		INCORPORATED		RURAL		URBAN	
		RDWY. MI.	BR. MI.	RDWY. MI.	BR. MI.	RDWY. MI.	BR. MI.	RDWY. MI.	BR. MI.
1975	14.26	6.31	—	7.67	0.28	6.31	—	7.67	0.28

REMARKS: See Sheet N^o 1

2-76

PREPARED BY
HIGHWAY PLANNING SURVEY
IN COOPERATION WITH
U. S. PUBLIC ROADS ADMINISTRATION

STATE OF MINNESOTA
DEPARTMENT OF HIGHWAYS
ROAD LIFE STUDIES
CONSTRUCTION PROJECT LOG RECORD

CONTROL SECTION 2514
TRUNK HIGHWAY 61
COUNTY Goodhue
DISTRICT 9A-68

LIMITS: Jct. T.H. 58 in Red Wing - W. Co. Line

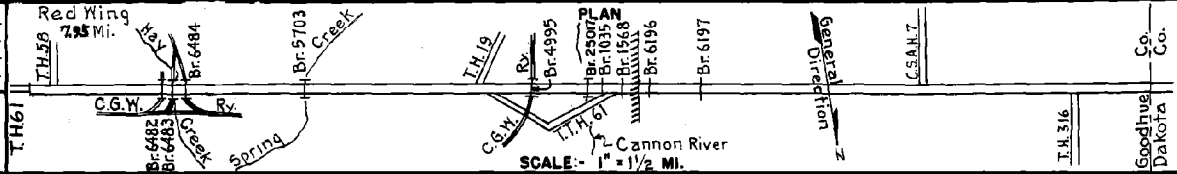

YEAR BUILT	PROJECT NO.	DESCRIPTION			CODE NO.
		TYPE	WIDTH	THICKNESS	
C	1952 2514-14	Grading Gravel	37 1/2	6 1/2	114 Mi. Divided Hwy 1200 C.Y./Mi.
M	1952 A.F.E. 20	Bit Surfacing one roadway of Div. Highway			MC-2 & 3, 23435 Gal. Agg. 655 C.Y.
C	2514-19	Br. 6483	28'3"		484' F.P.G.
C	2514-20	Br. 6484	2'3"		272' Cont. D.S.
C	2514-29				2.46 Mi., Divided.
C	1953 2514-30	P.C. Concrete	24'0"	9-7-9	
C	2514-36A & B	Traffic Signals			
C	1954 2514-33	Str. Lighting System *			* Mi. Pt. 0.93-2.38
C	2514-35	Guard Rail **			** Mi. Pt. 2.38-3.43
C	1955 2514-37	Roadside Development			Conc. Steps
M	1956 A.F.E. 605	Light Bit Seal	24'		RS-2, 1920 Gal. Agg. 92 C.Y. On Service Drives
M	1959 A.F.E. 604	Spot Treat Bit. Surf. Repair	24'	1 1/2"	MC-2, 6747 Gal. Agg. 513 Tons
C	1962 2514-42	Traffic Signals			
C	1963	Raise Portals & Sway Frames on Br. 4995			By Maint. Br. Crew
C	1965 2514-45 2514-6197	P.C. Conc. Base conc. & Bit. Surf. Extend Br. 6197	4'	9"	Widening of Conc. Base Bit over P.C. Conc. a W108 D in place
C	1965 Maint. Project	Plant Mix Bit.	68'	2 1/2"	over concrete in p.
M	1967 SF	Bit. Surf. Repair	20'	1"	MC-800 Tack 425 Gal. Pl. Mix Bit. 465.89 Ton
C	1968 2514-49	Pl. Mixed Bit. Surf. Gravel Shldr.	20'	3"	Bit. Mat'l. 447 Ton 10' Rt. & Lt.

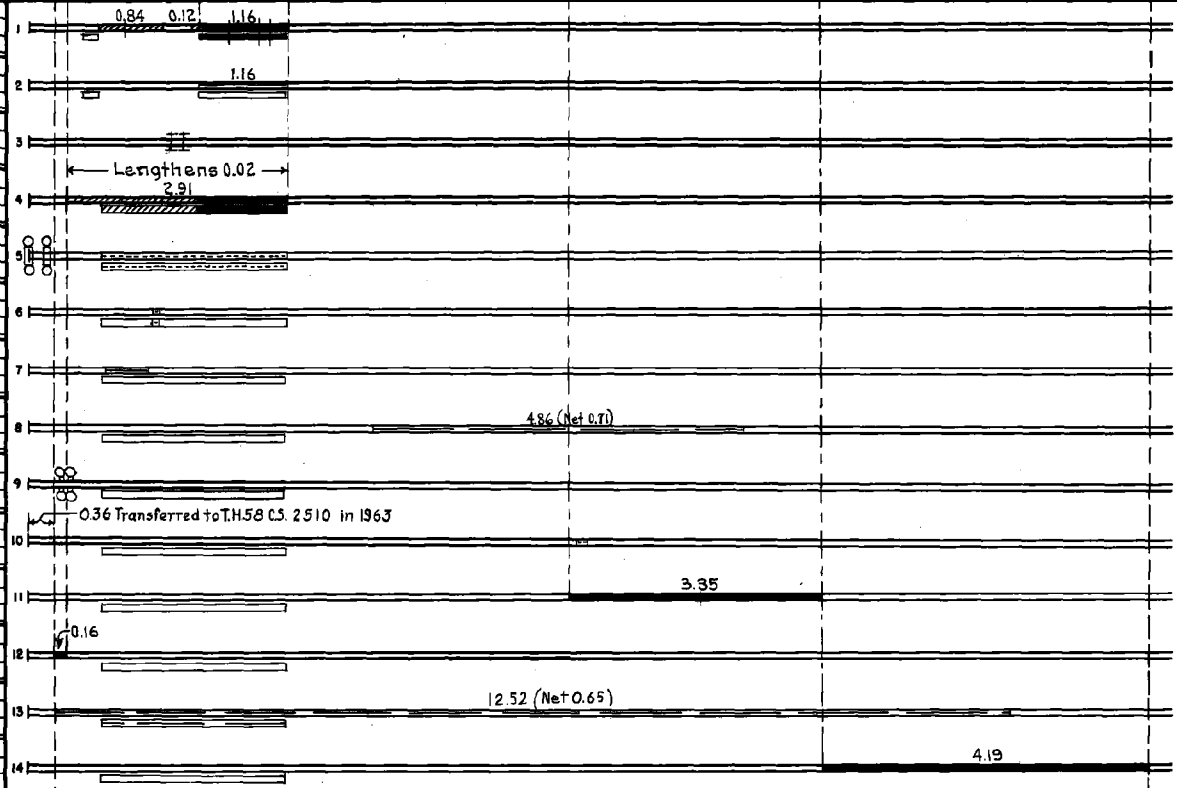

YEARS		TOTAL MILES	UNINCORPORATED		INCORPORATED		RURAL		URBAN	
FROM	TO		RDWY. MI.	BR. MI.	RDWY. MI.	BR. MI.	RDWY. MI.	BR. MI.	RDWY. MI.	BR. MI.

REMARKS: See Sheet No. 1
(1) 0.96 Mi. not in use. (2) C84, C104, C44 & C57 Pedestrian Underpass.

PREPARED BY
TRAFFIC AND PLANNING DIVISION
IN COOPERATION WITH
U.S. DEPARTMENT OF COMMERCE
BUREAU OF PUBLIC ROADS

STATE OF MINNESOTA
DEPARTMENT OF HIGHWAYS
ROAD LIFE STUDIES
CONSTRUCTION PROJECT LOG RECORD

CONTROL SECTION 2514
TRUNK HIGHWAY 61
COUNTY Goodhue
DISTRICT 2A-6B

LIMITS: Jct. T.H. 58 in Red Wing - W. Co. Line

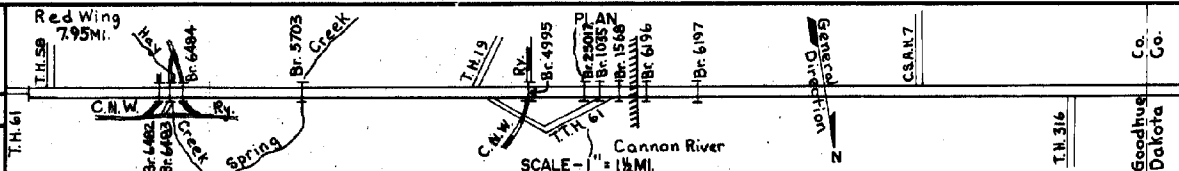

YEAR BUILT	PROJECT NO.	DESCRIPTION				REMARKS
		TYPE	WIDTH	THICKNESS		
M 1968	SF	Bit Surf. Repair	Var	Var	MC250 Tack 785 Gal. Agg. 385 Ton	
M 1969	SF	Bit Surf. Repair	Var	Var	MC250 Tack 349 Gal. Agg. 1453 Tons	
C 1971	2514-51	Plant Mix Bit Widening	13'	3"		
M 1972	SF	Bit. Shoulders	4	Var	177 Ton N.B. 177 Ton S.B.	
C 1974	HMS 003-3 (44)	Turn Lanes & Channelization				
C 1975	HMS 003-3(4)	TRAFFIC SIGNALS			AT MAIN ST AT TYLER RD	
C 1976	2514-56 (HMS 003-3(4))	GRADING Bit. SURFACING	20+3	2 3/4"		
M 1972	SF	SHOULDER REPAIR Bit. SHOULDER SURFACE	4'	2"	Base 1694 Ton Pl. Mix AC-1 (251) 354 T.	
M 1973	SF	Improve Shldr. Surf	10'	1"	AC-1 (231) WEAR SURF. 781. RC800 Tack 250 Gal.	
M 1976	SF	WIDEN INT. ROADWAY	2'	6"	551H 50 GAL. MC200 235 T. AC-1 (231) 1892.5 Ton MC 250 180 Ton	
C 1976	2514-60 (HMS 003-3(5))	Pl. Mix Bit. Overlay	7 1/2'	3/4"	FROM PINE ST (TH 58) TO BROAD ST	
C 1976	2514-63 (HMS 003-3(4))	TRAFFIC SIGNALS			MAIN ST (TH 11) BUS ST. PLUM ST (TH 63), AND BROAD ST	
M 1977	SF	BR. 4988 SEAL COAT & WITH PREPARK AGG.	50		RS-2 SEAL 1800 GAL. PREPARK 20 Ton	
C 1980	2514-76	Div. 2 Widening & Road W. Side Inclusion	22'	1 1/2"	0.1 MI. W. of Jct. TH 516 0.2 MI. W. of Jct. BROAD ST	

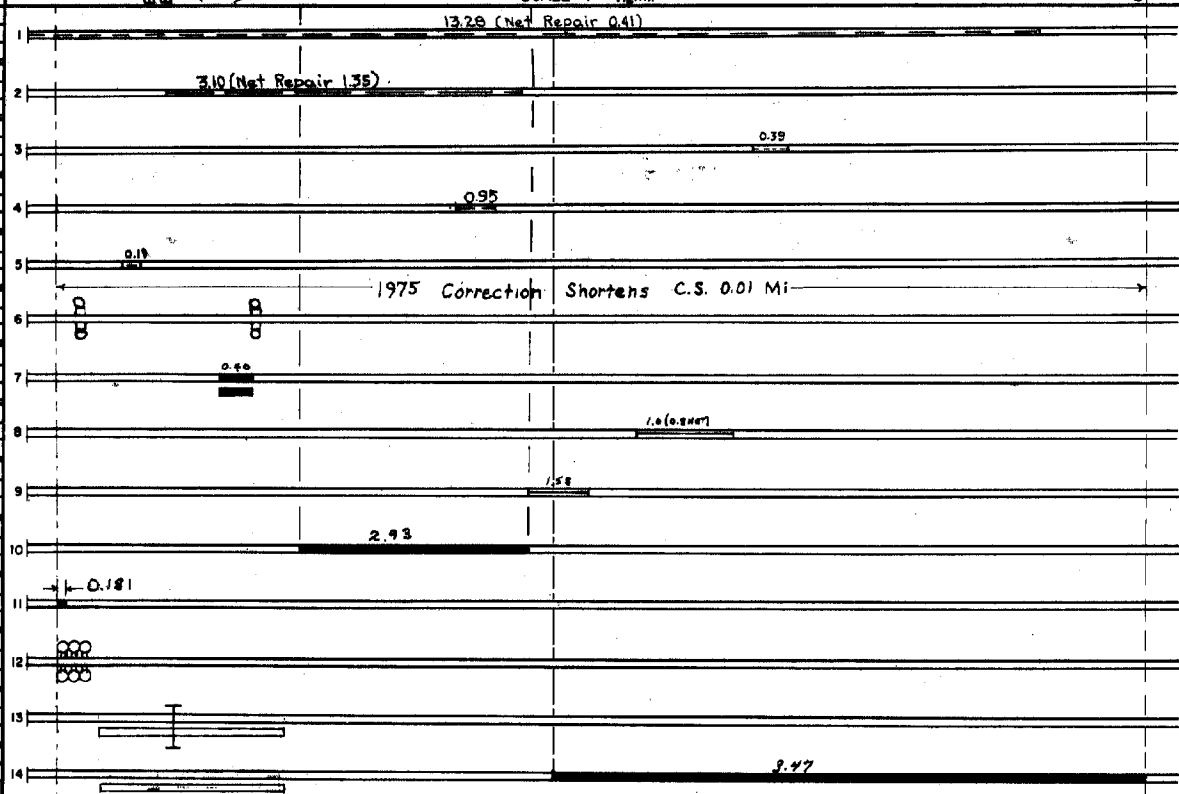

YEARS FROM	TOTAL MILES TO	UNINCORPORATED		INCORPORATED		RURAL		URBAN	
		RDWY. MI.	BR. MI.	RDWY. MI.	BR. MI.	RDWY. MI.	BR. MI.	RDWY. MI.	BR. MI.

REMARKS: See Sheet No. 1

