

PREPARED BY
HIGHWAY PLANNING SURVEY
IN COOPERATION WITH
U.S. PUBLIC ROADS ADMINISTRATION

STATE OF MINNESOTA
DEPARTMENT OF HIGHWAYS
ROAD LIFE STUDIES
CONSTRUCTION PROJECT LOG RECORD

CONTROL SECTION 2509
TRUNK HIGHWAY 87
COUNTY Goodhue
DISTRICT 6B

LIMITS: S. Co. Line - Jct. T.H. 52

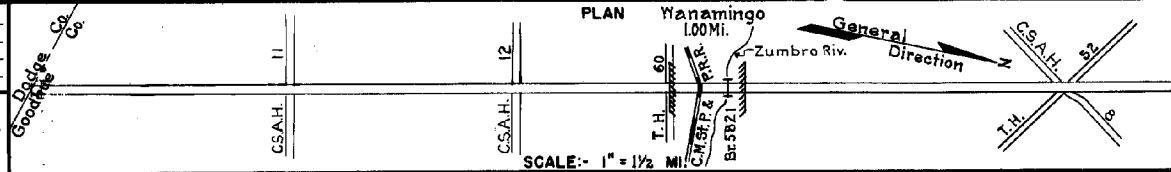

YEAR BUILT	PROJECT N ^o	DESCRIPTION			CODE N ^o
		TYPE	WIDTH	THICKNESS	
1923		Gravel Br. 8225	24' 21'	2 1/2" 2 1/2"	Co. Job 2305 Added in 1934. 1200 C.Y./Mi. 12' B.S.
1923		Gravel Br. X-722	24' 16'	3"	Co. Job 2304 Added in 1934. 1400 C.Y./Mi. 64' L.I.
1923		Br. 4778	23'		60' B.S.
1936		Regrading Gravel	24' 20'	2 1/2"	900 C.Y./Mile. Maint. Dept.
1937	A.F.E. 11	Regrading Gravel	26' 20'	2 1/2"	Maint. Dept.
1938		Br. 542			Extend W 106' 8" Maint. Dept.
1938		Br. 5821	30'		60' B.S. Maint. Dept.
1938	A.F.E. 30	Bit. Surf. Treat.	24'	3/4"	Maint. Dept.
M	1940	A.F.E. 46	Spot Graveling		98 C.Y./Mi. Maint. Dept.
M	1940	A.F.E. 18	Bit. Retreat		SC 283,284 Gal./Mi. Grav. 70 C.Y./Mi. Maint. Dept.
M	1941	A.F.E. 9	Spot Treat. Bit. Surf. Repair	21-30'	SC 283,449 Gal./Mi. Grav. 102 C.Y./Mi. Maint. Dept.
M	1942	A.F.E. 16 A.F.E. 4	Spot Treat. Bit. Surf. Repair	21-30'	SC 3,243 Gal./Mi. Grav. 48 C.Y./Mi. Maint. Dept.
M	1943	A.F.E. 4	Spot Treat. Bit. Surf. Repair	21-30'	MC 2,436 Gal./Mi. Grav. 79 C.Y./Mi. Maint. Dept.
M	1943	A.F.E. 6	Grav. Resurface (Spots)		305 C.Y./Mi. Maint. Dept.

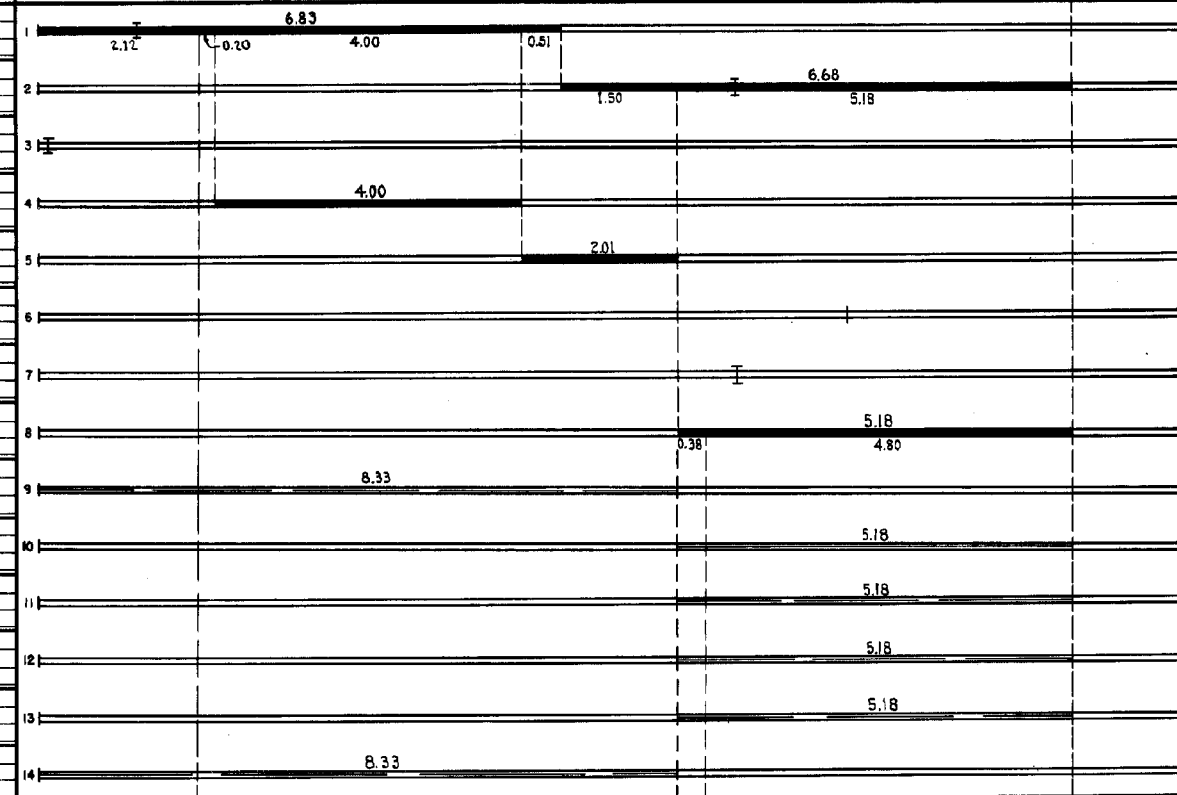

YEARS FROM	TO	TOTAL MILES	UNINCORPORATED		INCORPORATED		RURAL		URBAN	
			RDWY. MI.	BR. MI.	RDWY. MI.	BR. MI.	RDWY. MI.	BR. MI.	RDWY. MI.	BR. MI.
1934	1950	13.51	12.50	0.01	0.99	0.01	13.49	0.02	0.00	0.00
1951	1954	3.17	2.16	0.01	0.99	0.01	13.15	0.02	0.00	0.00
1955	1963	11.99	10.99	0.00	0.99	0.01	11.98	0.01	0.00	0.00
1964		12.00	11.00	0.00	0.99	0.01	11.99	0.01	0.00	0.00

REMARKS: Layout is to scale as of 1934

PREPARED BY
HIGHWAY PLANNING SURVEY
IN COOPERATION WITH
U.S. PUBLIC ROADS ADMINISTRATION

STATE OF MINNESOTA
DEPARTMENT OF HIGHWAYS
ROAD LIFE STUDIES
CONSTRUCTION PROJECT LOG RECORD

CONTROL SECTION 2509
TRUNK HIGHWAY 57
COUNTY Goodhue
DISTRICT 6B

LIMITS: S.Co.Line - Jct.T.H.52

Dodge Co.
Goodhue Co.

PLAN Winamingo
100 Mi.

General
Direction

SCALE: 1" = 1/2 MI.

YEAR BUILT	PROJECT N ^o	DESCRIPTION			CODE N ^o
		TYPE	WIDTH	THICK-NESS	
M 1944	A.F.E. 4	Spot Treat. Bit.Surf. Repair	20'		
M 1944	A.F.E. 6	Grav.Resurfacing (Spots)			
C 1945	A.F.E. 19	Bit.Resurfacing Mixed Bit.	24'	3/4" added	
M 1945	A.F.E. 6	Grav.Resurfacing (Spots)	20'		
M 1946	A.F.E. 4	Spot Treat. Bit. Surf. Repair	22'		
C 1946	A.F.E. 18	Bit. Resurfacing Mixed Bit.	24'	1" added	
M 1947	A.F.E. 4	Spot Treat. Bit. Surf. Repair & Fog Seal	22'		
M 1948	A.F.E. 4	Spot Treat. Bit. Surf. Repair	22'		
M 1948	A.F.E. 6	Grav. Resurfacing			
M 1949	A.F.E. 4	Spot Treat. Bit. Surf. Repair	22'		
M 1950	A.F.E. 4	Spot Treat. Bit. Surf. Repair	22'		
C 1950	A.F.E. 19	Sand-Gravel Base Bit Surfacing Mixed Bit.	28'	3"-9" 24' 1"	
M 1951	A.F.E. 4	Spot Treat. Bit. Surf. Repair Spot Bit. Seal	22'		
C 1951	2509-03 (1)	Grading Crushed Rock C85, C65 & 2-C46	34'	1 1/2"	

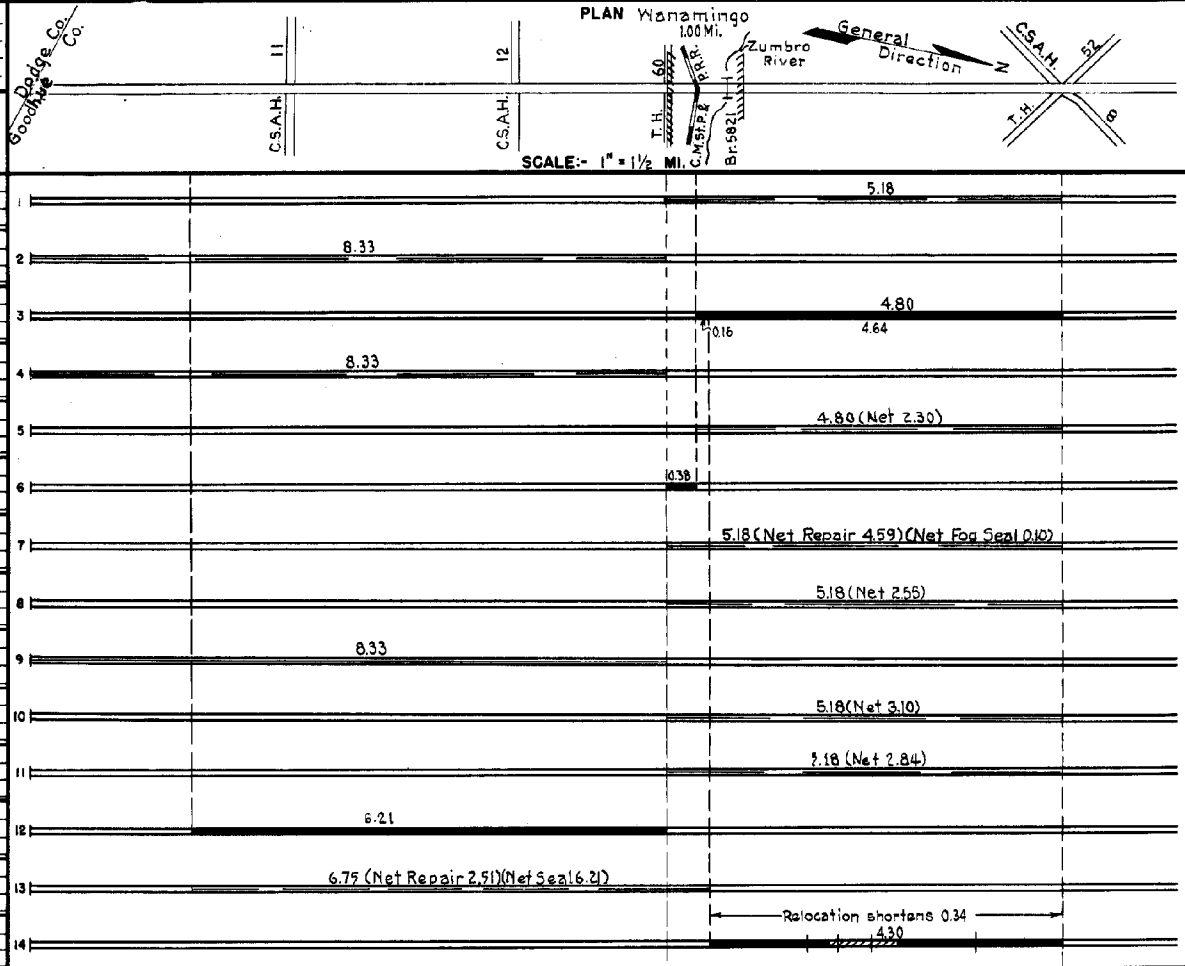

YEARS FROM	TO	TOTAL MILES	UNINCORPORATED		INCORPORATED		RURAL		URBAN	
			RDWY. MI.	BR. MI.	RDWY. MI.	BR. MI.	RDWY. MI.	BR. MI.	RDWY. MI.	BR. MI.

REMARKS: See Sheet No 1
 (1) Contract not final but work substantially complete in 1951.

PREPARED BY
HIGHWAY PLANNING SURVEY
IN COOPERATION WITH
U.S. PUBLIC ROADS ADMINISTRATION

STATE OF MINNESOTA
DEPARTMENT OF HIGHWAYS
ROAD LIFE STUDIES
CONSTRUCTION PROJECT LOG RECORD

CONTROL SECTION 2509
TRUNK HIGHWAY 27
COUNTY Goodhue
DISTRICT 6B

LIMITS: S.Co.Line - Jct.T.H.52

Dodge Co.
Goodhue Co.

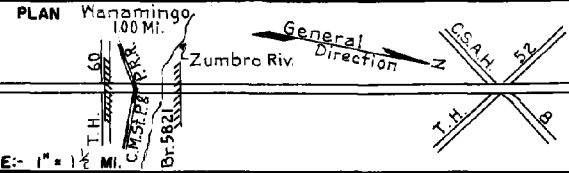

YEAR BUILT	PROJECT NO	DESCRIPTION			CODE NO	MILES
		TYPE	WIDTH	THICKNESS		
M 1952	A.F.E. 4	Spot Treat Bit Surf. Repair	22'		MC-3, 31,759 Gal. Agg. 1512 C.Y.	1 6.75 (Net 3.38)
M 1952	A.F.E. 6	Grav. Resurface			1053 C.Y.	2 2.12
C 1953	2509-08 2509-06	Sand-Grav. Subbase Crushed Rock Base Plant Mix Bit.	20' 6-7" 20' 3-6" 20' 1 1/2"			3 4.84 4.14
M 1953	A.F.E. 604	Spot Treat Bit Surf. Repair	22'		MC2, 9361 Gal. Agg. 472 C.Y.	4 6.21 (Net 1.43)
M 1954	A.F.E. 604	Spot Treat Bit Surf. Repair	22'		MC-2, 11480 Gal. Agg. 823 Tons	5 6.21 (Net 1.50)
M 1955	A.F.E. 606	Grav. Resurfacing	24'		783 Tons	6 2.12
C 1955	2509-10 2509-11	Grading Gravel	36' 26'		Const. C1010 1200 C.Y./Mi.	7 7.15 Relocation shortens 1.18
C 1956	2508-12	Sand-Grav. Sub-base Crushed Rock Base Plant Mix Bit.	24' 6-9" 24' 3" 24' 1 1/2"			8 7.15
M 1958	A.F.E. 605	Light Bit. Seal	25'		RS-2, 21868 Gal. Agg. 695 C.Y.	9 11.99
M 1961		Light Bit. Seal	25'		RS-2, 7723 Gal. Agg. 280 C.Y.	10 4.29
C 1964	2506-07 & 19	Grading Sub-Base Gravel Base Plant mix Bit	24' 5" 3-4"		9 1/2" Sand-gravel Sub-Base	11 Relocation Lengthens 0.01
M 1964	C	Light Bit. Seal	25'		RS-2K, 21886 Gal. Agg. 739 C.Y.	12 11.82
M 1967	SF	Bit Surf. Repair	20' 1"		Bit. Mixture 783 Ton	13 7.15 (Net 1.20)
C 1968	2509-13	Pl. Mix. Bit. Surf. Gravel Slides	24' 1 1/2"		Bit. Mat'l. 396 Ton	14 4.28

YEARS FROM	TOTAL MILES TO	UNINCORPORATED		INCORPORATED		RURAL		URBAN	
		ROWY. MI.	BR. MI.	ROWY. MI.	BR. MI.	ROWY. MI.	BR. MI.	ROWY. MI.	BR. MI.

REMARKS: See Sheet No. 1

PREPARED BY
TRANSPORTATION & TRANSIT PLANNING & PROGRAMMING DIVISION
IN COOPERATION WITH
U.S. DEPARTMENT OF TRANSPORTATION-BUREAU OF PUBLIC ROADS

STATE OF MINNESOTA
DEPARTMENT OF HIGHWAYS
ROAD LIFE STUDIES
CONSTRUCTION PROJECT LOG RECORD

CONTROL SECTION 2509
TRUNK HIGHWAY 52
COUNTY Goodhue
DISTRICT 6B

LIMITS: S. Co. Line - Jct T.H. 52

Ref. Pt. 012+00.251 - 024+00.395

Dodge Co.
Goodhue Co.

PLAN

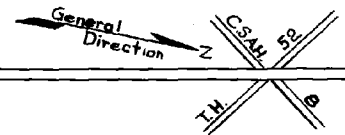
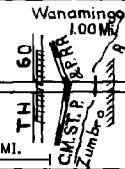

YEAR BUILT	PROJECT NO	DESCRIPTION	WIDTH	THICKNESS	REMARKS
C					
1971	2509-14	Plant Mix Bit Surface Gravel Shoulders	24"	3"	4' Right & Left
1975	2509-15	Pl. Mix Bit Resurf Gravel Shldrs	24'	3"	10' At 4-LT
M					
1971	SF	Spot Base Repair	Var.	Var.	CRUSHED ROCK 185 Ton
M					
1977	SF	Restore Agg. Shldrs.	4'	1"	Agg. 223 Ton
M					
1981	SF	Regrade Shoulders	4'	Var.	2,234 Ton
M					
1980	SF	Bit. Surf. Repair (Spot) Place Gravel Shoulders	24' 4'	1 1/2" Var.	1,348 Ton AC2331Wear 623 Ton Tack 880 gal. CRS 2
M					
1983	SF	Spot Bit. Overlay	40'	Var.	Pl. Mix 2331 154 Ton
M					
1984	SF	Spot Bit. Overlay	24'	1 1/2"	Sp. 2331 70 Tons
M					
1985	SF	Spot Overlay	24'	1 1/2"	Spec. 2331
M					
1985	SF	Gravel Shouldering	3'	3"	
M					
1986	SF	Gravel Shouldering	3'	2"	
M					
1986	SF	Spot Overlay	24'	1 1/2"	Spec. 2331
M					
1986	SF	Spot Overlay	24'	1 1/2"	Spec. 2331
M					
1986	M4197	Bit. Overlay	24'	1 1/2"	Spec. 2331

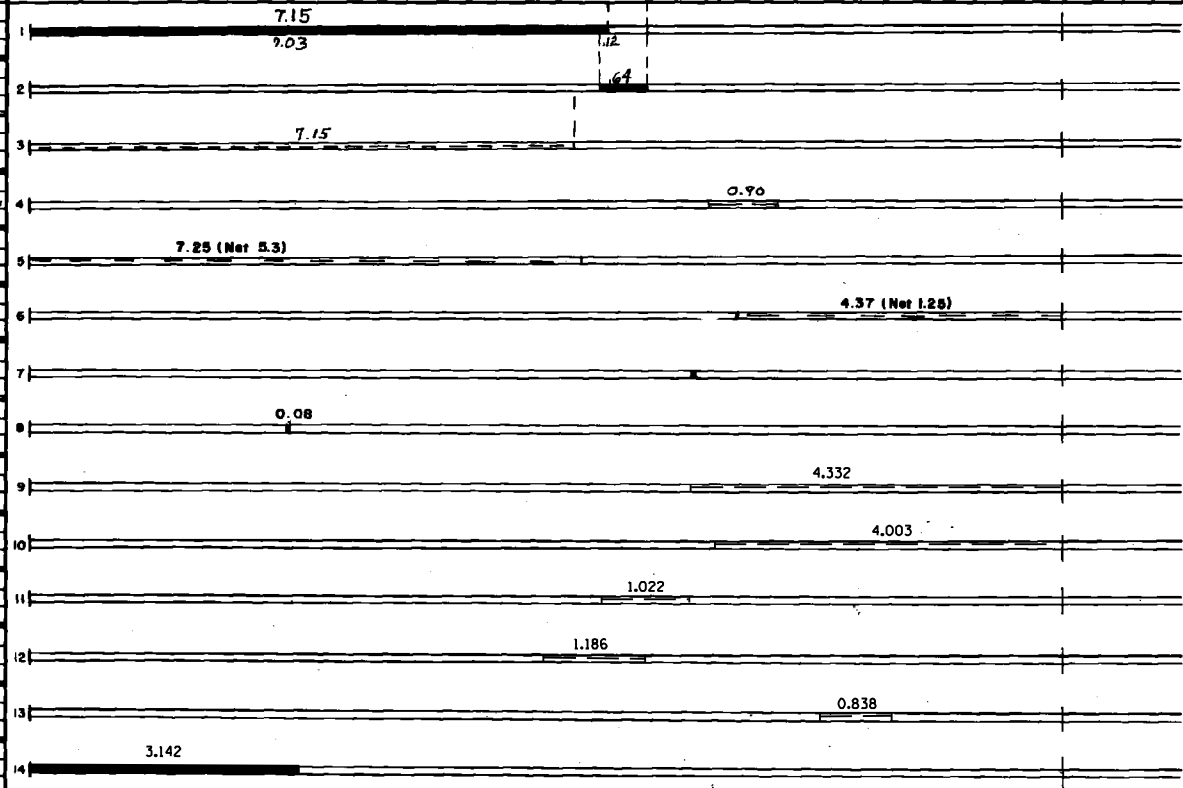

YEARS		TOTAL MILES	UNINCORPORATED		INCORPORATED		RURAL		URBAN	
FROM	TO		ROWY. MI.	BR. MI.	ROWY. MI.	BR. MI.	ROWY. MI.	BR. MI.	ROWY. MI.	BR. MI.

REMARKS: See Sheet 1

PREPARED BY
BUREAU OF POLICY & PLANNING
IN COOPERATION WITH
U. S. DEPARTMENT OF TRANSPORTATION - FEDERAL HIGHWAY ADMINISTRATION

STATE OF MINNESOTA
DEPARTMENT OF TRANSPORTATION
CONSTRUCTION PROJECT LOG RECORD

CONTROL SECTION 2509
TRUNK HIGHWAY 57
COUNTY Goodhue
DISTRICT 6B

LIMITS: Dodge/Goodhue Co. Line - Jct. USTH-52
Ref. Pt. 012+00.251 - 024+00.395

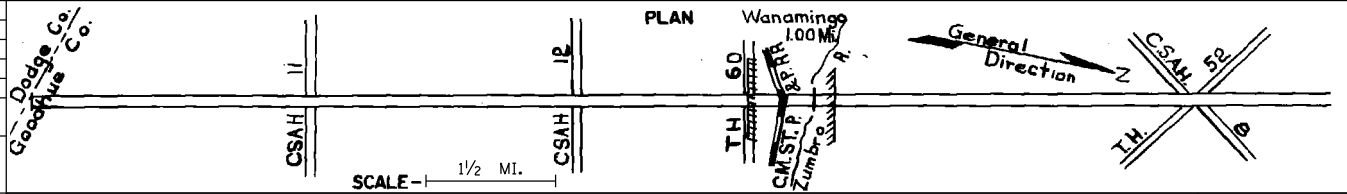

YEAR BUILT	PROJECT No	DESCRIPTION			REMARKS
		TYPE	WIDTH	THICKNESS	
M 1986	SF	Gravel Shouldering	4'	2 1/2"	
M 1987	M4229	Bit. Overlay	24'	1 1/2"	Spec. 2331
M 1987	SF	Gravel Shouldering	4'	2"	
M 1987	SF	Bit. Sealing			
M 1990	SF	Gravel Shouldering	3'	2"	
M 1998	M98459	Bit. Overlay	24'	1 1/2"	Spec. 2350
S 2004	2509-19	Mill & Bit Overlay Grading Bit Surface Br-25027 repl Br-5821	24' 42'	3" 7"	Spec. 2350
S 2007	2509-21	Milling Bit. Overlay	24'	var.	Spec. 2360
D 2009	8826-67	Rout & Seal			
2011	8826-105	Bit. Seal Coat			
2012	2509-22	Milling Bit. Overlay	27' 27'	1.5" 4"	Spec. 2360

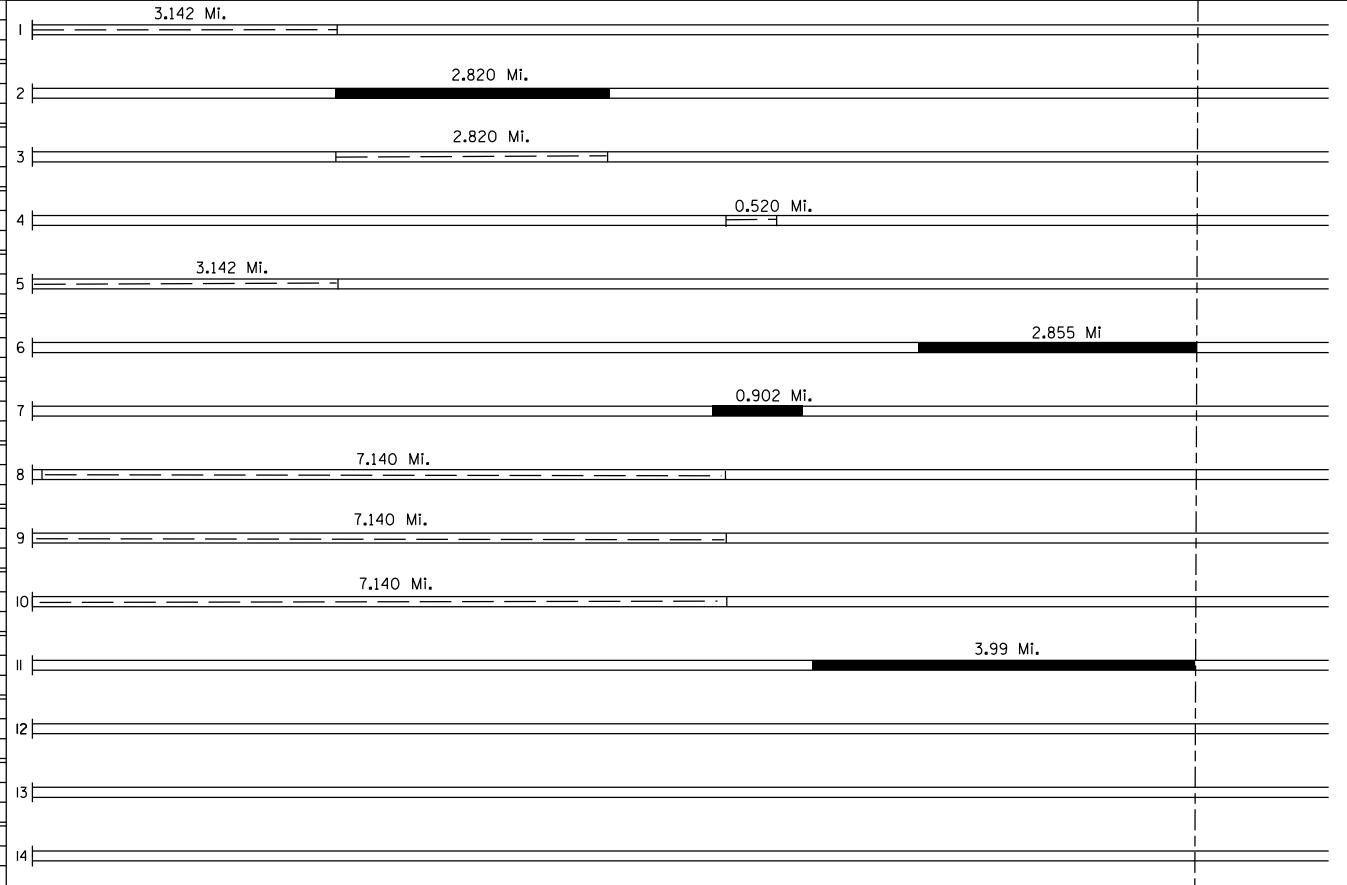

YEARS FROM TO		TOTAL MILES	UNINCORPORATED RDWY. MI. BR. MI.		INCORPORATED RDWY. MI. BR. MI.		RURAL RDWY. MI. BR. MI.		URBAN RDWY. MI. BR. MI.	

REMARKS: