

PREPARED BY  
HIGHWAY PLANNING SURVEY  
IN COOPERATION WITH  
U.S. PUBLIC ROADS ADMINISTRATION

STATE OF MINNESOTA  
DEPARTMENT OF HIGHWAYS  
ROAD LIFE STUDIES  
CONSTRUCTION PROJECT LOG RECORD

CONTROL SECTION 2204  
TRUNK HIGHWAY 22  
COUNTY Faribault  
DISTRICT 7A

LIMITS: Jct. T.H. 90-N.Jct. T.H. 109 at W. Corp. Limits of Wells

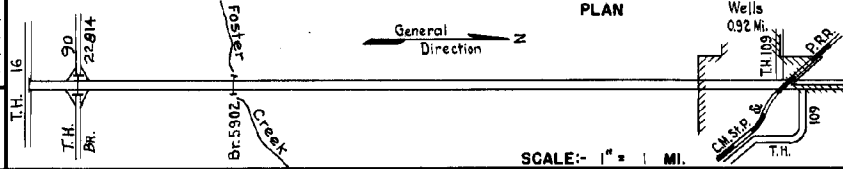

YEAR BUILT	PROJECT N <sup>o</sup>	DESCRIPTION			CODE N <sup>o</sup>
		TYPE	WIDTH	THICKNESS	
		Gravel			No Record of Constr.
		Grading Br. 2391	30' 16'		No Record of Constr. 48' L.T.
1921	22-39-1	Gravel	24'	3"	Co. Job 2001. 1400 C.Y./Mile.
1923	22-39-23	Br. 4051	20'		50' L.T.
1930		Tar Tr. Gravel	22'	1/2"	Maint. Dept.
	(1)				
1936	22-39-1	Tar Tr. Gravel	22'	1/2"	Maint. Dept.
C		Grading	36'		
1940	2204-01	Gravel	28'	1 1/2"	
	2204-03	Br. 5902			C(11-14-11) 12 T.
C					
1941	2204-04	Xing Signal			
C					
1941	A.F.E. 28	Seeding			Seed supplied by R.S.D.(S.P. 2204-07) Maint. Dept.
C					
1941	2204-06	Stab. Grav. Base Mixed Bit.	32' 26'	6 1/2" 1"	
C					
1941	A.F.E. 49	Guard Rail			Maint. Dept.
M					
1942	A.F.E. 5	Bit. Seal Coat			RG3 2802 Gal./Mi. Sand 15 C.Y./Mi. Maint. Dept.
M					
1943	A.F.E. 21	Rebuilding Shoulders with Earth			Earth 749 C.Y./Mi. Maint. Dept.
(2)		Bit. Surf. Treat.			

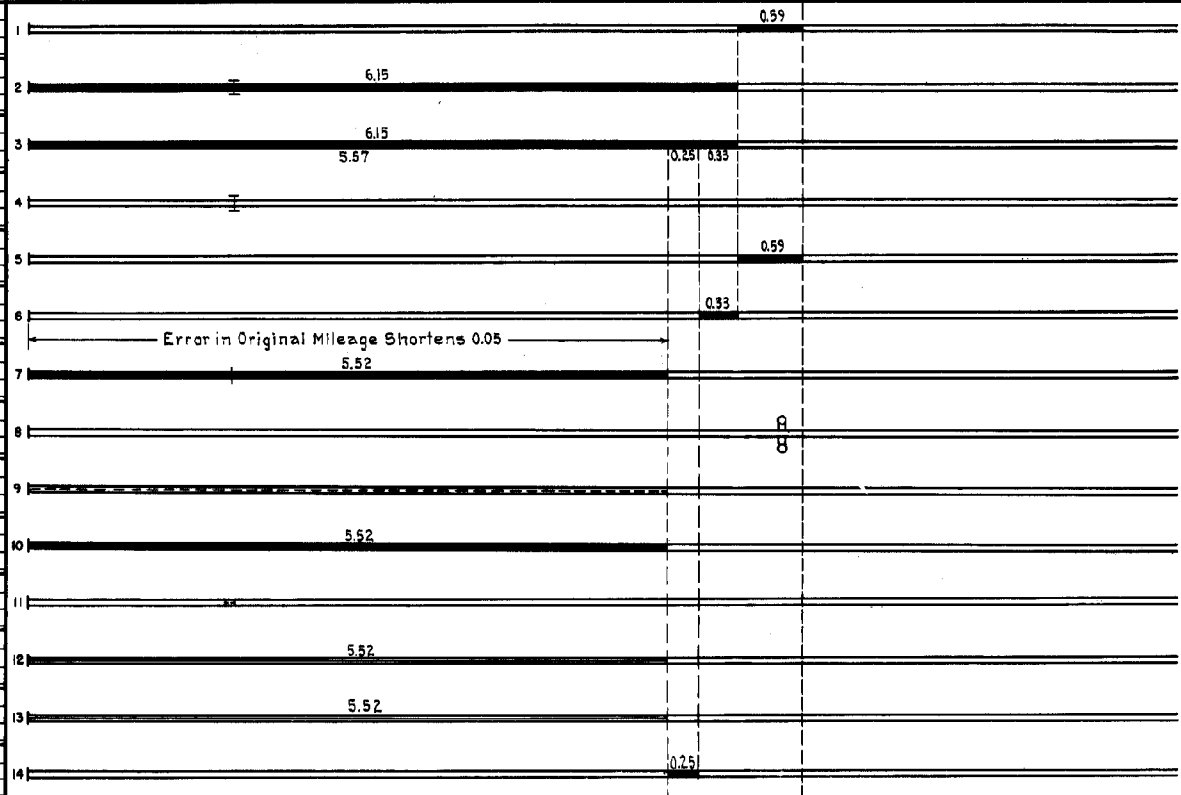

YEARS		TOTAL MILES	UNINCORPORATED		INCORPORATED		RURAL		URBAN	
FROM	TO		RDWY. MI.	BR. MI.	RDWY. MI.	BR. MI.	RDWY. MI.	BR. MI.	RDWY. MI.	BR. MI.
1921	1939	6.74	5.61	0.01	0.92	0.00	5.61	0.01	0.92	0.00
1940	1974	6.69	5.77	0.00	0.92	0.00	5.77	0.00	0.92	0.00
1975		6.27	5.35		0.92		5.35		0.92	

REMARKS: Layout is to scale as of 1921  
(1) This work not done under this project number but lies within the limits of this project. (2) No record of bituminous surfacing job on this section, however reports indicate bituminous surface in existence.

12-75

PREPARED BY  
HIGHWAY PLANNING SURVEY  
IN COOPERATION WITH  
U. S. PUBLIC ROADS ADMINISTRATION

STATE OF MINNESOTA  
DEPARTMENT OF HIGHWAYS  
ROAD LIFE STUDIES  
CONSTRUCTION PROJECT LOG RECORD

CONTROL SECTION 2204  
TRUNK HIGHWAY 22  
COUNTY Faribault  
DISTRICT 7A

LIMITS - Jct. T.H. 90 - N. Jct. T.H. 109 at W. Corp. Limits of Wells

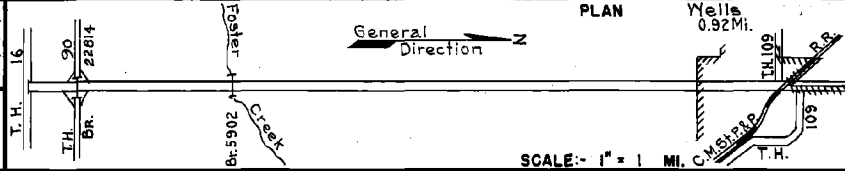

YEAR BUILT	PROJECT N°	DESCRIPTION			CODE N°
		TYPE	WIDTH	THICKNESS	
M 1945	A.F.E. 4	Bit. Surf. Repair			
M 1946	A.F.E. 24	Subtr. Correction			
M 1947	A.F.E. 4	Bit. Surf. Repair	24'		
C 1947	2204-11	Bit. Resurfacing Plant Mixed Bit.	24'	1 1/2" added	
M 1948	A.F.E. 5 A.F.E. 18	Bit. Seal Coat Spot Subgr. Corr.	24'		
C 1948	2204-10	Grading Concrete	22x20	9-7-9	
C 1949	2204-12	Sodding & Sidewalk Constr.			
M 1951	A.F.E. 4	Spot Bit. Seal	6-12		
M 1952	A.F.E. 5	Light Bit. Seal	24'		
M 1956	A.F.E. 604	Spot Treat Bit. Surf. Repair	24'		
M 1957	A.F.E. 604	Spot Treat Bit. Surf. Repair	24'		
M 1958	A.F.E. 604	Spot Treat Bit. Surf. Repair	24'		
M 1959	A.F.E. 604	Spot Treat Bit. Surf. Repair	24'	1"	
C 1961		Plant Mix Bit.	24'	1 1/2"	

LINE NO.	PROJECT N°	DESCRIPTION	WIDTH	THICKNESS	REMARKS	CODE N°
1	A.F.E. 4	Bit. Surf. Repair			MC-3, 1591 Gal. / Mi. Grav. 36 C.Y. / Mi. Maint. Div.	
2	A.F.E. 24	Subtr. Correction				
3	A.F.E. 4	Bit. Surf. Repair	24'		MC-3, 1463 Gal. Agg. 67 C.Y.	
4	2204-11	Bit. Resurfacing Plant Mixed Bit.	24'	1 1/2" added		
5	A.F.E. 5 A.F.E. 18	Bit. Seal Coat Spot Subgr. Corr.	24'		RC-3 & MC-3, 1770 Gal. Agg. 514 C.Y.	
6	2204-10	Grading Concrete	22x20	9-7-9		
7	2204-12	Sodding & Sidewalk Constr.				
8	A.F.E. 4	Spot Bit. Seal	6-12		MC-3, 952 Gal. Agg. 38 C.Y.	
9	A.F.E. 5	Light Bit. Seal	24'		RC-5-2, 9396 Gal. Agg. 335 C.Y.	
10	A.F.E. 604	Spot Treat Bit. Surf. Repair	24'		MC-3, 2009 Gal. Agg. 1298 Tons	
11	A.F.E. 604	Spot Treat Bit. Surf. Repair	24'		MC-3, 10532 Gal. Agg. 812 Tons	
12	A.F.E. 604	Spot Treat Bit. Surf. Repair	24'		MC-3, 10388 Gal. Agg. 693 Tons	
13	A.F.E. 604	Spot Treat Bit. Surf. Repair	24'	1"	MC-3, 23246 Gal. Agg. 1764 Tons	
14		Plant Mix Bit.	24'	1 1/2"	By Maint. over surf. in place	

0.20' 0.48' 0.20' 4.89

YEARS FROM	TO	TOTAL MILES	UNINCORPORATED		INCORPORATED		RURAL		URBAN	
			RDWY. MI.	BR. MI.	RDWY. MI.	BR. MI.	RDWY. MI.	BR. MI.	RDWY. MI.	BR. MI.

REMARKS: See Sheet N° 1  
(1) Contract not final but work substantially complete in 1948.

PREPARED BY  
TRAFFIC AND PLANNING DIVISION  
IN COOPERATION WITH  
U.S. DEPARTMENT OF COMMERCE  
BUREAU OF PUBLIC ROADS

STATE OF MINNESOTA  
DEPARTMENT OF HIGHWAYS  
ROAD LIFE STUDIES  
CONSTRUCTION PROJECT LOG RECORD

CONTROL SECTION 2204  
TRUNK HIGHWAY 28  
COUNTY Fairbault  
DISTRICT 7A

LIMITS: Jct. T.H. 90 - N. Jct. T.H. 109 at W Corp. Limits of Wells  
Ref. Pt. 012+00.144 - 018+00.444

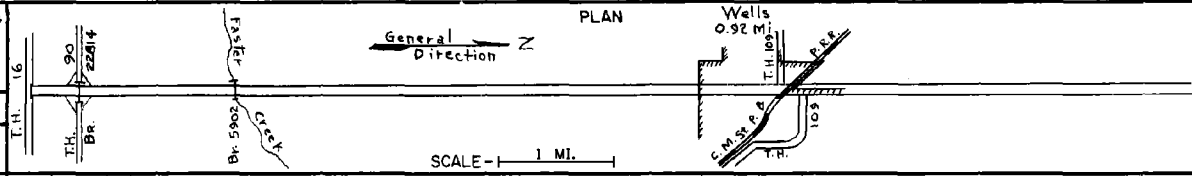

YEAR BUILT	PROJECT NO	DESCRIPTION				REMARKS
		TYPE	WIDTH	THICKNESS		
M 1965	C	Light Bit. Seal	24'			RS-1C, 9276 Gal. Agg. 366 C.Y.
C 1973	2204-15 S-4012(2)	Base Grading & Bit. Surfacing	24'	3"		
C 1975	-14	GRADE BIT. BASE Pl. Mix BIT. SURF.	30' 24'	8" 3"		SEE C.S. 2280 FOR DETAILS OF BR22804
	1090-2(53)138	P. Mix BIT. SHLDRS.	10'			
C 1974	2204-19	P. Mix Bit. Surf. Grav. Shoulders	24' 3'	3"		
M 1981	SF	Regravel Shoulders	4'	3"		2998 Tons
M 1982	2204-20	Guardrail Improvement				Br. 5902
M 1988	SF	Spot Overlay		2"		Spec. 2331
M 1989	SF	Gravel Shouldering				
M 1989	SF	Spot Overlay				Spec. 2331
M 1989	SF	Bit. Overlay	24'	2"		Spec. 2341
M 1990	SF	Spot Overlay		3"		Spec. 2331
S 2001	2204-23	Bit. Overlay Agg. Shoulder	24' var.	2" 2"		Spec. 2350 Class 2
C 2003	2204-24	Bit. Overlay	24'	3"		Spec 2360

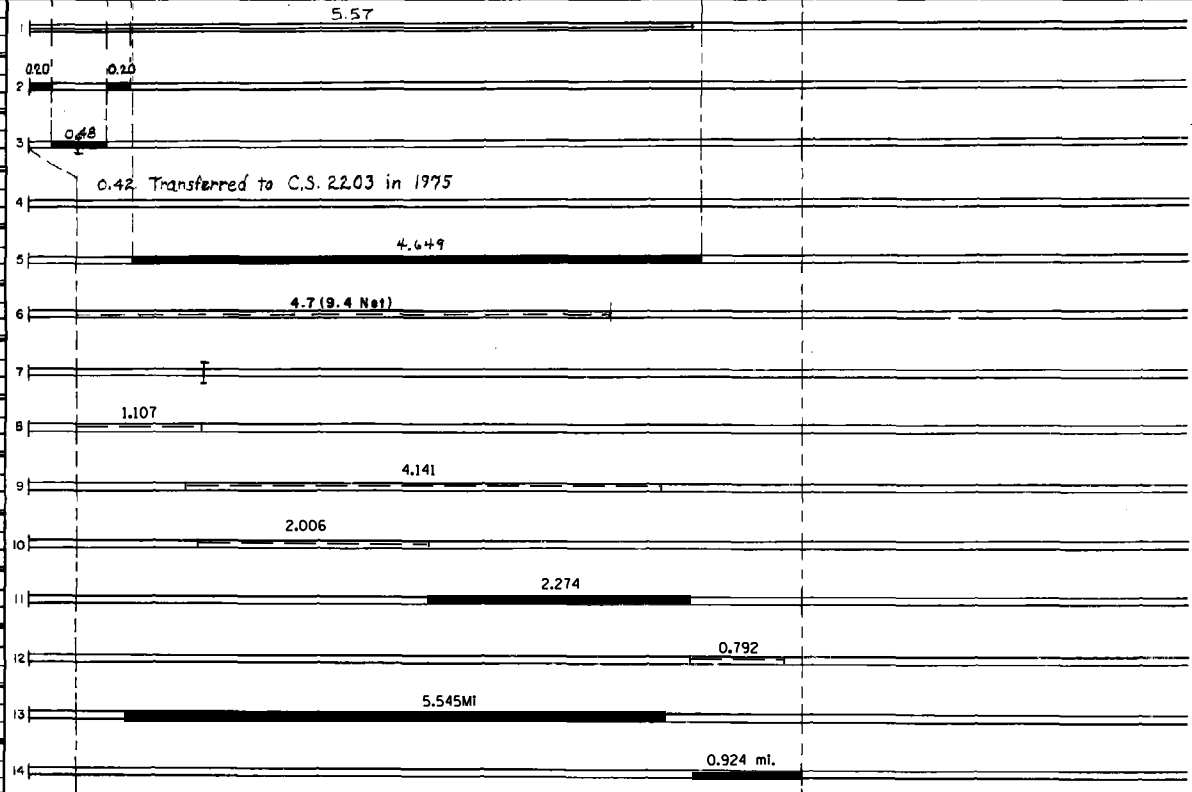

YEARS		TOTAL MILES	UNINCORPORATED		INCORPORATED		RURAL		URBAN	
FROM	TO		RDWY. MI.	BR. MI.	RDWY. MI.	BR. MI.	RDWY. MI.	BR. MI.	RDWY. MI.	BR. MI.

REMARKS: See Sheet No. 1