

PREPARED BY
HIGHWAY PLANNING SURVEY
IN COOPERATION WITH
U.S. PUBLIC ROADS ADMINISTRATION

STATE OF MINNESOTA
DEPARTMENT OF HIGHWAYS
ROAD LIFE STUDIES
CONSTRUCTION PROJECT LOG RECORD

CONTROL SECTION 0915
TRUNK HIGHWAY 210
COUNTY Carlton
DISTRICT 1A

LIMITS: Jct. T.H. 73 in Cromwell - Jct. T.H. 61

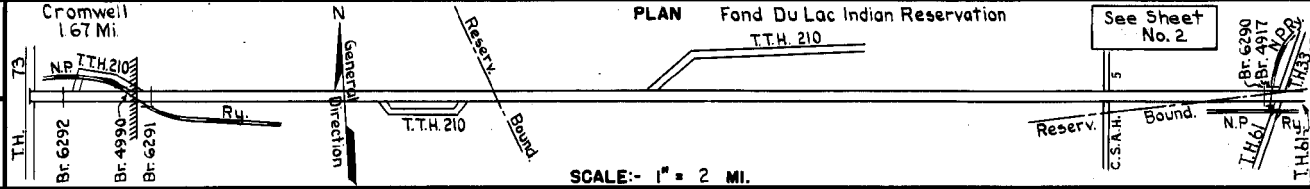

YEAR BUILT	PROJECT N°	DESCRIPTION			CODE N°
		TYPE	WIDTH	THICKNESS	
		Gravel	24'	2-3"	No Record of Constr.
1919	210-2-11	Grading Gravel	24'	2"	Co. Job 1903.
1920	210-2-10	Grading Br. 3391	30'		
1921	210-2-10	Gravel	24'	3 1/2"	1600 CY/Mile.
1922	210-2-26	Br. 3717			20' Bridge. (Retired in 1930)
1930	210-2-40-1&2	Grading Br. 6292, 4990, 6291, 4917 & 6290	40' 27'		W106D, 150' T.P.G.-O.H. 2-W1010D & 101' B.S.-O.H.
1931	210-2-40-1	Gravel	28'	1 1/2"	800 CY/Mile.
1932	210-2-40-1A&B&C	Concrete	20'	9-9"	Widened to 50' from Mi. Pt. 0.00-0.24 by City.
C	1948 0915-01	Regrading			
C	1952 0915-03	Base Work Plant Mix Bit.	28'	3"	On old concrete.
M	1954 A.F.E. 819 A.F.E. 605	Sag & Dip Removal With Plant Mix Bit. Light Bit Seal *	20'		Bit Mixture 1226 Tons Rt-8 & MC-2, 2351 Gal. * At Jct. T.H. 61
M	1954 A.F.E. 605	Light Bit Seal on 1954 Repair	20'		RC-2, 960 Gal. Agg. 80 CY.
C&M	1959 A.F.E. 833 A.F.E. 825	Guard Rail (Net 18) Bit Surf. Repair *	20'	1"-3"	* Spot Treat, subgrade connection Mi. Pt. 5.16- 5.21
M	1960	Spot Treat Bit Surf. Repair	20'		Plant Mix 1238 Tons

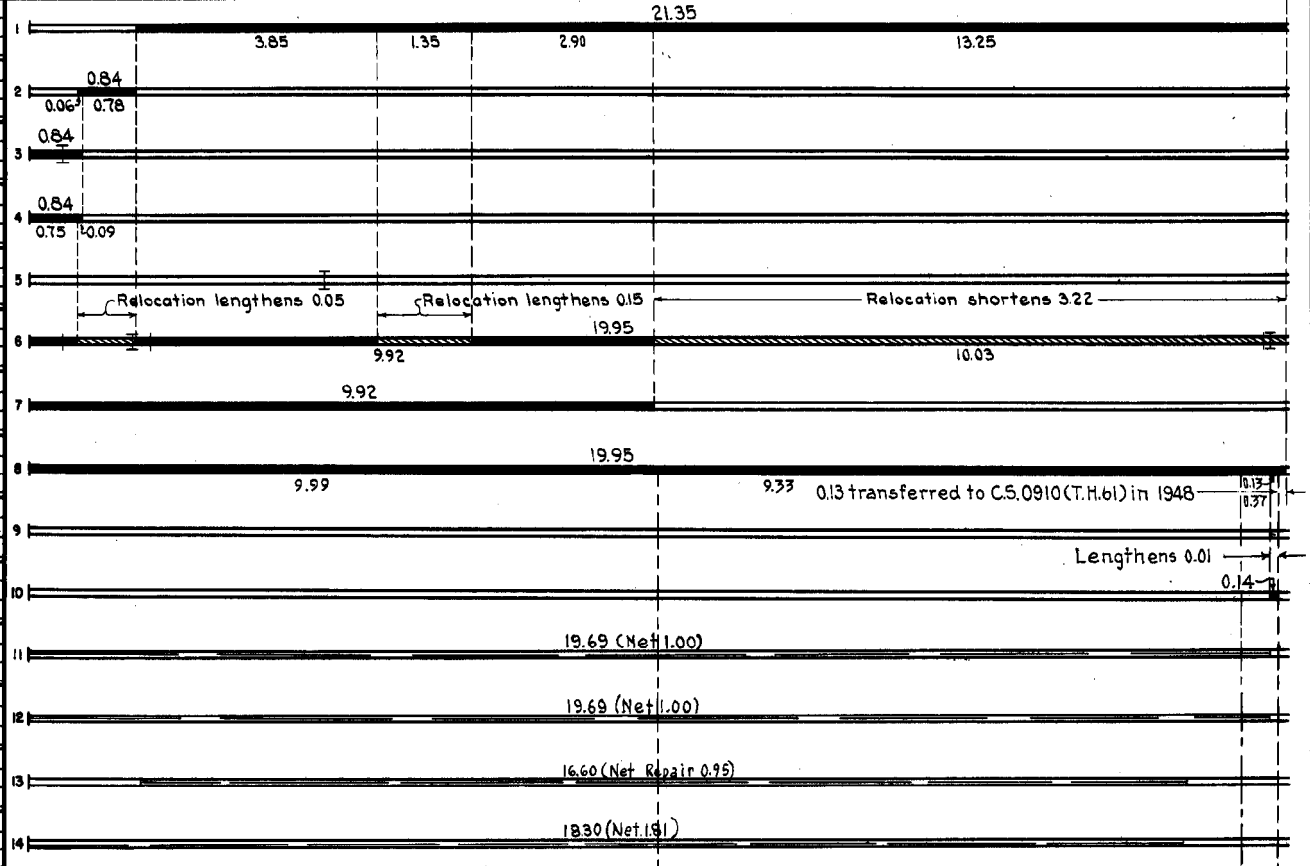

YEARS FROM TO	TOTAL MILES	UNINCORPORATED		INCORPORATED		RURAL		URBAN	
		RDWY. MI.	BR. MI.	RDWY. MI.	BR. MI.	RDWY. MI.	BR. MI.	RDWY. MI.	BR. MI.
1921-1929	22.97	20.45	0.00	2.52	0.00	22.97	0.00	0.00	0.00
1930-1947	19.95	18.26	0.02	1.64	0.03	19.90	0.05	0.00	0.00
1948-1951	19.82	18.15	0.02	1.64	0.03	19.77	0.05	0.00	0.00
1952-1965	19.83	18.14	0.02	1.64	0.03	19.78	0.05	0.00	0.00
1966-1967	20.03	18.36	0.00	1.64	0.03	20.00	0.03	0.00	0.00
1968	19.82	18.15	0.00	1.64	0.03	19.79	0.03	0.00	0.00

REMARKS: Layout is to scale as of 1930
 (2) T.H. 210 under T.H. 35, Br. 9188 S.B. T.H. 35, Br. 9189 N.B. T.H. 35.

PREPARED BY
TRAFFIC AND PLANNING DIVISION
IN COOPERATION WITH
U.S. DEPARTMENT OF COMMERCE
BUREAU OF PUBLIC ROADS

STATE OF MINNESOTA
DEPARTMENT OF HIGHWAYS
ROAD LIFE STUDIES
CONSTRUCTION PROJECT LOG RECORD

CONTROL SECTION 0915
TRUNK HIGHWAY 210
COUNTY Carlton
DISTRICT 1A

LIMITS: Jct. T.H. 73 in Cromwell - Jct. T.H. 61
Ref. Pt. 196+00.233 - 216+00.044

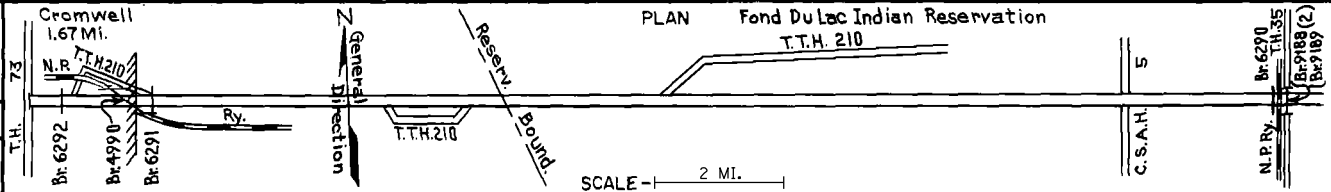

YEAR BUILT	PROJECT NO	DESCRIPTION	WIDTH	THICKNESS	REMARKS
C		Grading			Rt. & Lt. of P.C.
1965	0915-07 (1)	Gravel & Bit. Base Plant Mix Bit.	50' & 24'	8" & 5" 3"	Concrete inplace over P.C. conc. inp.
C		Grading, 12" Select gran.			0.52 mi. Divided Highway
1966	0980-02	Gravel & Bit. Base Plant Mix Bit.	24' - 48'	4" & 1" 3 1/2"	Br. 6290 extended Br. 4917 removed
M		Light Bit. Seal			CRS-1 15.943 Grals. Agg. 656.5 C.Y.
1967	C				
					0.21 Transferred to C.S. 0910 (T.H. 61=1)
C		Base Widening Pl. Mix. Bit. over P.C. Conc. inplace	24'	3"	0.88 mi. P.C. Conc. buried
1969	0915-08				
M		Spot Bit. Overlays	Var.	Var.	Sp. 2341 - 251.3 Tons
1984	SF		12-44'	0-5"	
M		Spot Overlay		1 1/2"	
1985	SF				
M		Spot Overlay		1 1/2"	Spec. 2341
1987	SF				
C		Grading		4"	Spec. 2331
1990	0915-18	Bit. Surfacing	24'	3"	Spec. 2341
C		Bit. Overlay	24'	Var.	Spec. 2341
1990	0915-19				
C		Bit. Overlay	24'	3"	Spec. 2341
1991	0915-22				
M		2' gravel shldr's outside 8' bit shldr's	3 1/2"	2"	Class 1
2000	8821-32				
M		Spot Overlay			Spec. 2231
2005	8821-141				
S		Milling	var.		
2006	0915-29	Bit. Overlay	var.	var.	Spec. 2360

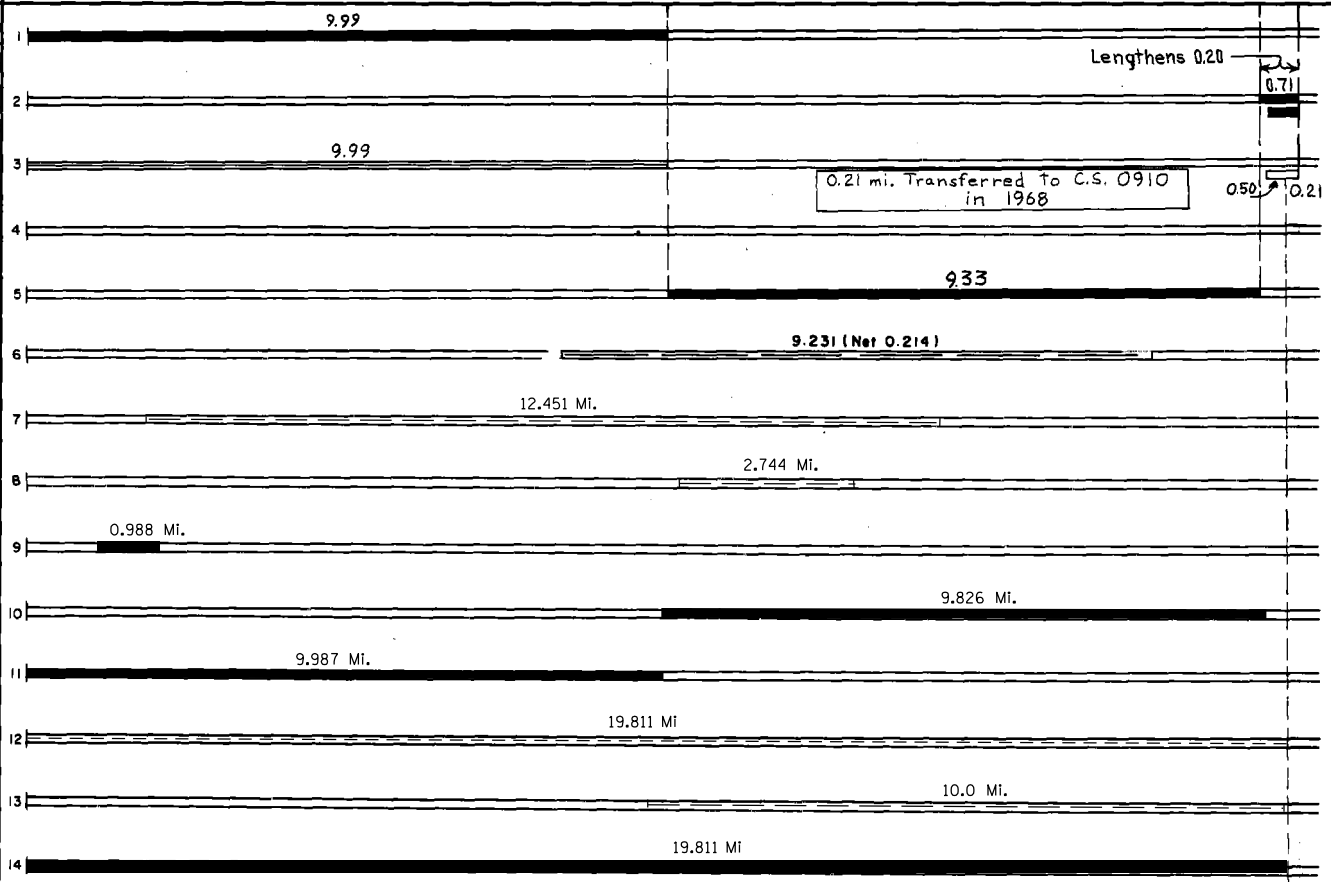

YEARS		TOTAL	UNINCORPORATED		INCORPORATED		RURAL		URBAN	
FROM	TO	MILES	RDWY. MI.	BR. MI.	RDWY. MI.	BR. MI.	RDWY. MI.	BR. MI.	RDWY. MI.	BR. MI.

REMARKS: See sheet No 1
(1) S.P. 0915-6291 & 0915-6292 for raising headwalls on bridges.

