

PREPARED BY
HIGHWAY PLANNING SURVEY
IN COOPERATION WITH
U.S. PUBLIC ROADS ADMINISTRATION

STATE OF MINNESOTA
DEPARTMENT OF HIGHWAYS
ROAD LIFE STUDIES
CONSTRUCTION PROJECT LOG RECORD

CONTROL SECTION 0508
TRUNK HIGHWAY 25
COUNTY Benton
DISTRICT 38

LIMITS: West T.H. 23 West of Foley - N. Co. Line.

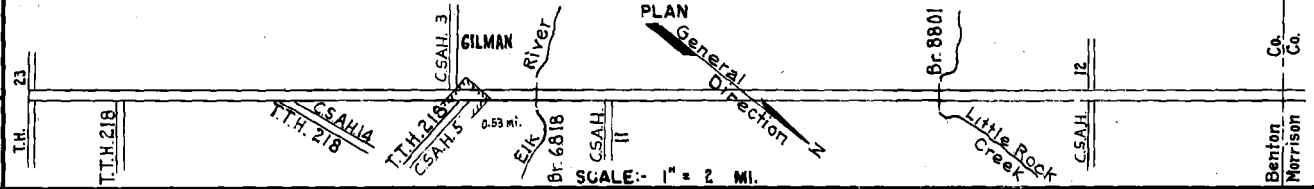

YEAR BUILT	PROJECT N°	DESCRIPTION			CODE N°
		TYPE	WIDTH	THICKNESS	
		Oil Tr. Gravel	45'	1 1/2"	No Record of Constr.
					Added in 1934.
		Gravel	24'	1 1/2"	No Record of Constr.
		Br. N° 2019	17'		Added in 1934. 46' B.S.
1926		Gravel	24'	2 1/4"	Co. Job N° 2605. 1100 C.Y./Mile. Added in 1934.
1932		Gravel	24'	2"	Co. Job N° 3203. Added in 1934. 1000 C.Y./Mi. 23' B.S.
		Br. 8485	60'		No Record of Const. Date Unknown 16' B.S.
M	1941 A.F.E. 31	Bit. Retreat	30'		SC-4, 5890 Gal./Mi. Grav. 380 C.Y./Mi. Maint. Dept.
M	1942 A.F.E. 24 A.F.E. 6	Culv. Inst. Reshaping (Spots) Regrav. & Lifts			1422 C.Y./Mi. Maint. Dept.
C	1947 0508-01	Grading & Stab. Gravel	36'		1200 C.Y./Mi.
C	1948 A.F.E. 16	Bit Surfacing Bit Surf. Treated (Mixed Prime)	26'		SC-3, 57350 Gal.
M	1949 A.F.E. 4	Spot Treat. Bit. Surf. Repair	24'		SC-4, 810 Gal. Agg. 56 C.Y.
M	1950 A.F.E. 4	Spot Treat. Bit. Surf. Repair	24'		SC-3 & RT-4, 7053 Gal. Agg. 480 C.Y.
C	1951 0508-04	Stab. Grav. Base Plant Mix Bit.	31' 24'	6'-9" 1 1/2"	
M	1952 A.F.E. 6	Grav. Resurfacing	24'		
C	1952 0508-05 (1)	Grading Gravel Br. 6818 & 8801	36' 26'		1200 C.Y./Mi. CCI-14 (1) 12T & C 108D

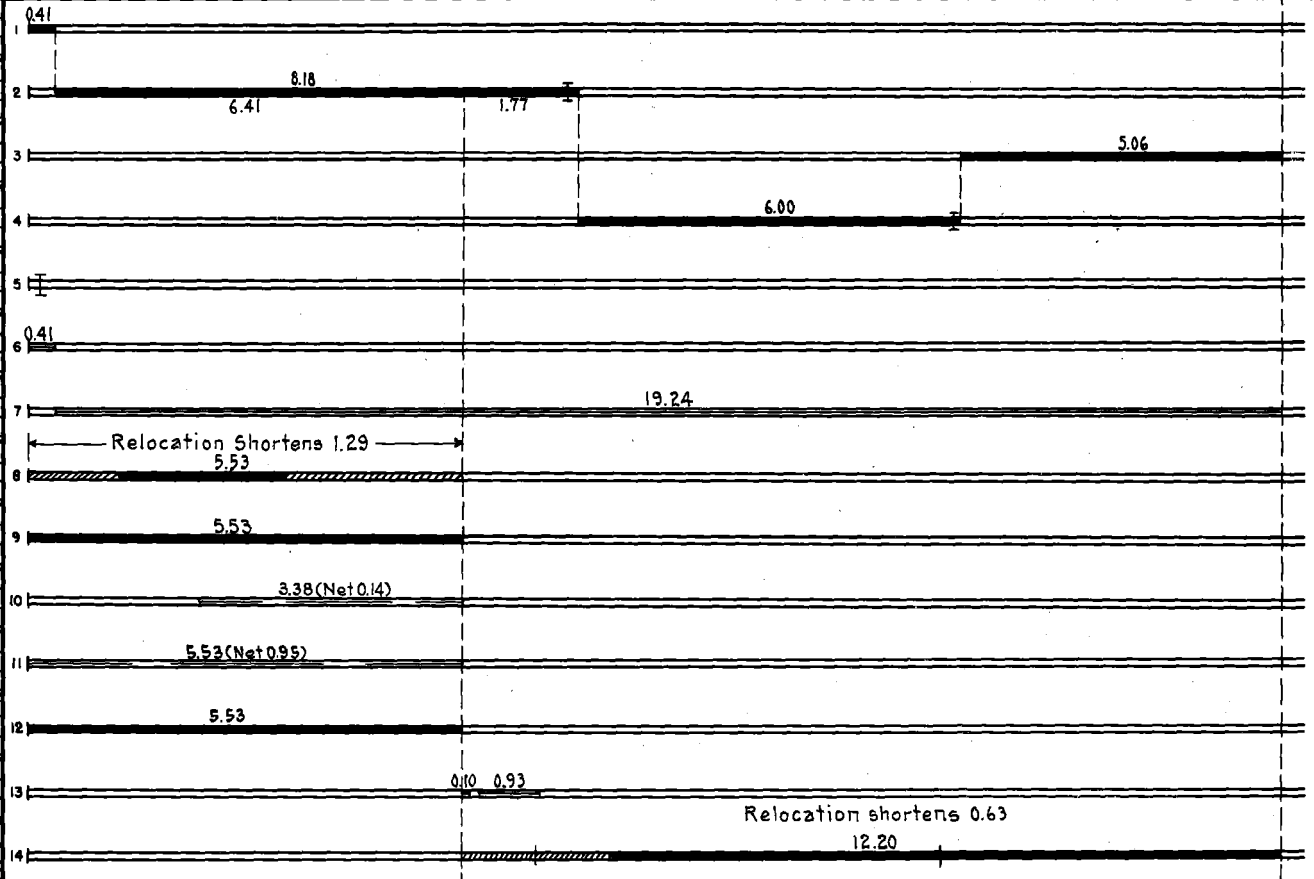

YEARS		TOTAL MILES	UNINCORPORATED		INCORPORATED		RURAL		URBAN	
FROM	TO		RDWY. MI.	BR. MI.	RDWY. MI.	BR. MI.	RDWY. MI.	BR. MI.	RDWY. MI.	BR. MI.
1934	1946	19.65	19.23	0.01	0.41	0.00	19.64	0.01	0.00	0.00
1947	1951	18.36	18.35	0.01	0.00	0.00	18.35	0.01	0.00	0.00
1952	1958	17.73	17.73	0.00	0.00	0.00	17.73	0.00	0.00	0.00
1959		17.72	17.70	0.00	0.02	0.00	17.73	0.00	0.00	0.00

REMARKS: Layout is to scale as of 1934
(1) Contract not final but work substantially complete.

PREPARED BY BUREAU OF POLICY & PLANNING IN COOPERATION WITH U. S. DEPARTMENT OF TRANSPORTATION - FEDERAL HIGHWAY ADMINISTRATION

STATE OF MINNESOTA DEPARTMENT OF TRANSPORTATION CONSTRUCTION PROJECT LOG RECORD

CONTROL SECTION 0508 TRUNK HIGHWAY 25 COUNTY Benton DISTRICT 3B

LIMITS: W. Jct TH 23 W of Foley - N. Co. Line Ref. Pt. 099+00.312 - 117+00.124

Table with columns: YEAR BUILT, PROJECT No, DESCRIPTION (TYPE, WIDTH, THICKNESS, REMARKS). Includes entry for 2011 project 0503-75, Bit Overlay, 24' width, 3' thickness, Spec 2360.

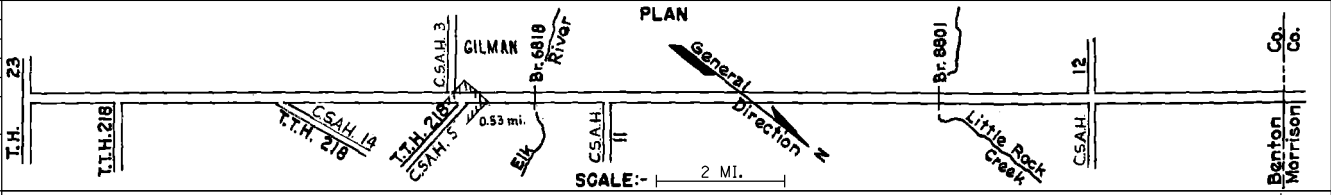

Summary table with columns: YEARS FROM, TO, TOTAL MILES, UNINCORPORATED RDWY. MI., BR. MI., INCORPORATED RDWY. MI., BR. MI., RURAL RDWY. MI., BR. MI., URBAN RDWY. MI., BR. MI.

REMARKS: [Blank area for project notes]