

PREPARED BY
HIGHWAY PLANNING SURVEY
IN COOPERATION WITH
U.S. PUBLIC ROADS ADMINISTRATION

STATE OF MINNESOTA
DEPARTMENT OF HIGHWAYS
ROAD LIFE STUDIES
CONSTRUCTION PROJECT LOG RECORD

CONTROL SECTION 0505
TRUNK HIGHWAY 95
COUNTY Benton
DISTRICT 30

LIMITS: Jct. T.H. 23 - E. Co. Line

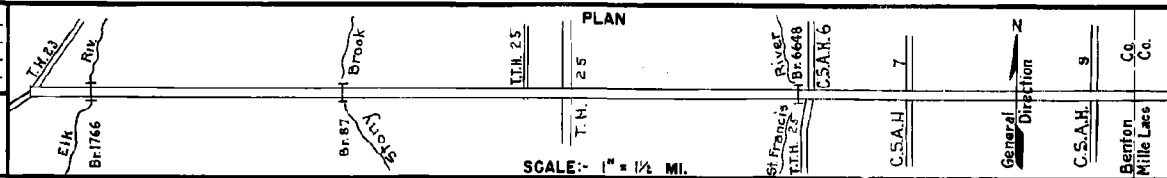

YEAR BUILT	PROJECT N ^o	DESCRIPTION			CODE N ^o
		TYPE	WIDTH	THICKNESS	
		Earth	24'		
		Br. N ^o 1766	16'		
		Gravel	22'	1 1/2"	
1927		Gravel	22'	2 1/2"	
		Br. 4039 & 1875	17'		
1929		Gravel	22'	2 1/2"	
		Br. N ^o 87	16'		
1936 A.F.E. 27		Reshape	28'		
1937 A.F.E. 46		Stab. Subgrade	24'	1"	
		Gravel	24'	2 1/4"	
1938		Br. 1766	27'		
		Br. 87	27'		
C		Grading	32'		
1940 A.F.E. 59		Gravel	26'	3/4"	
C					
1941 0505-01		Culvert			
M					
1942 A.F.E. 22		Culv. Inst.			
		Reshaping (Spots)			
		Regrav. & Lifts			
C					
1947 A.F.E. 33		Sand Grav. Base	29'	6-12"	
		Bit. Surf. Repair	26'		
		(Mixed Prime)			
M					
1948 A.F.E. 4		Spot Treat.			
		Bit. Surf. Repair	24'		
C					
1949 0505-03		Grading	30'		
		Stab. Gravel	30'	1 1/2"	
		Br. 6648	30'		
M					
1950 A.F.E. 4		Bit. Surf. Repair	24'		
C					
1950 0505-07		Stab. Grav. Base	28'	2-8"	
		Plant Mix Bit.	24'	1 1/2"	

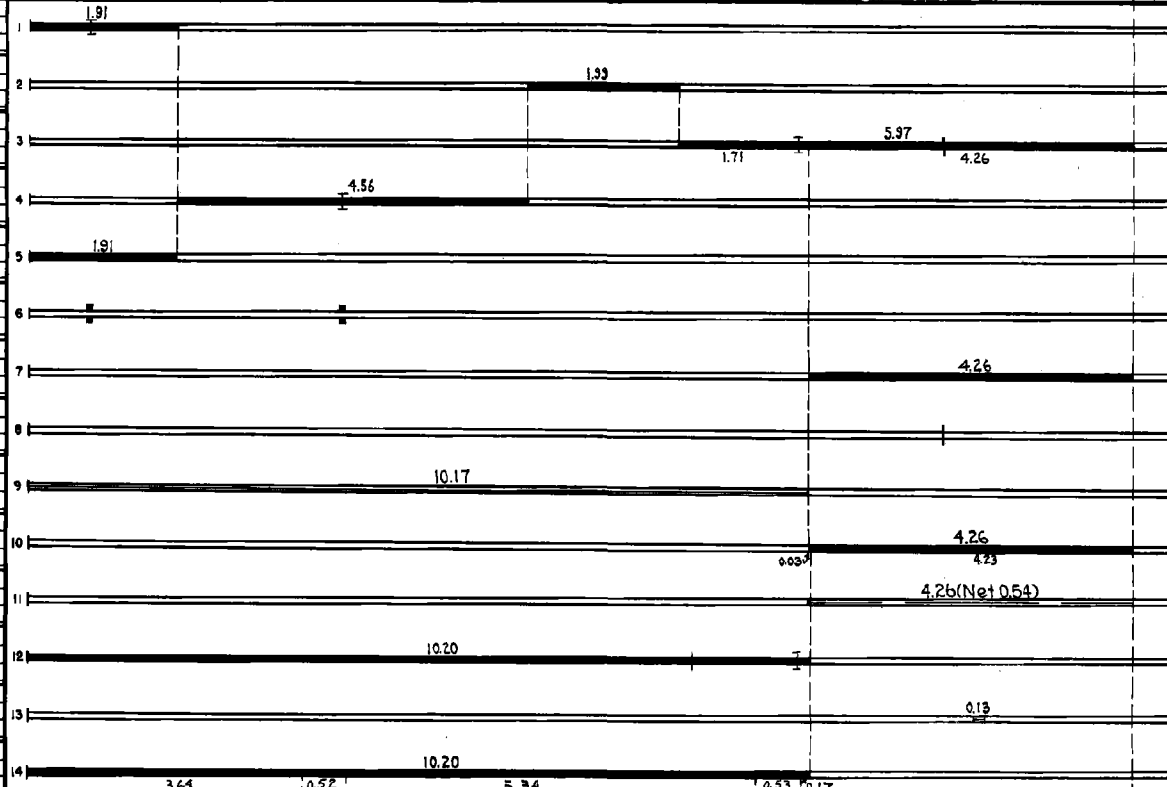

YEARS FROM 1934 TO	TOTAL MILES	UNINCORPORATED		INCORPORATED		RURAL		URBAN	
		RDWY. MI.	BR. MI.	RDWY. MI.	BR. MI.	RDWY. MI.	BR. MI.	RDWY. MI.	BR. MI.
1934	14.43	14.40	0.03	0.60	0.00	14.40	0.03	0.00	0.00

REMARKS: Layout is to scale as of 1934

PREPARED BY
 BUREAU OF POLICY & PLANNING
 IN COOPERATION WITH
 U. S. DEPARTMENT OF TRANSPORTATION - FEDERAL HIGHWAY ADMINISTRATION

STATE OF MINNESOTA
 DEPARTMENT OF TRANSPORTATION
 CONSTRUCTION PROJECT LOG RECORD

CONTROL SECTION 0505
 TRUNK HIGHWAY 95
 COUNTY Benton
 DISTRICT 3B

LIMITS: Jct. MNTH 23 - Benton/Mille Lacs Co. Line
 Ref. Pt. 000+00.050 - 014+00.424

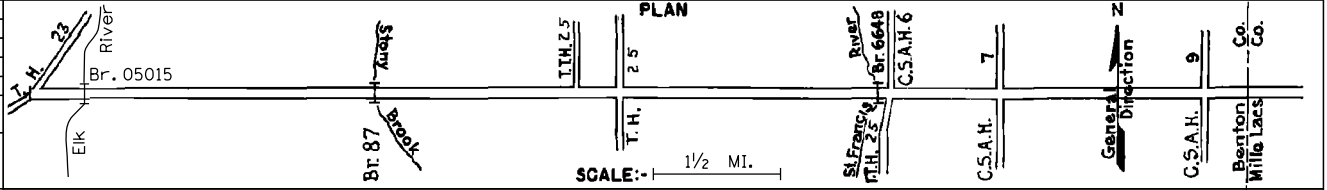

YEAR BUILT	PROJECT No	DESCRIPTION			REMARKS
		TYPE	WIDTH	THICKNESS	
C 1986	M4191	Bit. Overlay	28' 24'	2" 1 1/2"	Spec 2341
M 1989	0505-19	Aggregate Seal			
C 1990	M4379	Bit. Overlay	24'	1 1/2"	Spec 2341
C 1992	M4551	Bit. Overlay	24'	1 1/2"	Spec 2341
C 1995	0505-22	Bit. Overlay	28'	3 1/2"	Spec 2341
C 1995	0505-17	Grading Bit. Surfacing Remove/Construct Bridge	48' 24'	4 1/2"	Spec. 2341, 2331 * See Remarks
S 2001	0505-23	Grading Aggregate Base Mill & Bit. Surfacing	10' 6' 28'	3" 2"	Class 1 & 6 Spec. 2350
S 2007	0505-24	Milling Bit. Overlay	24'	1 1/2"	Spec. 2360
2013	8823-262	Bit. Seal Coat	24'		Type FA2

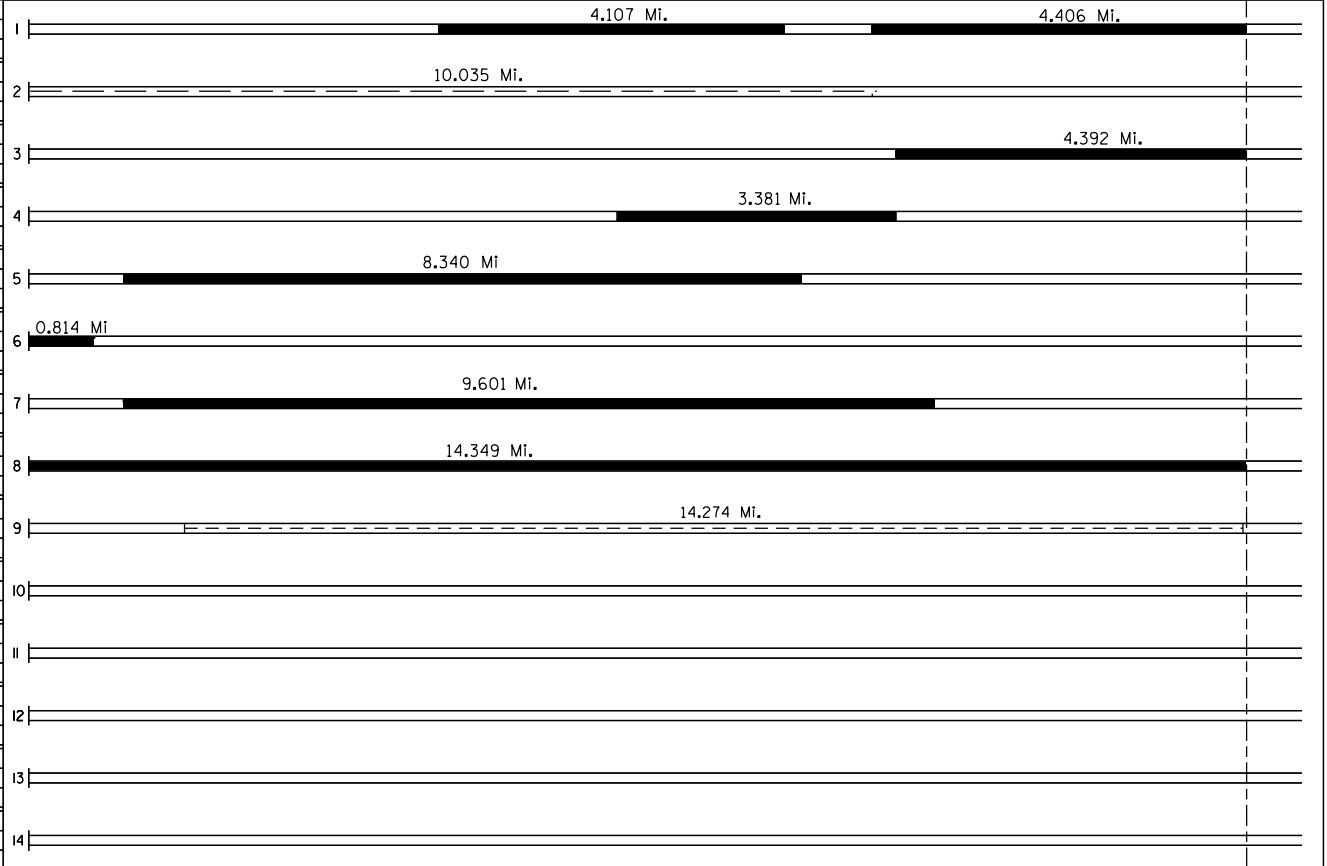

YEARS		TOTAL MILES	UNINCORPORATED		INCORPORATED		RURAL		URBAN	
FROM	TO		RDWY. MI.	BR. MI.	RDWY. MI.	BR. MI.	RDWY. MI.	BR. MI.	RDWY. MI.	BR. MI.

REMARKS: * Remove Bridge No's 1766 and L5807, Construct Bridge No's 05015 and 97591