

PREPARED BY
HIGHWAY PLANNING SURVEY
IN COOPERATION WITH
U.S. PUBLIC ROADS ADMINISTRATION

STATE OF MINNESOTA
DEPARTMENT OF HIGHWAYS
ROAD LIFE STUDIES
CONSTRUCTION PROJECT LOG RECORD

CONTROL SECTION 0504
TRUNK HIGHWAY 23
COUNTY Benton
DISTRICT 38

LIMITS: W. Jct. T.H. 25 W. of Foley to E. Co. Line

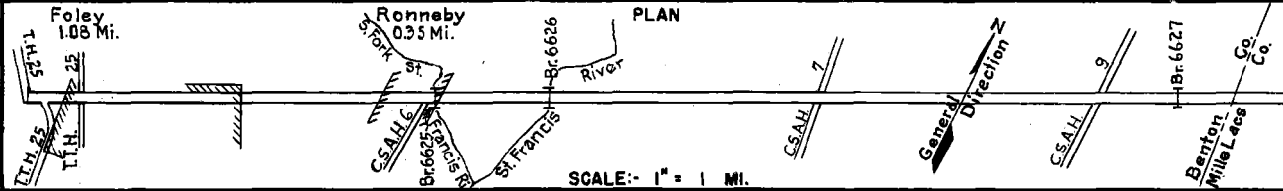

YEAR BUILT	PROJECT N°	DESCRIPTION			CODE N°
		TYPE	WIDTH	THICKNESS	
1921	23-23-1	Br. N° 3177	18'		35' C.D.G.
1923	23-23-21	Grading Gravel	30' 24'	4 1/4"	2000 C.Y./Mile.
1923	23-23-22A	Grading Br. 8484, 2974, & 2656 (1)	30' 20'		16' B.S. 40' C.S. 20' C.S.
1924	23-23-22A	Gravel	24'	3 1/4"	1775-1800 C.Y./Mile.
1930	23-23-22A	Br. N° 2656	27'		20' B.S. Reconstruction.
1931	23-23-21 (2) 23-23-22A (2)	Oil Tr. Gravel	2628'	1 1/2"	12964 Gal./Mile. Maint. Dept.
M	1940 A.F.E. 21	Spot Treat. Bit. Surf. Repair			Bit. 1865 Gal./Mi. Grav. 163 C.Y./Mi. Maint. Dept.
M	1941 A.F.E. 7	Spot Treat. Bit. Surf. Repair	26'		5C. 2572 Gal./Mi. 145 C.Y./Mi. Maint. Dept.
M	1942 A.F.E. 4	Spot Treat. Bit. Surf. Repair	24'		RT-6 & MG-3 2256 Gal./Mi. Grav. 185 C.Y./Mi. Maint. Dept.
M	1943 A.F.E. 4	Spot Treat. Bit. Surf. Repair	26'		MC-3 1245 Gal./Mi. Grav. 113 C.Y./Mi. Maint. Dept.
M	1944 A.F.E. 4	Spot Treat. Bit. Surf. Repair	26'		MG-2 2123 Gal./Mi. Grav. 92 C.Y./Mi. Maint. Div.
M	1945 A.F.E. 4	Spot Treat. Bit. Surf. Repair	26'		MC-3 2937 Gal./Mi. Grav. 123 C.Y./Mi. Maint. Div.
M	1946 A.F.E. 4	Spot Treat. Bit. Surf. Repair	24'		5C-3 2202 B. Gal. Agg. 1472 C.Y.
M	1947 A.F.E. 4	Spot Treat. Bit. Surf. Repair	24'		5C-3 223,275 Gal. Agg. -1687 C.Y.

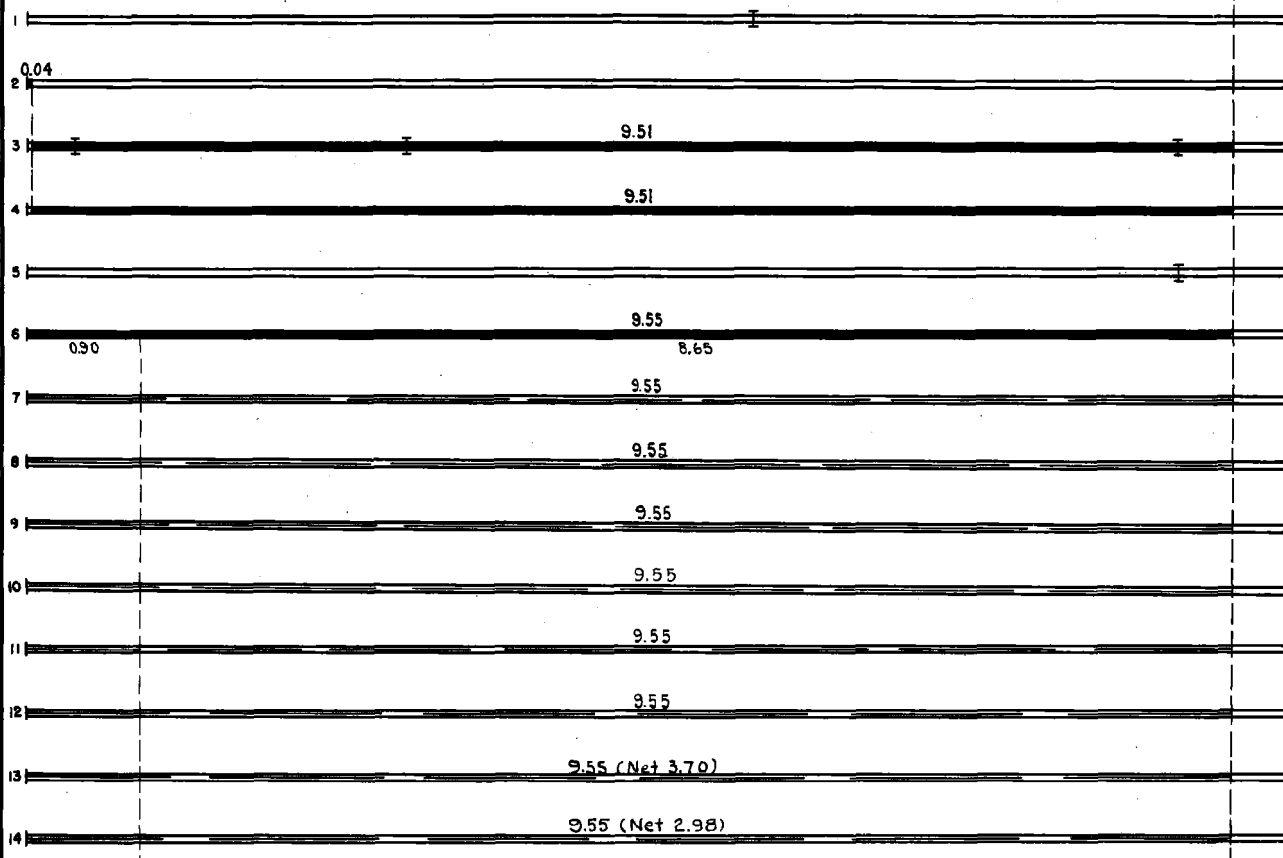

YEARS		TOTAL MILES	UNINCORPORATED		INCORPORATED		RURAL		URBAN	
FROM	TO		RDWY. MI.	BR. MI.	RDWY. MI.	BR. MI.	RDWY. MI.	BR. MI.	RDWY. MI.	BR. MI.
1923	1947	5.55	7.85	0.01	1.68	0.01	9.33	0.02	0.00	0.00
1948	1950	9.68	8.31	0.01	1.35	0.01	9.66	0.02	0.00	0.00
1951	1952	9.68	8.31	0.01	1.35	0.01	9.05	0.02	0.61	0.00
1953	1959	8.70	7.98	0.01	0.70	0.01	8.32	0.02	0.36	0.00
1960	1960	8.70	7.89	0.01	0.79	0.01	8.23	0.02	0.45	0.00
1961	1965	8.70	7.98	0.01	0.70	0.01	8.32	0.02	0.36	0.00
1966		8.70	7.26	0.01	1.42	0.01	7.60	0.02	1.08	0.00

REMARKS: Layout is to scale as of 1923. Plan revised for 1948 relocation.

- (1) Br. 3240 built in 1920 and Br. 2656 no record of construction
- (2) This work not done under these project numbers but lies within the limits of these projects

PREPARED BY
HIGHWAY PLANNING SURVEY
IN COOPERATION WITH
U. S. PUBLIC ROADS ADMINISTRATION

STATE OF MINNESOTA
DEPARTMENT OF HIGHWAYS
ROAD LIFE STUDIES
CONSTRUCTION PROJECT LOG RECORD

CONTROL SECTION 0504
TRUNK HIGHWAY 23
COUNTY Benton
DISTRICT 38

LIMITS: W. Jct. T.H. 25 W. of Foley to E. Co. Line

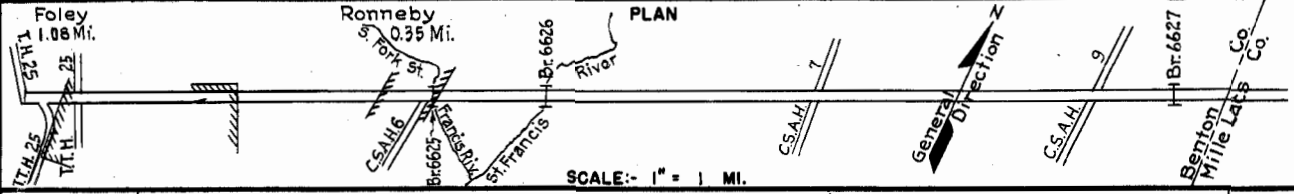

YEAR BUILT	PROJECT N°	DESCRIPTION			CODE N°
		TYPE	WIDTH	THICKNESS	
M	1948 A.F.E. 4	Spot Treat Bit.Surf.Repair	24'		SC-3, 10345 Gal. Agg. 735 C.Y.
C	1948 0504-06	Grading Gravel	42'	2 3/4"	Salv. Bit. Mat'l.
C	(1)	Bit.Surfacing Mixed Bit. (Mixed Prime)	26'	1 1/2"	
M	1949 A.F.E. 4	Spot Treat. Bit.Surf.Repair	24'		SC-4, 33336 Gal. Agg. 2364 C.Y.
M	1950 A.F.E. 4	Spot Treat. Bit. Surf. Repair	24'		SC-3 44, 19120 Gal. Agg. 1960 Tons
C	1950 0504-07	Concrete	24'	9'-9"	Extend C 64D Culv
M	1951 A.F.E. 4	Spot Treat. Bit.Surf.Repair	24'		SC-4 RT-4, 5176 Gal. Agg. 344 C.Y.
M	1952 A.F.E. 4	Spot Treat. Bit.Surf.Repair	24'		SC-4, 20060 Gal. Agg. 1628 C.Y.
C	1952 0504-05	Br. 6627	30'		30' B.S.
M	1953 A.F.E. 604	Spot Treat. Bit.Surf.Repair	24'		SC-4, 3428 Gal. Agg. 308 Tons
C	1953 0504-02	Grading Gravel & Salv. Bit.	42'	1 1/2"	3" Grav. Base on 9" Salv. Bit. Mat'l. (M.P.I. 0.97-4.36)
C	0504-03&04	Br. 6625 & Br. 6626	30'		30' S.S. & 40' C.D.G.
C	1953 A.F.E. 838	Bit.Surfacing Mixed Bit.	24'	1 1/4"	Bit. 77839 Gal. Agg. 6492 Tons
M	A.F.E. 830	Fog Seal Shoulders*			SC4&MCI, 12158 Gal.
M	1954 A.F.E. 604	Spot Treat. Bit.Surf.Repair	24'		Agg. 1030 Tons **M.P.I. 0.00-0.97
C	1955 0504-08	Concrete	22'	9'-9"	On Grav. Base

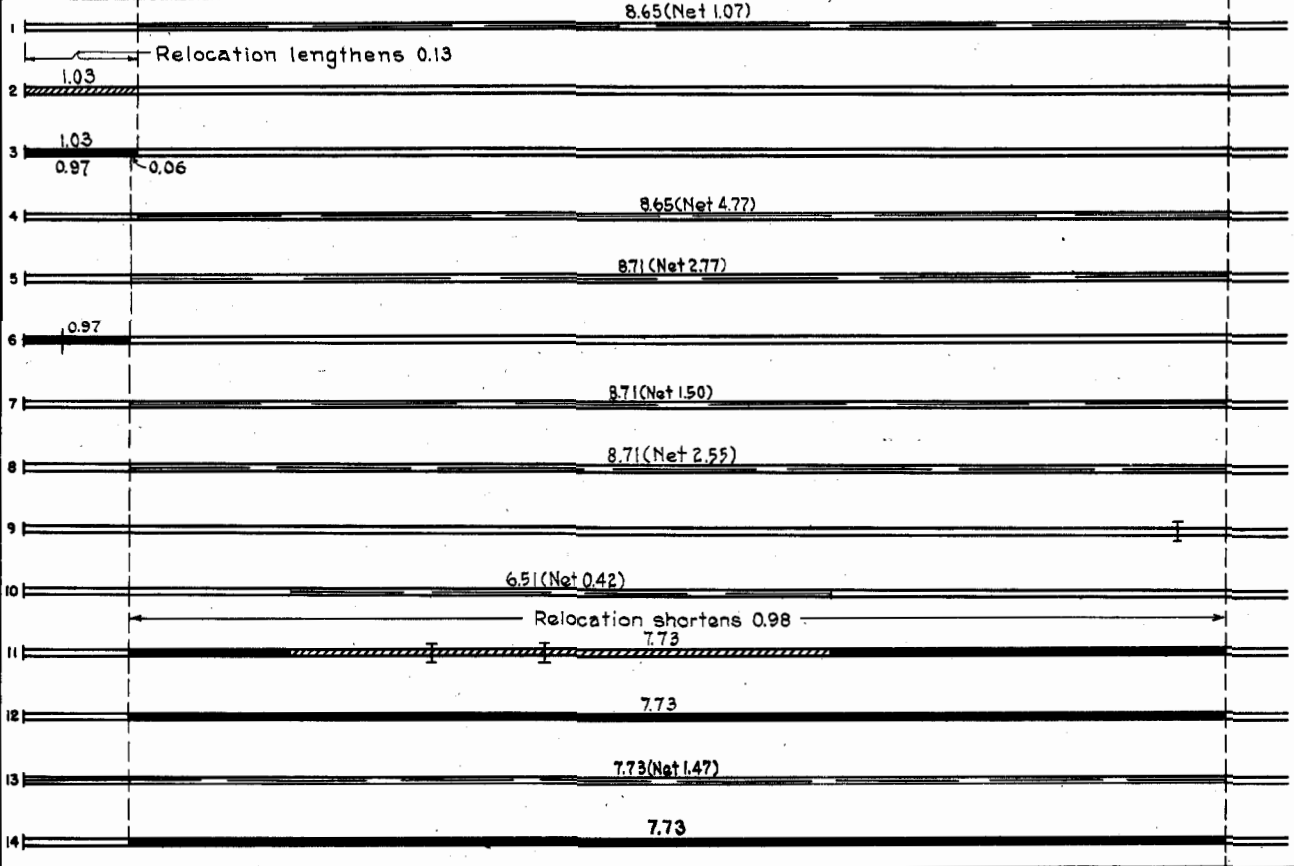

YEARS FROM	TOTAL MILES TO	UNINCORPORATED		INCORPORATED		RURAL		URBAN	
		RDWY. MI.	BR. MI.	RDWY. MI.	BR. MI.	RDWY. MI.	BR. MI.	RDWY. MI.	BR. MI.

REMARKS: See Sheet No. 1 (1) Bit. surface placed in connection with work on C.S. 0503.

PREPARED BY
TRAFFIC AND PLANNING DIVISION
IN COOPERATION WITH
U.S. DEPARTMENT OF COMMERCE
BUREAU OF PUBLIC ROADS

STATE OF MINNESOTA
DEPARTMENT OF HIGHWAYS
ROAD LIFE STUDIES
CONSTRUCTION PROJECT LOG RECORD

CONTROL SECTION 0504
TRUNK HIGHWAY 23
COUNTY Benton
DISTRICT 3B

LIMITS: W. Jct. T.H. 25 W. of Foley to E. Co. Line

Ref. Pt. 220+00.925 - 229+00.641

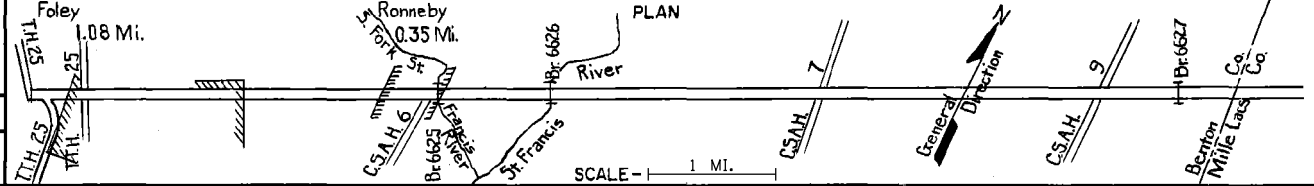

YEAR BUILT	PROJECT NO	DESCRIPTION			
		TYPE	WIDTH	THICKNESS	REMARKS
M 1961		Shoulder Seal	8'		RC-2, 7700 Gal. Agg. 246 C.Y.
M 1971	SF	Joint Seal			
1972	SF	Joint Seal	24'		3,500 lbs. Pata Plastic
M 1973	SF	Joint Seal			1,600 lbs Sealant
M 1982	SF	Conc. Pymt. Repair & Repl. Clean, Saw & Reseal Joints			# 3955
M 1984	0504 SF	Conc. Pymt. Rehabilitation Joint Repair			# 4058
M 1981	0504-II	Bit. Shoulders Turn Lanes	9' 13'	Var. 3"	
C 1990	0504-13	Bit. Shouldering Edge Drains	9'	1 1/2"	Spec. 2341
M 1991	4454	Edge Drains			
C 1996	0504-14	Bit. Overlay Shoulder Work	38'	3 1/2"	Spec. 2341
C 1998	0504-15	Bit. Overlay	22'	5"	Spec. 2350
M 2002	8823-36	Bit. Seal Coat			Type FA2
M 2004	8823-51	Bit. Seal Coat			Type FA3
M 2011	0504-18 (0503-75)	Grading Alt. Conc. & Bit. Surf. Agg Base	var.	6" 8"	Spec. 2360 Class 6

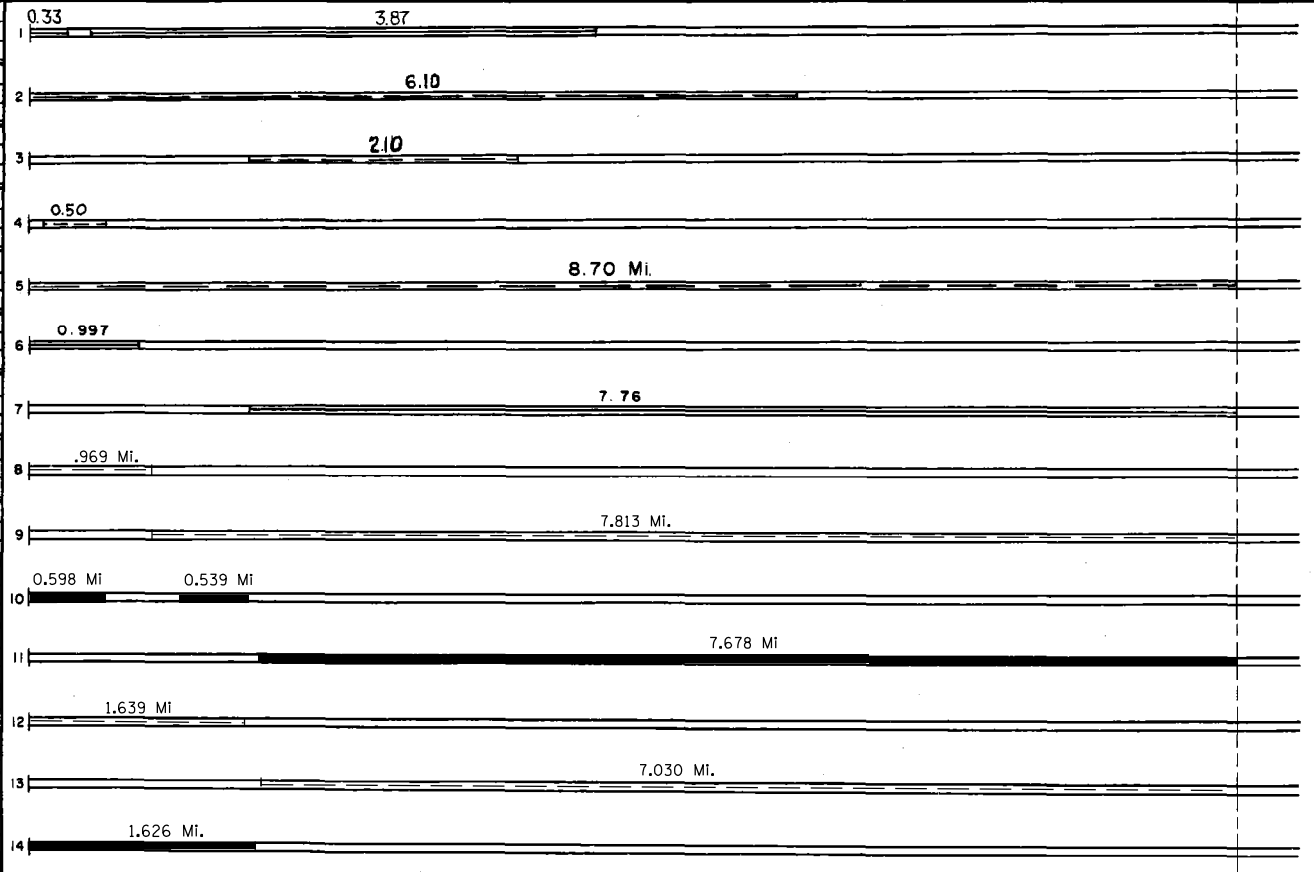

YEARS		TOTAL MILES	UNINCORPORATED		INCORPORATED		RURAL		URBAN	
FROM	TO		RDWY. MI.	BR. MI.	RDWY. MI.	BR. MI.	RDWY. MI.	BR. MI.	RDWY. MI.	BR. MI.

REMARKS: See Sheet No 1

PREPARED BY BUREAU OF POLICY & PLANNING IN COOPERATION WITH U. S. DEPARTMENT OF TRANSPORTATION - FEDERAL HIGHWAY ADMINISTRATION

STATE OF MINNESOTA DEPARTMENT OF TRANSPORTATION CONSTRUCTION PROJECT LOG RECORD

CONTROL SECTION 0504 TRUNK HIGHWAY 23 COUNTY Benton DISTRICT 3B

LIMITS: W Jct TH-25 W of Foley to E Co Line Ref. Pt 220+00.925 - 229+00.641

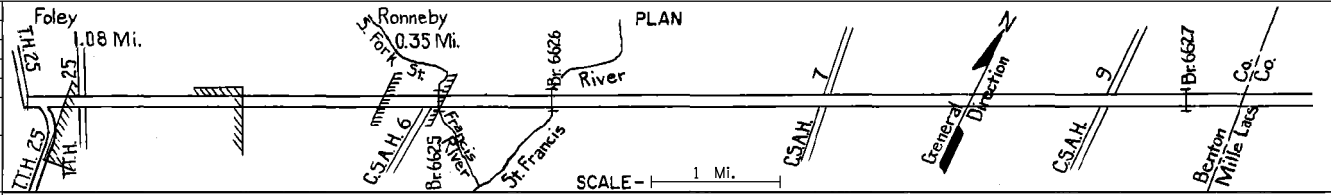

Table with columns: YEAR BUILT, PROJECT No, DESCRIPTION, TYPE, WIDTH, THICKNESS, REMARKS. Contains two entries for 2012: Microsurfacing and Grading.

Vertical project log table with 14 rows (1-14) and columns for project details. Includes a 1.626 Mi. scale bar and a 7.03 Mi. scale bar.

Summary table with columns: YEARS FROM, YEARS TO, TOTAL MILES, UNINCORPORATED RDWY. MI., BR. MI., INCORPORATED RDWY. MI., BR. MI., RURAL RDWY. MI., BR. MI., URBAN RDWY. MI., BR. MI.

REMARKS: [Blank area for project notes]