

PREPARED BY
HIGHWAY PLANNING SURVEY
IN COOPERATION WITH
U.S. PUBLIC ROADS ADMINISTRATION

STATE OF MINNESOTA
DEPARTMENT OF HIGHWAYS
ROAD LIFE STUDIES
CONSTRUCTION PROJECT LOG RECORD

CONTROL SECTION 0112
TRUNK HIGHWAY 65
COUNTY Aitkin
DISTRICT 1A

LIMITS: Jct. T.H. 210 in McGregor - N. Co. Line

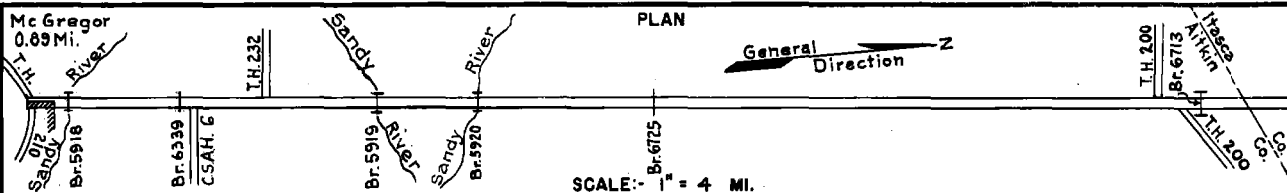

YEAR BUILT	PROJECT N ^o	DESCRIPTION			CODE N ^o
		TYPE	WIDTH	THICKNESS	
		Gravel	24'	2"	No Record of Constr.
		Earth	22'		No Record of Constr.
		Br.*4852, 2156, 2158, 6212, 2157, 8320, 8321	24' 24' 24'	18" 18" 24"	(1)
(2)		Gravel	22'	2-3"	Maint. Dept.
1928		Br. N ^o 4851	24'		60' B.S.
1930	65-5-37-1	Grading	32'		
		Gravel	24'	2 1/2"	1100 C.Y./Mile.
1930		Gravel	22'	3"	Status map shows Gravel. No Record of Constr.
(3)		Oil Tr. Gravel	22'	1"	Maint. Dept.
1931	65-5-37-1	Tar Tr. Gravel	22'	1"	Maint. Dept.
1931		Tar Tr. Gravel	22'	1"	Maint. Dept.
1932		Tar Tr. Gravel	22'	1"	Maint. Dept.
C	1940 A.F.E.67	Br. Removal and C.M. Culvert replacement			Maint. Dept.
M	1940 A.F.E.26	Spot Treat. Bit. Surf. Repair			50-3,2793 Gal./Mi. Maint. Dept.
M	1940 A.F.E.39	Regraveling			197 C.Y./Mi. Maint. Dept.
C	1941 0112-01	Grading & Stab. Base	36'		C128D.
		Br. 6339			50' B.S. & 120' B.S.
		Br. 5918 & 5919	30'		
C	1941 A.F.E.17	Seeding			Seed Supplied by R.S.D. (S.P. 0112-08) Maint. Dept.
M	1941 A.F.E.33	Regraveling	18 1/2'		240 C.Y./Mi. Maint. Dept.

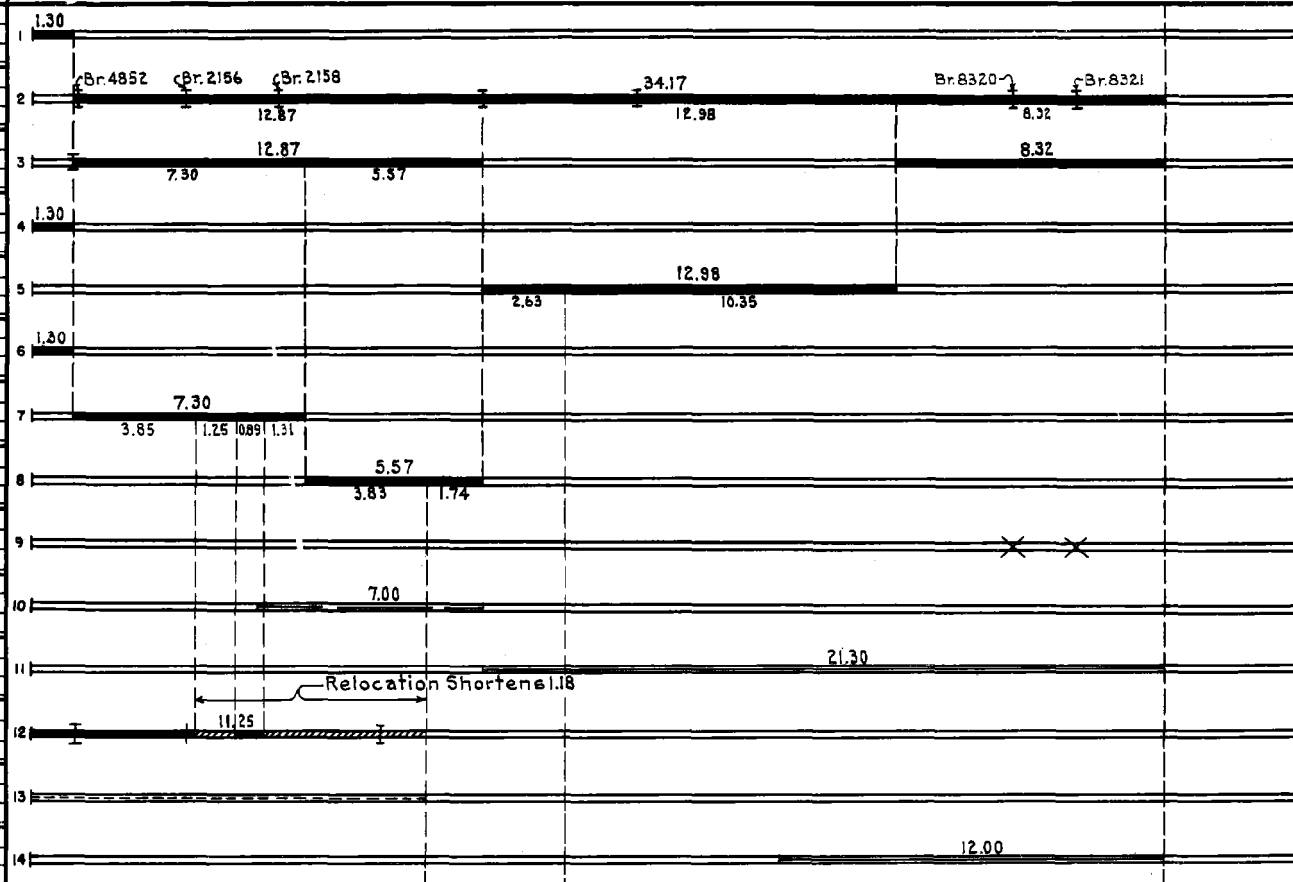

YEARS		TOTAL MILES	UNINCORPORATED		INCORPORATED		RURAL		URBAN	
FROM	TO		RDWY. MI.	BR. MI.	RDWY. MI.	BR. MI.	RDWY. MI.	BR. MI.	RDWY. MI.	BR. MI.
1921	1927	35.47	34.51	0.07	0.89	0.00	35.40	0.07	0.00	0.00
1928	1940	35.47	34.50	0.08	0.89	0.00	35.39	0.08	0.00	0.00
1941	1948	34.29	33.35	0.05	0.89	0.00	34.24	0.05	0.00	0.00
1949	1949	33.62	32.67	0.06	0.89	0.00	33.56	0.06	0.00	0.00
1950		31.00	30.03	0.08	0.89	0.00	30.92	0.08	0.00	0.00

REMARKS: Layout is to scale as of 1921. Plan revised for 1950 relocation & extension.

(2) Graveling done over period of years by Maint. Dept.

(3) This work not done under this project number but lies within the limits of this project

(1) Br. N^o 4852 is 10' C.S., Br. N^o 2156 is 23' B.S., Br. N^o 2158 is 210' H.T. & B.S., Br. N^o 6212 is 76' B.S. & C.A., Br. N^o 2157 is 23' B.S., Br. N^o 8320 is 14' W.S. & Br. N^o 8321 is 8' W.S.

PREPARED BY
HIGHWAY PLANNING SURVEY
IN COOPERATION WITH
U.S. PUBLIC ROADS ADMINISTRATION

STATE OF MINNESOTA
DEPARTMENT OF HIGHWAYS
ROAD LIFE STUDIES
CONSTRUCTION PROJECT LOG RECORD

CONTROL SECTION 0112
TRUNK HIGHWAY 65
COUNTY Aitkin
DISTRICT 1A

LIMITS: Jct. T.H. 210 in McGregor - N. Co. Line

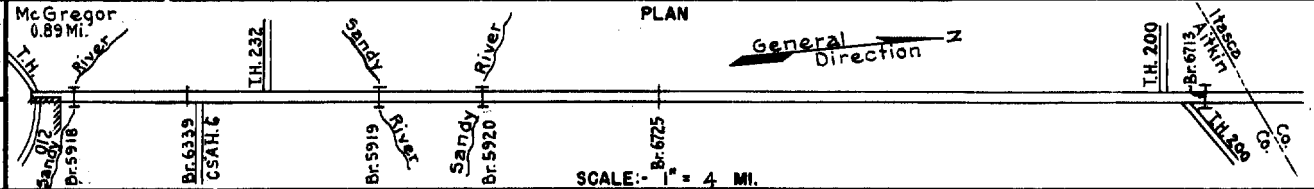

YEAR BUILT	PROJECT N ^o	DESCRIPTION		CODE N ^o
		TYPE	WIDTH THICKNESS	
C	0112-09	Stab. Grav. Base	32' 3"-12"	
1942	0112-10	Mixed Bit.	26' 1"	
M				RT-4&MG2, 938 Gal./Mi.
1944	A.F.E. 4	Bit. Fog Seal	28'	Maint. Div.
M				
1944	A.F.E. 6	Grav. Resurfacing (Spots)		22 C.Y./Mi. Maint. Div.
M				MG-2, 4138 Gal./Mi.
1945	A.F.E. 4	Bit. Surf. Repair		Sand 143 C.Y./Mi. Maint. Div.
M				RC-3, 3223 Gal./Mi.
1945	1944 A.F.E. 5	Bit. Seal Coat		Agg. 81 C.Y./Mi. Maint. Div.
M				
1945	A.F.E. 21	Grade Lift		Maint. Div.
M				
1947	A.F.E. 35	Swamp Fill (Spots)	24' 4"-12"	5732 C.Y.
C				
1948	0112-04	Grading	34'	
1949	0112-05	Br. 5920	30'	135' B.S.
C				MC-2 & 5C-3, 20237 Gal.
1949	A.F.E. 24	Bit. Surfacing Mixed Bit. (Mixed Prime)	24' 1 1/2"	
C				1.0' Granular Mat'l.
1950	0112-16	Stab. Gravel Culverts (2)	24' 2 1/2"	1200 C.Y./Mi.
C				
1950	A.F.E. 6	Gravel	26' 2"	2031 C.Y.
C				
1950	0112-19	Br. 6713	30'	119' L.T. & B.S.
(2)				1.0' Select Mat'l.
C				
1950	0112-20	Gravel	30' 9"	1.0' Select Mat'l.
(2)				700 C.Y./Mi.
M				
1950	A.F.E. 4	Spot Treat. Bit. Surf. Repair Bit. Seal Coat	24' 26'	MG2&3, RC1, 24328 Gal. Agg. 945 C.Y.

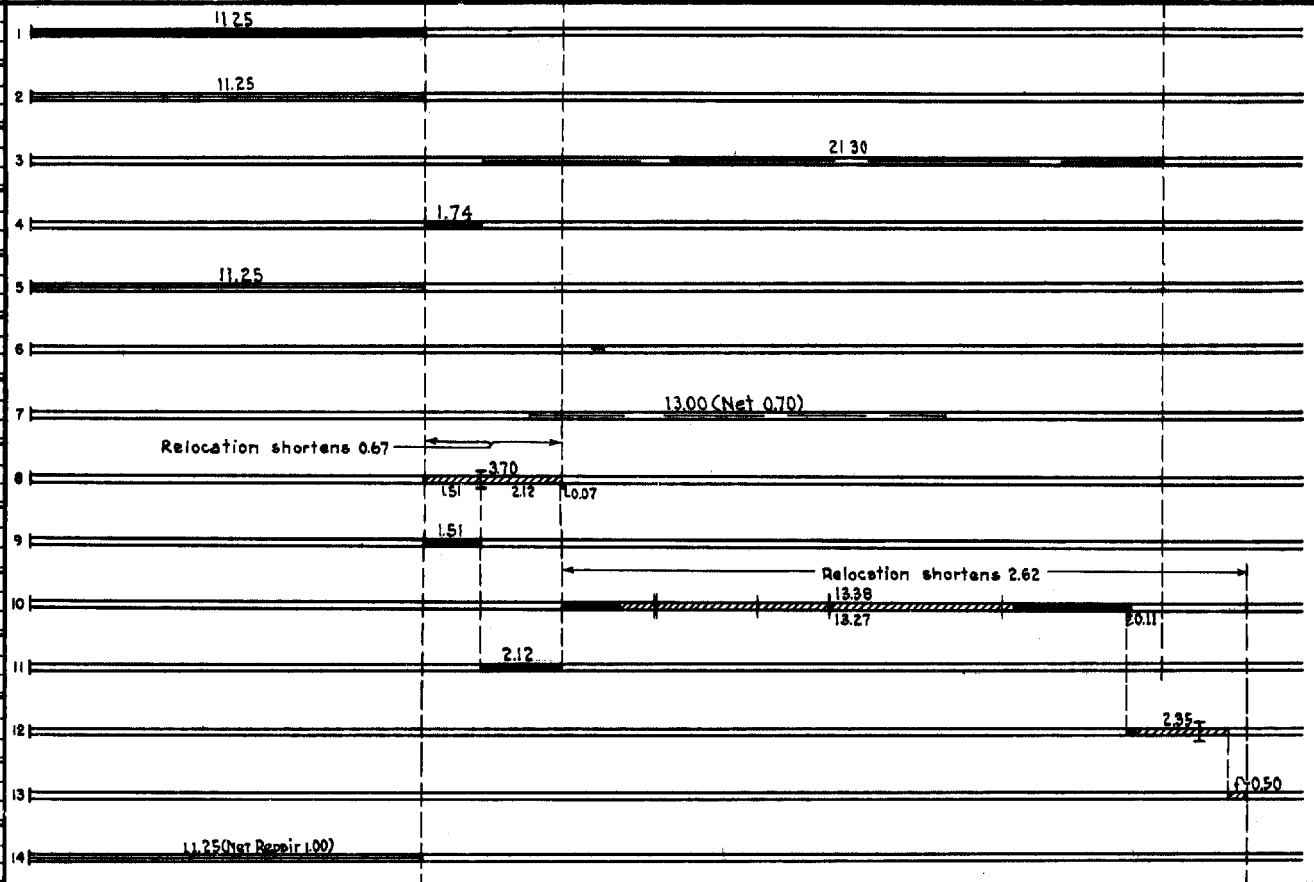

YEARS		TOTAL MILES	UNINCORPORATED		INCORPORATED		RURAL		URBAN	
FROM	TO		RDWY. MI.	BR. MI.	RDWY. MI.	BR. MI.	RDWY. MI.	BR. MI.	RDWY. MI.	BR. MI.

REMARKS: See Sheet N^o 1
(1) Br. 6725, C108D; 4x6 Timber Box; C88D; 2-C66. (2) Contract not final but work substantially complete in 1950.

PREPARED BY
HIGHWAY PLANNING SURVEY
IN COOPERATION WITH
U.S. PUBLIC ROADS ADMINISTRATION

STATE OF MINNESOTA
DEPARTMENT OF HIGHWAYS
ROAD LIFE STUDIES
CONSTRUCTION PROJECT LOG RECORD

CONTROL SECTION 0112
TRUNK HIGHWAY 65
COUNTY Aitkin
DISTRICT 1A

LIMITS: Jct. T.H. 210 in McGregor - N. Co. Line

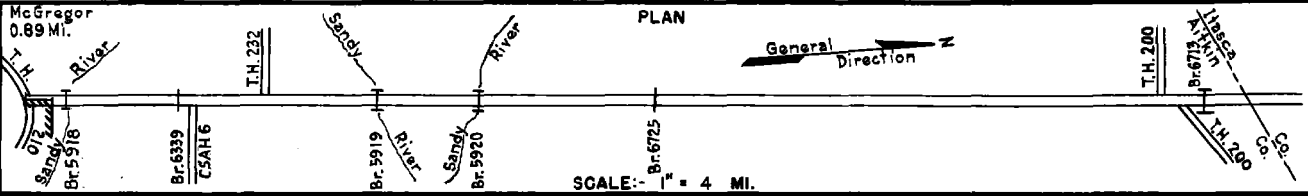

YEAR BUILT	PROJECT N°	DESCRIPTION			CODE N°
		TYPE	WIDTH	THICKNESS	
C	0112-21	Gravel Base Plant Mix Bit.	28' 24'	3"-12" 1 1/2"	
M	A.F.E. 4	Spot Treat Bit. Surf. Repair	24'		MC-2, 26554 Gal. Agg. 1540 C.Y.
M	A.F.E. 604	Spot Treat Bit. Surf. Repair	24'		MC-2, 9719 Gal. Agg. 552 C.Y.
M	A.F.E. 821	Spot Treat Bit. Surf. Repair Spot Base Repair	24' 30'		MC-2, 18903 Gal. Agg. 1490 Tons
M	A.F.E. 604	Spot Treat Bit. Surf. Repair	24'		MC-2, 8239 Gal. Agg. 666 Tons
M	A.F.E. 819	Spot Treat Bit. Surf. Repair Spot Base Repair	24' 32'		MC-2, 29855 Gal. Agg. 2022 Tons
M	A.F.E. 604	Spot Treat Bit. Surf. Repair	24'		MC-2, 10481 Gal. Agg. 762 Tons
M	A.F.E. 604	Spot Treat Bit. Surf. Repair	24'		MC-2, 6646 Gal. Agg. 571 Tons
C	0112-23	Plant Mix Bit. Gravel Shoulders	24'	2"	1003 Tons Bit. Mat.
M	1962	Light Bit. Seal Spot Treat Bit. Surf. Repair	24'		RS-2, 2591 Gal. MC-2, 9450 Gal. Agg. 109 C.Y. & 750 tons
M	1963	Light Bit. Seal	25'		RS-2, 19,663 Gal. Agg. 802 C.Y.
M	1968	Spot Bit. Surf. Repair	24'	1"	MC-250 Tack, 400 Gal. MC-800, 902 Tons
M	1970	Spot Bit. Surface Repair	24'	1"	MC-250 Tack, 365 Gal. MC-3000, 720 Tons
C	0112-26	Plant Mix Bit. Gravel Shoulders	24'	1 1/2"	

1		1975	
2	11.25 (Net 3.08)	1.37	18.38
3	2.50 (Net 1.20)		
4	8.00 (Net 2.10)		
5	8.35 (Net 1.20)		
6		22.05 (Net 3.05)	
7	6.15 (Net 1.20)		
8	4.85 (Net 0.80)		
9	11.25		
10	1.69 (Seal)		14.80 (Net Repair 1.05)
11	11.25		
12			444 (Net 138)
13			31.00 (Net Repair 0.85)
14			18.38

YEARS		TOTAL MILES	UNINCORPORATED		INCORPORATED		RURAL		URBAN	
FROM	TO		RDWY. MI.	BR. MI.	RDWY. MI.	BR. MI.	RDWY. MI.	BR. MI.	RDWY. MI.	BR. MI.

REMARKS: See Sheet No. 1

PREPARED BY
BUREAU OF POLICY & PLANNING
IN COOPERATION WITH
U.S. DEPARTMENT OF TRANSPORTATION-FEDERAL HIGHWAY ADMINISTRATION

STATE OF MINNESOTA
DEPARTMENT OF TRANSPORTATION
CONSTRUCTION PROJECT LOG RECORD

CONTROL SECTION 0112
TRUNK HIGHWAY 65
COUNTY Aitkin
DISTRICT 1A

LIMITS: Jct. T.H. 210 in McGregor-N. Co Line
Ref. Pt. 117+00.850 - 148+00.845

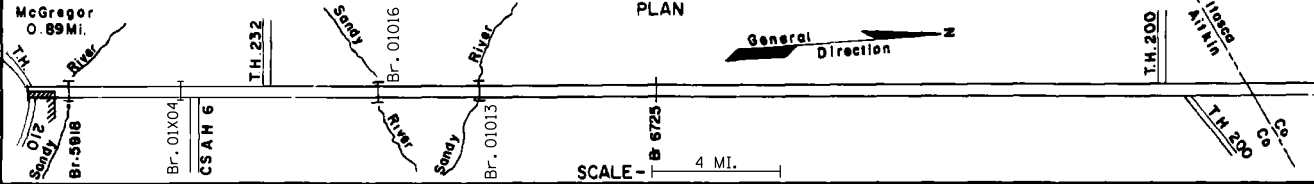

YEAR BUILT	PROJECT NO.	DESCRIPTION			
		TYPE	WIDTH	THICKNESS	REMARKS
M	1984 SF	Spot Bit. Overlay	24'	1-2"	Sp. 2341-1298 Tons
M	1986 SF	Spot Bit. Overlay	24'	1 1/2"	Spec. 2341
C	1986 0112-29	Remove Br. 6713			
M	1987 4262	Spot Bit. Overlay	24'	1 1/2"	Spec. 2341
C	1992 0112-31	Bit. Overlay Bit. Shouldering	24'	1 1/2"	Spec. 2341
C	1997 0112-35	Turn Lanes Culvert Replacement			
C	1997 0112-38	Bit. Surfacing	24'	1 1/2"	Type 31
C	2000 0112-40	Approach Grading Remove Br. 5918 Construct Br. 01014	24'		Over Sandy River
C	2000 0112-41	Milling Bit. Overlay	24'	1 1/2" Var.	Spec. 2350
C	2000 0112-10	Grading Bit. Overlay	24'	4.5"	Spec. 2350
C	2005 0112-34	Approach Grading Bit. Surface Bridges 01013, 01016	55' 24'	8" & 6.5"	Spec. 2350 Bit. Shoulders
C	2009 0112-47	Bit. Reclam. Milling Bit. Overlay	24'	var. 24'	Spec. 2360
C	2019 0112-52	Grading Full Depth Recon. Mill 2" & Bit Overlay Bituminous Surf.	30' var. var.	6" 4" 4"	12" agg. base cl.6 agg. shldr's 4" cl.6 widen shldr & ADA
C	2019 0112-56	Grading Full Depth Recon. Mill 2"-4" & Bit Overlay Bituminous Surf.	var. var. var.	6" 4" 4"	12" agg. base cl.6 agg. shldr's 4" cl.6 widen, RTL, Bypass

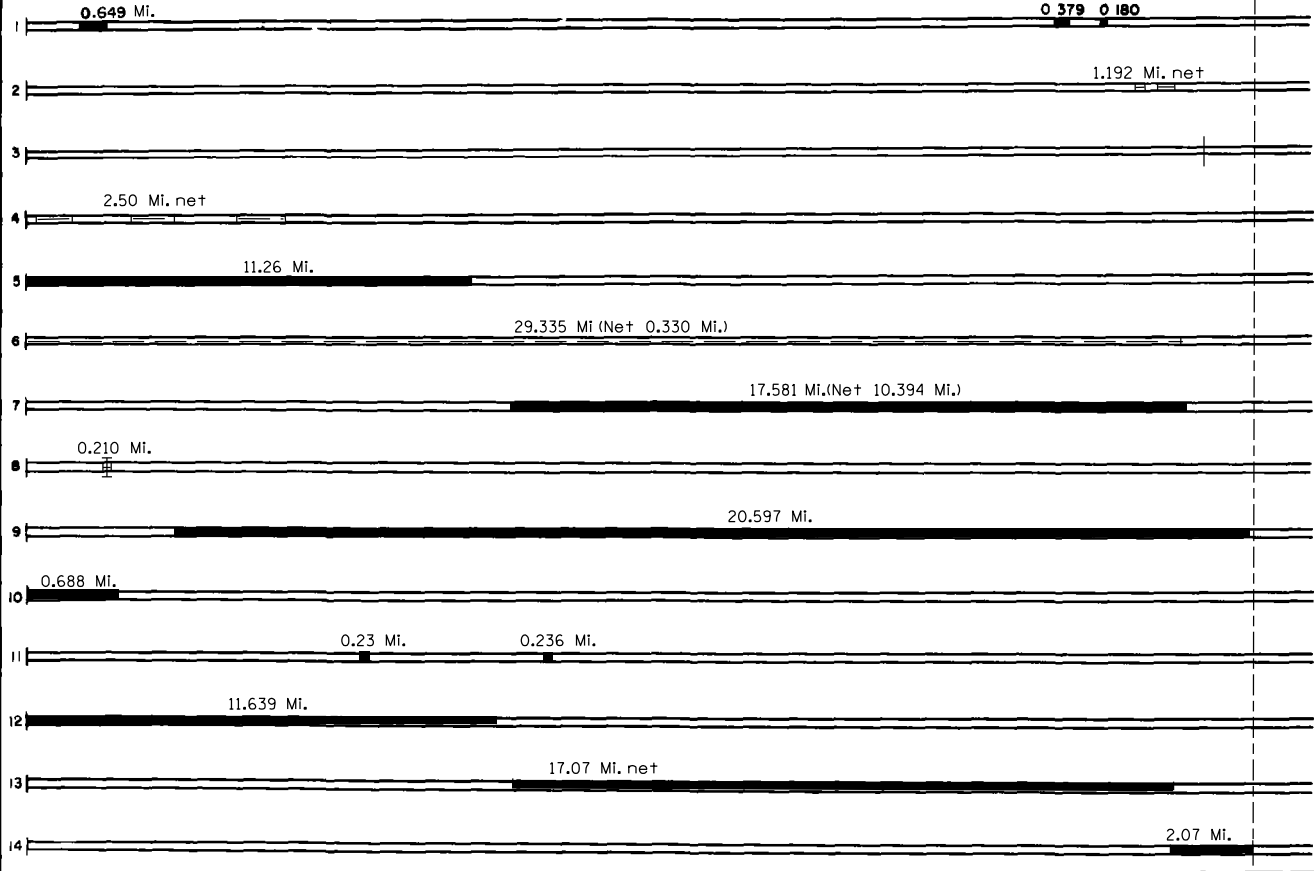

YEARS		TOTAL MILES	UNINCORPORATED		INCORPORATED		RURAL		URBAN	
FROM	TO		RDWY. MI.	BR. MI.	RDWY. MI.	BR. MI.	RDWY. MI.	BR. MI.	RDWY. MI.	BR. MI.

REMARKS: