

Sample Plan

CROSS SECTION MATCH LINE LAYOUT ----- NARRATIVE

References:

Design Scene: Chapter 17 - Cross Section

General Information:

A Cross Section Match Line Layout should be included in the Plan. Prepare a plan view showing each section at the proper station and distance from centerline. The purpose of Match Lines is to avoid duplication or omission of earthwork quantities.

Less complex projects, such as turn lanes, may not require a Cross Section Match Line Layout.

Match lines are shown when cross sections from separate alignments intersect (Intersections, ramps and loops at interchanges, etc.).

Sample Plan

CROSS SECTION MATCH LINE LAYOUT ----- CHECKLIST

- ___ 1. Label Alignments
- ___ 2. Show Stationing at 500' Increments
- ___ 3. Label Match Lines
- ___ 4. North Arrow
- ___ 5. Bar Scale
- ___ 6. Cross Section Index
- ___ 7. Cross references to other sheets (as applicable)
- ___ 8. Drawn by: and Checked by: Initials and Engineer's signature

REVISION DATE 12/13/16
 PLOTTED/REVISED: 26-JAN-2017 13:42

DISTRICT #: METRO
 IPLOT NAME: spxsmatchl
 FILENAME: Projects\DM_R0S\Non_Proj\rect\Design\SamplePlan\Eng\lsh\Xsmatch.dgn

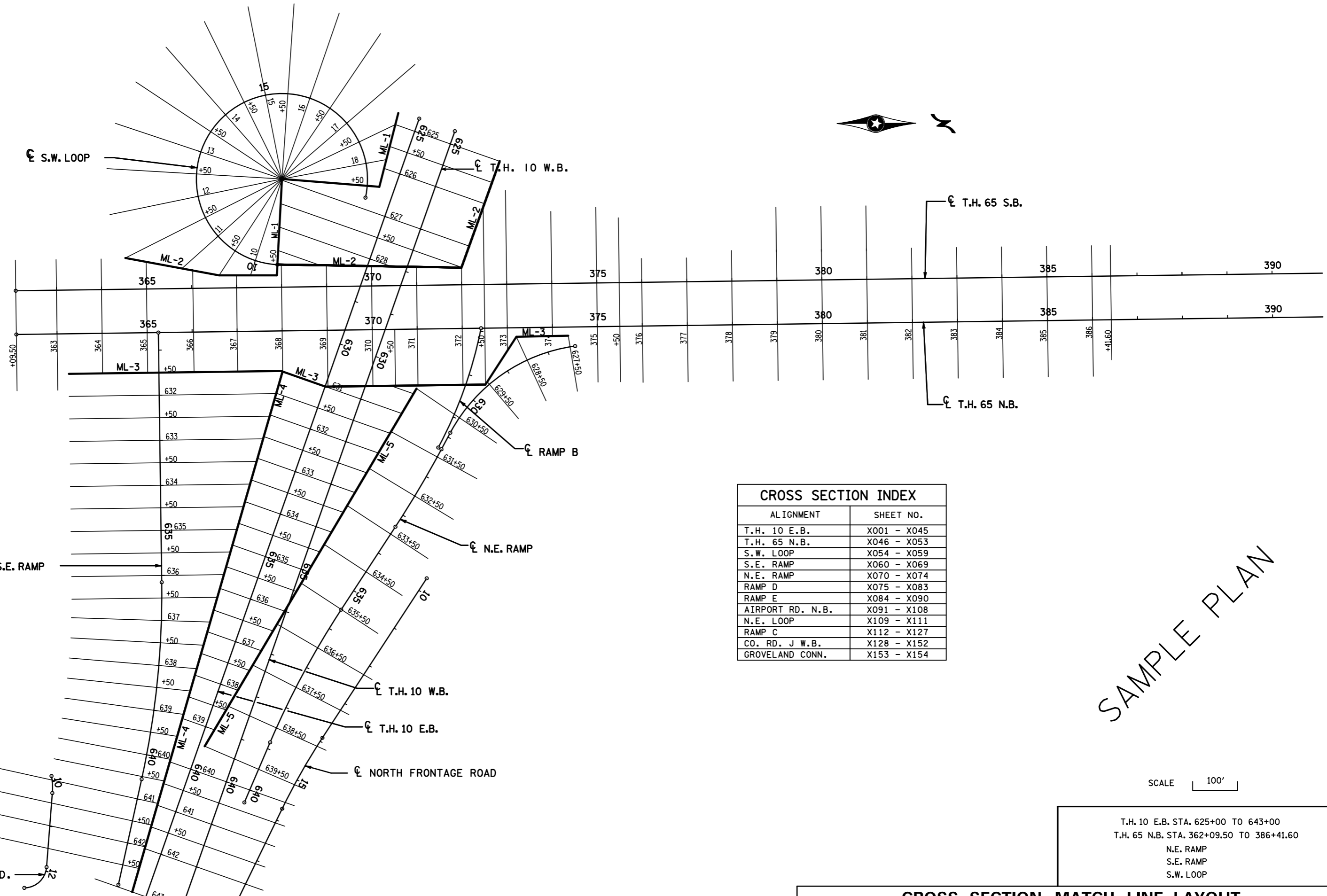

CROSS SECTION INDEX	
ALIGNMENT	SHEET NO.
T.H. 10 E.B.	X001 - X045
T.H. 65 N.B.	X046 - X053
S.W. LOOP	X054 - X059
S.E. RAMP	X060 - X069
N.E. RAMP	X070 - X074
RAMP D	X075 - X083
RAMP E	X084 - X090
AIRPORT RD. N.B.	X091 - X108
N.E. LOOP	X109 - X111
RAMP C	X112 - X127
CO. RD. J W.B.	X128 - X152
GROVELAND CONN.	X153 - X154

SAMPLE PLAN

SCALE 100'

T.H. 10 E.B. STA. 625+00 TO 643+00
 T.H. 65 N.B. STA. 362+09.50 TO 386+41.60
 N.E. RAMP
 S.E. RAMP
 S.W. LOOP

CROSS SECTION MATCH LINE LAYOUT

DISTRICT #: METRO
 IPLOT NAME: spxsmatch2
 PATH & FILENAME: Projects\DM_ROS\Non_Project\Design\SamplePlan\English\asmatch2.dgn
 REVISION DATE 07/14/06
 PLOTTED/REVISED: 26-JAN-2017 13:42

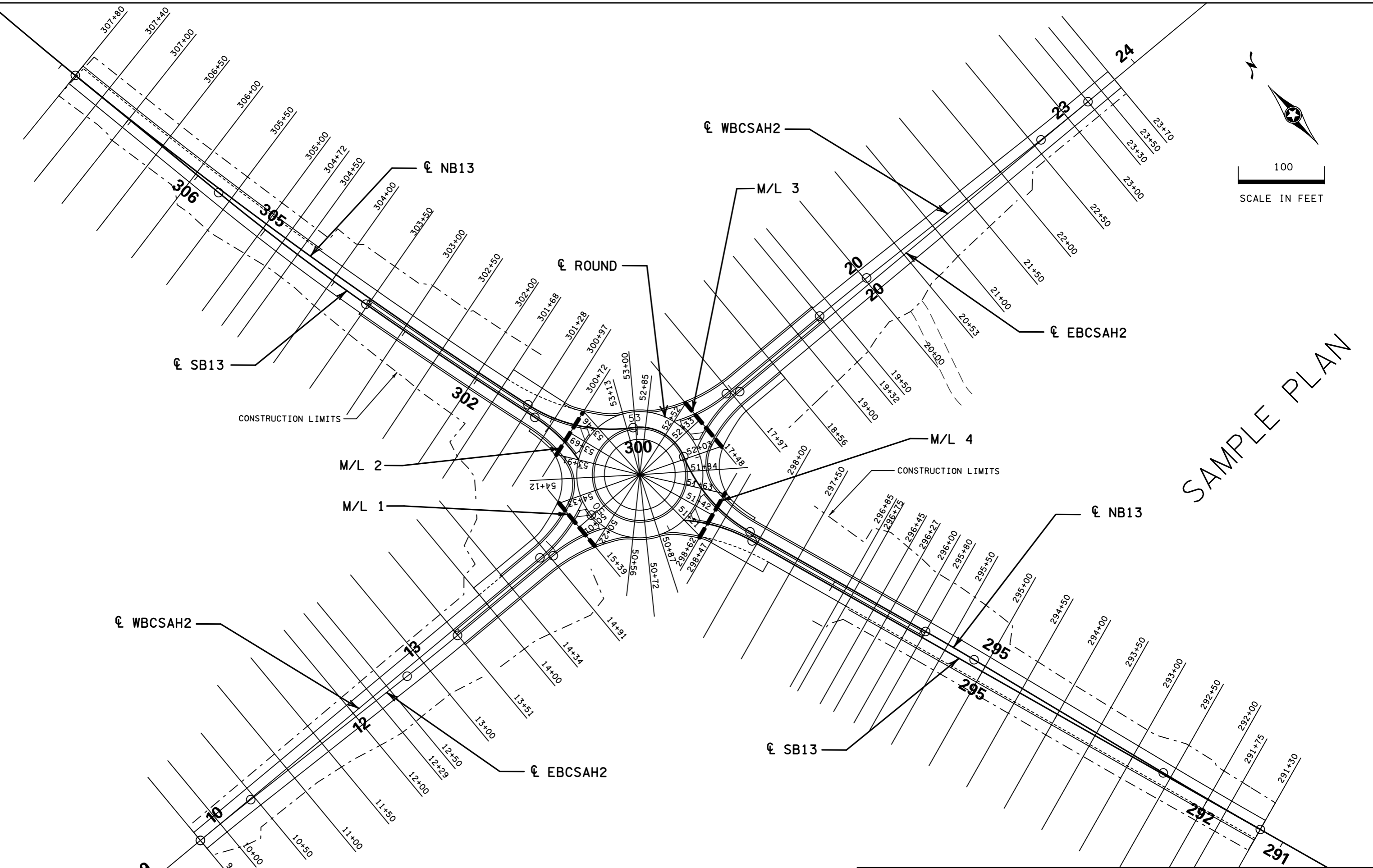

SAMPLE PLAN

CROSS SECTION MATCH LINE LAYOUT