

# GENERAL HIGHWAY MAP YELLOW MEDICINE COUNTY MINNESOTA

PREPARED BY THE  
MINNESOTA DEPARTMENT OF TRANSPORTATION  
PROGRAM SUPPORT GROUP  
IN COOPERATION WITH  
U.S. DEPARTMENT OF TRANSPORTATION  
FEDERAL HIGHWAY ADMINISTRATION



2000  
BASIC DATA - 1977

Projection:  
Minnesota Coordinate System  
South Zone  
Lambert Conformal Conic  
North American Datum  
of 1983

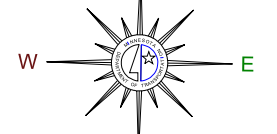

## LEGEND

ROAD AND ROADWAY FEATURES		NAVIGATION	
PROJECTED ROAD	(Symbol)	ANCHOR ON NATURAL OBSTACLE	(Symbol)
UNIMPAVED ROAD	(Symbol)	SHIP LINES ON HARBOR AREA	(Symbol)
GRAVEL AND GRAVEL ROAD	(Symbol)	DOCK, PIER OR MARINA	(Symbol)
SOIL SURFACE ROAD	(Symbol)	CRACKLED ICE	(Symbol)
BROWSDAYS ROAD	(Symbol)	NAVIGABLE STREAM	(Symbol)
RAVINE ROAD	(Symbol)	DAM WITH LOCK	(Symbol)
BIODEE ROAD	(Symbol)	LARGE DAM LIGHT BRIDGE	(Symbol)
TRAIL	(Symbol)	LOCK	(Symbol)
ROADS AS INCORPORATED CONTRACTS	(Symbol)		
ROADS INCORPORATED CONTRACTS	(Symbol)		
ROADS INCORPORATED CONTRACTS	(Symbol)		
ROADS INCORPORATED CONTRACTS	(Symbol)		
ROADS INCORPORATED CONTRACTS	(Symbol)		

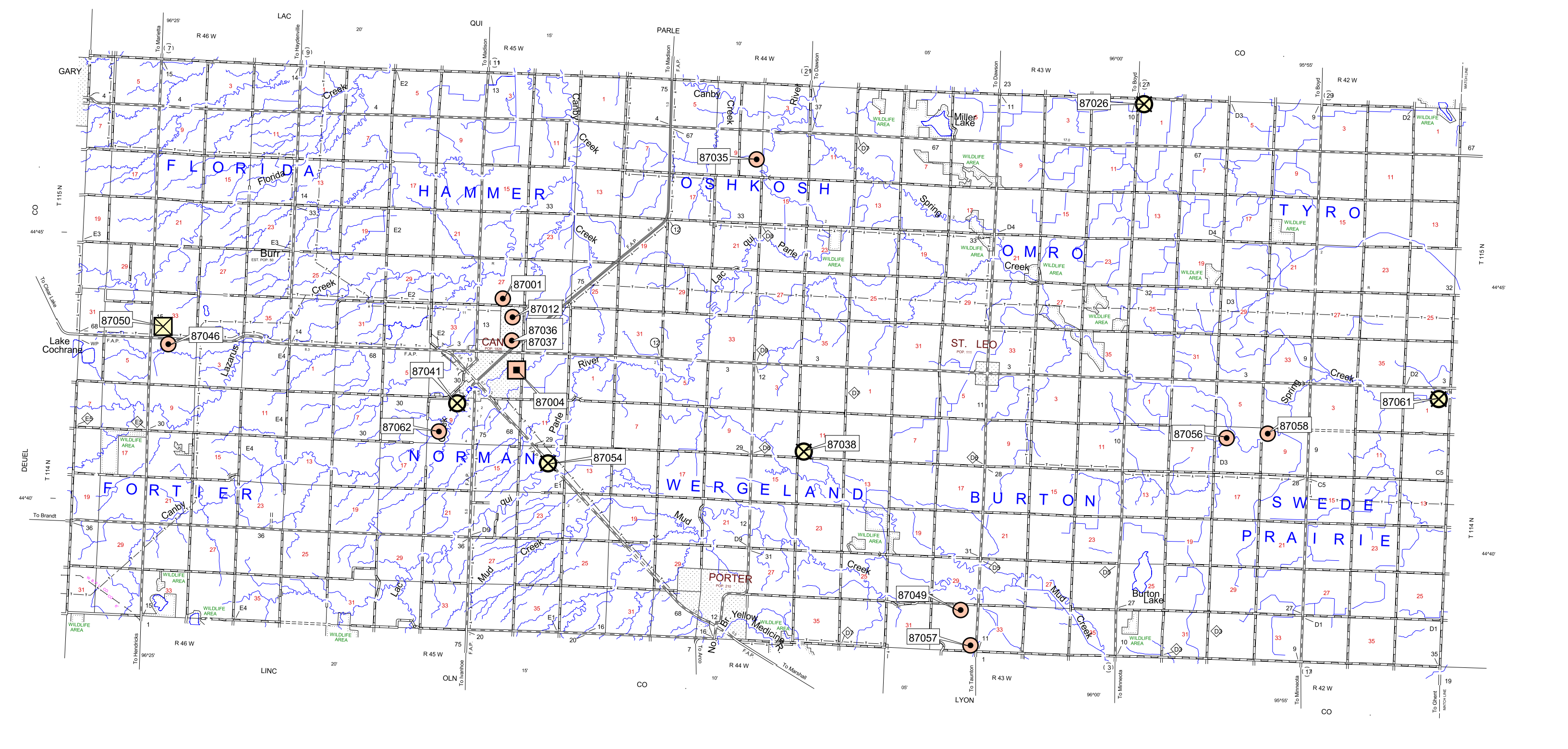

### Aggregate Source Legend

- Gravel Pit - Active
- Gravel Pit - Inactive
- Mn/DOT - Active
- Mn/DOT - Inactive
- Commercial Aggregate
- Rock Quarry

Source: Aggregate Unit  
Office of Materials & Road Research  
Minnesota Dept. of Transportation

6/2/2003

NOTE: ALL FEATURES EXCEPT TOWNSHIP ROADS AND  
CULTURE ARE CURRENT AS OF JANUARY 1, 2000  
NOTE: FOR DETAILS OF COUNTY STATE AND HIGHWAYS AND COUNTY  
ROADS IN INCORPORATED PLACES, SEE MAPS OF MUNICIPALITIES.

