

GENERAL HIGHWAY MAP  
**MARSHALL COUNTY**  
MINNESOTA

PREPARED BY THE  
MINNESOTA DEPARTMENT OF TRANSPORTATION  
PROGRAM SUPPORT GROUP  
IN COOPERATION WITH  
U.S. DEPARTMENT OF TRANSPORTATION  
FEDERAL HIGHWAY ADMINISTRATION

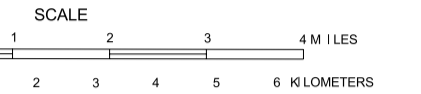

2000  
BASIC DATA - 1977

Projection:  
Minnesota Coordinate System  
North Zone  
Lambert Conformal Conic

North American Datum  
of 1983

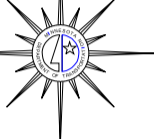

LEGEND

**ROAD AND ROADWAY FEATURES**

- Interstate
- State Highway
- County Highway
- County State Aid
- County State Aid in
- County State Aid
- State Highway
- State Road
- Interstate Exit
- General Road
- Federal Aid Interstate System
- National Forest Highway
- National Forest Highway
- County State Aid
- County State Aid
- State Highway
- State Road

**NAVIGATION**

- Interstate
- State Highway
- County Highway
- County State Aid
- County State Aid
- State Highway
- State Road

**CONSERVATION**

- Forest Reserve
- National Forest
- State Park
- Wildlife Refuge
- State Park
- Wildlife Refuge
- State Park
- Wildlife Refuge

**RECREATION**

- State Park
- Wildlife Refuge
- State Park
- Wildlife Refuge

**FARM AND DWELLING UNITS**

- Farm
- Dwelling Unit

**INDUSTRIAL**

- Factory or Industrial Plant
- Storage Tank
- Warehouse
- Stockyard
- Grain Elevator
- Ice Plant
- Refrigeration Plant
- Power Plant
- Construction Station

**CITY CENTERS**

- State Capital
- County Seat
- City Center
- Incorporated City Center
- Unincorporated Community

**MISCELLANEOUS MAP FEATURES**

- Church
- Graveyard
- Public Building
- Public Library
- Public School
- Public Utility
- Public Utility
- Public Utility
- Public Utility

**BOUNDARIES**

- National
- State
- County
- Township
- Range
- Section
- Quarter Section
- Half Section
- Quarter Quarter Section
- Section Quarter
- Quarter Section
- Section Quarter
- Quarter Section
- Section Quarter

**DRAINAGE**

- Waterway
- Waterway
- Waterway
- Waterway
- Waterway
- Waterway
- Waterway
- Waterway

**Aggregate Source Legend**

- Gravel Pit - Active
- Gravel Pit - Inactive
- Mn/DOT - Active
- Mn/DOT - Inactive
- Commercial Aggregate
- Rock Quarry

Source: Aggregate Unit  
Office of Materials & Road Research  
Minnesota Dept. of Transportation

5/27/2003

NORTH DAKOTA

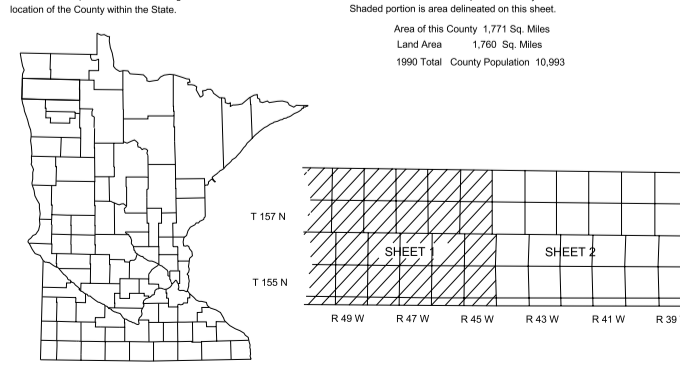
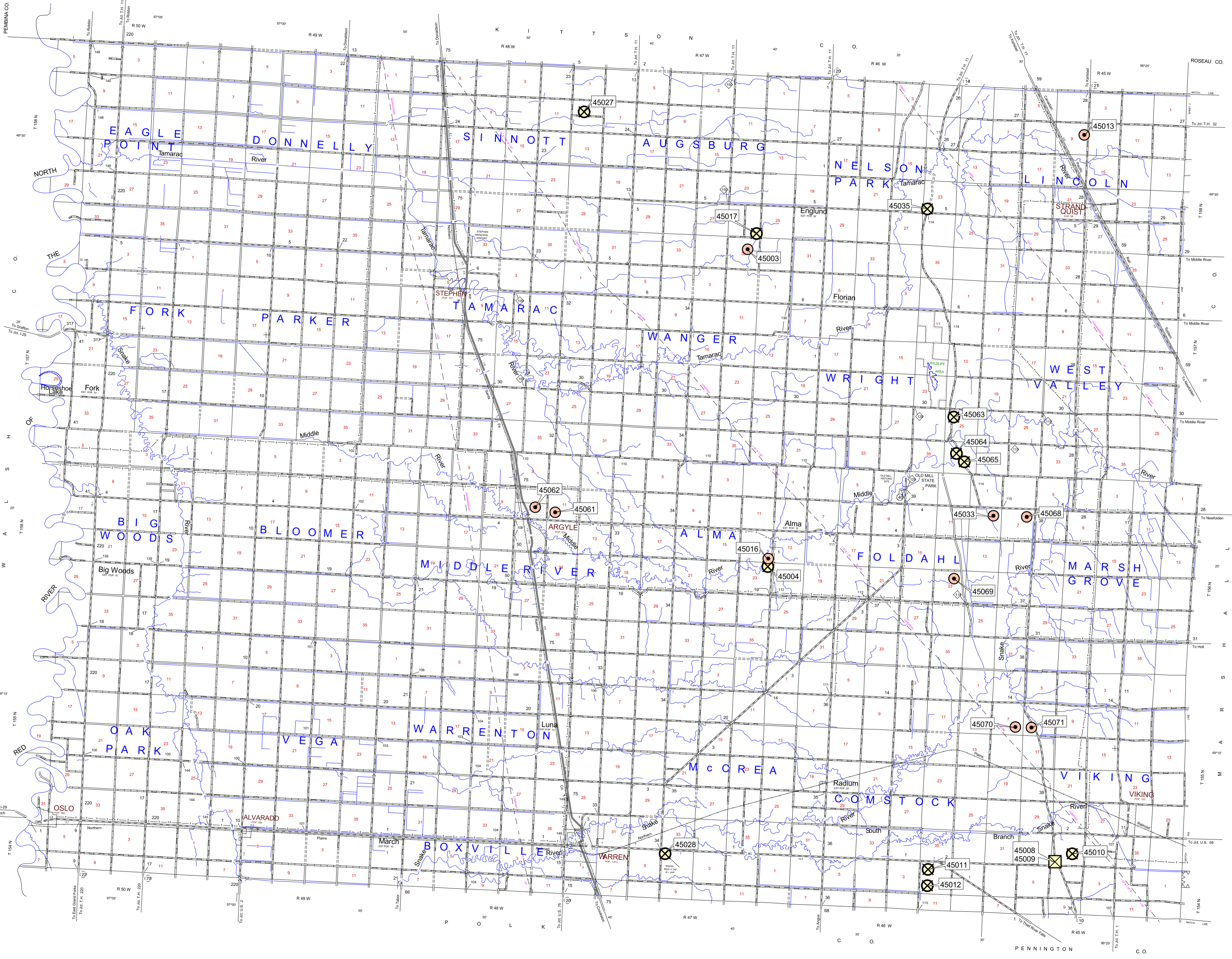

\*NOTE: ALL FEATURES EXCEPT TOWNSHIP ROADS AND CULTURE ARE CURRENT AS OF JANUARY 1, 2000.  
NOTE: FOR DETAIL OF COUNTY STATE AID HIGHWAYS AND COUNTY ROADS IN INCORPORATED PLACES, SEE MAPS OF MUNICIPALITIES.