

TRIBAL GOVERNMENT MAP

# UPPER SIOUX COMMUNITY

PREPARED BY THE  
MINNESOTA DEPARTMENT OF TRANSPORTATION  
OFFICE OF TRANSPORTATION SYSTEM MANAGEMENT

IN COOPERATION WITH  
U.S. DEPARTMENT OF TRANSPORTATION  
FEDERAL HIGHWAY ADMINISTRATION

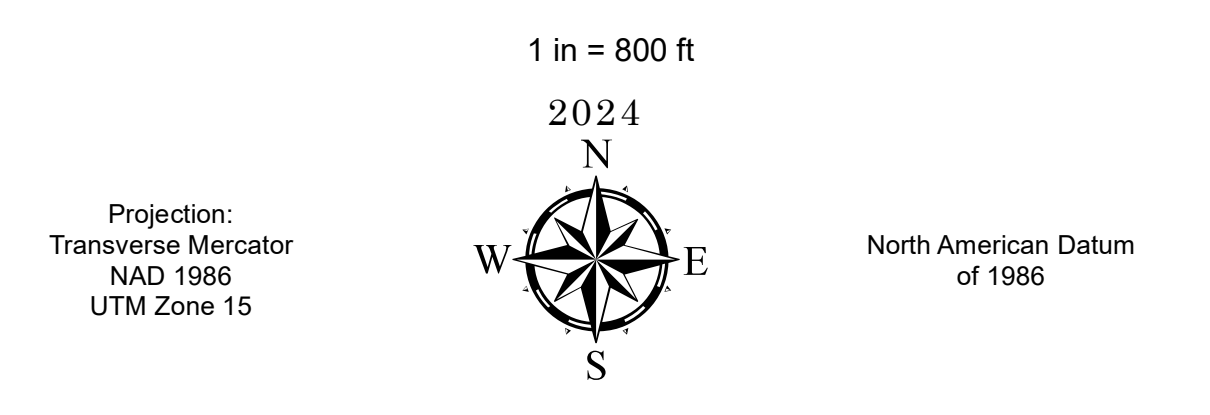
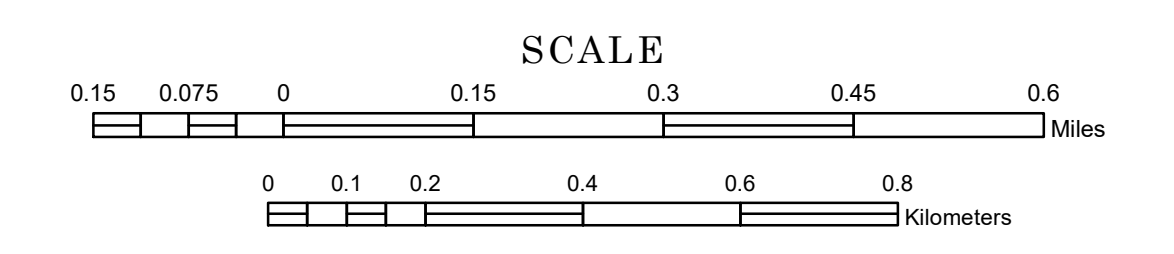

ROAD AND ROADWAY FEATURES		PUBLIC SERVICE FEATURES	
INTERSTATE.....		MINOT OFFICE.....	
US HIGHWAY.....		MINOT TRUCK STATION.....	
MN HIGHWAY.....		HIGHWAY PATROL DISTRICT OFFICE.....	
COUNTY STATE AID HIGHWAY.....		STATE TRAVEL INFORMATION CENTER.....	
COUNTY ROAD.....		REST AREA (Full Service).....	
MUNICIPAL STATE AID STREET.....		REST AREA (Vault Toilet).....	
MUNICIPAL STREET.....		WAYSIDE (Vault or Pit Toilet).....	
PRIVATE STREET.....		LOCAL PARK.....	
TOWNSHIP ROAD.....		PUBLIC ACCESS POINT.....	
UNORGANIZED TERRITORY ROAD.....		FAIRGROUNDS.....	
RAMP OR CONNECTOR.....		PORT OF ENTRY.....	
INTERSTATE EXIT.....		PARK AND RIDE LOT.....	
GREAT RIVER ROAD.....		MN STATE COLLEGE AND UNIVERSITY SYSTEM (MNSCU).....	
OTHER ROADS		UNIVERSITY OF MN SYSTEM.....	
Farm Road.....		CULTURAL FEATURES	
State Park.....		STATE HISTORICAL MARKER.....	
National Forest.....		HISTORIC DISTRICT.....	
National Monument.....		HISTORIC SITE.....	
National Wildlife Refuge.....		MONUMENT.....	
AVIATION FEATURES		BOUNDARY FEATURES	
COMMERCIAL AIRPORT.....		TRIBAL LAND.....	
GENERAL AIRPORT.....		COUNTY.....	
AIRSTRIP.....		MUNICIPALITY.....	
SEAPLANE.....		ADJACENT MUNICIPALITY.....	
AIRPORT RUNWAY.....		FEDERAL ADJUSTED URBAN AREA (2014).....	
RAILROAD AND RAILWAY FEATURES		MILITARY.....	
RAILWAY.....		VOYAGEURS NATIONAL PARK.....	
EMPIRE BUILDER STATION (Amtrak).....		BOUNDARY WATERS CANOE AREA WILDERNESS.....	
NORTHSTAR STATION (Comuter).....		STATE PARK.....	
LIGHT RAIL.....		REGIONAL PARK.....	
BLUE LINE.....		NATIONAL FOREST.....	
GREEN LINE.....		NATIONAL AND STATE FOREST.....	
INFRASTRUCTURE FEATURES		STATE FOREST.....	
LONG BRIDGE (300' or Greater Span).....		NATIONAL TRAIL.....	
MAJOR BRIDGE (20' to 300' Span).....		WILDLIFE REFUGE AREA.....	
MINOR BRIDGE (5' to 20' Span).....		WILDLIFE MANAGEMENT AREA.....	
DAM.....		RIVER OR STREAM (Perennial).....	
LOCK AND DAM.....		LAKE, POND OR RESERVOIR.....	
PUBLIC FACILITIES		STREAM (Intermittent).....	
STATE CAPITOL.....		DRAINAGE DITCH.....	
FEDERAL COURTHOUSE.....		WETLAND.....	
COUNTY COURTHOUSE.....		ISLAND OR LAND.....	
ARMORY.....		REGIONAL WATERSHED.....	
CITY CENTERS		HYDROLOGIC FEATURES	
TRIBAL GOVERNMENT CENTER.....		WETLAND.....	
CITY CENTER.....		ISLAND OR LAND.....	
LOCALLY KNOWN PLACE.....		REGIONAL WATERSHED.....	
UNINCORPORATED COMMUNITY.....			

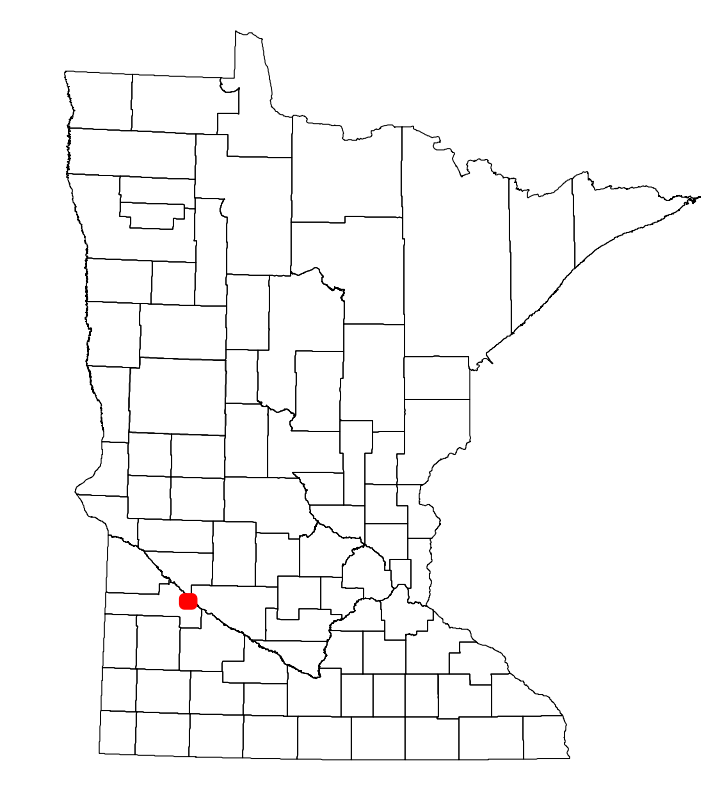

Population (U.S. Census 2000):

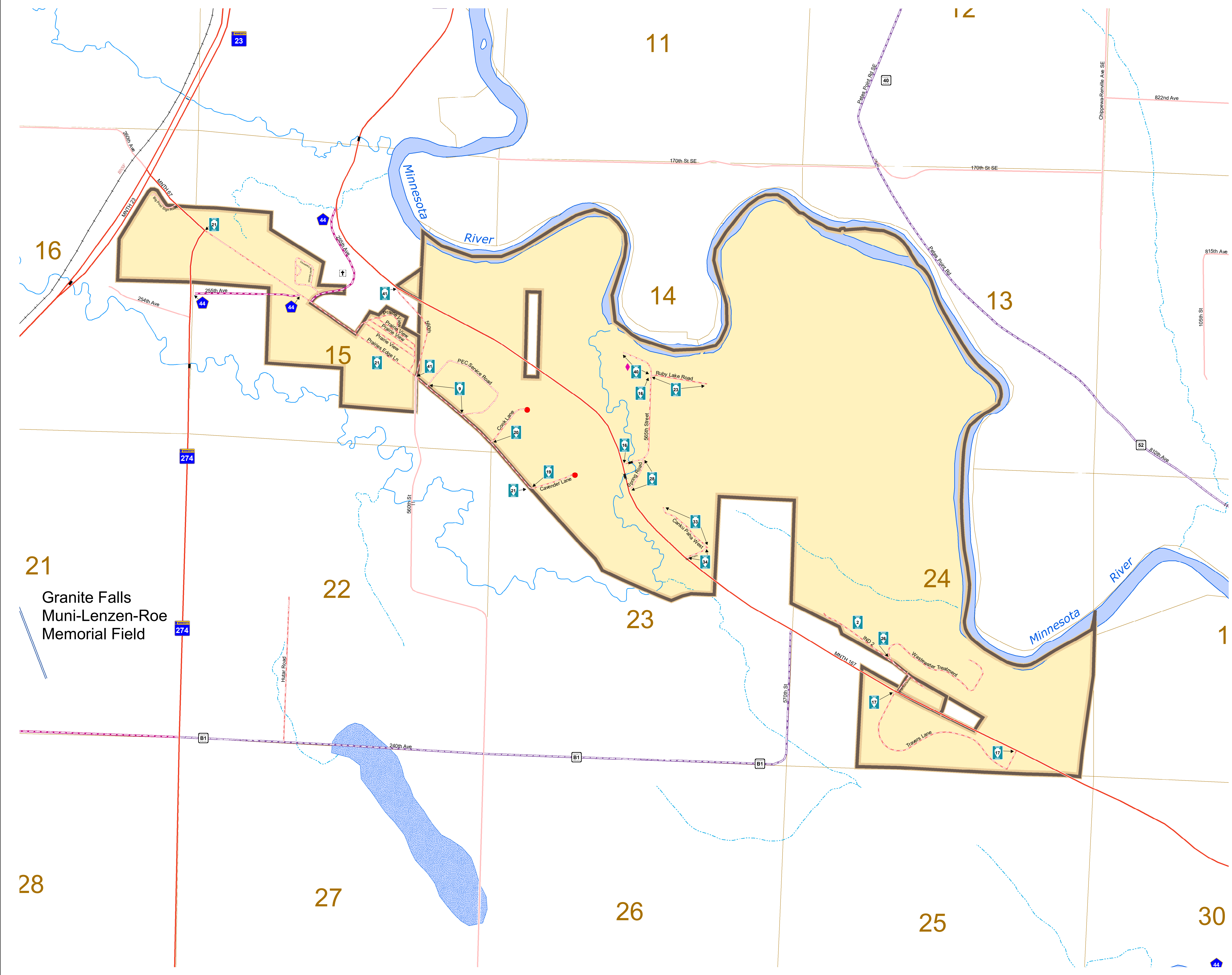

To request information from this document in an alternative format, call 651-366-4718 or 1-800-657-3774 (Greater Minnesota); 711 or 1-800-627-3529 (Minnesota Relay). You may also send an e-mail to [ADArequest.dot@state.mn.us](mailto:ADArequest.dot@state.mn.us). (Please request at least one week in advance.)