

TOWNSHIP OF WILLOW LAKE

PREPARED BY THE
MINNESOTA DEPARTMENT OF TRANSPORTATION
OFFICE OF TRANSPORTATION SYSTEM MANAGEMENT

IN COOPERATION WITH
U.S. DEPARTMENT OF TRANSPORTATION
FEDERAL HIGHWAY ADMINISTRATION

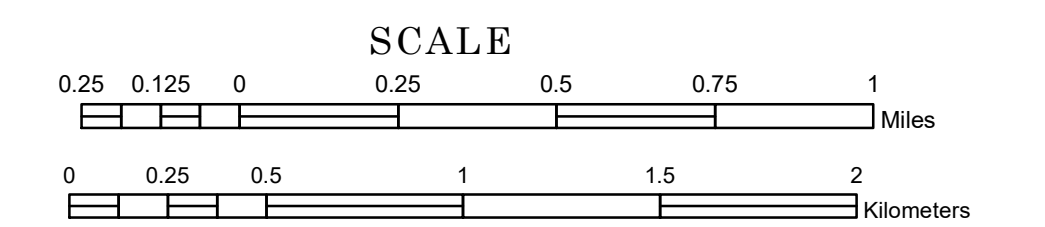

2023

Projection:
Transverse Mercator
NAD 1986
UTM Zone 15



North American Datum
of 1986

ROAD AND ROADWAY FEATURES		AVIATION FEATURES	
INTERSTATE	CONCRETE	COMMERCIAL AIRPORT	GENERAL AIRPORT
US HIGHWAY	BITUMINOUS	AIRSTRIP	SEAPLANE
MN HIGHWAY	GRAVEL	AIRPORT RUNWAY	
COUNTY STATE AID HIGHWAY	DIRT/UNIMPROVED		
COUNTY ROAD	OTHER		
TOWNSHIP ROAD	UNKNOWN		
UNORGANIZED TERRITORY ROAD			
OTHER ROADS	RAMP OR CONNECTOR		
Municipal	INTERSTATE EXIT		
Private	GREAT RIVER ROAD		
National Monument			
National Park			
National Wildlife			
State Game			
State Park			
Preserve			
RAILROAD AND RAILWAY FEATURES		BOUNDARY FEATURES	
EMPIRE BUILDER STATION (AMTRAK)	TRIBAL LAND	STATE OF MINNESOTA	COUNTY
NORTHSTAR STATION (COMMUTER)	STATE OF MINNESOTA	COUNTY	MUNICIPALITY
			UNORGANIZED TERRITORY
			FEDERAL ADJUSTED URBAN AREA (2014)
			CIVIL TOWNSHIP
			CONGRESSIONAL TOWNSHIP
			SECTION
			MILITARY
			VOYAGEURS NATIONAL PARK
			BOUNDARY WATERS CANOE AREA WILDERNESS
			STATE PARK
			REGIONAL PARK
			NATIONAL FOREST
			NATIONAL AND STATE FOREST
			STATE FOREST
			NATIONAL TRAIL
			WILDLIFE REFUGUE AREA
			WILDLIFE MANAGEMENT AREA
INFRASTRUCTURE FEATURES		HYDROLOGIC FEATURES	
LONG BRIDGE (200' or Greater Span)	TRIAL LAND	STATE OF MINNESOTA	COUNTY
MAJOR BRIDGE (20' to 200' Span)	STATE OF MINNESOTA	COUNTY	MUNICIPALITY
MINOR BRIDGE (5' to 20' Span)			UNORGANIZED TERRITORY
DAM			FEDERAL ADJUSTED URBAN AREA (2014)
LOCK AND DAM			CIVIL TOWNSHIP
			CONGRESSIONAL TOWNSHIP
			SECTION
			MILITARY
			VOYAGEURS NATIONAL PARK
			BOUNDARY WATERS CANOE AREA WILDERNESS
			STATE PARK
			REGIONAL PARK
			NATIONAL FOREST
			NATIONAL AND STATE FOREST
			STATE FOREST
			NATIONAL TRAIL
			WILDLIFE REFUGUE AREA
			WILDLIFE MANAGEMENT AREA
CITY CENTERS		HYDROLOGIC FEATURES	
STATE CAPITAL	STATE OF MINNESOTA	COUNTY	MUNICIPALITY
COUNTY SEAT			UNORGANIZED TERRITORY
CITY CENTER			FEDERAL ADJUSTED URBAN AREA (2014)
UNINCORPORATED COMMUNITY			CIVIL TOWNSHIP
			CONGRESSIONAL TOWNSHIP
			SECTION
			MILITARY
			VOYAGEURS NATIONAL PARK
			BOUNDARY WATERS CANOE AREA WILDERNESS
			STATE PARK
			REGIONAL PARK
			NATIONAL FOREST
			NATIONAL AND STATE FOREST
			STATE FOREST
			NATIONAL TRAIL
			WILDLIFE REFUGUE AREA
			WILDLIFE MANAGEMENT AREA
PUBLIC SERVICE FEATURES		HYDROLOGIC FEATURES	
MNDOT OFFICE	STATE OF MINNESOTA	COUNTY	MUNICIPALITY
MNDOT TRUCK STATION			UNORGANIZED TERRITORY
HIGHWAY PATROL DISTRICT OFFICE			FEDERAL ADJUSTED URBAN AREA (2014)
STATE TRAVEL INFORMATION CENTER			CIVIL TOWNSHIP
REST AREA (Full Service)			CONGRESSIONAL TOWNSHIP
REST AREA (Vault Toilet)			SECTION
WAYSIDE (Vault or Pit Toilet)			MILITARY
PARK AND RIDE LOT			VOYAGEURS NATIONAL PARK
PORT OF ENTRY			BOUNDARY WATERS CANOE AREA WILDERNESS
PUBLIC ACCESS POINT			STATE PARK
MN STATE COLLEGE AND UNIVERSITY SYSTEM (MNSCU)			REGIONAL PARK
UNIVERSITY OF MN SYSTEM			NATIONAL FOREST
FAIRGROUNDS			NATIONAL AND STATE FOREST
			STATE FOREST
			NATIONAL TRAIL
			WILDLIFE REFUGUE AREA
			WILDLIFE MANAGEMENT AREA
CULTURAL FEATURES		HYDROLOGIC FEATURES	
STATE HISTORICAL MARKER	STATE OF MINNESOTA	COUNTY	MUNICIPALITY
HISTORIC DISTRICT			UNORGANIZED TERRITORY
HISTORIC SITE			FEDERAL ADJUSTED URBAN AREA (2014)
MONUMENT			CIVIL TOWNSHIP
			CONGRESSIONAL TOWNSHIP
			SECTION
			MILITARY
			VOYAGEURS NATIONAL PARK
			BOUNDARY WATERS CANOE AREA WILDERNESS
			STATE PARK
			REGIONAL PARK
			NATIONAL FOREST
			NATIONAL AND STATE FOREST
			STATE FOREST
			NATIONAL TRAIL
			WILDLIFE REFUGUE AREA
			WILDLIFE MANAGEMENT AREA
			WILDLIFE REFUGUE AREA
			WILDLIFE MANAGEMENT AREA
			WILDLIFE REFUGUE AREA
			WILDLIFE MANAGEMENT AREA
			WILDLIFE REFUGUE AREA
			WILDLIFE MANAGEMENT AREA

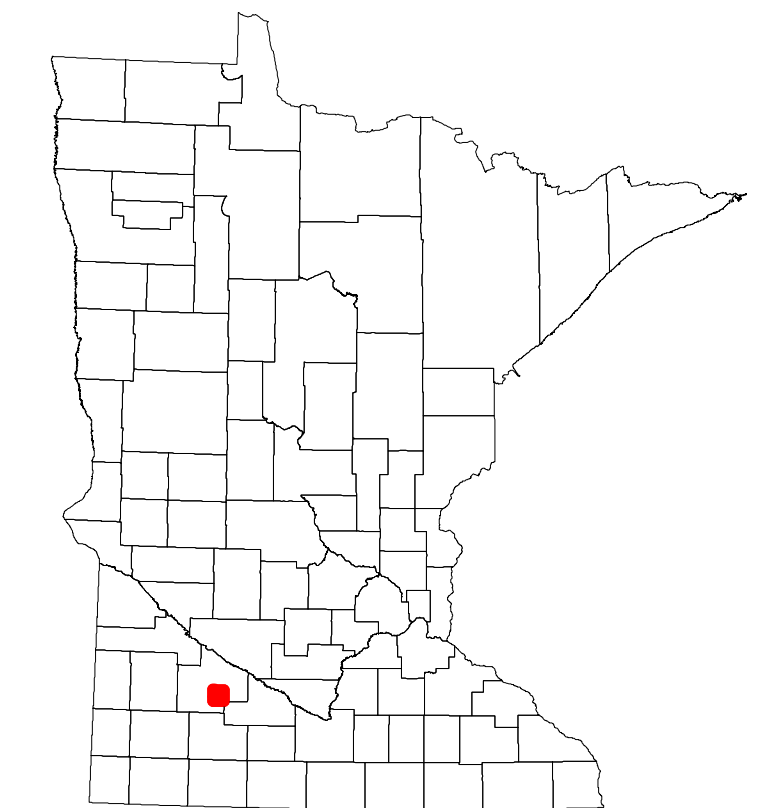

Population (U.S. Census 2010): 222

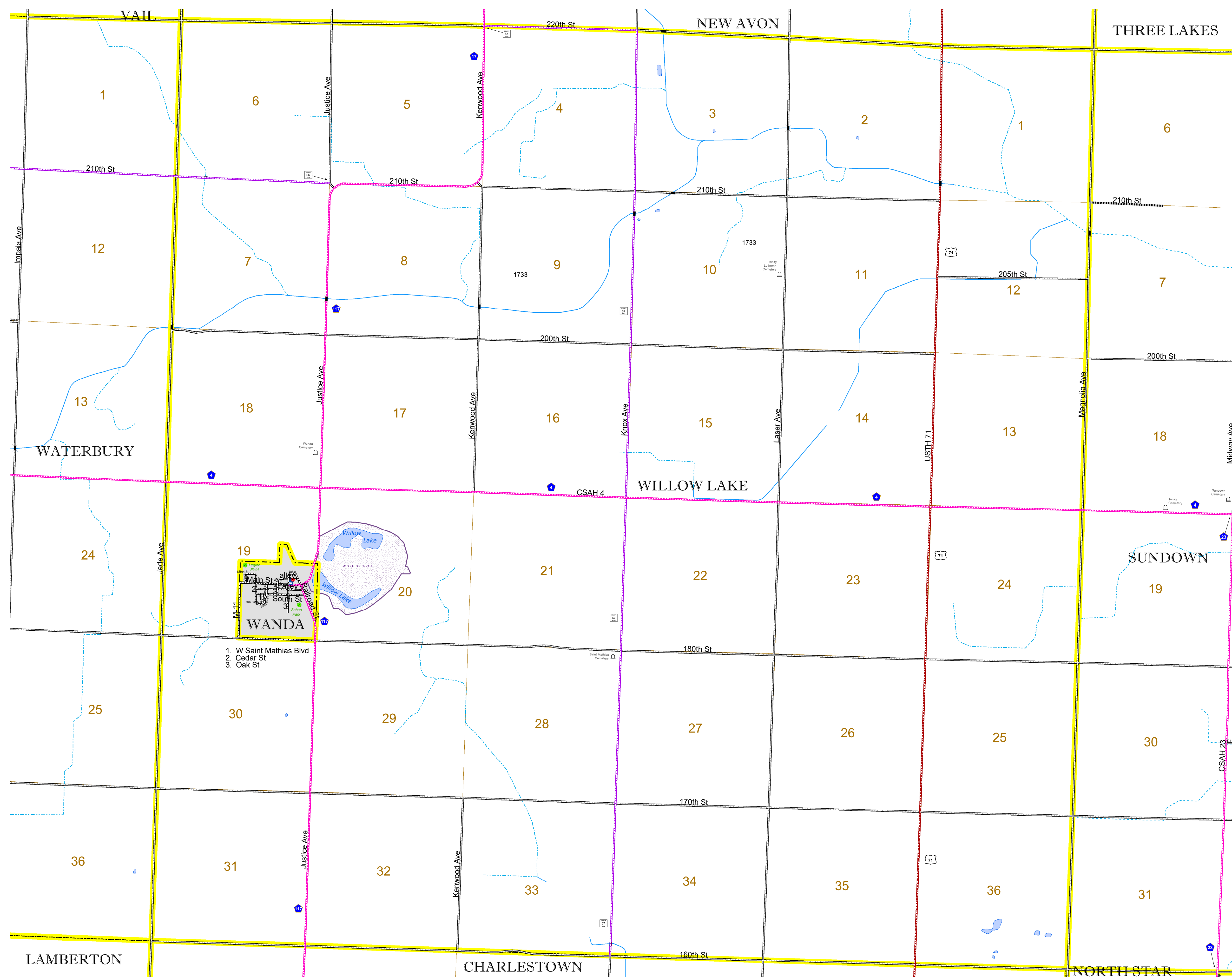

1. W Saint Mathias Blvd
2. Cedar St
3. Oak St

To request information from this document in an alternative format, call 651-366-4718 or 1-800-657-3774 (Greater Minnesota); 711 or 1-800-627-3529 (Minnesota Relay). You may also send an e-mail to ADRequest.dot@state.mn.us. (Please request at least one week in advance.)