

TOWNSHIP OF WESTSIDE

PREPARED BY THE
MINNESOTA DEPARTMENT OF TRANSPORTATION
OFFICE OF TRANSPORTATION SYSTEM MANAGEMENT

IN COOPERATION WITH
U.S. DEPARTMENT OF TRANSPORTATION
FEDERAL HIGHWAY ADMINISTRATION



1 in = 1,600 ft

2023

Projection:
Transverse Mercator
NAD 1986
UTM Zone 15



North American Datum
of 1986

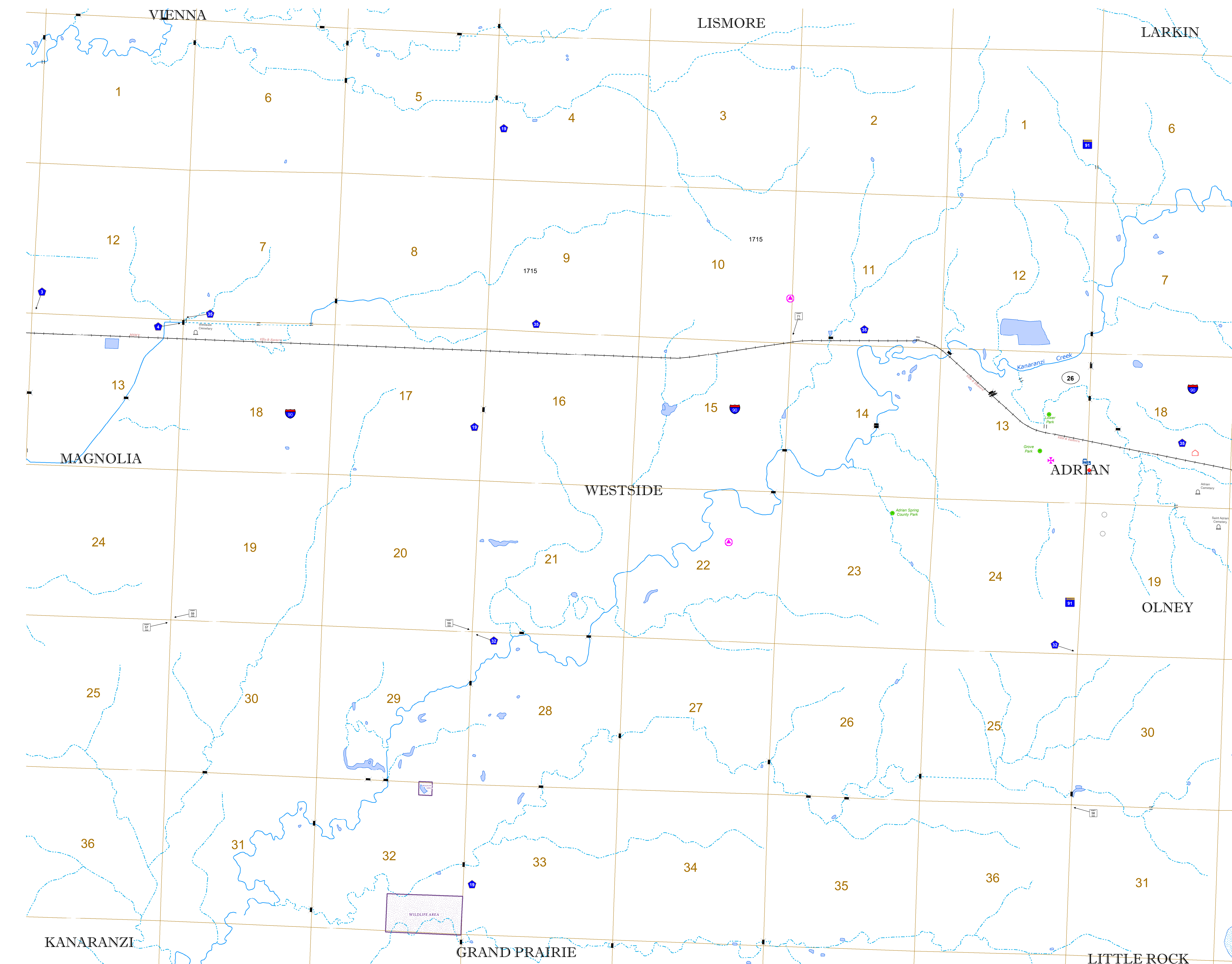

INTERSTATE	CONCRETE	AVIATION FEATURES
US HIGHWAY	BITUMINOUS	GENERAL AIRPORT
MN HIGHWAY	GRAVEL	AIRSTRIP
COUNTY STATE AID HIGHWAY	DIRT/UNIMPROVED	SEAPLANE
COUNTY ROAD	OTHER	AIRPORT RUNWAY
TOWNSHIP ROAD	UNKNOWN	AIRPORT TAXIWAY
UNORGANIZED TERRITORY ROAD	RAMP OR CONNECTOR	BOUNDARY FEATURES
OTHER ROADS	INTERSTATE EXIT	TRIBAL LAND
Municipal	GREAT RIVER ROAD	STATE OF MINNESOTA
Private	RAILROAD AND RAILWAY FEATURES	COUNTY
National Monument	EMPIRE BUILDER STATION (AMTRAK)	MUNICIPALITY
National Park	NORTHSTAR STATION (COMMUTER)	UNORGANIZED TERRITORY
National Wildlife Refuge	LIGHT RAIL	FEDERAL ADJUSTED URBAN AREA (2014)
State Park	BLUE LINE	CIVIL TOWNSHIP
State Park Preserve	GREEN LINE	CONGRESSIONAL TOWNSHIP
Section	INFRASTRUCTURE FEATURES	MILITARY
Section	LONG BRIDGE (200' OR GREATER SPAN)	VOYAGEURS NATIONAL PARK
Section	MAJOR BRIDGE (20' TO 200' SPAN)	BOUNDARY WATERS CANOE AREA WILDERNESS
Section	MINOR BRIDGE (5' TO 20' SPAN)	STATE PARK
Section	DAM	REGIONAL PARK
Section	LOCK AND DAM	NATIONAL FOREST
Section	CITY CENTERS	NATIONAL AND STATE FOREST
Section	STATE CAPITAL	STATE FOREST
Section	COUNTY SEAT	NATIONAL TRAIL
Section	CITY CENTER	WILDLIFE REFUGE AREA
Section	UNINCORPORATED COMMUNITY	WILDLIFE MANAGEMENT AREA
Section	PUBLIC SERVICE FEATURES	HYDROLOGIC FEATURES
Section	MNDOT OFFICE	RIVER OR STREAM (PERMANENT)
Section	MNDOT TRUCK STATION	LAKE, POND OR RESERVOIR
Section	HIGHWAY PATROL DISTRICT OFFICE	STREAM (INTERMITTENT)
Section	STATE TRAVEL INFORMATION CENTER	DRAINAGE DITCH
Section	REST AREA (FULL SERVICE)	WETLAND
Section	REST AREA (VAULT TOILET)	ISLAND OR LAND
Section	WAYSIDE (VAULT OR PIT TOILET)	REGIONAL WATERSHED
Section	PARK AND RIDE LOT	
Section	PORT OF ENTRY	
Section	PUBLIC ACCESS POINT	
Section	MN STATE COLLEGE AND UNIVERSITY SYSTEM (MNSCU)	
Section	UNIVERSITY OF MN SYSTEM	
Section	FAIRGROUNDS	
Section	CULTURAL FEATURES	
Section	STATE HISTORICAL MARKER	
Section	HISTORIC DISTRICT	
Section	HISTORIC SITE	
Section	MONUMENT	

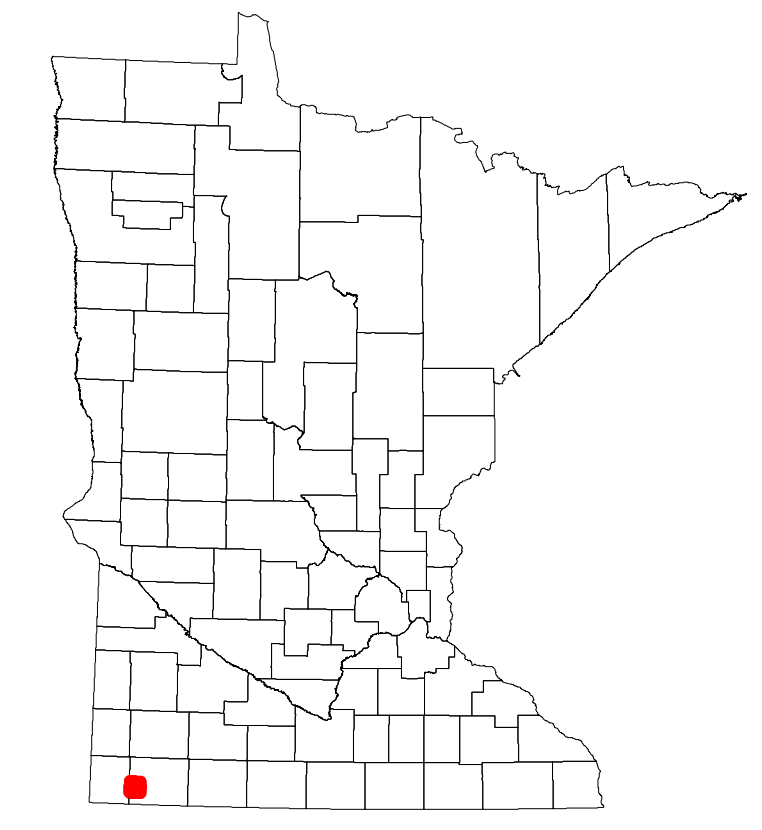

Population (U.S. Census 2010): 218

To request information from this document in an alternative format, call 651-366-4718 or 1-800-657-3774 (Greater Minnesota); 711 or 1-800-627-3529 (Minnesota Relay). You may also send an e-mail to ADRequest.dot@state.mn.us. (Please request at least one week in advance.)