

# TOWNSHIP OF SPENCER BROOK

PREPARED BY THE  
MINNESOTA DEPARTMENT OF TRANSPORTATION  
OFFICE OF TRANSPORTATION SYSTEM MANAGEMENT

IN COOPERATION WITH  
U.S. DEPARTMENT OF TRANSPORTATION  
FEDERAL HIGHWAY ADMINISTRATION

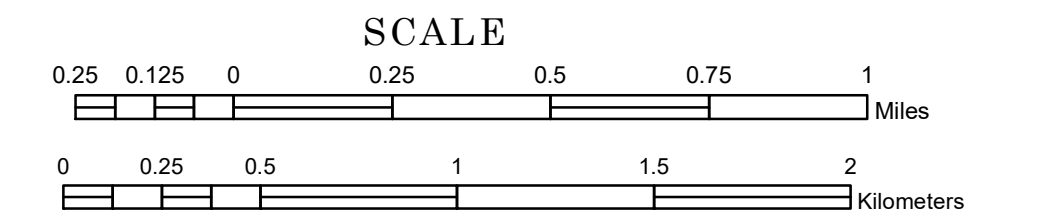

1 in = 1,600 ft

2024

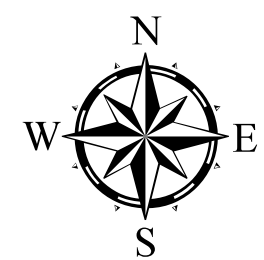

Projection:  
Transverse Mercator  
NAD 1986  
UTM Zone 15

North American Datum  
of 1986

ROAD AND ROADWAY FEATURES		BOUNDARY FEATURES	
INTERSTATE	[Symbol]	CONCRETE	[Symbol]
US HIGHWAY	[Symbol]	BITUMINOUS	[Symbol]
MN HIGHWAY	[Symbol]	GRAVEL	[Symbol]
COUNTY STATE AID HIGHWAY	[Symbol]	DIRT/UNIMPROVED	[Symbol]
COUNTY ROAD	[Symbol]	OTHER	[Symbol]
TOWNSHIP ROAD	[Symbol]	UNKNOWN	[Symbol]
UNORGANIZED TERRITORY ROAD	[Symbol]		
OTHER ROADS			
Municipal	[Symbol]	RAMP OR CONNECTOR	[Symbol]
Private	[Symbol]	INTERSTATE EXIT	[Symbol]
National Monument	[Symbol]	GREAT RIVER ROAD	[Symbol]
National Park	[Symbol]		
National Wildlife	[Symbol]		
State Game	[Symbol]		
State Park	[Symbol]		
Preserve	[Symbol]		
RAILROAD AND RAILWAY FEATURES		AVIATION FEATURES	
EMPIRE BUILDER STATION (AMTRAK)	[Symbol]	COMMERCIAL AIRPORT	[Symbol]
NORTHSTAR STATION (COMMUTER)	[Symbol]	GENERAL AIRPORT	[Symbol]
		AIRSTRIP	[Symbol]
		SEAPLANE	[Symbol]
		AIRPORT RUNWAY	[Symbol]
INFRASTRUCTURE FEATURES		CITY CENTERS	
LONG BRIDGE (200' OR GREATER SPAN)	[Symbol]	STATE CAPITAL	[Symbol]
MAJOR BRIDGE (20' TO 200' SPAN)	[Symbol]	COUNTY SEAT	[Symbol]
MINOR BRIDGE (5' TO 20' SPAN)	[Symbol]	CITY CENTER	[Symbol]
DAM	[Symbol]	UNINCORPORATED COMMUNITY	[Symbol]
LOCK AND DAM	[Symbol]		
PUBLIC SERVICE FEATURES		MILITARY	
MNDOT OFFICE	[Symbol]	VOYAGEURS NATIONAL PARK	[Symbol]
MNDOT TRUCK STATION	[Symbol]	BOUNDARY WATERS CANOE AREA WILDERNESS	[Symbol]
HIGHWAY PATROL DISTRICT OFFICE	[Symbol]	STATE PARK	[Symbol]
STATE TRAVEL INFORMATION CENTER	[Symbol]	REGIONAL PARK	[Symbol]
REST AREA (FULL SERVICE)	[Symbol]	NATIONAL FOREST	[Symbol]
REST AREA (VAULT TOILET)	[Symbol]	NATIONAL AND STATE FOREST	[Symbol]
WAYSIDE (VAULT OR PIT TOILET)	[Symbol]	STATE FOREST	[Symbol]
PARK AND RIDE LOT	[Symbol]	WILDLIFE REFUGUE AREA	[Symbol]
PORT OF ENTRY	[Symbol]	WILDLIFE MANAGEMENT AREA	[Symbol]
PUBLIC ACCESS POINT	[Symbol]	HYDROLOGIC FEATURES	
MN STATE COLLEGE AND UNIVERSITY SYSTEM (MNSCU)	[Symbol]	RIVER OR STREAM (PERENNIAL)	[Symbol]
UNIVERSITY OF MN SYSTEM	[Symbol]	LAKE, POND OR RESERVOIR	[Symbol]
FAIRGROUNDS	[Symbol]	STREAM (INTERMITTENT)	[Symbol]
		DRAINAGE DITCH	[Symbol]
		HISTORIC DISTRICT	[Symbol]
		HISTORIC SITE	[Symbol]
		WETLAND	[Symbol]
		ISLAND OR LAND	[Symbol]
		REGIONAL WATERSHED	[Symbol]

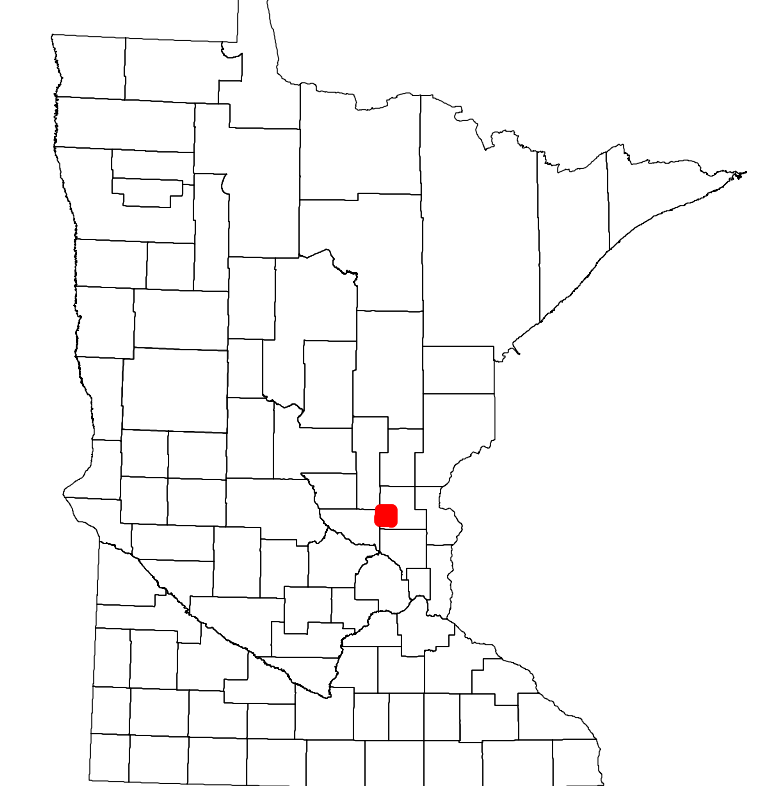

Population (U.S. Census 2010): 1589

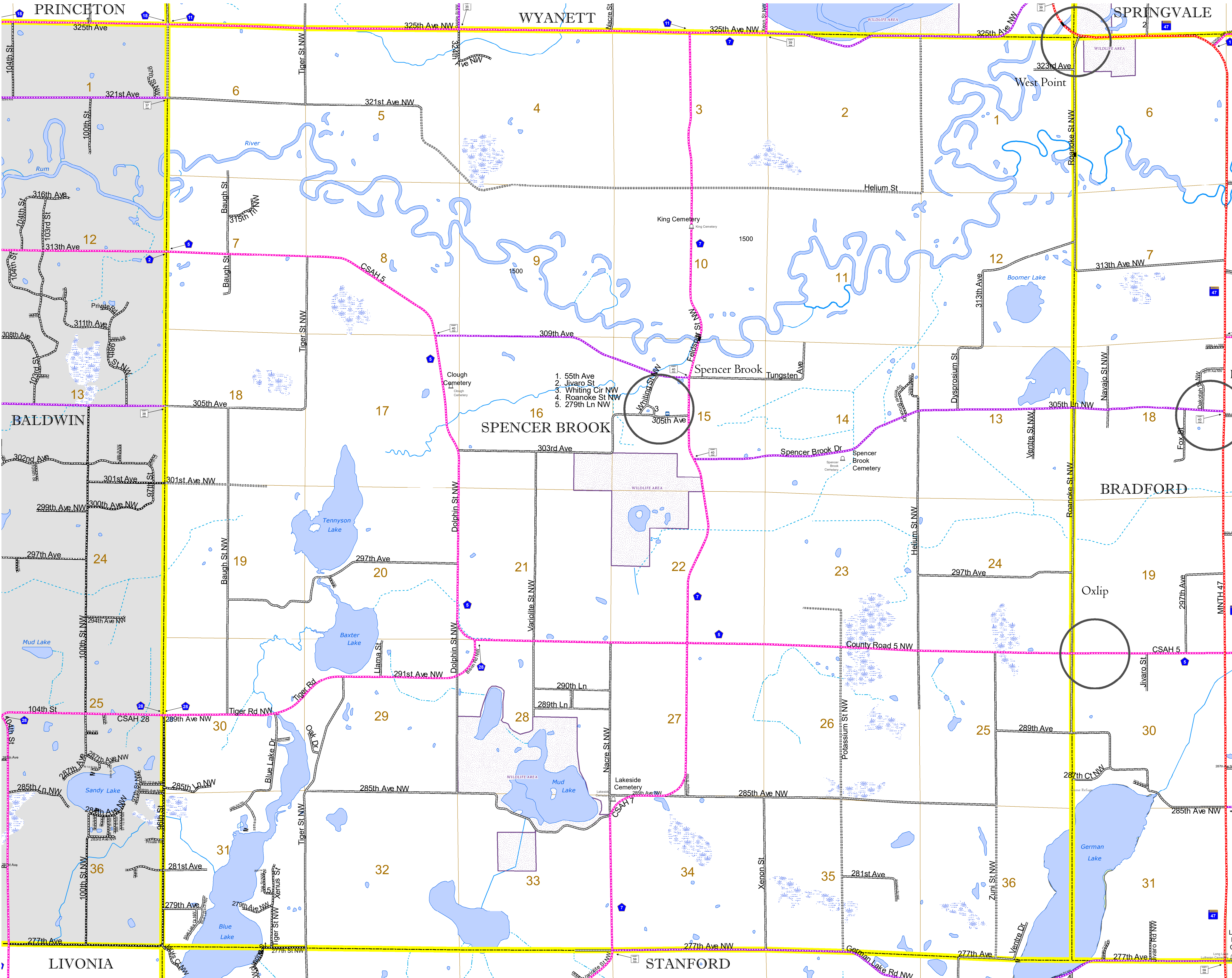

To request information from this document in an alternative format, call 651-366-4718 or 1-800-657-3774 (Greater Minnesota); 711 or 1-800-627-3529 (Minnesota Relay). You may also send an e-mail to ADRequest.dot@state.mn.us. (Please request at least one week in advance.)