

# TOWNSHIP OF WATERFORD

PREPARED BY THE  
MINNESOTA DEPARTMENT OF TRANSPORTATION  
OFFICE OF TRANSPORTATION SYSTEM MANAGEMENT

IN COOPERATION WITH  
U.S. DEPARTMENT OF TRANSPORTATION  
FEDERAL HIGHWAY ADMINISTRATION

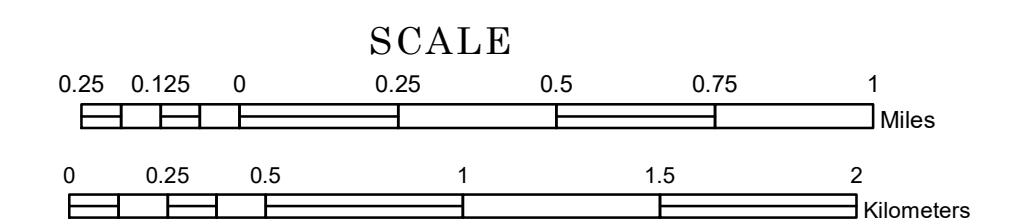

2024

Projection:  
Transverse Mercator  
NAD 1986  
UTM Zone 15

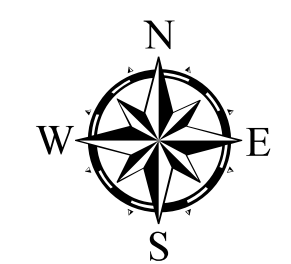

North American Datum  
of 1986

ROAD AND ROADWAY FEATURES		RAILROAD AND RAILWAY FEATURES		AVIATION FEATURES	
INTERSTATE	CONCRETE	INTERSTATE	COMMERCIAL AIRPORT	GENERAL AIRPORT	
US HIGHWAY	BITUMINOUS	EMPIRE BUILDER STATION (AMTRAK)	GENERAL AIRPORT	AIRSTRIP	
MN HIGHWAY	GRAVEL	NORTHSTAR STATION (COMMUTER)	SEAPLANE	AIRPORT RUNWAY	
COUNTY STATE AID HIGHWAY	DIRT/UNIMPROVED	BLUE LINE	AIRPORT RUNWAY		
COUNTY ROAD	OTHER	GREEN LINE			
TOWNSHIP ROAD	UNKNOWN				
UNORGANIZED TERRITORY ROAD					
OTHER ROADS					
MUNICIPAL	RAMP OR CONNECTOR				
PRIVATE	INTERSTATE EXIT				
NATIONAL MONUMENT	GREAT RIVER ROAD				
NATIONAL WILDLIFE					
STATE GAME					
STATE PARK					
PRESERVE					
INFRASTRUCTURE FEATURES		BOUNDARY FEATURES			
LONG BRIDGE (200' OR GREATER SPAN)	TRIAL LAND	TRIBAL LAND	STATE OF MINNESOTA		
MAJOR BRIDGE (20' TO 200' SPAN)	COUNTY	COUNTY	MUNICIPALITY		
MINOR BRIDGE (5' TO 20' SPAN)	MUNICIPALITY	MUNICIPALITY	UNINCORPORATED COMMUNITY		
DAM	UNINCORPORATED COMMUNITY	UNINCORPORATED COMMUNITY			
LOCK AND DAM					
CITY CENTERS					
STATE CAPITAL	SECTION				
COUNTY SEAT	MILITARY				
CITY CENTER	VOYAGEURS NATIONAL PARK				
UNINCORPORATED COMMUNITY	BOUNDARY WATERS CANOE AREA WILDERNESS				
PUBLIC SERVICE FEATURES					
MNDOT OFFICE	STATE PARK				
MNDOT TRUCK STATION	REGIONAL PARK				
HIGHWAY PATROL DISTRICT OFFICE	NATIONAL FOREST				
STATE TRAVEL INFORMATION CENTER	NATIONAL AND STATE FOREST				
REST AREA (FULL SERVICE)	STATE FOREST				
REST AREA (VAULT TOILET)	NATIONAL TRAIL				
WAYSIDE (VAULT OR P/T TOILET)	WILDLIFE REFUGUE AREA				
PARK AND RIDE LOT	WILDLIFE MANAGEMENT AREA				
PORT OF ENTRY	HYDROLOGIC FEATURES				
PUBLIC ACCESS POINT	RIVER OR STREAM (PERENNIAL)				
MN STATE COLLEGE AND UNIVERSITY SYSTEM (MNSCU)	LAKE, POND OR RESERVOIR				
UNIVERSITY OF MN SYSTEM	STREAM (INTERMITTENT)				
FARMS	DRAINAGE DITCH				
	WETLAND				
	ISLAND OR LAND				
	REGIONAL WATERSHED				



Population (U.S. Census 2010): 497

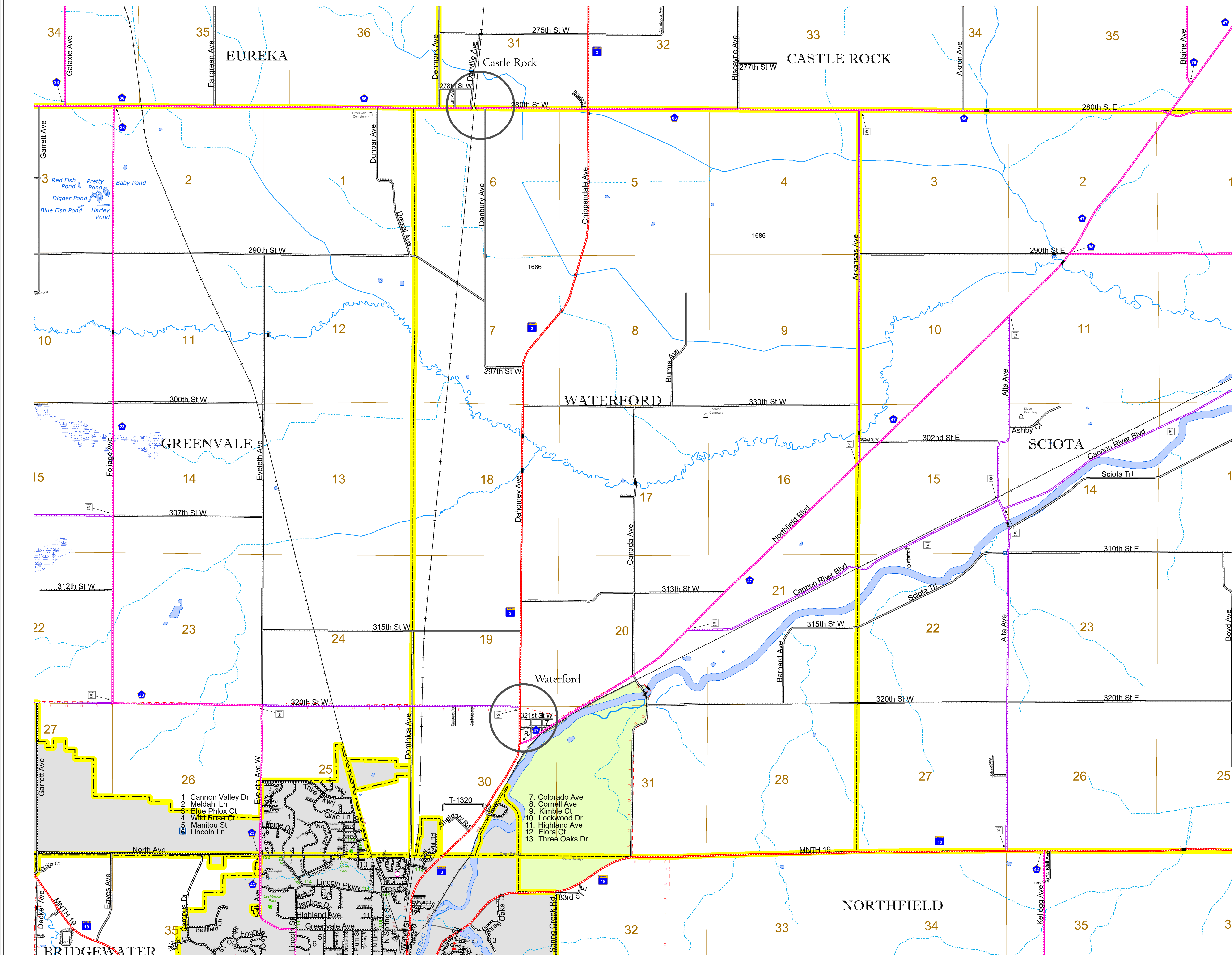

To request information from this document in an alternative format, call 651-366-4718 or 1-800-657-3774 (Greater Minnesota); 711 or 1-800-627-3529 (Minnesota Relay). You may also send an e-mail to ADArequest.dot@state.mn.us. (Please request at least one week in advance.)