

STREET SERIES MINNEAPOLIS- SAINT PAUL

PREPARED BY THE
MINNESOTA DEPARTMENT OF TRANSPORTATION
OFFICE OF TRANSPORTATION SYSTEM MANAGEMENT

IN COOPERATION WITH
U.S. DEPARTMENT OF TRANSPORTATION
FEDERAL HIGHWAY ADMINISTRATION

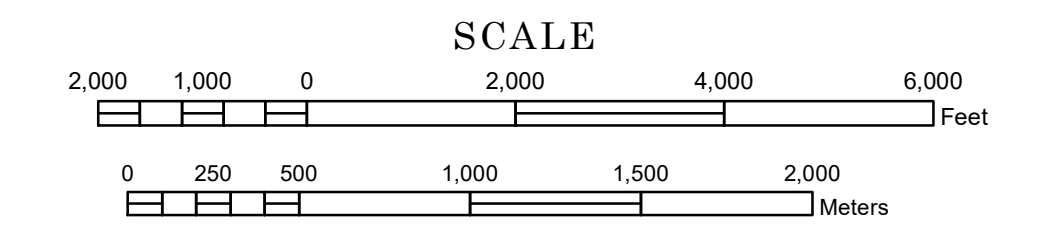

1 in = 1,840 ft

2024

Projection:
Transverse Mercator
NAD 1986
UTM Zone 15

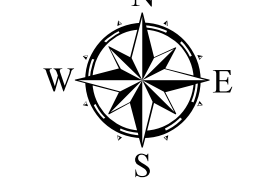

North American Datum
of 1986

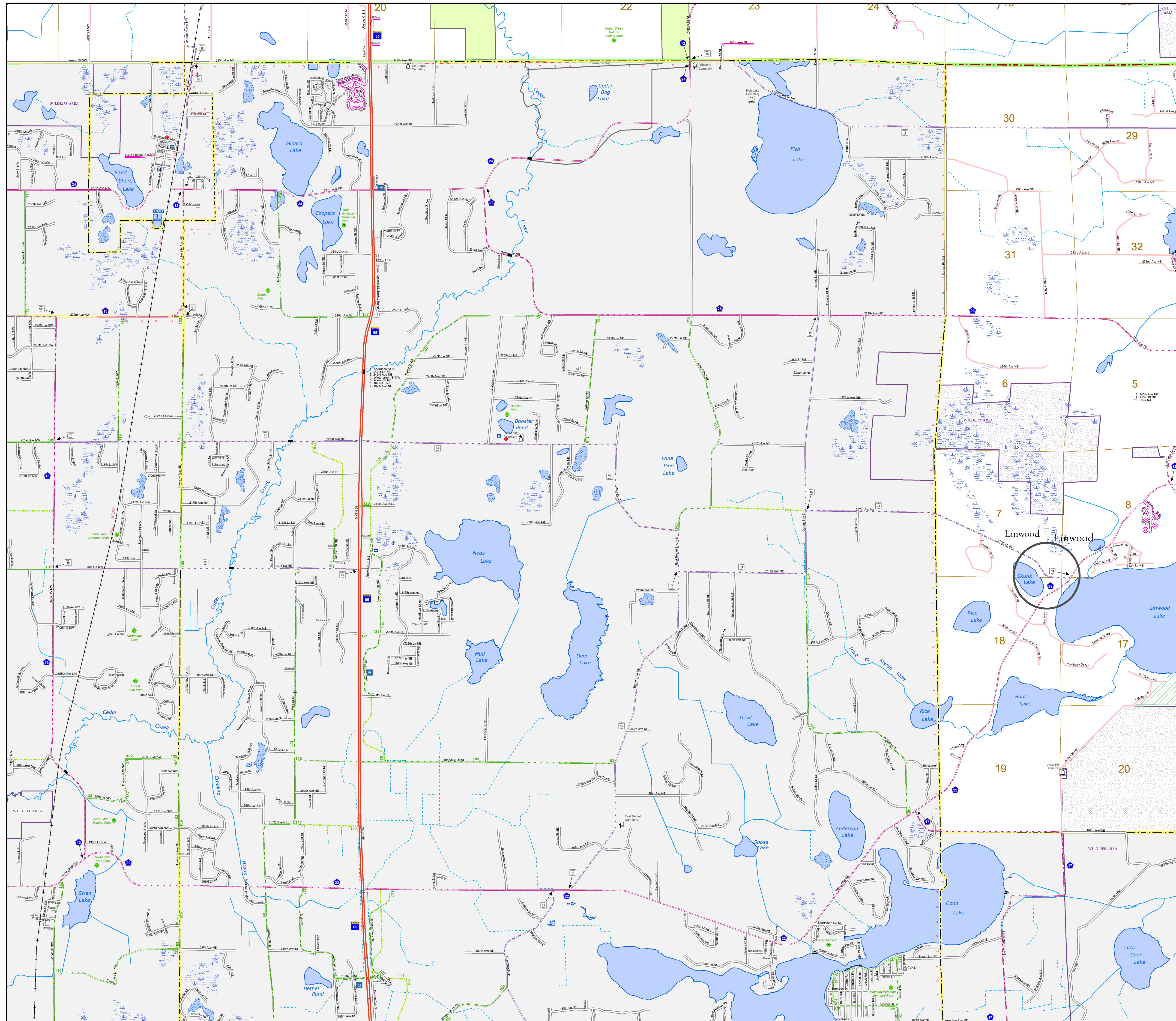

ROAD AND ROADWAY FEATURES	PUBLIC SERVICE FEATURES
INTERSTATE	MINDOT OFFICE
US HIGHWAY	MINDOT TRUCK STATION
MN HIGHWAY	HIGHWAY PATROL DISTRICT OFFICE
COUNTY STATE AID HIGHWAY	STATE TRAVEL INFORMATION CENTER
COUNTY ROAD	REST AREA (Full Service)
MUNICIPAL STATE AID STREET	REST AREA (Vault Toilet)
MUNICIPAL STREET	WAYSIDE (Vault or Pit Toilet)
PRIVATE STREET/ROAD	LOCAL PARK
TOWNSHIP ROAD	PUBLIC ACCESS POINT
UNORGANIZED TERRITORY ROAD	FAIRGROUNDS
RAMP OR CONNECTOR	PORT OF ENTRY
INTERSTATE EXIT	PARK AND RIDE LOT
GREAT RIVER ROAD	MN STATE COLLEGE AND UNIVERSITY SYSTEM (MNSCU)
OTHER ROADS	UNIVERSITY OF MN SYSTEM
Farmhouse	CULTURAL FEATURES
Shore Park	STATE HISTORICAL MARKER
Home Service	HISTORIC DISTRICT
Munjoy	HISTORIC SITE
	MONUMENT
AVIATION FEATURES	BOUNDARY FEATURES
COMMERCIAL AIRPORT	TRIBAL LAND
GENERAL AIRPORT	COUNTY
AIRSTRIP	MUNICIPALITY
SEAPLANE	ADJACENT MUNICIPALITY
AIRPORT RUNWAY	FEDERAL ADJUSTED URBAN AREA (2014)
RAILROAD AND RAILWAY FEATURES	MILITARY
RAILWAY	VOYAGEURS NATIONAL PARK
EMPIRE BUILDER STATION (Attnx)	BOUNDARY WATERS CANOE AREA WILDERNESS
NORTHSTAR STATION (Commuter)	STATE PARK
LIGHT RAIL	REGIONAL PARK
BLUE LINE	NATIONAL FOREST
GREEN LINE	NATIONAL AND STATE FOREST
INFRASTRUCTURE FEATURES	STATE FOREST
LONG BRIDGE (300' or Greater Span)	NATIONAL TRAIL
MAJOR BRIDGE (20' to 300' Span)	WILDLIFE REFUGUE AREA
MINOR BRIDGE (5' to 20' Span)	WILDLIFE MANAGEMENT AREA
DAM	RIVER OR STREAM (Perennial)
LOCK AND DAM	LAKE, POND OR RESERVOIR
PUBLIC FACILITIES	STREAM (Intermittent)
STATE CAPITOL	DRAINAGE DITCH
FEDERAL COURTHOUSE	HYDROLOGIC FEATURES
COUNTY COURTHOUSE	WETLAND
ANCHORY	ISLAND OR LAND
CITY CENTERS	REGIONAL WATERSHED
TRIBAL GOVERNMENT CENTER	
CITY CENTER	
LOCALLY KNOWN PLACE	
UNINCORPORATED COMMUNITY	

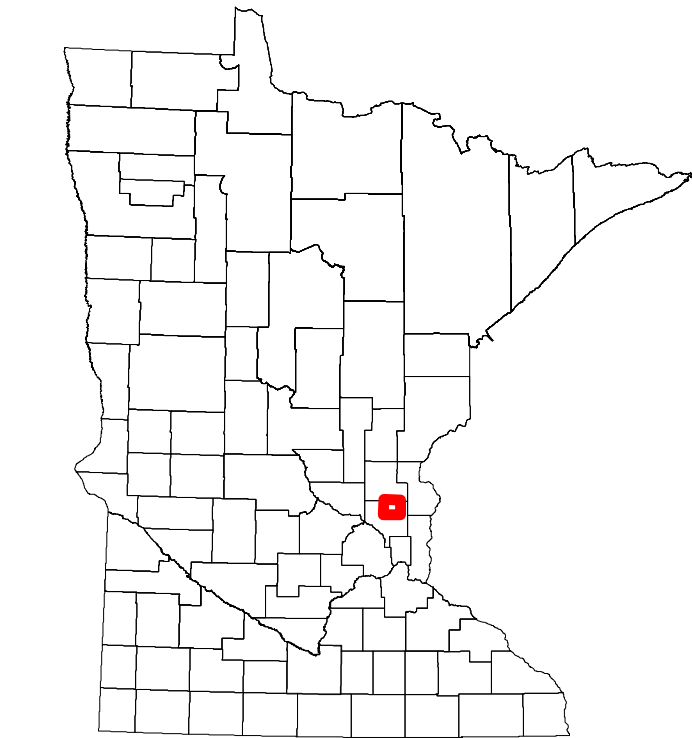

To request information from this document in an alternative format, call 651-366-4718 or 1-800-657-3774 (Greater Minnesota); 711 or 1-800-627-3529 (Minnesota Relay). You may also send an e-mail to ADRequest.dot@state.mn.us. (Please request at least one week in advance.)