

MUNICIPALITY OF
BELGRADE

PREPARED BY THE
MINNESOTA DEPARTMENT OF TRANSPORTATION
OFFICE OF TRANSPORTATION SYSTEM MANAGEMENT

IN COOPERATION WITH
U.S. DEPARTMENT OF TRANSPORTATION
FEDERAL HIGHWAY ADMINISTRATION

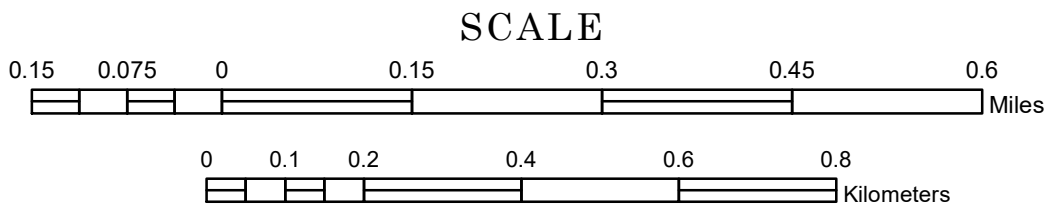

1 in = 800 ft
2024

Projection:
Transverse Mercator
NAD 1986
UTM Zone 15



North American Datum
of 1986

ROAD AND ROADWAY FEATURES		PUBLIC SERVICE FEATURES	
INTERSTATE		MINOT OFFICE	
US HIGHWAY		MINOT TRUCK STATION	
MIN HIGHWAY		HIGHWAY PATROL DISTRICT OFFICE	
COUNTY STATE AID HIGHWAY		STATE TRAVEL INFORMATION CENTER	
COUNTY ROAD		REST AREA (Full Service)	
MUNICIPAL STREET		REST AREA (Vault Toilet)	
MUNICIPAL STATE AID STREET		WAYSIDE (Vault or Pn Toilet)	
PRIVATE STREET/ROAD		PUBLIC ACCESS POINT	
TOWNSHIP ROAD		LOCAL PARK	
UNORGANIZED TERRITORY ROAD		FAIRGROUNDS	
RAMP OR CONNECTOR		PORT OF ENTRY	
INTERSTATE EXIT		PARK AND RIDE LOT	
GREAT RIVER ROAD		PUBLIC UNIVERSITY/COLLEGE	
OTHER ROADS		PRIVATE UNIVERSITY/COLLEGE	
RAILROAD		ELEMENTARY SCHOOL	
RAILROAD BRIDGE (100' or Greater Span)		MIDDLE SCHOOL	
RAILROAD BRIDGE (20' to 99' Span)		HIGH SCHOOL	
RAILROAD BRIDGE (100' or Greater Span)		AVIATION FEATURES	
RAILROAD BRIDGE (Under 100' Span)		COMMERCIAL AIRPORT	
SKYWAY		GENERAL AIRPORT	
PEDESTRIAN BRIDGE		AIRSTRIP	
PEDESTRIAN TUNNEL		SEAPLANE	
DAM		AIRPORT RUNWAY	
LOCK AND DAM		CULTURAL FEATURES	
LOCK AND DAM		STATE HISTORICAL MARKER	
STATE CAPITOL		HISTORIC DISTRICT	
FEDERAL COURTHOUSE		HISTORIC SITE	
COUNTY COURTHOUSE		MONUMENT	
ARMORY		CEMETERY	
CITY HALL		BOUNDARY FEATURES	
TOWN HALL		TRIBAL LAND	
COMMUNITY CENTER		COUNTY	
ARENA		MUNICIPALITY	
STADIUM		ADJACENT MUNICIPALITY	
POST OFFICE		FEDERAL ADJUSTED URBAN AREA (2014)	
POLICE STATION		MILITARY	
FIRE STATION		STATE PARK	
PUBLIC LIBRARY		REGIONAL PARK	
PUBLIC MUSEUM		NATIONAL FOREST	
EVENT CENTER		NATIONAL AND STATE FOREST	
CITY CENTERS		STATE FOREST	
TRIBAL GOVERNMENT CENTER		NATIONAL TRAIL	
CITY CENTER		WILDLIFE REFUGE AREA	
LOCALLY KNOWN PLACE		WILDLIFE MANAGEMENT AREA	
UNINCORPORATED COMMUNITY		HYDROLOGIC FEATURES	
		RIVER OR STREAM (PERMANENT)	
		LAKE, POND OR RESERVOIR	
		STREAM (Intermittent)	
		DRAINAGE DITCH	
		WETLAND	
		ISLAND OR LAND	
		REGIONAL WATERSHED	

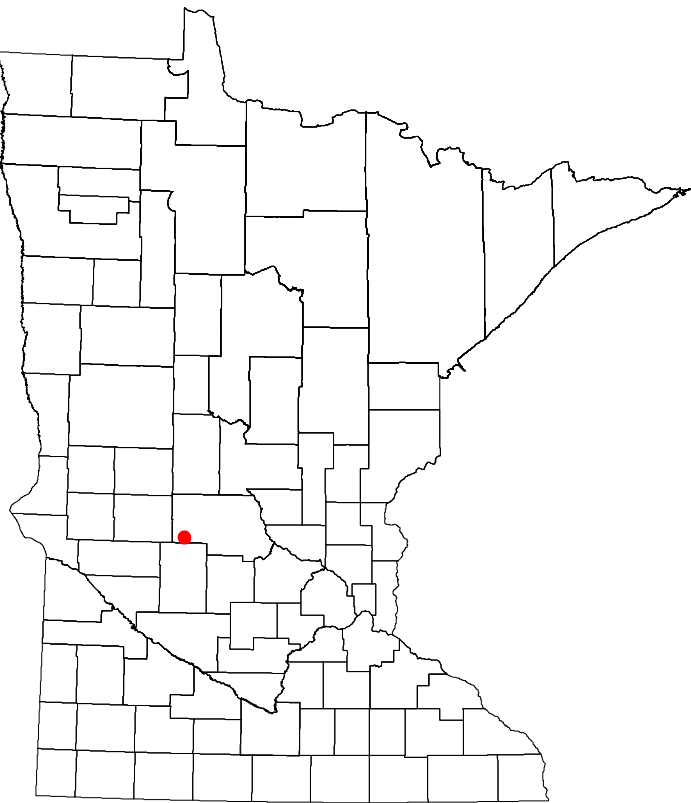

Population (U.S. Census 2020): 738

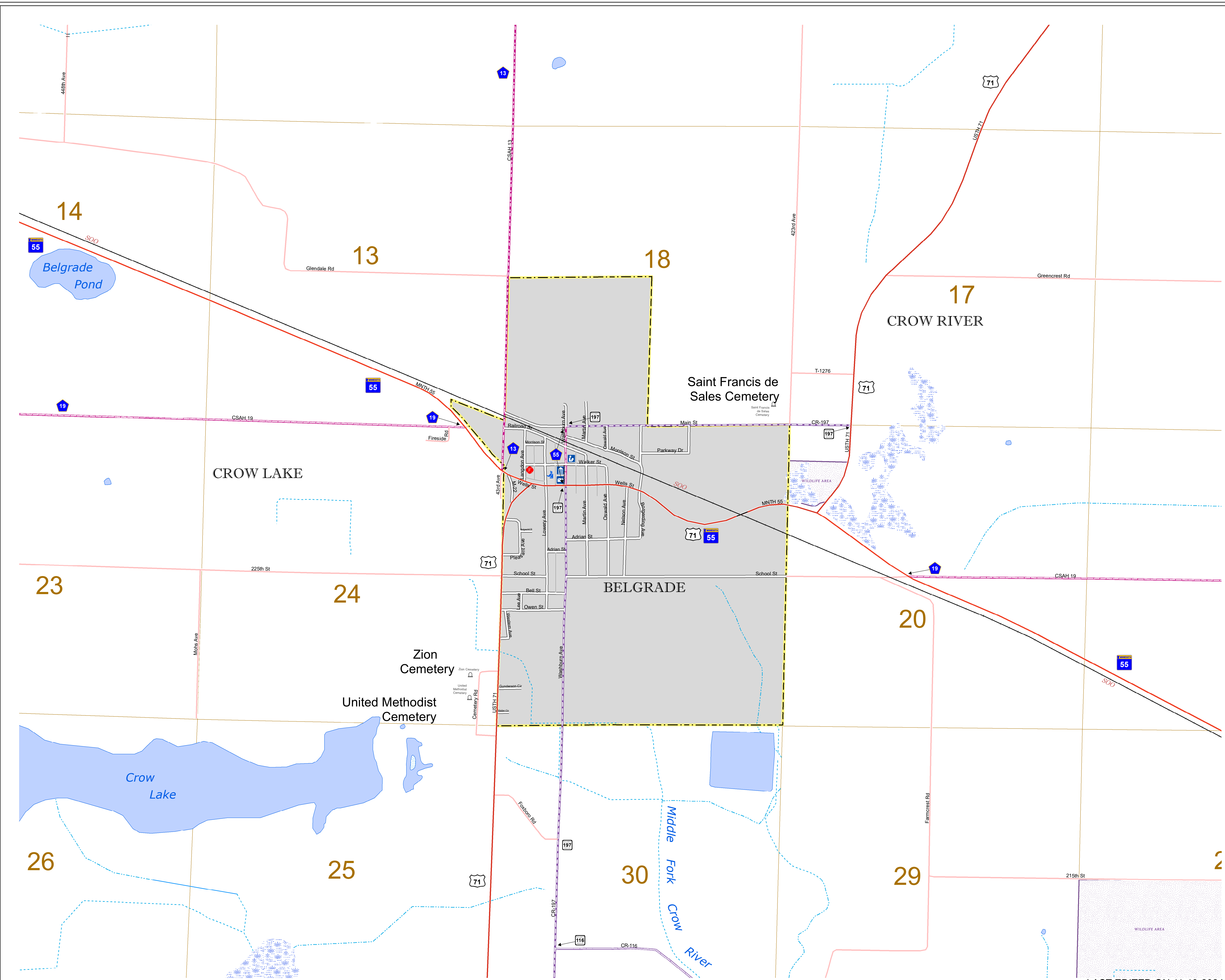

To request information from this document in an alternative format, call 651-366-4718 or 1-800-657-3774 (Greater Minnesota); 711 or 1-800-627-3529 (Minnesota Relay). You may also send an e-mail to ADArequest.dot@state.mn.us. (Please request at least one week in advance.)

LAST EDITED ON 11-19-2024