

I-35 JCT WITH I-535 AND USTH 53

ST. LOUIS CO. 69
 DULUTH 1040
 PS 2730

100's
I-35 200's USE (RP) = 255+00.236 (RP) = 255+00.318
 A&B's

USTH 53 C&D's USE (RP) = 001+00.541

I-535 C's USE (RP) = 001+00.571

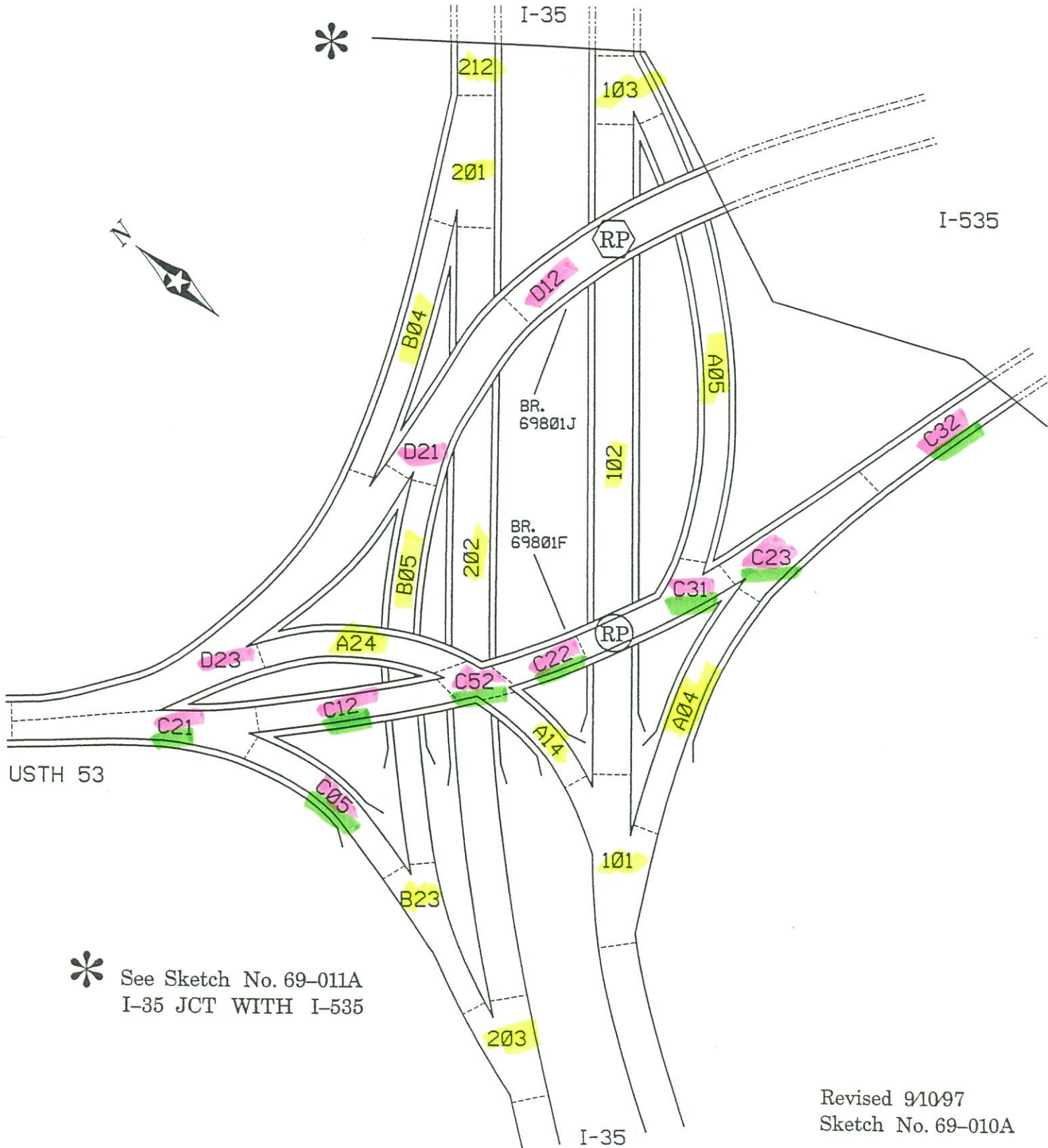

* See Sketch No. 69-011A
 I-35 JCT WITH I-535

Revised 9/10/97
 Sketch No. 69-010A

(5 YEAR CRASH HISTORY)

LIST ACCIDENT BY REFERENCE POINT

01/01/2011 THROUGH 12/31/2015

REPORT DATE: MAR 28,2016

INPUT CONTROLS - COMMAND NUMBER 1

OPTLIST

NO-CODELIST

(DEFAULT) MILES

VEHIC-DATA

(DEFAULT) NO-RLG-DATA

(DEFAULT) NO-FORMATB

NEWS=NO

START-DATE=01/01/2011

END-DATE=12/31/2015

+ROUTES: ROUTE-SYS-&-NUM=0100000035,START-REF=255.236,END-REF=255.318

+SELECT: INCLUDE ACCIDENTS IF:

ACD.INTCHANGE-ELEM *EQ* '201' *OR*

ACD.INTCHANGE-ELEM *EQ* '202' *OR*

ACD.INTCHANGE-ELEM *EQ* '203' *OR*

ACD.INTCHANGE-ELEM *EQ* '212' *OR*

ACD.INTCHANGE-ELEM *EQ* '101' *OR*

ACD.INTCHANGE-ELEM *EQ* '102' *OR*

ACD.INTCHANGE-ELEM *EQ* '103' *OR*

ACD.INTCHANGE-ELEM *EQ* 'A04' *OR*

ACD.INTCHANGE-ELEM *EQ* 'A14' *OR*

ACD.INTCHANGE-ELEM *EQ* 'A24' *OR*

ACD.INTCHANGE-ELEM *EQ* 'A05' *OR*

ACD.INTCHANGE-ELEM *EQ* 'B23' *OR*

ACD.INTCHANGE-ELEM *EQ* 'B04' *OR*

ACD.INTCHANGE-ELEM *EQ* 'B05'

+TITLES:

(5 YEAR CRASH HISTORY)

(5 YEAR CRASH HISTORY)

LIST ACCIDENT BY REFERENCE POINT

01/01/2011 THROUGH 12/31/2015

REPORT DATE: MAR 28, 2016

ISTH ROUTE SYSTEM - ROUTE 35 - BEGINNING AT 255+00.236 - ENDING AT 255+00.318

SELECT=YES

ROUTE NUMBER	REFERENCE POINT	E L M	R L Y	I N D E S T	D V I D E S T	C T Y	T W N P C I T Y	DATE	TIME	S E V	#	J V E H	L U M C	I M I P A	T Y P E	D I P A C H E R	L O C A L I D	L I T T L E	W H H U R E	W H H U R E	S C H U R E	C H A S E	D E T R I M E N T	V I S I B I L I T Y	D I R E C T I O N	A A G G R E S S I V E	F C C C C C	F C C C C	P C C C C	A S S E S S M E N T	EX G E N E R A L	ACCIDENT NUMBER	
ISTH 35	255+00.236	102	1	01	69	1040	1/26/2011	1348	N	2	01	55	01	01	01	98	01	02	00	01	02	01	02	01	02	N	11	01	00	01	67	M	110320145
ISTH 35	255+00.236	A24	1	01	69	1040	1/31/2011	0950	N	1	01	30	34	90	01	98	01	04	00	03	06	03	01	01	W	01	03	00	01	20	F	110390549	
ISTH 35	255+00.236	202	1	01	69	1040	1/31/2011	1209	N	1	01	55	34	07	02	98	01	04	00	03	02	01	03	SW	01	03	00	01	29	M	110390558		
ISTH 35	255+00.236	203	2	01	69	1040	4/28/2011	1318	N	2	01	45	01	01	01	90	01	02	00	01	02	01	01	S	01	04	15	01	25	U	111220199		
ISTH 35	255+00.236	103	1	01	69	1040	7/24/2011	1320	C	4	01	45	01	90	01	90	01	01	00	01	05	01	01	S	03	16	01	00	01	64	M	112170042	
ISTH 35	255+00.236	103	1	01	69	1040	9/21/2011	1126	N	2	20	45	01	02	01	98	01	02	00	02	02	01	02	N	11	01	00	01	25	M	112170042		
ISTH 35	255+00.236	203	1	01	69	1040	8/15/2011	1427	N	3	22	45	01	01	01	98	01	01	02	01	01	08	02	W	11	01	00	01	64	M	112680050		
ISTH 35	255+00.236	102	1	01	69	1040	11/30/2011	1630	B	1	22	55	34	05	04	98	01	04	00	03	02	01	01	NE	01	03	00	01	28	M	113060043		
ISTH 35	255+00.236	B23	1	01	69	1040	12/23/2011	0719	C	2	22	40	01	01	01	05	04	04	00	03	02	02	01	S	02	10	04	15	01	51	M	113520181	
ISTH 35	255+00.236	202	1	01	69	1040	1/30/2012	1739	N	2	21	55	01	02	01	98	04	01	00	01	02	01	01	S	02	11	01	00	01	30	M	113610277	
ISTH 35	255+00.236	B04	1	01	69	1040	1/27/2011	0956	N	2	03	45	01	01	01	05	01	02	00	01	06	02	01	S	02	11	01	00	01	48	M	120320273	
ISTH 35	255+00.236	101	1	01	69	1040	2/26/2012	1413	N	2	21	55	01	02	01	98	01	02	00	02	02	01	01	N	04	14	08	00	01	28	M	120400177	
ISTH 35	255+00.236	102	2	01	69	1040	3/22/2012	1640	N	1	01	55	32	90	01	98	01	03	00	02	02	01	03	N	03	01	15	00	01	57	M	120580319	
ISTH 35	255+00.236	203	1	01	69	1040	6/04/2012	1155	B	2	20	45	01	01	01	05	01	01	00	01	01	02	04	SW	01	16	15	00	01	61	F	120580319	
ISTH 35	255+00.236	B23	1	01	69	1040	9/10/2012	1429	N	3	20	40	01	01	01	05	01	01	00	01	02	02	04	S	03	10	01	00	01	28	F	120860242	
ISTH 35	255+00.236	212	1	01	69	1040	9/13/2012	1642	N	2	22	55	01	01	01	98	01	01	00	01	01	01	01	S	04	11	01	00	01	70	M	121570244	
ISTH 35	255+00.236	B23	1	01	69	1040	11/05/2012	0750	N	2	20	40	01	01	01	05	01	01	00	01	06	02	01	SW	03	11	01	00	01	58	F	122550231	
ISTH 35	255+00.236	103	2	01	69	1040	11/16/2012	1811	N	1	20	55	01	02	01	98	04	01	00	01	01	01	01	N	01	10	01	00	01	21	F	122580254	
ISTH 35	255+00.236	A04	2	01	69	1040	11/24/2012	2027	B	1	01	55	34	02	01	98	04	04	00	05	02	01	04	E	11	01	00	01	42	M	122580254		
ISTH 35	255+00.236	203	1	01	69	1040	12/10/2012	1459	C	2	22	55	01	01	01	05	01	01	00	02	02	02	03	S	01	16	15	00	01	22	M	123100216	
ISTH 35	255+00.236	202	2	01	69	1040	11/24/2012	0212	N	1	01	55	34	08	01	98	04	04	00	05	01	01	01	S	01	16	01	00	01	29	F	123240215	
ISTH 35	255+00.236	201	2	01	69	1040	2/25/2013	1736	N	1	21	55	32	04	03	98	01	01	00	01	02	01	01	S	01	10	01	00	01	38	M	123240215	
ISTH 35	255+00.236	A24	1	03	69	1040	3/23/2013	2136	B	1	21	30	34	07	01	01	04	01	00	01	06	02	04	N	01	18	00	02	59	M	123470500		
ISTH 35	255+00.236	202	1	01	69	1040	5/08/2013	0745	C	2	01	55	01	01	01	98	01	01	00	01	02	01	03	SW	01	10	01	00	01	28	F	123470509	
ISTH 35	255+00.236	202	2	01	69	1040	11/24/2012	0212	N	1	01	55	34	08	01	98	04	04	00	05	01	01	01	S	01	10	01	00	99	901	Z	130040297	
ISTH 35	255+00.236	201	2	01	69	1040	2/25/2013	1736	N	1	21	55	32	04	03	98	01	01	00	01	02	01	01	S	13	90	00	01	60	M	130570270		
ISTH 35	255+00.236	A24	1	03	69	1040	3/23/2013	2136	B	1	21	30	34	07	01	01	04	01	00	01	06	02	04	N	01	18	00	02	38	M	130830088		
ISTH 35	255+00.236	202	1	01	69	1040	5/08/2013	0745	C	2	01	55	01	01	01	98	01	01	00	01	02	01	03	SW	13	03	08	01	72	M	131330212		

(5 YEAR CRASH HISTORY)

LIST ACCIDENT BY REFERENCE POINT

01/01/2011 THROUGH 12/31/2015

REPORT DATE: MAR 28,2016

ISTH ROUTE SYSTEM - ROUTE 35 - BEGINNING AT 255+00.236 - ENDING AT 255+00.318

SELECT=YES

ROUTE NUMBER	REFERENCE POINT	ELEVATION	ROAD TYPE	CITY	DATE	TIME	SEVERITY	#	J	I	T	D	O	L	W	W	S	C	D	V	D	A	F	F	P	ACCIDENT TYPE	ACCIDENT NUMBER	
ISTH 35	255+00.236	A24	1 01	69 1040	9/08/2015	1609	B	1	20	55	32	07	04	98	01	01	00	09	05	02	11	N	01	05	15	01	19 M	
ISTH 35	255+00.236	202	2 01	69 1040	10/01/2015	1938	N	2	20	55	01	02	01	98	01	01	00	01	06	01	01	S	01	01	00	01	28 F	1522990285
ISTH 35	255+00.236	A14	2 01	69 1040	10/30/2015	0718	N	2	20	55	01	01	01	05	02	02	00	01	01	02	01	S	10	01	00	01	34 M	153060256
ISTH 35	255+00.236	B23	2 01	69 1040	11/10/2015	1628	N	2	20	55	01	01	01	05	01	01	00	01	06	02	02	S	16	15	00	01	34 F	153160284
ISTH 35	255+00.236	B23	2 01	69 1040	12/21/2015	1734	N	2	20	55	01	01	01	05	04	02	00	01	06	02	01	S	01	15	00	01	34 F	153560379
ISTH 35	255+00.268	102	1 01	69 1040	10/17/2012	1605	N	2	01	55	01	02	01	98	01	02	00	01	06	01	03	N	01	01	00	01	40 F	122960233
ISTH 35	255+00.318	A05	1 01	69 1040	1/17/2011	2206	N	1	01	55	32	04	01	98	04	02	00	03	02	02	01	N	01	03	61	01	17 F	110180531
ISTH 35	255+00.318	212	2 03	69 1040	4/18/2013	2341	N	1	01	55	32	98	01	98	04	04	08	04	01	01	03	S	01	61	00	01	36 F	131090445
ISTH 35	255+00.318	B05	2 01	69 1040	6/12/2013	0849	N	1	22	55	34	04	02	98	01	01	00	01	05	02	31	W	14	13	08	01	24 M	131890218
ISTH 35	255+00.318	201	1 01	69 1040	7/04/2013	2336	N	1	01	55	33	90	01	98	04	01	00	01	01	02	01	S	14	21	00	01	22 M	132170226
ISTH 35	255+00.318	101	2 01	69 1040	12/24/2013	1719	N	1	22	55	34	04	02	98	04	04	00	05	02	01	01	N	15	03	07	01	21 M	133600335
ISTH 35	255+00.318	103	2 01	69 1040	12/31/2013	2343	N	1	01	55	32	04	01	98	04	01	00	05	01	01	03	N	01	03	61	01	18 M	140020397
ISTH 35	255+00.318	103	1 01	69 1040	1/08/2014	0726	C	2	20	55	01	05	02	98	02	01	00	05	02	01	03	NE	16	46	00	01	27 M	140080488
ISTH 35	255+00.318	B23	1 01	69 1040	6/25/2014	1537	N	2	20	55	01	01	01	05	01	02	00	01	04	02	03	S	11	01	00	01	52 F	141770215
ISTH 35	255+00.318	B23	1 01	69 1040	7/11/2014	1154	N	2	22	55	01	01	01	05	01	02	00	01	02	02	01	S	11	01	00	01	33 F	142020206
ISTH 35	255+00.318	B04	2 01	69 1040	5/06/2015	1804	N	2	22	55	01	01	01	05	01	02	00	01	06	02	04	S	11	01	00	01	30 M	151280247
ISTH 35	255+00.318	B04	2 01	69 1040	12/30/2015	1639	N	2	22	55	01	01	01	05	01	02	00	01	02	02	03	S	10	01	00	01	34 F	153650299
																					04	S	10	04	00	01	21 F	

SEVERITY SUMMARY FOR +ROUTES: ROUTE-SYS-&-NUM=0100000035,START-REF=255.236,END-REF=255.318

FATAL ACCIDENTS	INCAPACITATING INJURY ACCIDENTS	NON-INCAPACITATING INJURY ACCIDENTS	POSSIBLE INJURY ACCIDENTS	SUBTOTAL INJURY ACCIDENTS	PROPERTY DAMAGE ACCIDENTS	TOTAL ACCIDENTS
0	0	6	10	16	72	88

TRANSPORTATION INFORMATION SYSTEM - MAR 28,2016

```
:LIST-ACCIDENTS-BY-REF-POINT,START-DATE=01/01/2011,NEWS=NO,  
: END-DATE=12/31/2015,VEHIC-DATA,OPTLIST,NO-CODELIST  
+ROUTES  
ROUTE-SYS-&-NUM=0200000053,START-REF=001.541,END-REF=001.541  
+SELECT  
INCLUDE ACCIDENTS IF:  
ACD.INTCHANGE-ELEM *EQ* 'C05' *OR*  
ACD.INTCHANGE-ELEM *EQ* 'C12' *OR*  
ACD.INTCHANGE-ELEM *EQ* 'C21' *OR*  
ACD.INTCHANGE-ELEM *EQ* 'C22' *OR*  
ACD.INTCHANGE-ELEM *EQ* 'C23' *OR*  
ACD.INTCHANGE-ELEM *EQ* 'C31' *OR*  
ACD.INTCHANGE-ELEM *EQ* 'C32' *OR*  
ACD.INTCHANGE-ELEM *EQ* 'C52' *OR*  
ACD.INTCHANGE-ELEM *EQ* 'D12' *OR*  
ACD.INTCHANGE-ELEM *EQ* 'D21' *OR*  
ACD.INTCHANGE-ELEM *EQ* 'D23'  
+TITLES
```

(5 YEAR CRASH HISTORY)

(5 YEAR CRASH HISTORY)

LIST ACCIDENT BY REFERENCE POINT

01/01/2011 THROUGH 12/31/2015

REPORT DATE: MAR 28,2016

USTH ROUTE SYSTEM - ROUTE 53 - BEGINNING AT 001+00.541 - ENDING AT 001+00.541

SELECT=YES

ROUTE NUMBER	REFERENCE POINT	E L E S T M	R Y S T Y	I N D C T Y	DATE	TIME	#	J	L	L	L	W	W	S	C	D	V	D	A	F	F	P	A S	ACCIDENT
																								NUMBER

SEVERITY SUMMARY FOR +ROUTES: ROUTE-SYS-&-NUM=0200000053,START-REF=001.541,END-REF=001.541

FATAL ACCIDENTS	INCAPACITATING INJURY ACCIDENTS	NON-INCAPACITATING INJURY ACCIDENTS	POSSIBLE INJURY ACCIDENTS	SUBTOTAL INJURY ACCIDENTS	PROPERTY DAMAGE ACCIDENTS	TOTAL ACCIDENTS
0	0	2	7	9	38	47

:LIST-ACCIDENTS-BY-REF-POINT,START-DATE=01/01/2011,NEWS=NO,
: END-DATE=12/31/2015,VEHIC-DATA,OPTLIST,NO-CODELIST
+ROUTES

ROUTE-SYS-&-NUM=0100000535,START-REF=001.571,END-REF=001.571

+SELECT

INCLUDE ACCIDENTS IF:

- ACD.INTCHANGE-ELEM *EQ* 'C05' *OR*
- ACD.INTCHANGE-ELEM *EQ* 'C12' *OR*
- ACD.INTCHANGE-ELEM *EQ* 'C21' *OR*
- ACD.INTCHANGE-ELEM *EQ* 'C22' *OR*
- ACD.INTCHANGE-ELEM *EQ* 'C23' *OR*
- ACD.INTCHANGE-ELEM *EQ* 'C31' *OR*
- ACD.INTCHANGE-ELEM *EQ* 'C32' *OR*
- ACD.INTCHANGE-ELEM *EQ* 'C52'

+TITLES

(5 YEAR CRASH HISTORY)

(5 YEAR CRASH HISTORY)

LIST ACCIDENT BY REFERENCE POINT 01/01/2011 THROUGH 12/31/2015 REPORT DATE: MAR 28,2016
 Isth ROUTE SYSTEM - ROUTE 535 - BEGINNING AT 001+00.571 - ENDING AT 001+00.571
 SELECT=YES

ROUTE NUMBER	REFERENCE POINT	ELEVATION	ROAD	SECTION	TOWNSHIP	CITY	DATE	TIME	SEVERITY	#	J	I	T	D	O	L	W	W	S	C	D	V	D	A	F	F	P	ACCIDENT NUMBER			
ISTH 535	001+00.571	C32	1	01	69	1040	7/27/2011	1315	N	2	01	55	01	01	01	90	01	01	00	01	02	01	02	S	14	03	08	01	76 M	112170040	
ISTH 535	001+00.571	C23	1	01	69	1040	11/21/2011	1459	C	1	20	55	32	04	01	98	01	02	00	05	06	02	01	E	10	03	00	01	24 F	113340194	
ISTH 535	001+00.571	C05	1	01	69	1040	12/31/2011	1058	N	2	20	55	01	01	01	05	01	02	00	02	02	02	02	SW	01	15	00	01	59 F	120050230	
ISTH 535	001+00.571	C52	2	03	69	1040	9/15/2012	1526	N	1	04	30	34	07	01	01	01	01	00	01	06	04	01	E	01	15	00	01	23 F	122590106	
ISTH 535	001+00.571	C05	1	01	69	1040	9/16/2012	1554	N	2	20	40	01	01	01	05	01	01	00	01	02	02	03	S	11	01	00	01	31 M	122610198	
ISTH 535	001+00.571	C52	1	01	69	1040	10/29/2012	0540	N	1	04	55	22	90	04	01	02	02	00	01	05	02	35	N	01	90	00	01	55 M	130230296	
ISTH 535	001+00.571	C23	1	01	69	1040	1/31/2014	1031	N	2	20	55	01	01	01	05	01	01	00	01	06	02	03	S	11	01	00	01	60 M	140340416	
ISTH 535	001+00.571	C05	1	01	69	1040	12/03/2014	0727	N	2	20	55	01	01	01	05	01	04	00	02	02	02	01	S	10	04	00	01	63 M	143380271	
ISTH 535	001+00.571	C32	3	01	69	1040	1/26/2015	0751	N	2	01	55	01	01	01	98	01	04	00	03	01	01	35	N	01	01	00	01	52 M	150340344	
ISTH 535	001+00.571	C22	1	01	69	1040	2/19/2015	1712	N	1	22	55	34	04	08	98	01	01	00	01	06	02	01	N	01	32	00	01	72 M	151050167	
ISTH 535	001+00.571	C05	1	01	69	1040	12/31/2015	1517	N	2	21	40	01	01	01	05	01	02	00	01	02	02	03	S	10	01	00	01	57 M	160040095	
																														19 F	

SEVERITY SUMMARY FOR +ROUTES: ROUTE-SYS-&-NUM=010000535, START-REF=001.571, END-REF=001.571

FATAL ACCIDENTS	INCAPACITATING INJURY ACCIDENTS	NON-INCAPACITATING INJURY ACCIDENTS	POSSIBLE INJURY ACCIDENTS	SUBTOTAL INJURY ACCIDENTS	PROPERTY DAMAGE ACCIDENTS	TOTAL ACCIDENTS
0	0	0	1	1	10	11

I-35 JCT WITH I-535

ST. LOUIS CO. 69
DULUTH 1040
PS 2730

I-35 ALL ELEMENTS USE (RP) = 255+00.514

I-535 C&D's USE (RP) = 001+00.499



* See Sketch No. 69-010A
I-35 JCT WITH I-535
AND USTH 53

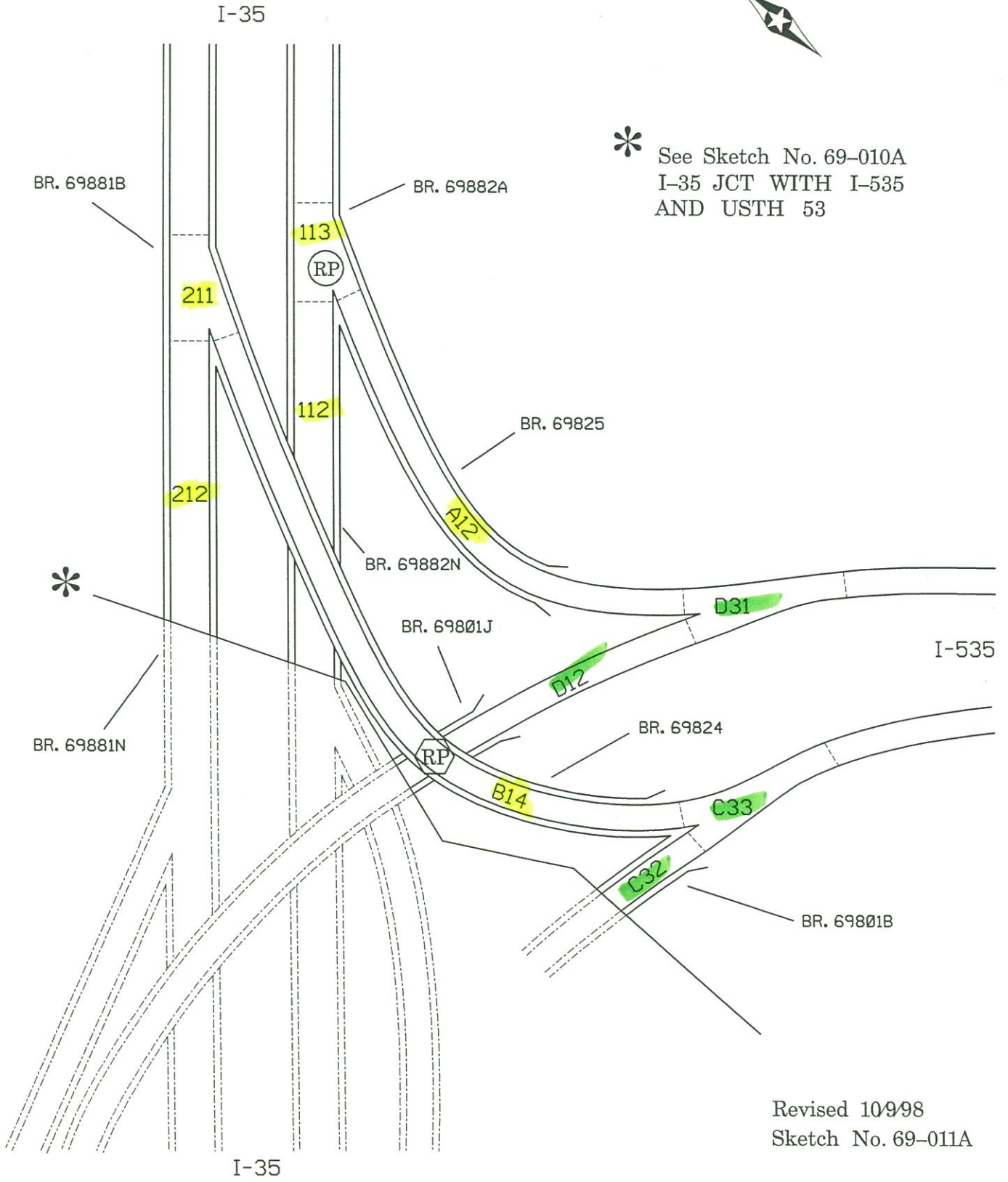

Revised 10/98
Sketch No. 69-011A

TRANSPORTATION INFORMATION SYSTEM - MAR 28,2016

```
:LIST-ACCIDENTS-BY-REF-POINT,START-DATE=01/01/2011,NEWS=NO,  
: END-DATE=12/31/2015,VEHIC-DATA,OPTLIST,NO-CODELIST  
+ROUTES  
ROUTE-SYS-&-NUM=0100000035,START-REF=255.514,END-REF=255.514  
+SELECT  
INCLUDE ACCIDENTS IF:  
  ACD.INTCHANGE-ELEM *EQ* '112' *OR*  
  ACD.INTCHANGE-ELEM *EQ* '113' *OR*  
  ACD.INTCHANGE-ELEM *EQ* '211' *OR*  
  ACD.INTCHANGE-ELEM *EQ* '212' *OR*  
  ACD.INTCHANGE-ELEM *EQ* 'A12' *OR*  
  ACD.INTCHANGE-ELEM *EQ* 'B14'  
+TITLES
```

(5 YEAR CRASH HISTORY)

(5 YEAR CRASH HISTORY)

LIST ACCIDENT BY REFERENCE POINT

01/01/2011 THROUGH 12/31/2015

REPORT DATE: MAR 28,2016

ISTH ROUTE SYSTEM - ROUTE 35 - BEGINNING AT 255+00.514 - ENDING AT 255+00.514

SELECT=YES

ROUTE NUMBER	REFERENCE POINT	E L E M E N T	R O A D	I N T E R S E C T I O N	C I T Y	DATE	TIME	S E V E R I T Y	#	J	L	I	T	D	O	L	L	W	W	S	C	D	V	D	A	F	F	P	A S	ACCIDENT NUMBER
		M	Y	S	T			V	V	U	M	Y	I	P	C	C	H	R	R	R	H	A	S	I	C	C	C	C	G E X	
ISTH 35	255+00.514	113	1	01	69 1040	3/28/2011	1211	N	2	20	55	01	01	01	98	01	01	00	01	02	01	02	N	01	15	00	01	59	M	110970188
ISTH 35	255+00.514	211	1	01	69 1040	5/12/2011	1524	N	2	01	45	01	01	01	98	01	02	00	01	01	01	01	S	11	01	00	01	18	F	111330208
ISTH 35	255+00.514	A12	2	00	69 1040	4/16/2011	0500	N	1	00	40	32	08	00	98	02	04	00	03	00	00	01	N	05	00	00	00	42	F	111390077
ISTH 35	255+00.514	211	2	01	69 1040	9/28/2011	0911	N	2	22	45	01	02	01	98	01	01	00	01	01	01	01	S	14	08	00	01	76	M	112930035
ISTH 35	255+00.514	113	1	01	69 1040	2/10/2012	1714	N	2	22	55	01	02	01	98	01	01	00	01	02	01	01	N	01	01	00	01	30	M	120440215
ISTH 35	255+00.514	B14	1	01	69 1040	3/22/2012	1915	C	2	01	55	01	01	01	98	04	03	00	02	06	02	01	S	11	01	00	01	50	M	120860236
ISTH 35	255+00.514	B14	1	01	69 1040	3/22/2012	1915	N	1	20	55	32	90	01	98	04	03	00	02	06	02	01	S	01	01	00	01	16	M	120860237
ISTH 35	255+00.514	B14	1	01	69 1040	4/16/2012	0623	N	1	22	55	34	08	01	98	01	04	00	05	06	02	01	S	01	03	61	01	32	F	121080194
ISTH 35	255+00.514	B14	1	01	69 1040	4/16/2012	0714	N	1	22	55	34	02	01	98	01	02	00	05	06	02	03	S	01	03	61	01	23	F	121080196
ISTH 35	255+00.514	B14	1	01	69 1040	4/16/2012	0747	N	1	22	55	34	02	01	98	01	02	00	05	06	02	01	S	01	03	61	01	34	F	121080197
ISTH 35	255+00.514	A12	1	01	69 1040	6/17/2012	1742	N	2	21	55	01	09	01	98	01	01	00	01	06	02	01	S	01	01	00	01	18	M	121740216
ISTH 35	255+00.514	B14	1	01	69 1040	8/03/2012	0042	N	1	21	55	32	07	01	98	04	01	00	01	06	02	01	S	01	03	15	99	22	M	122160187
ISTH 35	255+00.514	A12	1	01	69 1040	1/23/2013	0828	C	1	22	55	34	07	02	98	01	04	00	05	06	02	01	S	01	03	00	01	19	F	130240180
ISTH 35	255+00.514	112	1	01	69 1040	3/06/2013	0812	N	2	01	55	01	01	01	98	01	01	00	02	02	01	01	N	10	01	00	01	33	F	130660256
ISTH 35	255+00.514	B14	1	01	69 1040	3/16/2013	1336	C	1	22	55	34	07	02	98	01	01	00	01	06	02	03	S	01	15	00	01	17	F	130790362
ISTH 35	255+00.514	A12	1	01	69 1040	6/04/2013	0755	N	2	20	55	01	01	01	98	01	02	00	01	06	02	04	N	16	15	00	01	69	M	131580176
ISTH 35	255+00.514	212	3	00	69 1040	6/07/2013	1900	N	2	00	45	01	01	00	90	01	01	00	01	00	00	02	S	01	00	00	00	22	F	131900085
ISTH 35	255+00.514	211	1	01	69 1040	7/09/2013	0637	C	2	22	55	01	01	01	98	01	06	00	01	02	02	01	S	01	01	00	01	51	M	131920238
ISTH 35	255+00.514	B14	2	01	69 1040	11/03/2013	1536	N	1	20	55	34	04	02	98	01	02	00	01	06	02	01	SW	01	03	00	01	34	F	133090259
ISTH 35	255+00.514	113	1	01	69 1040	12/04/2013	0946	N	1	20	35	31	04	01	98	01	04	00	04	06	02	01	N	01	03	00	01	22	M	133380645
ISTH 35	255+00.514	113	1	01	69 1040	12/06/2013	0743	N	2	01	55	01	02	01	98	01	01	00	05	01	01	04	N	01	01	00	01	34	F	133400554
ISTH 35	255+00.514	113	1	01	69 1040	12/25/2013	1043	N	1	01	55	34	04	03	98	01	04	00	05	02	01	01	SW	01	03	00	01	36	F	133610329
ISTH 35	255+00.514	112	1	01	69 1040	12/25/2013	1149	N	1	01	55	34	04	03	98	01	04	00	05	02	01	02	NE	01	03	00	01	20	F	133610330
ISTH 35	255+00.514	B14	2	01	69 1040	1/22/2014	0805	N	2	20	55	01	02	02	98	01	07	00	05	06	02	01	S	01	46	00	01	68	F	140230457
ISTH 35	255+00.514	211	1	01	69 1040	3/03/2014	2108	N	1	21	55	33	90	05	98	04	04	00	03	03	02	01	S	14	46	00	01	86	F	140640335
ISTH 35	255+00.514	112	2	01	69 1040	4/16/2014	1835	N	1	01	55	32	04	01	98	01	04	00	05	01	01	01	N	01	03	00	01	24	F	141080223
ISTH 35	255+00.514	B14	1	01	69 1040	6/18/2014	1347	B	1	01	55	32	07	02	98	01	08	00	01	06	02	11	S	01	03	61	01	28	M	141700290
ISTH 35	255+00.514	A12	1	01	69 1040	1/08/2015	1824	N	1	22	55	34	04	02	98	04	07	00	05	06	02	01	N	01	03	61	01	18	F	150120380
ISTH 35	255+00.514	113	2	01	69 1040	1/08/2015	1625	N	1	20	55	32	04	01	98	01	01	00	05	01	02	03	N	01	03	00	01	40	M	150120390
ISTH 35	255+00.514	B14	2	01	69 1040	3/03/2015	1438	N	1	21	55	34	07	01	98	01	01	00	02	07	02	03	S	01	08	61	01	52	F	150640242

(5 YEAR CRASH HISTORY)

LIST ACCIDENT BY REFERENCE POINT

01/01/2011 THROUGH 12/31/2015

REPORT DATE: MAR 28,2016

ISTH ROUTE SYSTEM - ROUTE 35 - BEGINNING AT 255+00.514 - ENDING AT 255+00.514

SELECT=YES

ROUTE NUMBER	REFERENCE POINT	ELEVATION	RD	SECTION	TWNP	CITY	DATE	TIME	SEVERITY	#	J	L	I	T	D	O	L	I	T	W	W	S	C	D	V	D	A	F	F	P	ACCIDENT TYPE	ACCIDENT NUMBER
ISTH 35	255+00.514	211	2	01	69	1040	4/03/2015	0117	B	1	03	55	33	90	01	98	04	01	00	01	01	01	01	01	S	01	18	00	02	28	F	151320224
ISTH 35	255+00.514	A12	2	01	69	1040	7/13/2015	1751	N	2	01	55	01	01	01	98	01	01	00	02	06	02	02	N	01	04	00	01	50	M	151960126	
ISTH 35	255+00.514	212	2	01	69	1040	9/11/2015	1502	N	1	21	55	34	02	01	98	01	01	00	01	01	01	01	01	N	13	08	90	01	38	M	152570254
ISTH 35	255+00.514	113	2	01	69	1040	12/27/2015	2139	N	1	01	55	32	04	03	98	04	01	00	05	01	01	01	N	01	03	00	01	16	F	160110015	

SEVERITY SUMMARY FOR +ROUTES: ROUTE-SYS-&-NUM=010000035,START-REF=255.514,END-REF=255.514

FATAL ACCIDENTS	INCAPACITATING INJURY ACCIDENTS	NON-INCAPACITATING INJURY ACCIDENTS	POSSIBLE INJURY ACCIDENTS	SUBTOTAL INJURY ACCIDENTS	PROPERTY DAMAGE ACCIDENTS	TOTAL ACCIDENTS
0	0	2	4	6	28	34

```
:LIST-ACCIDENTS-BY-REF-POINT,START-DATE=01/01/2011,NEWS=NO,  
:  END-DATE=12/31/2015,VEHIC-DATA,OPTLIST,NO-CODELIST  
+ROUTES  
ROUTE-SYS-&-NUM=0100000535,START-REF=001.499,END-REF=001.499  
+SELECT  
INCLUDE ACCIDENTS IF:  
  ACD.INTCHANGE-ELEM *EQ* 'C32' *OR*  
  ACD.INTCHANGE-ELEM *EQ* 'C33' *OR*  
  ACD.INTCHANGE-ELEM *EQ* 'D12' *OR*  
  ACD.INTCHANGE-ELEM *EQ* 'D31'  
+TITLES
```

(5 YEAR CRASH HISTORY)

(5 YEAR CRASH HISTORY)

LIST ACCIDENT BY REFERENCE POINT

01/01/2011 THROUGH 12/31/2015

REPORT DATE: MAR 28,2016

ISTH ROUTE SYSTEM - ROUTE 535 - BEGINNING AT 001+00.499 - ENDING AT 001+00.499

SELECT=YES

ROUTE NUMBER	REFERENCE POINT	E L M	R Y	I N D C	T W N P	DATE	TIME	S V E	#	J U M	L I T	D O	L I C	L G H	W H	W H	S U	C H R	D E T	D I R	A C C	F T	F T	P T O	A S	ACCIDENT NUMBER				
ISTH 535	001+00.499	C33	2 01	69	1040	11/25/2011	2359	N	1	20	55	34	02	01	98	04	02	00	02	06	01	02	S	01	03	15	99	19	M	120370305
ISTH 535	001+00.499	D31	1 01	69	1040	3/03/2012	0936	C	1	22	55	33	08	02	98	01	04	00	03	01	01	01	N	01	03	61	01	22	F	120650239
ISTH 535	001+00.499	D31	2 01	69	1040	1/25/2013	0227	N	1	22	55	33	08	01	98	04	04	00	03	01	01	02	N	01	18	00	02	25	M	130420259
ISTH 535	001+00.499	C32	1 01	69	1040	1/24/2013	1834	N	1	03	55	32	04	01	98	04	04	00	03	06	02	01	N	01	03	00	01	22	F	130570259
ISTH 535	001+00.499	D31	1 01	69	1040	4/16/2013	1049	N	2	22	55	01	01	01	98	01	02	00	01	01	01	02	N	10	01	00	01	23	M	131080366
ISTH 535	001+00.499	D31	2 01	69	1040	7/15/2013	1714	N	2	03	55	01	01	01	05	01	02	00	01	02	02	01	S	16	01	00	01	30	F	132170228
ISTH 535	001+00.499	C33	1 01	69	1040	7/08/2014	1805	N	1	01	55	34	07	01	98	01	02	00	02	01	01	01	S	01	08	00	01	28	F	141900269
ISTH 535	001+00.499	D31	2 01	69	1040	7/12/2014	0112	B	1	03	55	34	02	02	98	04	01	00	01	05	02	04	N	01	03	18	01	42	M	142580247
ISTH 535	001+00.499	C33	2 01	69	1040	1/08/2015	2054	N	1	03	55	35	07	01	98	04	02	00	05	90	02	04	S	01	90	00	01	55	F	150200302
ISTH 535	001+00.499	D31	2 01	69	1040	1/08/2015	2109	N	1	01	55	32	07	01	98	04	02	00	05	06	02	01	S	01	18	03	02	56	M	150200303
ISTH 535	001+00.499	D12	1 01	69	1040	2/26/2015	1729	N	1	22	55	33	90	03	98	01	01	00	01	06	02	01	W	01	32	00	01	64	M	150770175
ISTH 535	001+00.499	D31	2 01	69	1040	3/19/2015	0755	N	3	01	55	01	01	01	98	01	02	00	01	01	01	03	N	10	01	00	01	48	F	150780196
ISTH 535	001+00.499	D12	2 01	69	1040	6/09/2015	0942	C	1	21	55	34	07	01	98	01	01	00	01	06	01	11	N	01	90	00	01	58	M	151610332
ISTH 535	001+00.499	D12	2 01	69	1040	8/07/2015	2140	N	2	20	55	01	01	01	05	03	01	00	01	02	02	01	S	11	01	00	01	19	M	152320293

SEVERITY SUMMARY FOR +ROUTES: ROUTE-SYS-&-NUM=010000535, START-REF=001.499, END-REF=001.499

FATAL ACCIDENTS	INCAPACITATING INJURY ACCIDENTS	NON-INCAPACITATING INJURY ACCIDENTS	POSSIBLE INJURY ACCIDENTS	SUBTOTAL INJURY ACCIDENTS	PROPERTY DAMAGE ACCIDENTS	TOTAL ACCIDENTS
0	0	1	2	3	11	14

USTH 53 JCT WITH MSAS 124 (21st AVE. W)

ST. LOUIS CO. 69
DULUTH 1040
PS 2730

100's
USTH 53 200's USE $\textcircled{\text{RP}}$ = 001+00.820
 A&B's USE $\text{\textcircled{RP}}$ = 001+00.974

MSAS 124 900's USE $\textcircled{\text{RP}}$ = 000+00.157

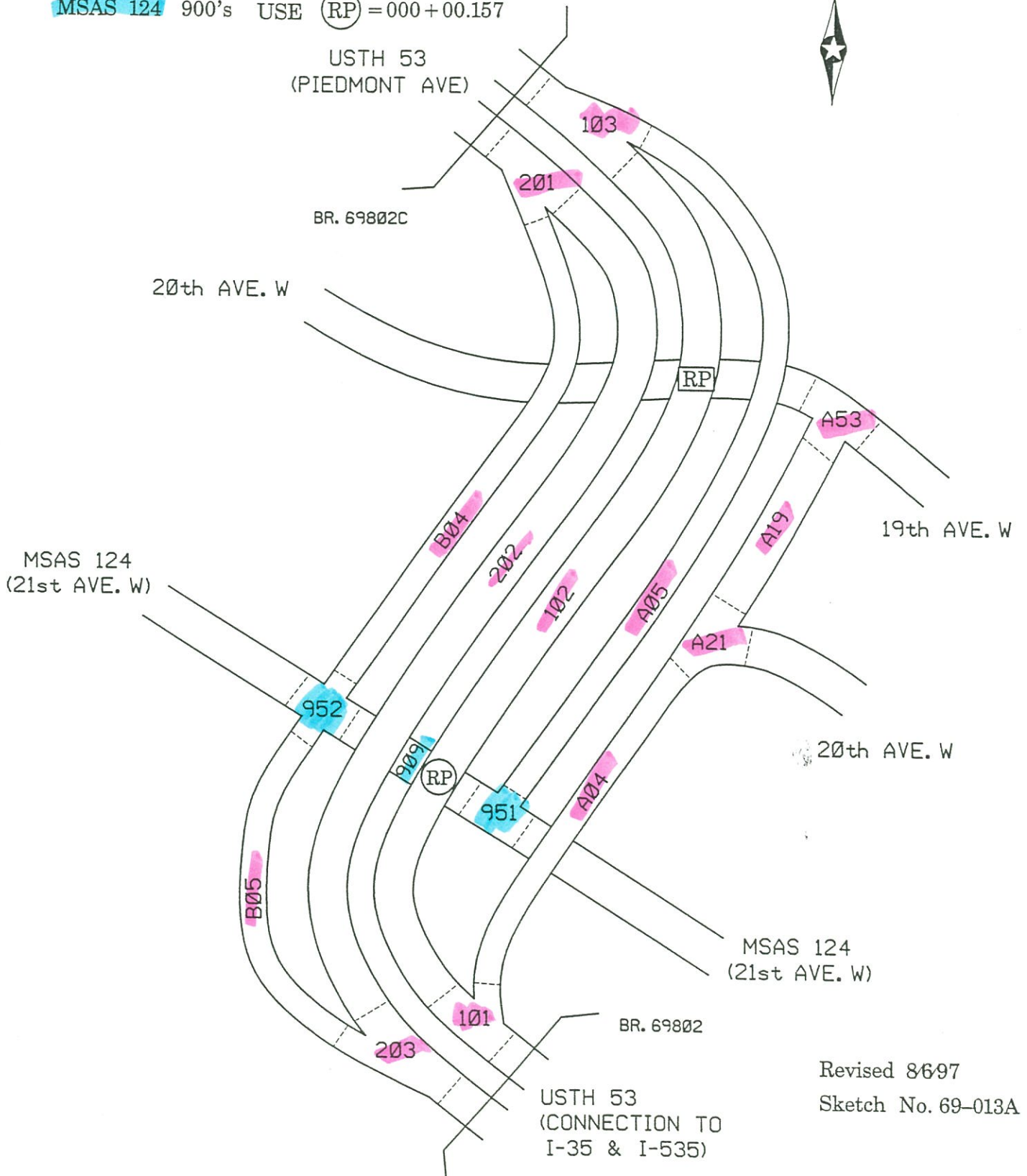

Revised 8/6/97
Sketch No. 69-013A

TRANSPORTATION INFORMATION SYSTEM - MAR 28,2016

```
:LIST-ACCIDENTS-BY-REF-POINT,START-DATE=01/01/2011,NEWS=NO,  
:  END-DATE=12/31/2015,VEHIC-DATA,OPTLIST,NO-CODELIST  
+ROUTES  
ROUTE-SYS-&-NUM=0200000053,START-REF=001.820,END-REF=001.974  
+SELECT  
INCLUDE ACCIDENTS IF:  
  ACD.INTCHANGE-ELEM *EQ* '101' *OR*  
  ACD.INTCHANGE-ELEM *EQ* '102' *OR*  
  ACD.INTCHANGE-ELEM *EQ* '103' *OR*  
  ACD.INTCHANGE-ELEM *EQ* '201' *OR*  
  ACD.INTCHANGE-ELEM *EQ* '202' *OR*  
  ACD.INTCHANGE-ELEM *EQ* '203' *OR*  
  ACD.INTCHANGE-ELEM *EQ* 'A04' *OR*  
  ACD.INTCHANGE-ELEM *EQ* 'A05' *OR*  
  ACD.INTCHANGE-ELEM *EQ* 'A19' *OR*  
  ACD.INTCHANGE-ELEM *EQ* 'A21' *OR*  
  ACD.INTCHANGE-ELEM *EQ* 'A53' *OR*  
  ACD.INTCHANGE-ELEM *EQ* 'B04' *OR*  
  ACD.INTCHANGE-ELEM *EQ* 'B05'  
+TITLES
```

(5 YEAR CRASH HISTORY)

(5 YEAR CRASH HISTORY)

LIST ACCIDENT BY REFERENCE POINT 01/01/2011 THROUGH 12/31/2015 REPORT DATE: MAR 28,2016
 USTH ROUTE SYSTEM - ROUTE 53 - BEGINNING AT 001+00.820 - ENDING AT 001+00.974
 SELECT=YES

ROUTE NUMBER	REFERENCE POINT	ELM Y	REV Y	IND S T	C TWNP OR CITY	DATE	TIME	TYPE	#	J	L	I	T	D	O	L	W	W	S	C	D	V	D	A	F	F	P	A	S	ACCIDENT NUMBER
USTH 53	001+00.820	A04	1	01	69 1040	1/13/2011	1140	N	1	21	40	32	04	03	98	01	04	00	03	06	03	01	N	01	03	61	01	19	F	110180525
USTH 53	001+00.820	202	2	01	69 1040	1/16/2011	1903	N	2	01	55	01	05	01	98	04	01	00	01	01	01	01	S	14	08	00	01	19	F	110270062
USTH 53	001+00.820	102	1	00	69 1040	2/09/2011	0400	N	2	00	00	01	01	00	05	01	01	00	01	00	00	01								
USTH 53	001+00.820	202	1	01	69 1040	2/17/2012	0711	N	1	01	50	34	07	02	98	01	04	00	03	01	01	03	S	10	03	00	01	28	F	120540472
USTH 53	001+00.820	102	1	01	69 1040	11/05/2012	0708	N	1	20	55	34	07	04	98	01	01	00	01	06	03	01	N	01	15	00	01	20	F	123100215
USTH 53	001+00.820	A04	2	01	69 1040	11/14/2012	1234	N	2	01	55	01	02	01	98	01	02	00	01	01	03	02	N	01	08	00	01	49	M	123210219
USTH 53	001+00.820	102	2	01	69 1040	1/23/2013	0648	N	1	01	55	34	07	02	98	04	04	00	05	06	03	01	N	01	03	00	01	31	F	130240169
USTH 53	001+00.820	103	3	03	69 1040	4/22/2013	0627	N	1	01	40	34	07	01	98	01	01	00	05	06	03	01	N	01	46	00	01	39	F	131140144
USTH 53	001+00.820	B05	1	03	69 1040	4/22/2013	0703	N	2	01	45	34	90	01	98	01	01	00	05	06	01	02	S	01	61	00	01	53	M	131150027
USTH 53	001+00.820	202	2	01	69 1040	5/03/2013	2042	N	1	01	45	34	07	01	98	04	05	00	05	01	03	01	S	01	03	61	01	22	F	131260200
USTH 53	001+00.820	201	2	03	69 1040	8/29/2013	0743	N	2	21	55	01	01	01	05	01	01	00	01	05	02	01	S	01	15	00	01	19	M	132410035
USTH 53	001+00.820	201	2	01	69 1040	10/17/2013	1521	N	1	21	55	32	04	03	98	01	03	00	02	06	03	01	S	01	03	61	01	20	F	140090510
USTH 53	001+00.820	102	1	01	69 1040	1/25/2014	1204	N	1	21	55	32	04	01	98	01	01	00	05	06	01	04	N	01	03	61	01	34	M	140280659
USTH 53	001+00.820	202	1	01	69 1040	2/15/2014	1600	N	2	01	40	01	09	01	98	01	04	00	05	06	03	01	SW	01	03	00	01	19	F	140490432
USTH 53	001+00.820	101	1	01	69 1040	3/04/2014	0730	C	1	01	50	32	04	02	98	01	01	00	05	01	01	02	N	14	03	61	01	54	M	140660382
USTH 53	001+00.820	202	1	01	69 1040	3/27/2014	1223	N	1	01	40	32	04	02	98	01	04	00	03	06	03	01	S	01	03	61	01	21	M	140900268
USTH 53	001+00.820	202	1	01	69 1040	4/20/2014	0326	N	1	01	45	32	02	01	98	04	02	00	05	06	05	02	S	01	03	00	01	35	M	141110215
USTH 53	001+00.820	101	1	01	69 1040	7/09/2014	1730	N	2	21	45	01	02	01	98	01	01	00	01	05	03	02	N	01	01	00	01	37	M	141910198
USTH 53	001+00.820	202	1	01	69 1040	8/28/2014	1445	B	1	21	55	32	04	03	98	01	01	00	01	06	03	11	S	01	03	00	01	58	M	142470258
USTH 53	001+00.820	B05	1	03	69 1040	3/26/2015	1747	C	2	01	70	01	01	01	05	01	01	00	01	02	02	01	S	00	00	00	01	25	F	150850130
USTH 53	001+00.820	101	1	01	69 1040	2/20/2015	1120	C	1	22	55	32	04	03	98	01	04	00	03	05	01	01	N	01	03	00	01	53	F	150970181
USTH 53	001+00.820	202	2	01	69 1040	9/02/2015	0900	N	1	01	40	34	04	01	98	01	03	00	02	06	03	01	S	01	03	61	01	18	F	152460306
USTH 53	001+00.820	102	2	01	69 1040	11/17/2015	1331	N	1	22	40	32	04	01	98	01	03	02	02	06	01	01	S	01	03	00	01	20	F	153220285
USTH 53	001+00.974	202	1	01	69 1040	3/06/2011	1632	N	1	01	40	32	04	02	98	01	04	00	03	06	03	01	S	01	03	00	01	23	F	110700197
USTH 53	001+00.974	202	1	01	69 1040	11/27/2012	1401	N	1	01	40	34	07	02	98	01	04	00	02	06	03	03	S	01	03	00	01	29	F	130070100
USTH 53	001+00.974	202	1	01	69 1040	2/01/2013	1539	C	1	01	55	32	07	03	98	01	02	00	01	06	01	01	S	01	08	46	01	65	F	130350412
USTH 53	001+00.974	103	1	03	69 1040	3/15/2013	2153	C	1	22	40	34	90	01	98	04	04	07	03	06	03	01	N	01	61	00	01	34	M	130740367
USTH 53	001+00.974	103	1	00	69 1040	2/18/2013	1735	N	1	00	40	32	08	00	98	07	04	00	04	00	00	01	NW	01	00	00	00	23	F	130790060
USTH 53	001+00.974	201	1	01	69 1040	7/06/2013	1528	C	1	01	40	32	04	02	98	01	03	00	02	06	03	03	S	01	03	61	01	19	F	131890208
USTH 53	001+00.974	202	2	01	69 1040	10/29/2013	1603	N	1	01	40	32	02	01	98	01	03	00	02	06	03	01	S	01	03	00	01	18	M	133040211
USTH 53	001+00.974	A05	1	03	69 1040	12/11/2013	0935	N	2	01	30	01	01	01	98	01	01	00	05	07	02	01	N	11	50	00	01	53	M	133450116
USTH 53	001+00.974	202	1	01	69 1040	2/17/2014	2251	N	1	01	40	32	04	02	98	04	02	00	05	06	03	01	S	01	01	00	01	21	F	140500441
USTH 53	001+00.974	202	1	01	69 1040	1/10/2015	0858	N	1	22	40	32	04	01	98	01	01	00	05	06	01	03	S	13	01	00	01	52	M	150120383

(5 YEAR CRASH HISTORY)

LIST ACCIDENT BY REFERENCE POINT

01/01/2011 THROUGH 12/31/2015

REPORT DATE: MAR 28,2016

USTH ROUTE SYSTEM - ROUTE 53 - BEGINNING AT 001+00.820 - ENDING AT 001+00.974

SELECT=YES

ROUTE NUMBER	REFERENCE POINT	E L M	R Y	I N D C	T W N P	DATE	TIME	V	#	J	L	I	T	D	O	L	T	G	H	H	U	H	S	C	D	V	D	A	F	F	P	A	S	ACCIDENT	
																																			EX NUMBER
USTH 53	001+00.974	202	2	01	69 1040	1/08/2015	1547	N	1	22	40	32	07	01	98	01	04	00	05	06	01	01	S	01	03	00	01	19	F	150120384					
USTH 53	001+00.974	202	2	01	69 1040	5/05/2015	2151	B	1	01	40	51	90	01	98	04	01	00	01	06	01	35	S	01	03	41	01	32	M	151280249					

SEVERITY SUMMARY FOR +ROUTES: ROUTE-SYS-&-NUM=0200000053,START-REF=001.820,END-REF=001.974

FATAL ACCIDENTS	INCAPACITATING INJURY ACCIDENTS	NON- INCAPACITATING INJURY ACCIDENTS	POSSIBLE INJURY ACCIDENTS	SUBTOTAL INJURY ACCIDENTS	PROPERTY DAMAGE ACCIDENTS	TOTAL ACCIDENTS
0	0	2	6	8	27	35

TRANSPORTATION INFORMATION SYSTEM - MAR 28,2016

:LIST-ACCIDENTS-BY-REF-POINT,START-DATE=01/01/2011,NEWS=NO,
: END-DATE=12/31/2015,VEHIC-DATA,OPTLIST,NO-CODELIST
+ROUTES
ROUTE-SYS-&-NUM=0510400124,START-REF=000.157,END-REF=000.157
+SELECT
INCLUDE ACCIDENTS IF:
ACD.INTCHANGE-ELEM *EQ* '909' *OR*
ACD.INTCHANGE-ELEM *EQ* '951' *OR*
ACD.INTCHANGE-ELEM *EQ* '952'
+TITLES

(5 YEAR CRASH HISTORY)

(5 YEAR CRASH HISTORY)

LIST ACCIDENT BY REFERENCE POINT

01/01/2011 THROUGH 12/31/2015

REPORT DATE: MAR 28,2016

MSAS ROUTE SYSTEM - ROUTE 10400124 - BEGINNING AT 000+00.157 - ENDING AT 000+00.157

SELECT=YES

ROUTE NUMBER	REFERENCE POINT	E L M	R Y	I N D C	N T W N P	DATE	TIME	V	#	J	L	I	T	D	O	L	L	W	W	S	C	D	V	D	A	F	F	P	A S	ACCIDENT
		L E S T	M Y S T	E R N D C	N T W N P				S E	J U M Y	L I T D O	I T T S	C E T I	D I C C C C	T G H H U H	C H R R R A	W W S C	W W S C	S C E T I	C E T I	D I C C C C	D I C C C C	A F F P	F F P	F F P	P	G E	ACCIDENT		
		M Y S T	M Y S T	E R N D C	N T W N P				S E	J U M Y	L I T D O	I T T S	C E T I	D I C C C C	T G H H U H	C H R R R A	W W S C	W W S C	S C E T I	C E T I	D I C C C C	D I C C C C	A F F P	F F P	F F P	P	G E	ACCIDENT		
MSAS 124	000+00.157	952	1 00	69 1040	1/27/2011	0959	N	2 00	30	01	01	00	05	01	02	00	01	00	00	00	03	SW	10	00	00	00	28	F	110600125	
																					01	SW	10	00	00	00	57	M		

SEVERITY SUMMARY FOR +ROUTES: ROUTE-SYS-&-NUM=0510400124,START-REF=000.157,END-REF=000.157

FATAL ACCIDENTS	INCAPACITATING INJURY ACCIDENTS	NON-INCAPACITATING INJURY ACCIDENTS	POSSIBLE INJURY ACCIDENTS	SUBTOTAL INJURY ACCIDENTS	PROPERTY DAMAGE ACCIDENTS	TOTAL ACCIDENTS
0	0	0	0	0	1	1