

CHANNELIZERS, SIDEWALK BARRICADES, AND PORTABLE STANDS

GENERAL NOTES;

1. RAILINGS OR OTHER OBJECTS MAY PROTRUDE A MAXIMUM OF 4" INTO THE WALKWAY CLEAR SPACE WHEN LOCATED A MINIMUM OF 27" ABOVE THE WALKWAY SURFACE.
2. WHEN TEMPORARY BARRIER IS USED AS A PEDESTRIAN CHANNELIZER IT SHALL MEET CRASHWORTHY REQUIREMENTS.
3. WHEN USED, SIDEWALK BARRICADES SHALL BE PLACED ACROSS THE ENTIRE WIDTH OF THE WALKWAY SURFACE.
4. ALL DEVICES USED TO CHANNELIZE PEDESTRIAN FLOW SHOULD INTERLOCK SUCH THAT GAPS DO NOT ALLOW PEDESTRIANS TO STRAY FROM THE CHANNELIZED PATH.

SPECIFIC NOTES;

- ① ANY TRIPPING HAZARD IN THE WALKWAY NEEDS A DETECTABLE EDGE. BALLAST SHALL BE LOCATED BEHIND THE DETECTABLE EDGE OR INTERNAL TO THE DEVICE. ANY SUPPORT ON THE FRONT OF THE DEVICE SHOULD NOT EXTEND INTO THE 48" MINIMUM WALKWAY CLEAR SPACE, ANY SUPPORT THAT EXTENDS INTO THE WALKWAY SHALL NOT EXCEED 0.5" HEIGHT ABOVE THE WALKWAY SURFACE; IF GREATER THAN 0.25", BEVEL AS SHOWN IN THE EDGE TREATMENT DETAIL.
- ② DETECTABLE EDGES SHALL BE CONTINUOUS AND 6" MINIMUM ABOVE THE WALKWAY SURFACE AND HAVE COLOR MARKINGS CONTRASTING WITH THE WALKWAY SURFACE. THE DETECTABLE EDGE AROUND A PORTABLE SIGN STAND SHOULD BE PLACED IN THE WALKWAY AREA IN WHICH THE SIGN POSES A HAZARD TO A VISUALLY IMPAIRED PEDESTRIAN.
- ③ DEVICES AND DETECTABLE EDGES SHALL NOT BLOCK WATER DRAINAGE FROM THE WALKWAY. A GAP HEIGHT OR OPENING FROM THE WALKWAY SURFACE UP TO A MAXIMUM OF 2" IS ALLOWED FOR DRAINAGE PURPOSES.
- ④ WHEN HAND GUIDANCE IS REQUIRED, THE TOP RAIL OR TOP SURFACE SHALL:
 - BE IN A VERTICAL PLANE PERPENDICULAR TO THE WALKWAY ABOVE THE DETECTABLE EDGE,
 - BE CONTINUOUS AT A HEIGHT OF 34 TO 38" ABOVE THE WALKWAY SURFACE, AND
 - BE SUPPORTED WITH MINIMAL INTERFERENCE TO THE PEDESTRIAN'S HANDS OR FINGERS.
- ⑤ ALL DEVICES SHALL BE FREE OF SHARP OR ROUGH EDGES, AND FASTENERS (BOLTS) SHALL BE ROUNDED TO PREVENT HARM TO HANDS, ARMS OR CLOTHING OF PEDESTRIANS.
- ⑥ TEMPORARY WALKWAY SURFACES SHALL BE FIRM, STABLE, FREE-DRAINING AND NON-SLIP REGARDLESS OF WEATHER CONDITIONS. TEMPORARY WALKWAY SURFACES SHALL ALLOW NORMAL USAGE OF WHEELCHAIRS, WALKERS, STROLLERS, OR OTHER MOBILITY DEVICES. CONCRETE, BITUMINOUS, STEEL, RUBBER, WOOD (3/4" OR THICKER), AND PLASTIC ARE ACCEPTABLE SURFACE MATERIALS FOR A TEMPORARY WALKWAY SURFACE. GRAVEL, MILLINGS, OR OTHER UNEVEN SURFACES ARE NOT ACCEPTABLE SURFACE MATERIALS.
- ⑦ LONGITUDINAL CHANNELIZING DEVICES FOR PEDESTRIANS SHALL BE 32" HIGH OR GREATER.
- ⑧ AN EDGE OF THE FRAMING MAY BE REMOVED IF IT IS NOT NEEDED FOR PED GUIDANCE. STABILITY OF THE DETECTABLE EDGE SHOULD BE MAINTAINED.

TYPICAL AUDIBLE MESSAGE
DEVICE LOCATION WHEN USED

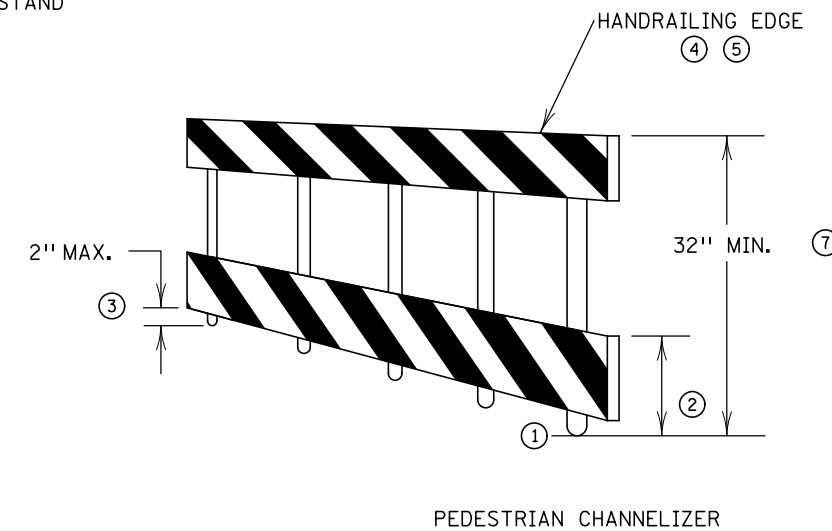
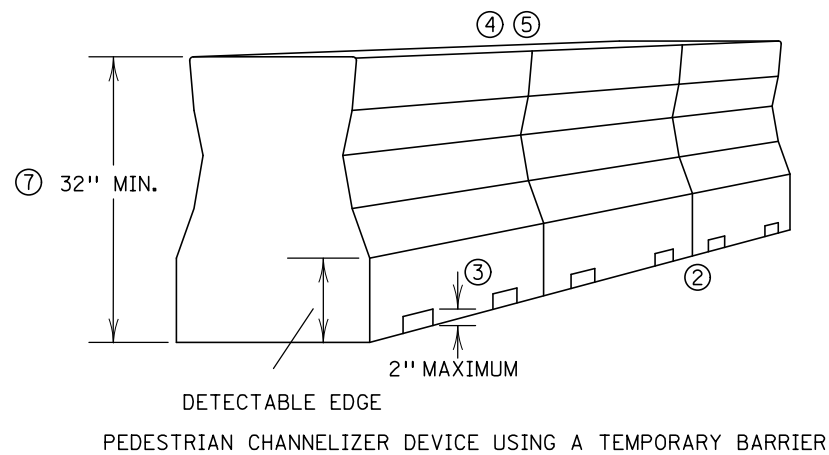
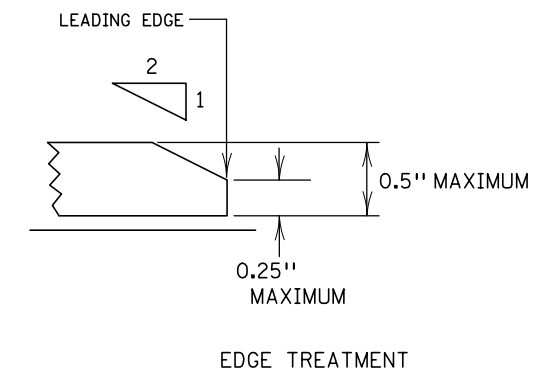
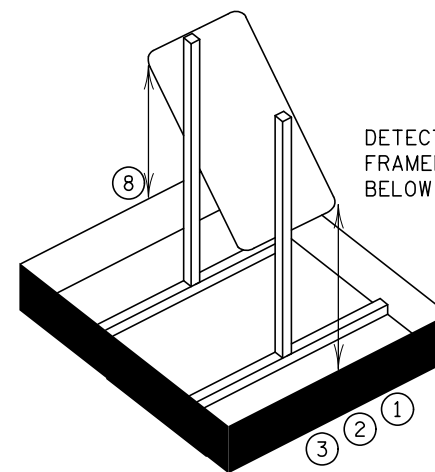
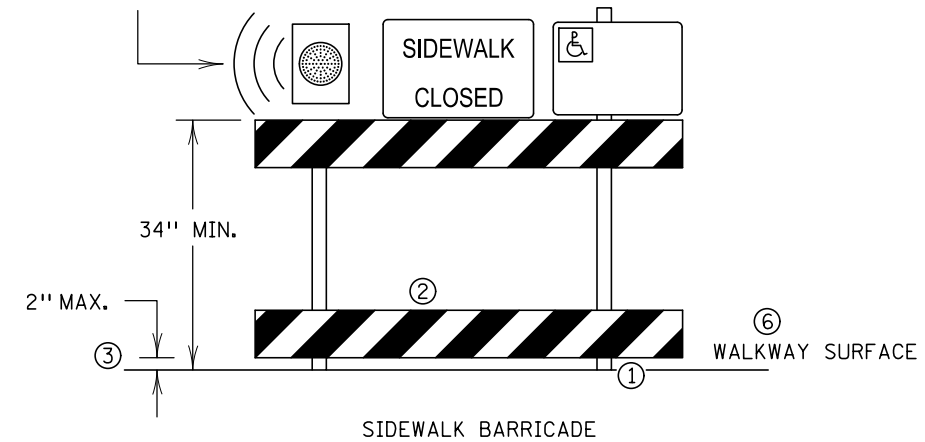

TEMPORARY CURB RAMPS AND WALKWAY SURFACES

SPECIFIC NOTES;

- ① CURB RAMPS SHALL BE 48" MIN. WIDTH WITH A FIRM, STABLE AND SLIP RESISTANT SURFACE.
- ② PROTECTIVE EDGING WITH A 2" MIN. HEIGHT SHALL BE PLACED WHEN A CURB RAMP OR LANDING PLATFORM HAS A VERTICAL DROP OF 6" OR GREATER OR HAS A SIDE APRON SLOPE STEEPER THAN 1:3. PROTECTIVE EDGING SHOULD BE CONSIDERED WHEN CURB RAMPS OR LANDING PLATFORMS HAVE A VERTICAL DROP OF 3" OR MORE.
- ③ DETECTABLE EDGING WITH 6" MIN. HEIGHT AND CONTRASTING COLOR SHALL BE PLACED ON ALL CURB RAMP LANDINGS WHERE THE WALKWAY CHANGES DIRECTION (TURNS).
- ④ CURB RAMPS AND LANDINGS SHALL HAVE A 2% MAX. CROSS SLOPE.
- ⑤ CLEAR SPACE OF 48" X 48" MIN. SHALL BE PROVIDED ABOVE AND BELOW THE CURB RAMP.
- ⑥ THE CURB RAMP WALKWAY EDGE SHALL BE MARKED WITH A CONTRASTING COLOR, 2" TO 4" WIDE MARKING. THE MARKING IS OPTIONAL WHERE COLOR CONTRASTING EDGING IS USED.
- ⑦ WATER FLOW IN THE GUTTER SYSTEM SHALL NOT BE IMPEDED.
- ⑧ LATERAL JOINTS OR GAPS BETWEEN SURFACES SHALL BE LESS THAN 1/2" WIDTH.
- ⑨ CHANGES BETWEEN SURFACE HEIGHTS SHALL NOT EXCEED 1/2". LATERAL EDGES SHOULD BE VERTICAL UP TO 1/4" HIGH, AND BEVELED AT 1:2 BETWEEN 1/4" AND 1/2" HEIGHT.
- ⑩ THE TEMPORARY WALKWAY SURFACE MAY HAVE A THICKNESS GREATER THAN 0.5", IF THE THICKNESS OF THE TEMPORARY WALKWAY SURFACE IS LESS THAN OR EQUAL TO 0.5", THE BEVEL MAY BE 1:2.

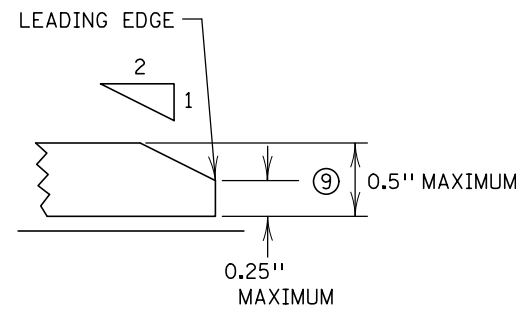

EDGE TREATMENT

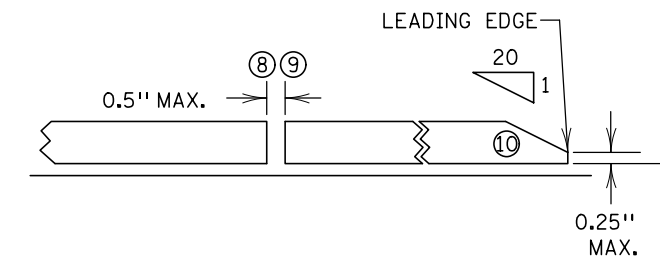

TEMPORARY WALKWAY SURFACE

