

Components of a Stationary Temporary Traffic Control Zone

Temporary Traffic Control Distance Charts

Posted Speed Limit Prior to Work Starting (mph)	Advance Warning Sign Spacing (A) feet	Decision Sight Distance (D) feet	Taper Length (12 ft lane) (L) feet	Shifting Taper (L/2) feet	Typical Shoulder Taper (L/3) feet
0 - 30	G = 25 ft	250	200	100	75
35 - 40		325	325	175	125
45 - 50	G = 50 ft	600	600	300	200
55		750	700	350	250
60 - 65		1000	1400	800	275
70 - 75		1200	1600	900	300

Posted Speed Limit Prior to Work Starting (mph)	Buffer Space (B) feet	Shadow Vehicle Following Distance (F) feet	Protection Vehicle Roll-Ahead Buffer Distance (with or without TMA)	
			Moving (15 mph max) feet	Stopped feet
0 - 30	G = 25 ft	250 - 550	100	100
35 - 40			100	100
45 - 50	G = 50 ft	600 - 900	175	125
55			175	125
60 - 65			225	175
70 - 75			225	175

Type A channelizing devices are typically used in attended temporary traffic control zones.*

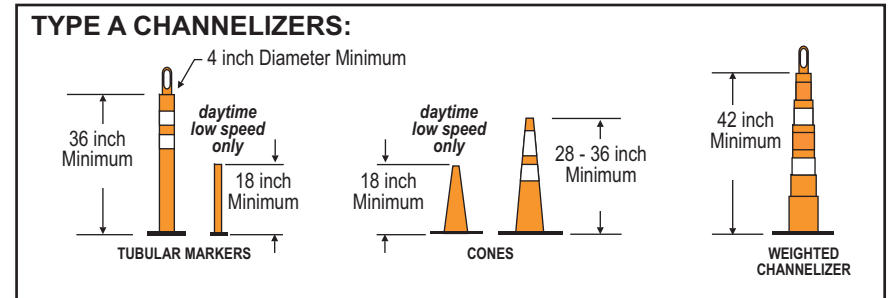

Type B channelizing devices shall be used if the temporary traffic control zone will be installed for more than 12 hours or if it is left unattended over night.*

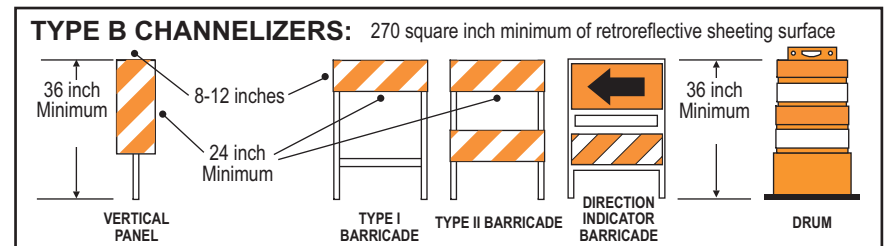

* See the MN MUTCD, Part 6F for more details on application restrictions.

Temporary Traffic Control Distance Charts

Posted Speed Limit Prior to Work Starting (mph)		Advance Warning Sign Spacing (A) feet	Decision Sight Distance (D) feet	Taper Length (12 ft lane) (L) feet	Shifting Taper (L/2) feet	Typical Shoulder Taper (L/3) feet
0 - 30	G = 25 ft	250	550	200	100	75
35 - 40		325	700	325	175	125
45 - 50	G = 50 ft	600	900	600	300	200
55		750	1200	700	350	250
60 - 65		1000	1400	800	400	275
70 - 75		1200	1600	900	450	300

Posted Speed Limit Prior to Work Starting (mph)		Buffer Space (B) feet	Shadow Vehicle Following Distance (F) feet	Protection Vehicle Roll-Ahead Buffer Distance (with or without TMA) (R) feet	
				Moving (15 mph max)	Stopped
0 - 30	G = 25 ft	85	250 - 550	100	100
35 - 40		170	325 - 700	100	100
45 - 50	G = 50 ft	280	600 - 900	175	125
55		335	750 - 1200	175	125
60 - 65		485	1000 - 1400	225	175
70 - 75		670	1200 - 1600	225	175

Type A channelizing devices are typically used in attended temporary traffic control zones.*

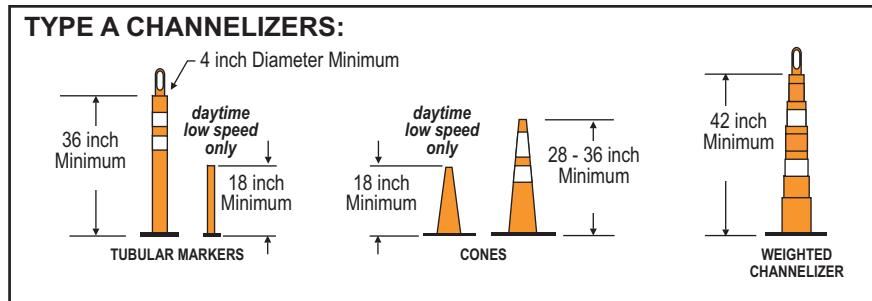

Type B channelizing devices shall be used if the temporary traffic control zone will be installed for more than 12 hours or if it is left unattended over night.*

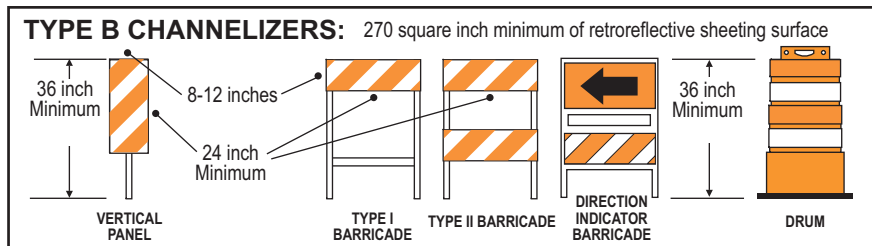

* See the MN MUTCD, Part 6F for more details on application restrictions.

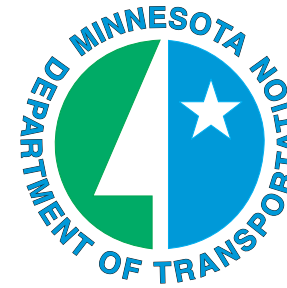

Minnesota Department of Transportation Minnesota Manual on Uniform Traffic Control Devices

