

2010 TH Traffic Volumes City of Faribault

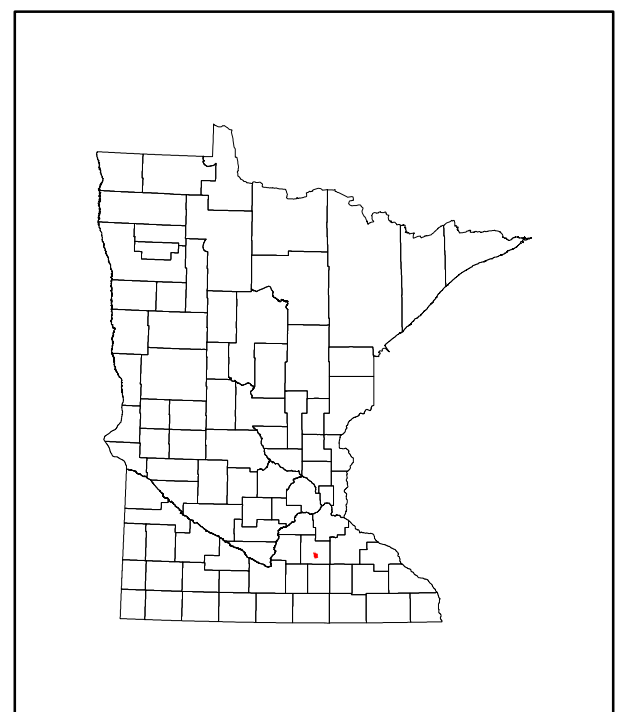

Map Source:
Minnesota Department of Transportation
Office of Transportation Data and Analysis
Traffic Volume Program
http://www.dot.state.mn.us/traffic/data/html/volume_program.html

0 0.25 0.5 Miles

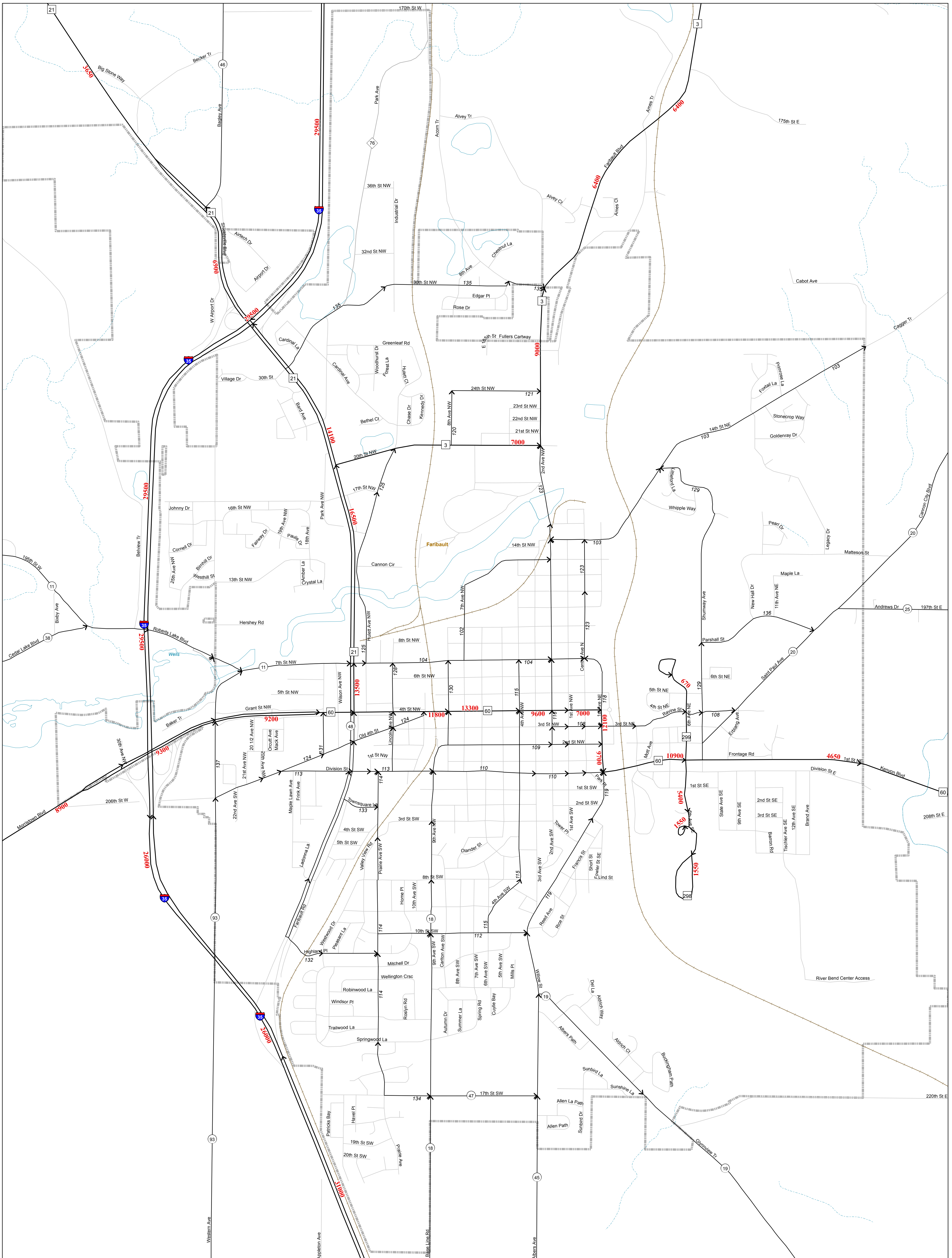

MAP LEGEND

- Trunk Highway AADT** (Red line with shield)
- CSAH and County Road AADT** (Blue line with shield)
- MSAS System AADT** (Green line with shield)
- Interstate** (Blue line with shield)
- US Highway** (Red line with shield)
- MN Highway** (Blue line with shield)
- CSAH** (Blue line with shield)
- MSAS** (Green line with shield)
- County Road** (Black line with shield)
- Other Roads** (Black line)
- Railroads** (Black line with cross-ticks)
- Cities** (Black outline)
- COUNTIES** (Dashed line)
- COUNTY SHEETS** (Dotted line)
- Lakes** (Blue wavy line)
- Rivers** (Blue wavy line)
- Perennial Streams** (Blue wavy line)
- Ditches** (Blue wavy line)
- National Forests** (Green wavy line)
- National Parks** (Green wavy line)
- Tribal Gov'ts** (Yellow wavy line)
- State Forests** (Light green wavy line)
- State Parks** (Light green wavy line)

Numerals Indicate Average Annual Daily Traffic (AADT) Volumes on Designated Roads

Traffic Volumes are Subject to Variability and Construction Effects
For More Info Visit:
<http://www.dot.state.mn.us/traffic/data/html/aadt.html>

