

2009 TH VOLUMES
GENERAL HIGHWAY MAP
CASS COUNTY
MINNESOTA

PREPARED BY THE
MINNESOTA DEPARTMENT OF TRANSPORTATION
OFFICE OF TRANSPORTATION DATA & ANALYSIS
IN COOPERATION WITH
U.S. DEPARTMENT OF TRANSPORTATION
FEDERAL HIGHWAY ADMINISTRATION



2009
BASIC DATA - 1977*

Projections
Minnesota Coordinate System
Central Zone
Lambert Conformal Conic

North American Datum
of 1983



LEGEND

ROAD AND ROADWAY FEATURES	NAVIGATION
PROJECTED ROAD	BASIC LINES ON NATURAL OBSTACLE
UNIMPROVED ROAD	SHIP LINES ON PLAIN LAKES
GRADED AND DRAINED ROAD	DOCK, PIER OR LANDING
GRAVEL OR STONE ROAD	NAVIGABLE STREAM
BETTERMENT ROAD	LANDMARK LIGHT BEACON
GRAVEL ROAD	LIGHTHOUSE
TRUNK HIGHWAY UNDER CONSTRUCTION	
ROADS IN UNINCORPORATED PLACES	
ROADS WITHIN MUNICIPALITIES AND PREVIOUS ROADS	
POINTS BETWEEN WHICH DISTANCES ARE MEASURED INDICATED THIS WAY	
GRADE SEPARATION	
FULL TRAFFIC INTERCHANGE	
PARTIAL TRAFFIC INTERCHANGES INDICATING TRAFFIC MOVEMENT	
ROAD SYSTEM DESIGNATIONS	CONSERVATION
INTERSTATE TRUNK HIGHWAY	FOREST RANGER STATION
U.S. NUMBERED TRUNK HIGHWAY	GUARD OR BRIDGE STATION
STATE NUMBERED TRUNK HIGHWAY	NOT PERMANENTLY OCCUPIED
COUNTY STATE AID HIGHWAY	FOREST STATION
COUNTY STATE AID IN BOUNDING COUNTY	GAME PRESERVE
TERMINATION OF DESIGNATED ROUTE	SECURITY OR LOOKOUT TOWER
	PERMANENT ELEVATION
	MINIMUM POINT OF VIEW
	MANIPULATION OF WATER
	PUBLIC ACCESS POINT
RAILROADS	RECREATION
RAILROAD ANY NUMBER OF TRACKS BY A SINGLE OPERATING COMPANY OR BY TRAINS OF ANOTHER OPERATING COMPANY	GOLF COURSE OR COUNTRY CLUB
RAILROADS IN AUTHORITY OF TWO OR MORE FRANCHISES OR SEPARATELY OPERATED COMPANIES	SKI RESORT
RAILROAD STATION	ATHELETIC FIELD
GRADE CROSSING	MOVEMENT FROM
	POND
	PLASTIC OR POLYESTER
	BATHING BEACH OR SWIMMING POOL
	CAMP SITE
	CAMP OR LODGE
ARWAYS	FARM AND DWELLING UNITS
MILITARY FIELD	FARM UNIT
COMMERCE OR MANUFACTURE	BARNS OR OTHER THAN FARM
COMPLETE FACILITIES	BARNS OR DONORIES FOR STUDENTS
INDUSTRIAL FACILITIES	MANUFACTURE
LANDING AREA OR STRIP	SEASONAL DWELLING
ARROYO LIGHT BEACON/GENERAL	HOME OR GARAGE OF TRAILING CLOSELY SPACED
RAILROAD STATION	INDICATES NUMBER OF EACH UNIT
	SHOWS LOCATION OF CULTURAL FEATURE
STRUCTURES	INDUSTRIAL
GENERAL SYMBOLS OVER 20 SPAN	FACTORY OR INDUSTRIAL PLANT
SMALL BRIDGES CLOSELY SPACED	STORAGE TANKS, OIL OR GAS
GENERAL SYMBOLS 20 SPAN AND OVER	LAKE OR POND
GENERAL SYMBOLS 100 SPAN AND OVER	BEEHIVE
TRUSS	STOCKING FEEDLOT
REFLECTOR BRIDGE	QUARRY/GENERAL/REAR OR CRESCENT FACTORY
DAW WITH ROAD LARGE SCALE	
DAW WITH ROAD SMALL SCALE	
LEVEL OR SIDE WITH ROAD	
LEVEL OR SIDE	
WOOD STRUCTURES 10 TO 20 SPAN	
FORD - ROAD ESTABLISHED	
BOUNDARIES	PUBLIC SERVICE FACILITIES
NATIONAL OR STATE	POST OFFICE
COUNTY	FIRE STATION
CONGRESSIONAL TOWNSHIP (U.S. LAND)	PUBLIC LIBRARY
CORPORATE LINE	SCOUT CAMP OR MEETING POST
SECTION LINE	RAILROAD PORT OF ENTRY
DEPARTMENT OF TRANSPORTATION BOUNDARY	RAILROAD STATION
NATIONAL OR STATE PARK	GENERAL HOSPITAL
	COLLEGIATE INSTITUTION
DRAINAGE	CITY CENTERS
INTERRUPTED STREAM	STATE CAPITAL
WIDE STREAM	CITY CENTER
WIDE RIVER	INCORPORATED CITY (GENERALIZED)
WIDE RIVER WITH DAM OR WEIR	
DRAINAGE BIFURCATION	
LAKE OR POND	

VOLUMES PREPARED BY
THE OFFICE OF
TRANSPORTATION DATA & ANALYSIS

NUMERALS INDICATE AVERAGE DAILY
TRAFFIC VOLUMES ON DESIGNATED ROADS.

FOR DESIGNATED ROADS :
/ = SEGMENT ENDPOINT FOR ALL
ROADS INTERSECTED BY HATCH
(= SEGMENT ENDPOINT ONLY FOR
ROAD SEPARATED FROM INTERSECTING
ROAD BY ARC

TRUNK HIGHWAY ROUTES ARE 2009 A.A.D.T. VOLUMES

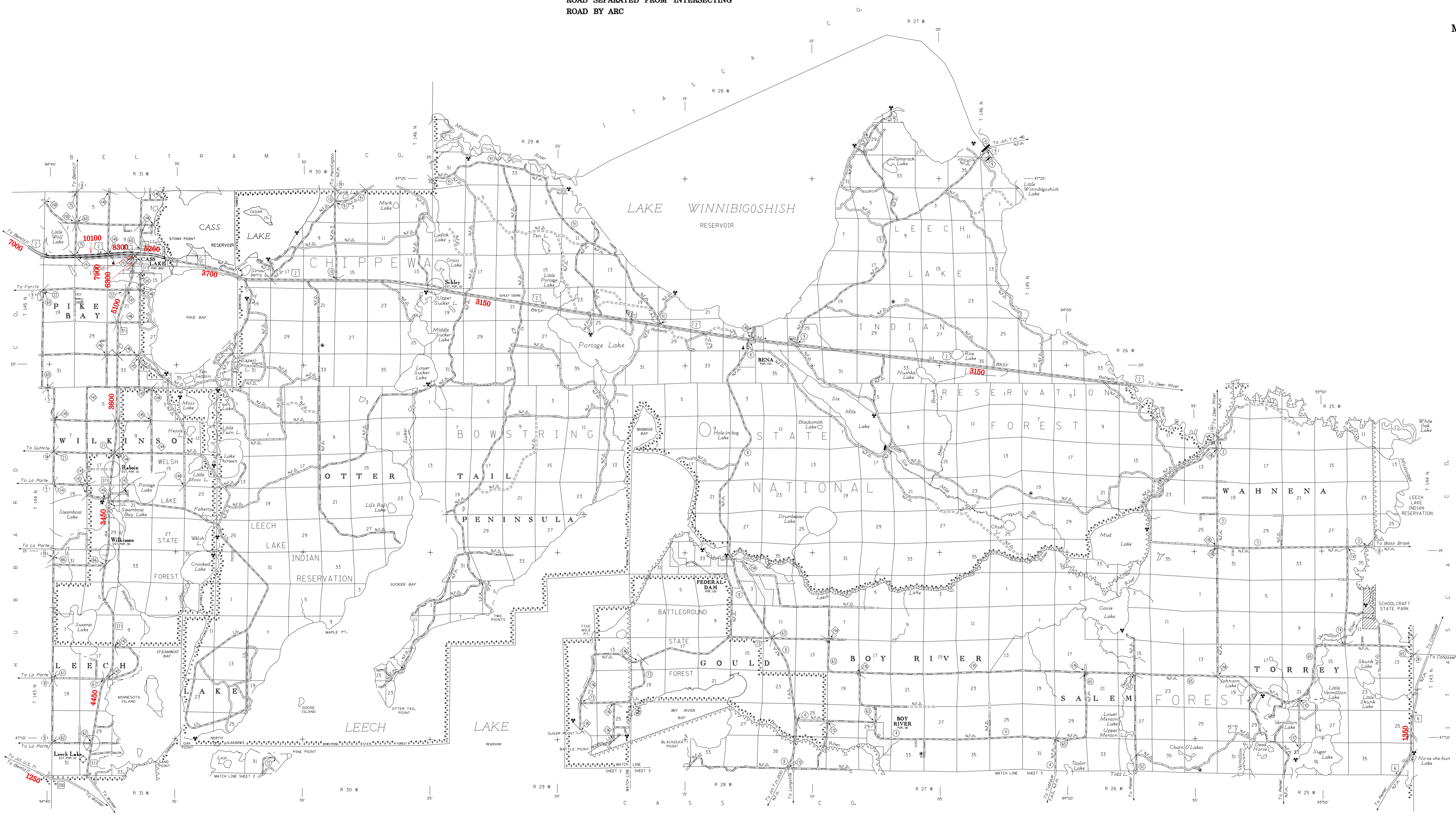

TRAFFIC VOLUMES ARE SUBJECT TO VARIABILITY AND CONSTRUCTION EFFECTS
FOR MORE INFO VISIT: <http://www.dot.state.mn.us/traffic/data/html/adtt.html>

*NOTE: ALL FEATURES EXCEPT TOWNSHIP ROADS AND
CULTURE ARE CURRENT AS OF JANUARY 1, 2009.

NOTE: FOR DETAIL OF COUNTY STATE AID HIGHWAYS AND COUNTY
ROADS IN INCORPORATED PLACES, SEE MAPS OF MUNICIPALITIES.

