

2006 TRUNK HIGHWAY VOLUMES
GENERAL HIGHWAY MAP
WASECA COUNTY
MINNESOTA

PREPARED BY THE
MINNESOTA DEPARTMENT OF TRANSPORTATION
OFFICE OF TRANSPORTATION DATA & ANALYSIS
IN COOPERATION WITH
U.S. DEPARTMENT OF TRANSPORTATION
FEDERAL HIGHWAY ADMINISTRATION

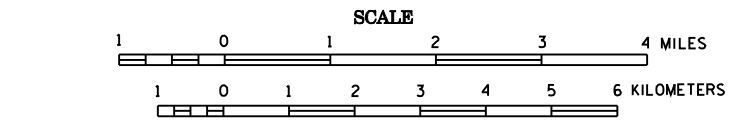

2006
BASIC DATA - 1977
Projection: Minnesota Coordinate System
South Zone
Lambert Conformal Conic
North American Datum of 1983



LEGEND

ROAD AND ROADWAY FEATURES	NAVIGATION	CONSERVATION	RECREATION	FARM AND DWELLING UNITS	INDUSTRIAL	PUBLIC SERVICE FACILITIES	CITY CENTERS	MISCELLANEOUS MAP FEATURES
PROTECTED ROAD	SHIP LINES ON NATURAL STREAMS	FOREST RANGER STATION	BOAT CLUB	FARM UNIT	FACTORY	POST OFFICE	COUNTY SEAT	CAMPUS OTHER RELIGIOUS INSTITUTIONS
PROHIBITED ROAD	SHIP LINES ON MAN-MADE CANALS	GUARD OR RANGER STATION	BOAT HOUSE	SMALL OTHER THAN FARM	MANUFACTURE OF COMMODITIES FOR EXPORT	RAILROAD	CITY CENTER	CAMPUS OTHER RELIGIOUS INSTITUTIONS
UNPROTECTED ROAD	SOIL-PURPOSE ROAD	PORT WAREHOUSE	BOAT HOUSE	MANUFACTURE OF COMMODITIES FOR EXPORT	MANUFACTURE OF COMMODITIES FOR EXPORT	RAILROAD	CITY CENTER	CAMPUS OTHER RELIGIOUS INSTITUTIONS
GRADED AND DRAINED ROAD	SOIL-PURPOSE ROAD	PORT WAREHOUSE	BOAT HOUSE	MANUFACTURE OF COMMODITIES FOR EXPORT	MANUFACTURE OF COMMODITIES FOR EXPORT	RAILROAD	CITY CENTER	CAMPUS OTHER RELIGIOUS INSTITUTIONS
GRADED AND UNGRADED ROAD	SOIL-PURPOSE ROAD	PORT WAREHOUSE	BOAT HOUSE	MANUFACTURE OF COMMODITIES FOR EXPORT	MANUFACTURE OF COMMODITIES FOR EXPORT	RAILROAD	CITY CENTER	CAMPUS OTHER RELIGIOUS INSTITUTIONS
GRADED ROAD	SOIL-PURPOSE ROAD	PORT WAREHOUSE	BOAT HOUSE	MANUFACTURE OF COMMODITIES FOR EXPORT	MANUFACTURE OF COMMODITIES FOR EXPORT	RAILROAD	CITY CENTER	CAMPUS OTHER RELIGIOUS INSTITUTIONS
UNGRADED ROAD	SOIL-PURPOSE ROAD	PORT WAREHOUSE	BOAT HOUSE	MANUFACTURE OF COMMODITIES FOR EXPORT	MANUFACTURE OF COMMODITIES FOR EXPORT	RAILROAD	CITY CENTER	CAMPUS OTHER RELIGIOUS INSTITUTIONS
ROAD WITH UNGRADED DRIVEWAY	SOIL-PURPOSE ROAD	PORT WAREHOUSE	BOAT HOUSE	MANUFACTURE OF COMMODITIES FOR EXPORT	MANUFACTURE OF COMMODITIES FOR EXPORT	RAILROAD	CITY CENTER	CAMPUS OTHER RELIGIOUS INSTITUTIONS
ROAD WITH UNGRADED DRIVEWAY	SOIL-PURPOSE ROAD	PORT WAREHOUSE	BOAT HOUSE	MANUFACTURE OF COMMODITIES FOR EXPORT	MANUFACTURE OF COMMODITIES FOR EXPORT	RAILROAD	CITY CENTER	CAMPUS OTHER RELIGIOUS INSTITUTIONS
ROAD WITH UNGRADED DRIVEWAY	SOIL-PURPOSE ROAD	PORT WAREHOUSE	BOAT HOUSE	MANUFACTURE OF COMMODITIES FOR EXPORT	MANUFACTURE OF COMMODITIES FOR EXPORT	RAILROAD	CITY CENTER	CAMPUS OTHER RELIGIOUS INSTITUTIONS

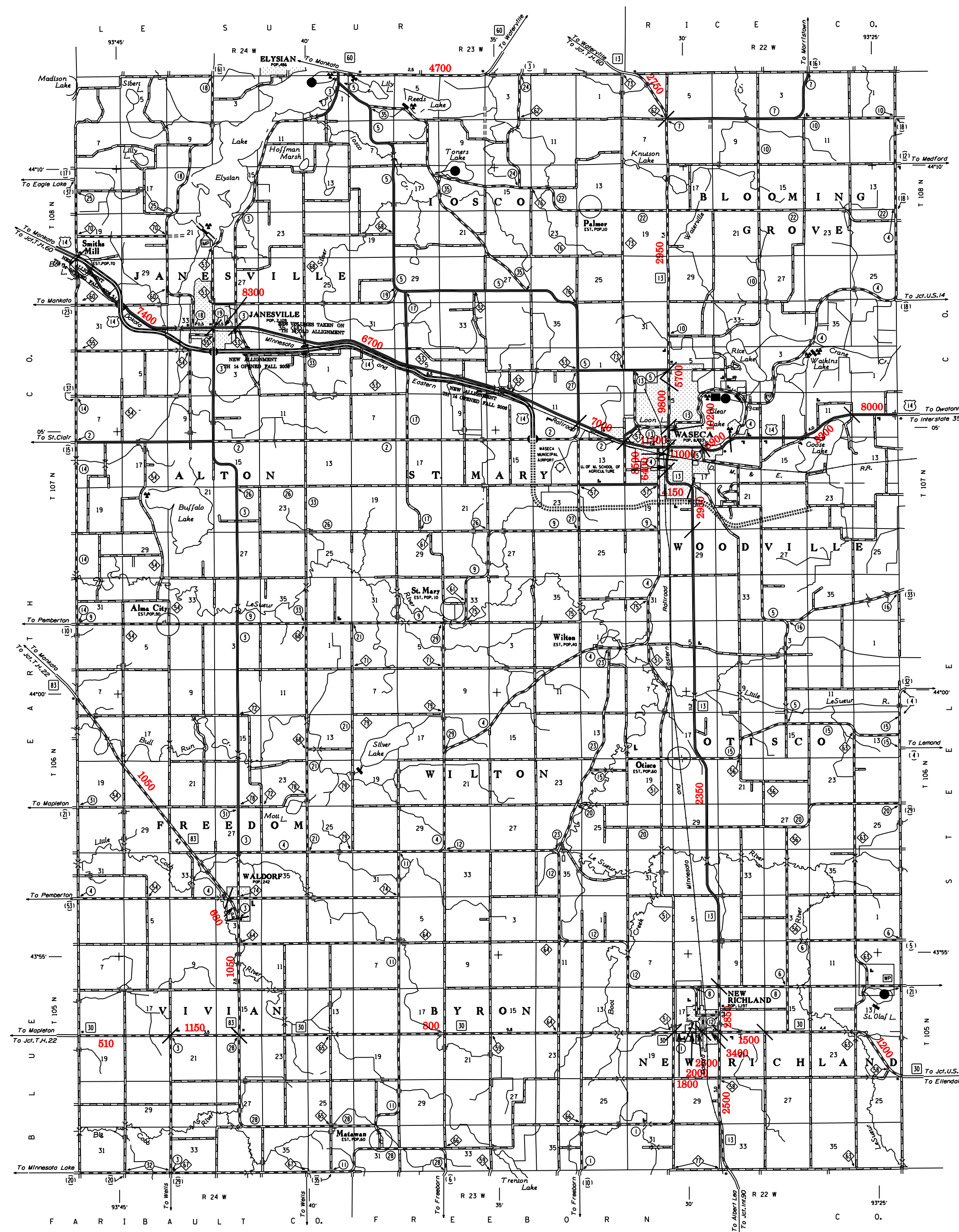

VOLUMES PREPARED BY
THE OFFICE OF
TRANSPORTATION DATA & ANALYSIS

NUMERALS INDICATE AVERAGE DAILY
TRAFFIC VOLUMES ON DESIGNATED ROADS.

TRUNK HIGHWAY ROUTES ARE 2006 A.A.T.VOLUMES.

FOR DESIGNATED ROADS :
/ = SEGMENT ENDPOINT FOR ALL
ROADS INTERSECTED BY HATCH
(= SEGMENT ENDPOINT ONLY FOR
ROAD SEPARATED FROM INTERSECTING
ROAD BY ARC

NOTE: ALL FEATURES EXCEPT TOWNSHIP ROADS AND
CULTURE ARE CURRENT AS OF JANUARY 1, 2006.
NOTE: FOR DETAIL OF COUNTY STATE AID HIGHWAYS AND COUNTY
ROADS IN INCORPORATED PLACES, SEE MAPS OF MUNICIPALITIES.

