

2006 TRUNK HIGHWAY VOLUMES
 GENERAL HIGHWAY MAP
McLEOD COUNTY MINNESOTA

PREPARED BY THE
MINNESOTA DEPARTMENT OF TRANSPORTATION
 OFFICE OF TRANSPORTATION DATA & ANALYSIS
 IN COOPERATION WITH
U.S. DEPARTMENT OF TRANSPORTATION
 FEDERAL HIGHWAY ADMINISTRATION

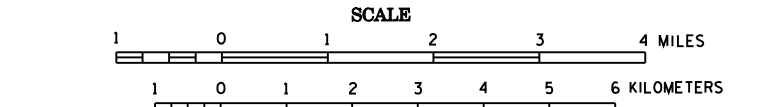

2006
 BASIC DATA - 2005*

Projections
 Minnesota Coordinate System
 South Zone
 Lambert Conformal Conic



LEGEND

ROAD AND ROADWAY FEATURES	NAVIGATION
PROPOSED ROAD	RAILROAD
UNIMPROVED ROAD	RAILROAD CROSSING
GRAVEL AND GRAVEL ROAD	RAILROAD CROSSING WITH SIGNAL
GRAVEL ROAD	RAILROAD CROSSING WITH SIGNAL AND LIGHTS
BRIDGE ROAD	RAILROAD CROSSING WITH SIGNAL AND LIGHTS AND CROSSING
ROAD	RAILROAD CROSSING WITH SIGNAL AND LIGHTS AND CROSSING AND LIGHTS
DIVIDED ROAD	RAILROAD CROSSING WITH SIGNAL AND LIGHTS AND CROSSING AND LIGHTS AND CROSSING
ROAD WITH UNPAVED CONSTRUCTION	RAILROAD CROSSING WITH SIGNAL AND LIGHTS AND CROSSING AND LIGHTS AND CROSSING AND LIGHTS
ROAD IN UNINCORPORATED CENSUS	RAILROAD CROSSING WITH SIGNAL AND LIGHTS AND CROSSING AND LIGHTS AND CROSSING AND LIGHTS AND CROSSING
EXTENSION OF ROAD, ROAD NOT	RAILROAD CROSSING WITH SIGNAL AND LIGHTS AND CROSSING AND LIGHTS AND CROSSING AND LIGHTS AND CROSSING
ROAD WITH UNPAVED CONSTRUCTION	RAILROAD CROSSING WITH SIGNAL AND LIGHTS AND CROSSING AND LIGHTS AND CROSSING AND LIGHTS AND CROSSING
EXTENSION OF ROAD, ROAD NOT	RAILROAD CROSSING WITH SIGNAL AND LIGHTS AND CROSSING AND LIGHTS AND CROSSING AND LIGHTS AND CROSSING
ROAD WITH UNPAVED CONSTRUCTION	RAILROAD CROSSING WITH SIGNAL AND LIGHTS AND CROSSING AND LIGHTS AND CROSSING AND LIGHTS AND CROSSING
EXTENSION OF ROAD, ROAD NOT	RAILROAD CROSSING WITH SIGNAL AND LIGHTS AND CROSSING AND LIGHTS AND CROSSING AND LIGHTS AND CROSSING
ROAD WITH UNPAVED CONSTRUCTION	RAILROAD CROSSING WITH SIGNAL AND LIGHTS AND CROSSING AND LIGHTS AND CROSSING AND LIGHTS AND CROSSING
EXTENSION OF ROAD, ROAD NOT	RAILROAD CROSSING WITH SIGNAL AND LIGHTS AND CROSSING AND LIGHTS AND CROSSING AND LIGHTS AND CROSSING

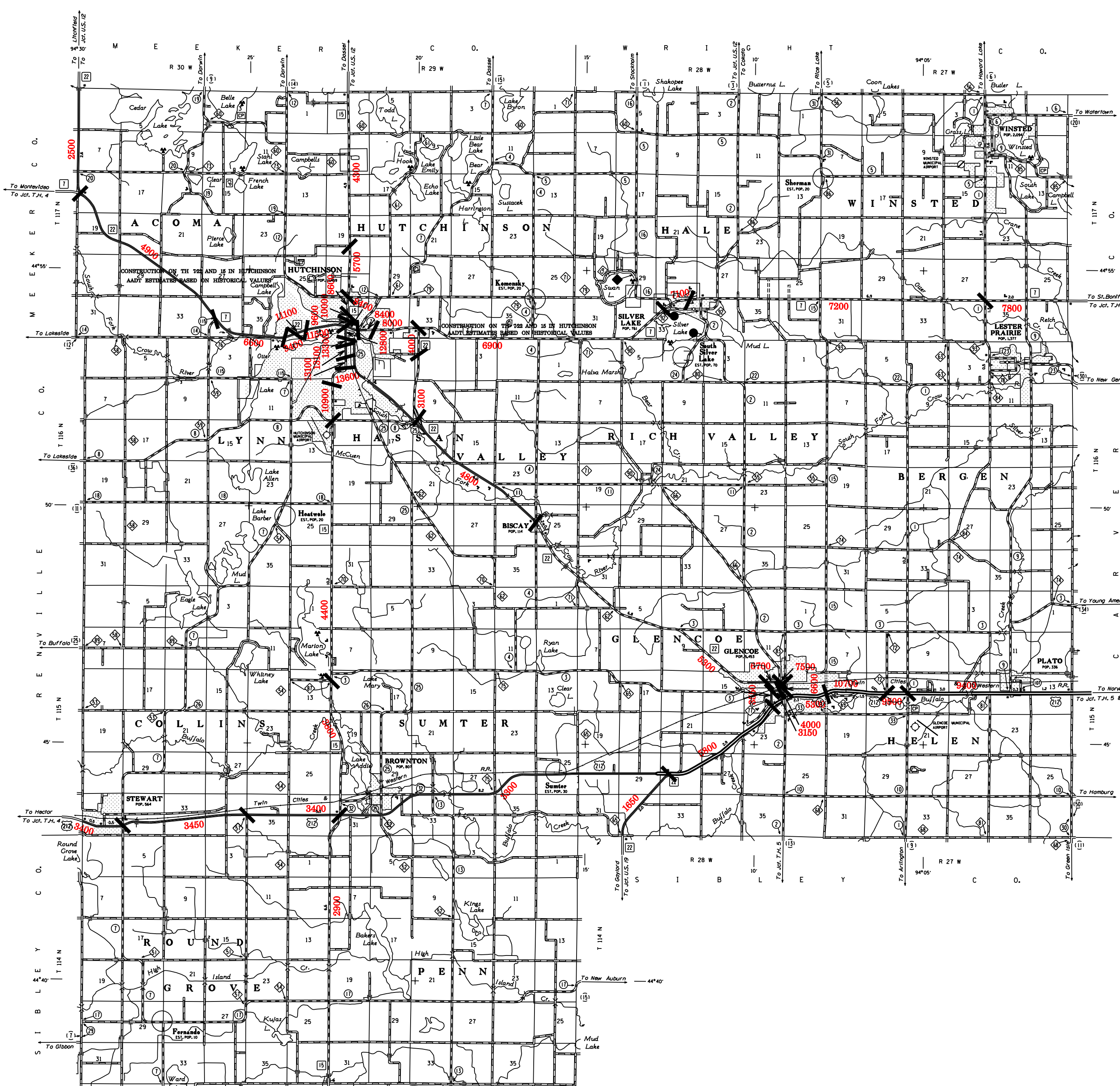

VOLUMES PREPARED BY
 THE OFFICE OF
TRANSPORTATION DATA & ANALYSIS

NUMERALS INDICATE AVERAGE DAILY
 TRAFFIC VOLUMES ON DESIGNATED ROADS.

TRUNK HIGHWAY ROUTES ARE 2006 A.A.T. VOLUMES.

FOR DESIGNATED ROADS:
 / = SEGMENT ENDPOINT FOR ALL
 ROADS INTERSECTED BY HATCH
 (= SEGMENT ENDPOINT ONLY FOR
 ROAD SEPARATED FROM INTERSECTING
 ROAD BY ARC

*NOTE: ALL FEATURES EXCEPT TOWNSHIP ROADS AND
 CULTURE ARE CURRENT AS OF JANUARY 1, 2006.
 NOTE: FOR DETAILS OF COUNTY STATE AND HIGHWAYS AND COUNTY
 ROADS IN INCORPORATED PLACES, SEE MAPS OF MUNICIPALITIES.

