

2006 TRUNK HIGHWAY VOLUMES GENERAL HIGHWAY MAP JACKSON COUNTY MINNESOTA

PREPARED BY THE
MINNESOTA DEPARTMENT OF TRANSPORTATION
OFFICE OF TRANSPORTATION DATA & ANALYSIS
IN COOPERATION WITH
U.S. DEPARTMENT OF TRANSPORTATION
FEDERAL HIGHWAY ADMINISTRATION

SCALE
0 1 2 3 4 MILES
0 1 2 3 4 5 6 KILOMETERS

2006
BASIC DATA - 1977**

Projections: Minnesota Coordinate System
South Zone
Lambert Conformal Conic
North American Datum
of 1983

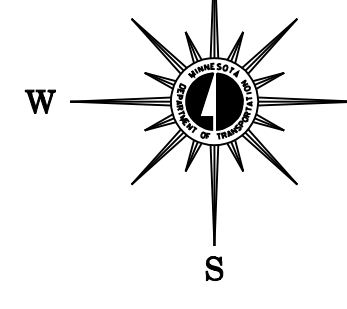

LEGEND

ROAD AND ROADWAY FEATURES

- Paved Road
- Unimproved Road
- Gravel or Stone Road
- Bituminous Road
- Divided Road
- Other Road
- Grade Separation
- Full Traffic Interchange
- Partial Traffic Interchange
- Right-of-Way
- Road System Designations
- Interstate
- State
- County
- Local
- Other

MAINTENANCE

- State
- County
- Local
- Other

STRUCTURES

- Bridge
- Tunnel
- Structure

BOUNDARIES

- National
- State
- County
- Township
- Section
- Range
- Other

DRAINAGE

- Stream
- Drainage

MISCELLANEOUS MAP FEATURES

- City Center
- Other

- Navigation
- Conservation
- Recreation
- Farm and Dwelling Units
- Commercial
- Public Service Facilities
- City Centers
- Miscellaneous Map Features

VOLUMES PREPARED BY
THE OFFICE OF
TRANSPORTATION DATA & ANALYSIS

NUMERALS INDICATE AVERAGE DAILY
TRAFFIC VOLUMES ON DESIGNATED ROADS.

TRUNK HIGHWAY ROUTES ARE 2006 A.D.T. VOLUMES.

FOR DESIGNATED ROADS :
/ = SEGMENT ENDPOINT FOR ALL
ROADS INTERSECTED BY HATCH
(= SEGMENT ENDPOINT ONLY FOR
ROAD SEPARATED FROM INTERSECTING
ROAD BY ARC

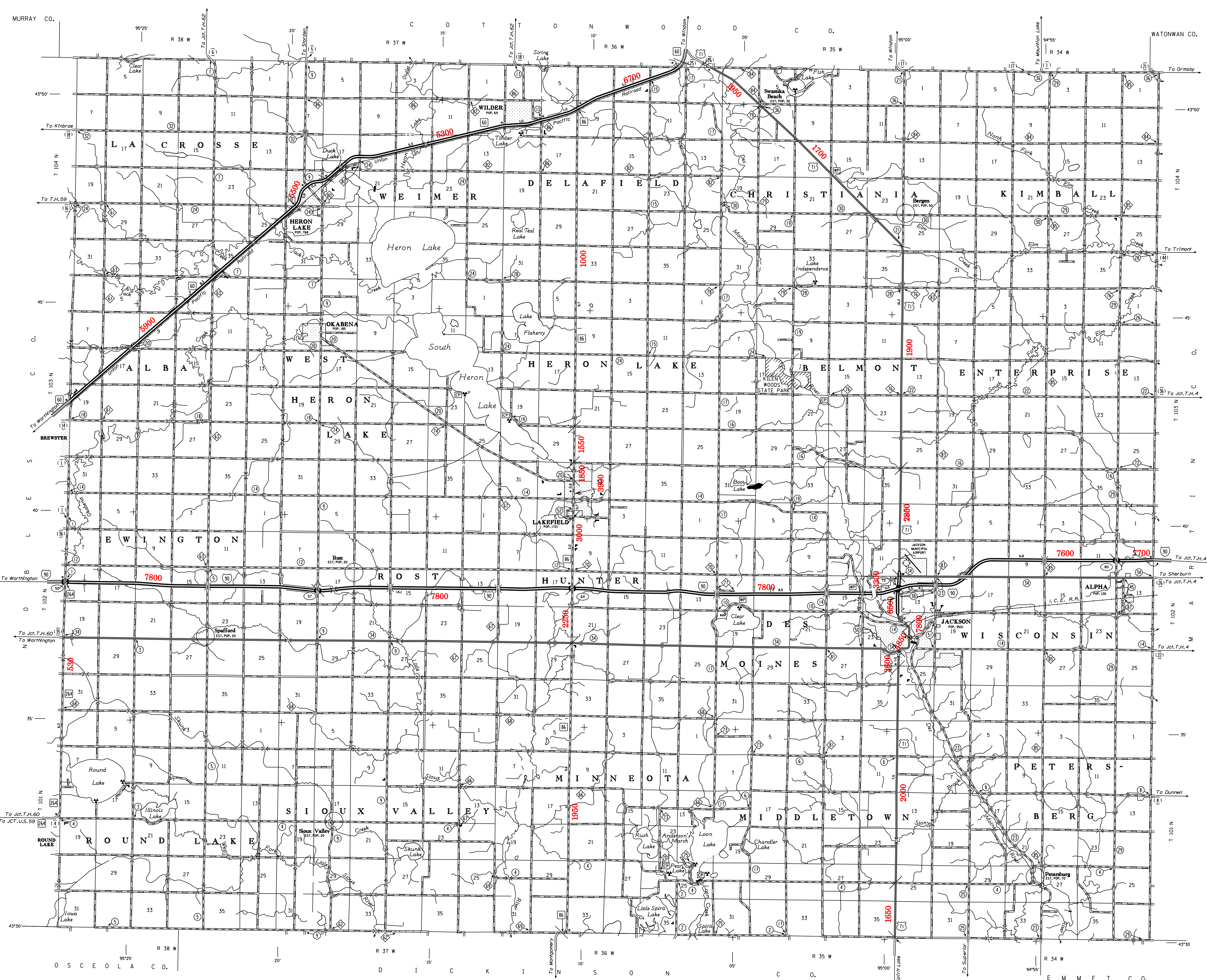

I O W A

NOTE: ALL FEATURES EXCEPT TOWNSHIP ROADS AND
CULTURE ARE CURRENT AS OF JANUARY 1, 2006.
NOTE: FOR DETAIL OF COUNTY STATE AID HIGHWAYS AND COUNTY
ROADS IN INCORPORATED PLACES, SEE MAPS OF MANICIPALITIES.

