

2006 TRUNK HIGHWAY VOLUMES

GENERAL HIGHWAY MAP

ITASCA COUNTY MINNESOTA

PREPARED BY THE MINNESOTA DEPARTMENT OF TRANSPORTATION OFFICE OF TRANSPORTATION DATA & ANALYSIS IN COOPERATION WITH U.S. DEPARTMENT OF TRANSPORTATION FEDERAL HIGHWAY ADMINISTRATION

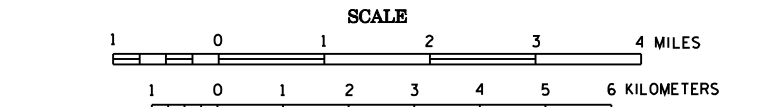

2006 BASIC DATA - 1977

Projection: Minnesota Coordinate System North Zone, Lambert Conformal Conic



LEGEND

Legend table with categories: ROAD AND ROADWAY FEATURES, NAVIGATION, CONSERVATION, RECREATION, FARM AND DWELLING UNITS, INDUSTRIAL, PUBLIC SERVICE FACILITIES, CITY CENTERS, MISCELLANEOUS MAP FEATURES, BOUNDARIES, DRAINAGE.

VOLUMES PREPARED BY THE OFFICE OF TRANSPORTATION DATA & ANALYSIS

NUMERALS INDICATE AVERAGE DAILY TRAFFIC VOLUMES ON DESIGNATED ROADS. TRUNK HIGHWAY ROUTES ARE 2006 A.A.D.T. VOLUMES.

FOR DESIGNATED ROADS: / = SEGMENT ENDPOINT FOR ALL ROADS INTERSECTED BY HATCH (- = SEGMENT ENDPOINT ONLY FOR ROAD SEPARATED FROM INTERSECTING ROAD BY ARC

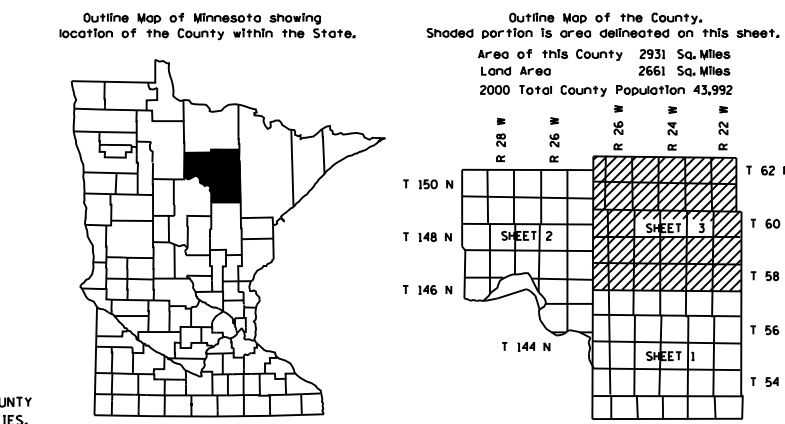
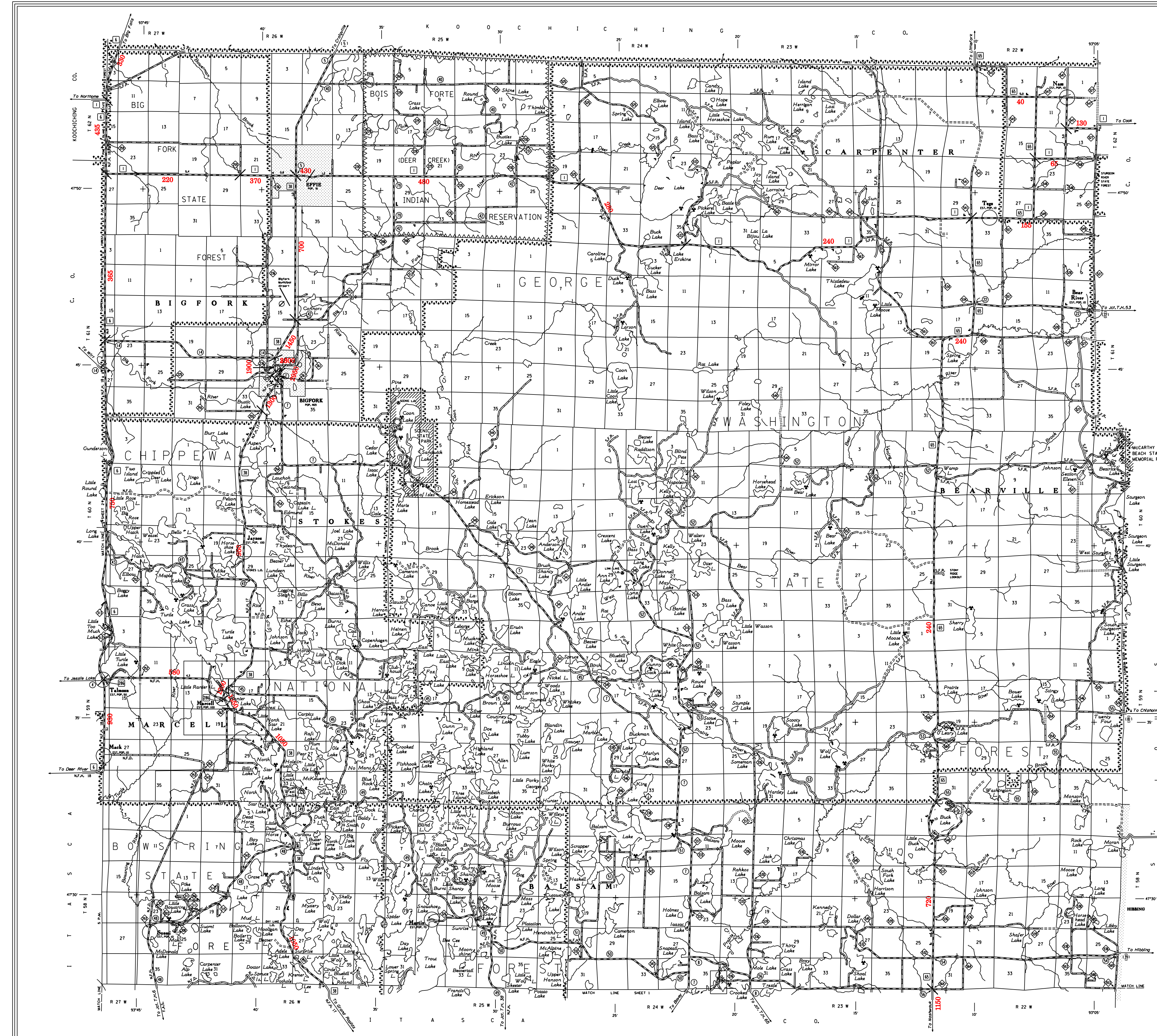

NOTE: ALL FEATURES EXCEPT TOWNSHIP ROADS AND CULTURE ARE CURRENT AS OF JANUARY 1, 2006. NOTE: FOR DETAIL OF COUNTY STATE AID HIGHWAYS AND COUNTY ROADS IN INCORPORATED PLACES, SEE MAPS OF MUNICIPALITIES.