

2006 TRUNK HIGHWAY VOLUMES
GENERAL HIGHWAY MAP
CROW WING COUNTY
MINNESOTA

PREPARED BY THE
MINNESOTA DEPARTMENT OF TRANSPORTATION
OFFICE OF TRANSPORTATION DATA & ANALYSIS
IN COOPERATION WITH
U.S. DEPARTMENT OF TRANSPORTATION
FEDERAL HIGHWAY ADMINISTRATION

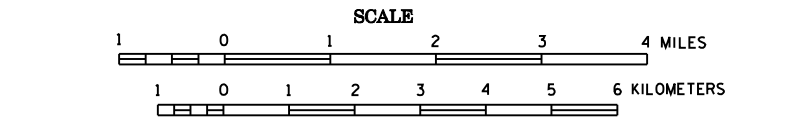

2006
BASIC DATA - 1977
Projection: Minnesota Coordinate System
Central Zone
Lambert Conformal Conic
North American Datum of 1983

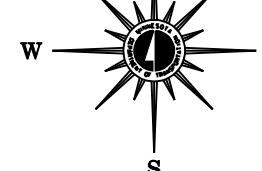

LEGEND

ROAD AND ROADWAY FEATURES	NAVIGATION	CONSERVATION	RECREATION	FARM AND DWELLING UNITS	INDUSTRIAL	PUBLIC SERVICE FACILITIES	STRUCTURES	CITY CENTERS	MISCELLANEOUS MAP FEATURES
PROTECTED ROAD	RAIL LINES ON NATURAL STREAM	STATE PARK	STATE PARK	FARM UNIT	INDUSTRIAL	POST OFFICE	GENERAL STORE	STATE CAPITAL	COUNTY OTHER RELIGIOUS INSTITUTION
PROTECTED ROAD	RAIL LINES ON MAN-MADE CANALS	STATE PARK	STATE PARK	FARM UNIT	INDUSTRIAL	POST OFFICE	GENERAL STORE	STATE CAPITAL	COUNTY OTHER RELIGIOUS INSTITUTION
PROTECTED ROAD	RAIL LINES ON MAN-MADE CANALS	STATE PARK	STATE PARK	FARM UNIT	INDUSTRIAL	POST OFFICE	GENERAL STORE	STATE CAPITAL	COUNTY OTHER RELIGIOUS INSTITUTION

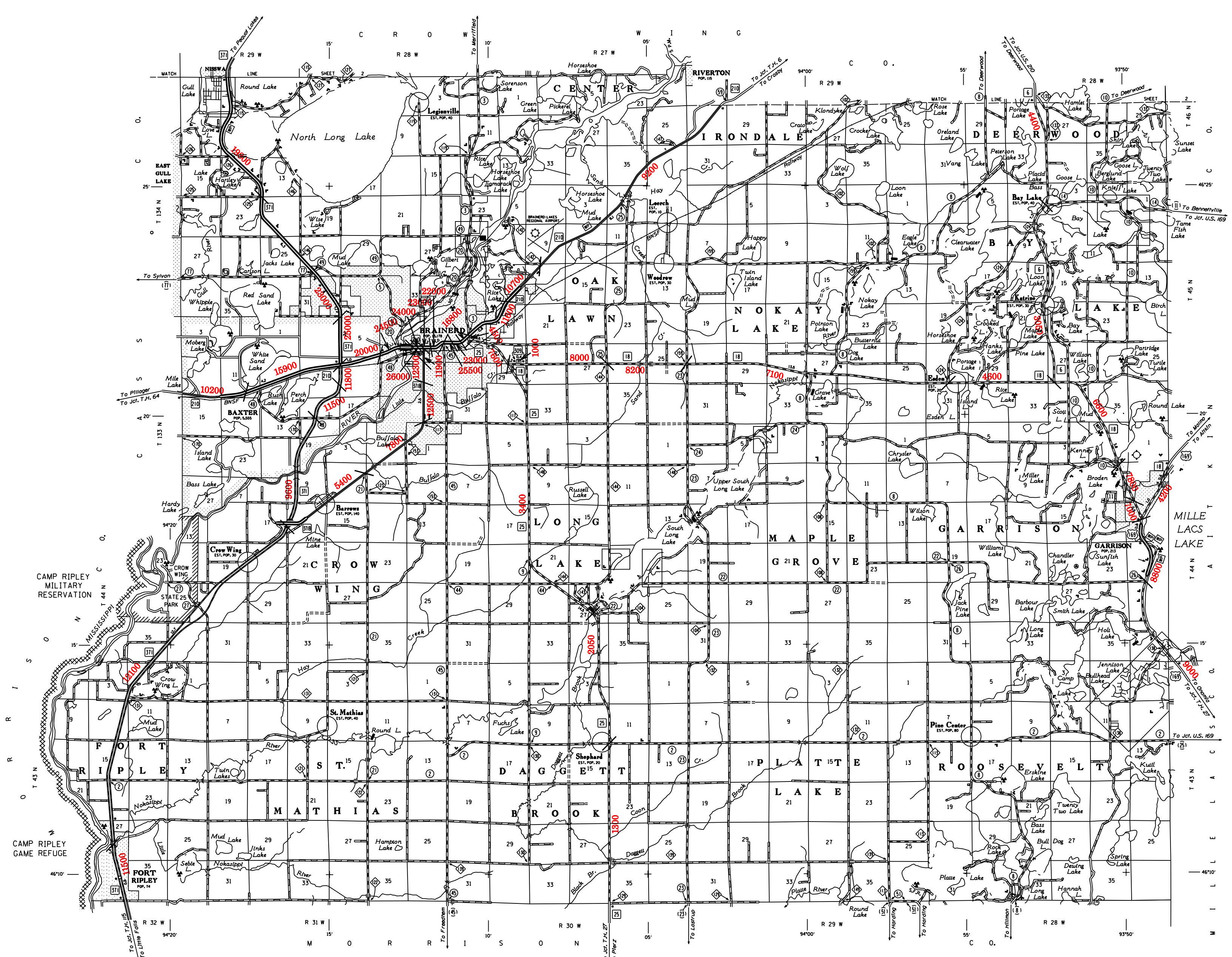

VOLUMES PREPARED BY
THE OFFICE OF
TRANSPORTATION DATA & ANALYSIS

NUMERALS INDICATE AVERAGE DAILY
TRAFFIC VOLUMES ON DESIGNATED ROADS.

TRUNK HIGHWAY ROUTES ARE 2006 A.A.D.T. VOLUMES.

FOR DESIGNATED ROADS :
// = SEGMENT ENDPOINT FOR ALL
ROADS INTERSECTED BY HATCH
(= SEGMENT ENDPOINT ONLY FOR
ROAD SEPARATED FROM INTERSECTING
ROAD BY ARC

NOTE: ALL FEATURES EXCEPT TOWNSHIP ROADS AND
CULTURE ARE CURRENT AS OF JANUARY 1, 2006.
NOTE: FOR DETAIL OF COUNTY STATE AID HIGHWAYS AND COUNTY
ROADS IN INCORPORATED PLACES, SEE MAPS OF MUNICIPALITIES.

