

2006 TRUNK HIGHWAY VOLUMES

GENERAL HIGHWAY MAP

CASS COUNTY MINNESOTA

PREPARED BY THE
MINNESOTA DEPARTMENT OF TRANSPORTATION
OFFICE OF TRANSPORTATION DATA & ANALYSIS
IN COOPERATION WITH
U.S. DEPARTMENT OF TRANSPORTATION
FEDERAL HIGHWAY ADMINISTRATION

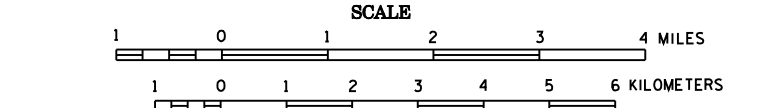

2006
BASIC DATA - 1977*

Projections
Minnesota Coordinate System
Central Zone
Lambert Conformal Conic
North American Datum of 1983

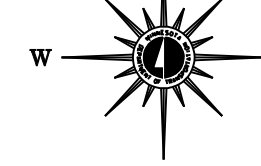

LEGEND

ROAD AND ROADWAY FEATURES	NAVIGATION
PROTECTED ROAD	RAILROADS
UNIMPROVED ROAD	RAILROAD CROSSINGS
GRADED AND GRAVEL ROAD	RAILROAD BRIDGE
GRAVEL ROAD	RAILROAD TRESTLE
STRIPED ROAD	RAILROAD UNDERPASS
ROAD UNDER CONSTRUCTION	RAILROAD UNDER CONSTRUCTION
ROAD OR UNIMPROVED CROSSING	RAILROAD UNDER CONSTRUCTION
ROAD OR UNIMPROVED CROSSING	RAILROAD UNDER CONSTRUCTION
ROAD OR UNIMPROVED CROSSING	RAILROAD UNDER CONSTRUCTION
ROAD OR UNIMPROVED CROSSING	RAILROAD UNDER CONSTRUCTION

VOLUMES PREPARED BY
THE OFFICE OF
TRANSPORTATION DATA & ANALYSIS

NUMERALS INDICATE AVERAGE DAILY
TRAFFIC VOLUMES ON DESIGNATED ROADS.

TRUNK HIGHWAY ROUTES ARE 2006 A.A.D.T. VOLUMES.

FOR DESIGNATED ROADS :
/ = SEGMENT ENDPOINT FOR ALL
ROADS INTERSECTED BY HATCH
(= SEGMENT ENDPOINT ONLY FOR
ROAD SEPARATED FROM INTERSECTING
ROAD BY ARC

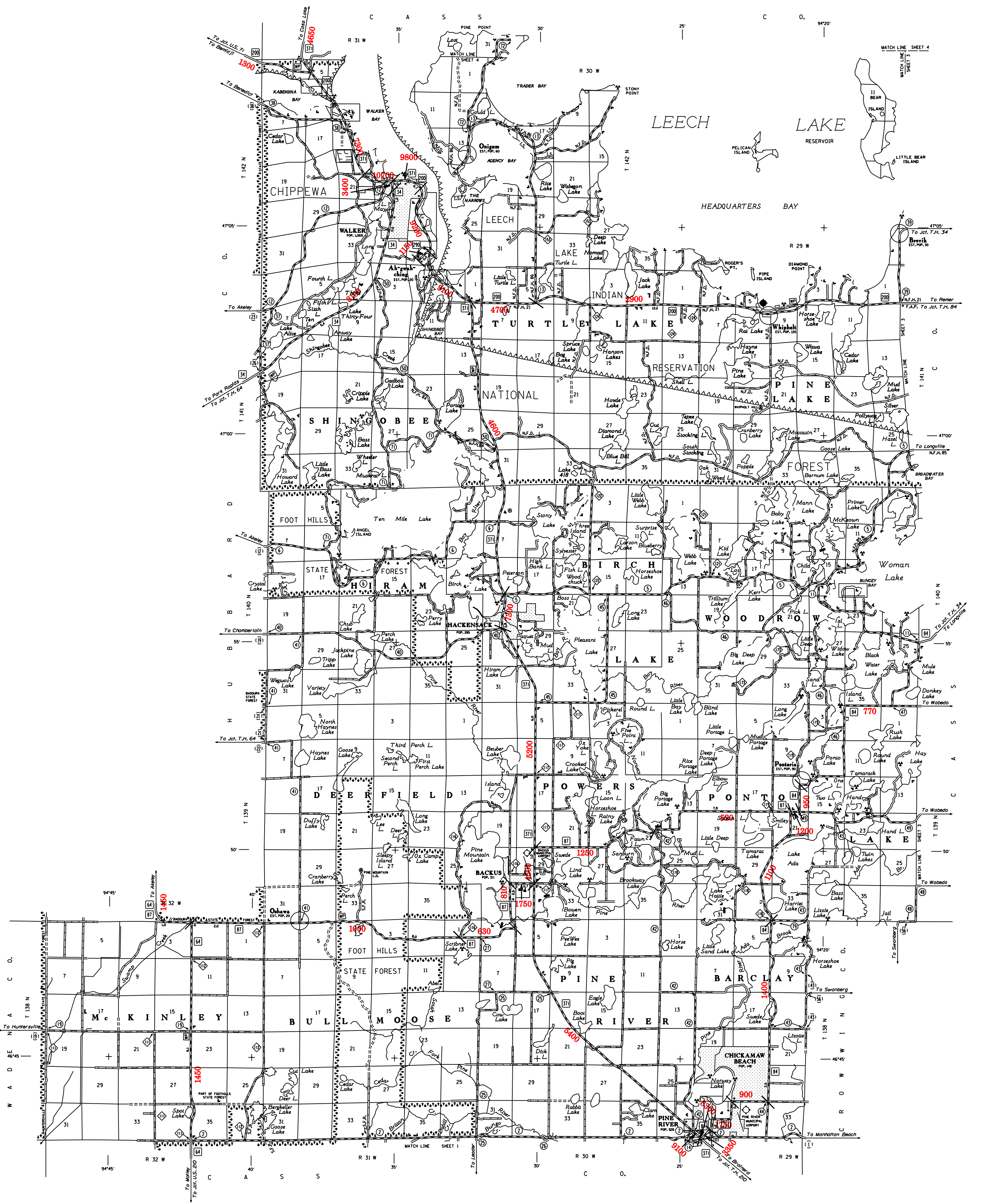
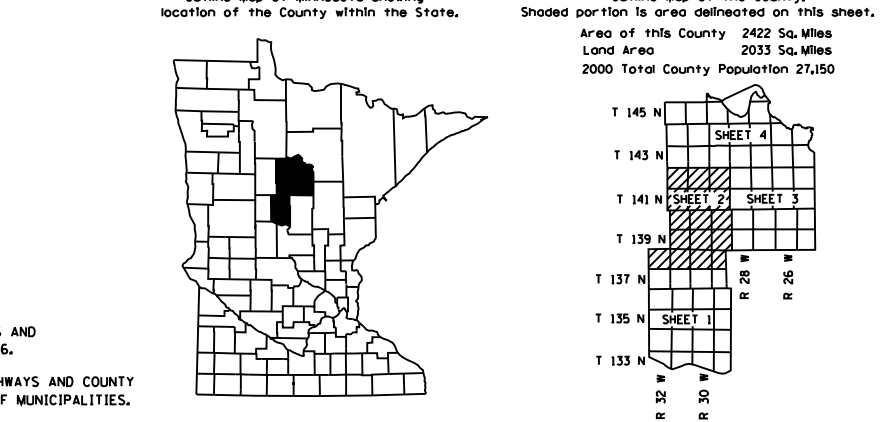

*NOTE: ALL FEATURES EXCEPT TOWNSHIP ROADS AND
COUNTIES ARE CURRENT AS OF JANUARY 1, 2006.
NOTE: FOR DETAILS OF COUNTY STATE AID HIGHWAYS AND COUNTY
ROADS IN INCORPORATED PLACES, SEE MAPS OF MUNICIPALITIES.