

2006 TRUNK HIGHWAY VOLUMES

GENERAL HIGHWAY MAP

CASS COUNTY MINNESOTA

PREPARED BY THE MINNESOTA DEPARTMENT OF TRANSPORTATION OFFICE OF TRANSPORTATION DATA & ANALYSIS

SCALE 1 0 1 2 3 4 MILES 1 0 1 2 3 4 5 6 KILOMETERS

2006 BASIC DATA - 1977* Projection: Minnesota Coordinate System, Lambert Conformal Conic



LEGEND

- ROAD AND ROADWAY FEATURES: Paved road, Private road, Graded and drained road, etc. NAVIGATION: Bridge lines, Ship lines, etc. CONSERVATION: Forest, etc. RECREATION: Golf course, etc. FARM AND DWELLING UNITS: Farm unit, etc. AIRWAYS: Military field, etc. PUBLIC SERVICE FACILITIES: Post office, etc. CITY CENTERS: State capital, etc. MISCELLANEOUS MAP FEATURES: etc.

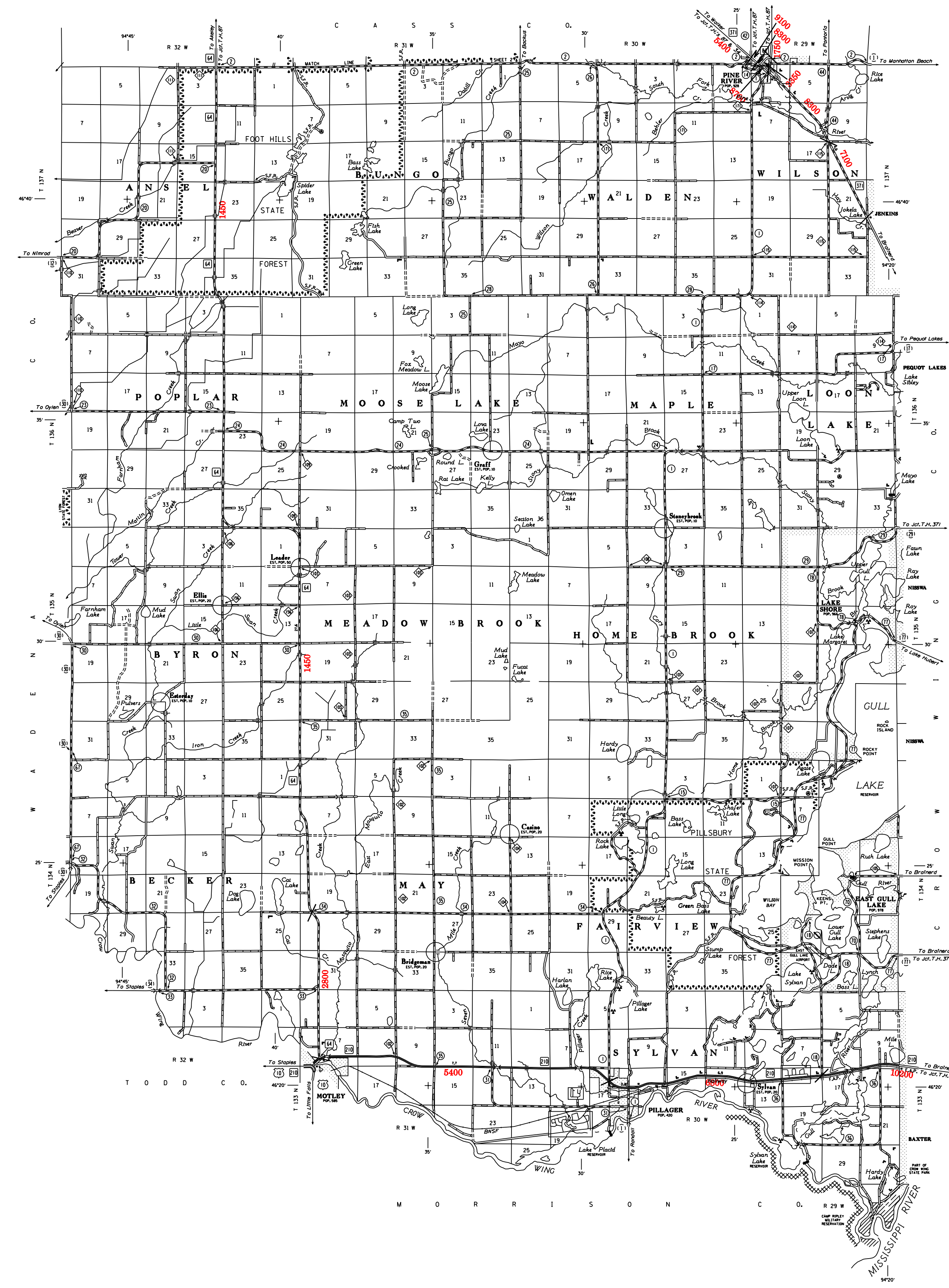

VOLUMES PREPARED BY THE OFFICE OF TRANSPORTATION DATA & ANALYSIS NUMERALS INDICATE AVERAGE DAILY TRAFFIC VOLUMES ON DESIGNATED ROADS. TRUNK HIGHWAY ROUTES ARE 2006 A.A.T.V. VOLUMES.

FOR DESIGNATED ROADS: / = SEGMENT ENDPOINT FOR ALL ROADS INTERSECTED BY HATCH (= SEGMENT ENDPOINT ONLY FOR ROAD SEPARATED FROM INTERSECTING ROAD BY ARC

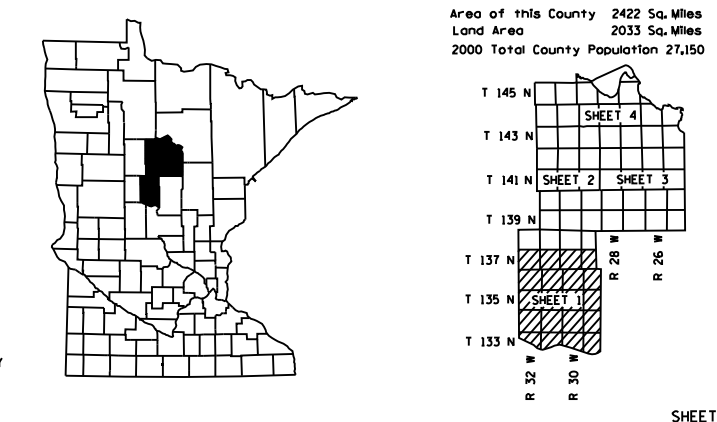

*NOTE: ALL FEATURES EXCEPT TOWNSHIP ROADS AND CULTURE ARE CURRENT AS OF JANUARY 1, 2006.