

2004 TRUNK HIGHWAY VOLUMES
GENERAL HIGHWAY MAP
STEELE
COUNTY
MINNESOTA

PREPARED BY THE
MINNESOTA DEPARTMENT OF TRANSPORTATION
OFFICE OF TRANSPORTATION DATA & ANALYSIS
IN COOPERATION WITH
U.S. DEPARTMENT OF TRANSPORTATION
FEDERAL HIGHWAY ADMINISTRATION

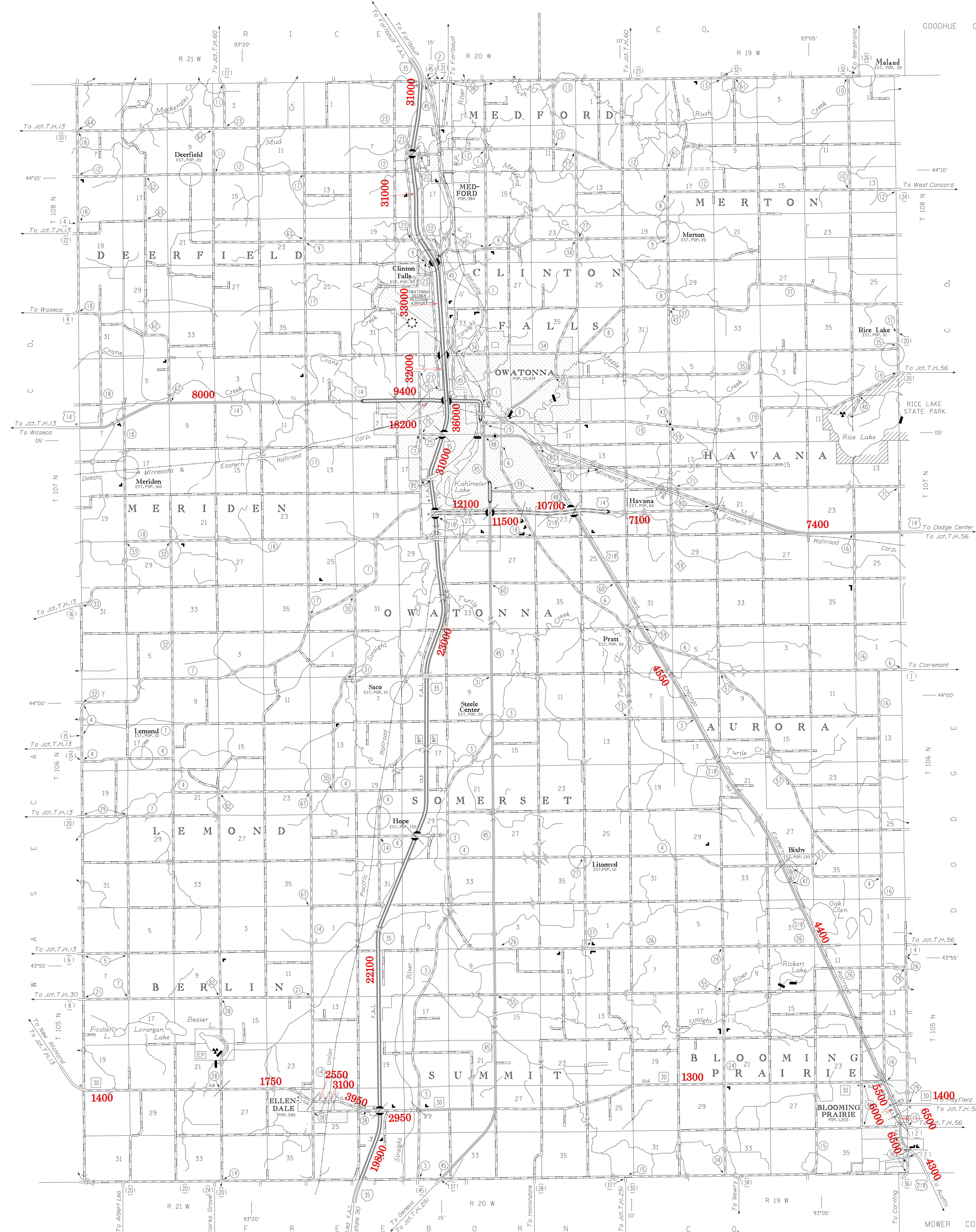
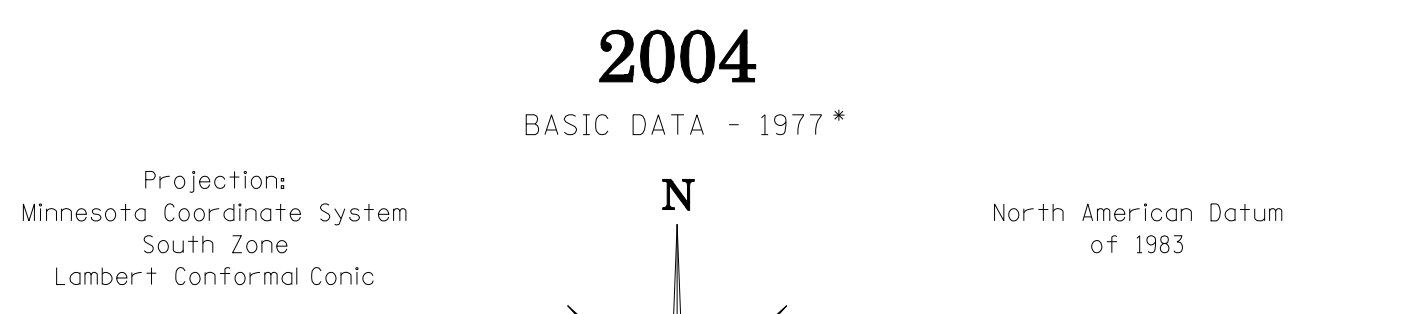
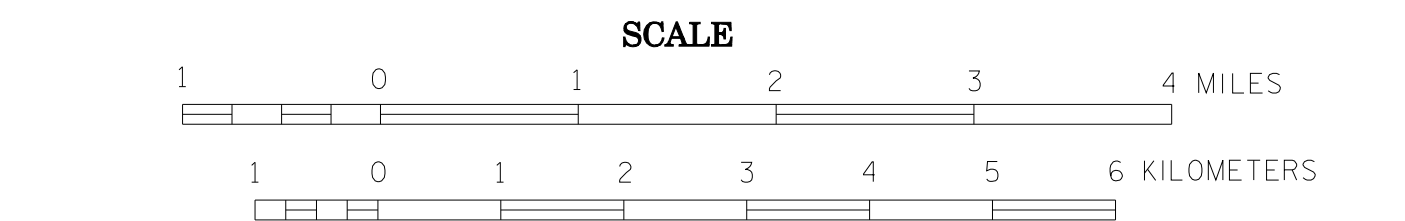

**VOLUMES PREPARED BY
THE OFFICE OF
TRANSPORTATION DATA & ANALYSIS**

**NUMERALS INDICATE AVERAGE DAILY
TRAFFIC VOLUMES ON DESIGNATED ROADS.**

TRUNK HIGHWAY ROUTES ARE 2004 A.A.D.T. VOLUMES.

FOR DESIGNATED ROADS :
/ = SEGMENT ENDPOINT FOR ALL
ROADS INTERSECTED BY HATCH
(= SEGMENT ENDPOINT ONLY FOR
ROAD SEPARATED FROM INTERSECTING
ROAD BY ARC

LEGEND

ROAD AND ROADWAY FEATURES	NAVIGATION
PROPOSED ROAD	DRAINAGE CANALS
PROPOSED ROAD UNDER CONSTRUCTION	DRAINAGE CANALS UNDER CONSTRUCTION
PROPOSED ROAD UNDER CONSTRUCTION - INTERSECTION	DRAINAGE CANALS UNDER CONSTRUCTION - INTERSECTION
PROPOSED ROAD UNDER CONSTRUCTION - ENDPOINT	DRAINAGE CANALS UNDER CONSTRUCTION - ENDPOINT
PROPOSED ROAD UNDER CONSTRUCTION - INTERSECTION	DRAINAGE CANALS UNDER CONSTRUCTION - INTERSECTION
PROPOSED ROAD UNDER CONSTRUCTION - ENDPOINT	DRAINAGE CANALS UNDER CONSTRUCTION - ENDPOINT
PROPOSED ROAD UNDER CONSTRUCTION - INTERSECTION	DRAINAGE CANALS UNDER CONSTRUCTION - INTERSECTION

ROAD SYSTEM DESIGNATIONS

- UNDESIGNED ROAD
- DESIGNED ROAD
- STATE HIGHWAY
- STATE TRUNK HIGHWAY
- STATE HIGHWAY UNDER CONSTRUCTION
- STATE TRUNK HIGHWAY UNDER CONSTRUCTION
- STATE HIGHWAY UNDER CONSTRUCTION - INTERSECTION
- STATE TRUNK HIGHWAY UNDER CONSTRUCTION - INTERSECTION

RAILROADS

- RAILROAD TRACK
- RAILROAD CROSSING
- RAILROAD UNDER CONSTRUCTION

AIRWAYS

- AIRWAY
- AIRWAY UNDER CONSTRUCTION

STRUCTURES

- BRIDGE
- TUNNEL
- VIADUCT
- CANYON WALL
- UNDERPASS

CITY CENTERS

- CITY CENTER
- CITY CENTER - UNINCORPORATED

MISCELLANEOUS MAP FEATURES

- WATER
- WATER UNDER CONSTRUCTION
- LAND
- LAND UNDER CONSTRUCTION
- SETBACK
- SETBACK UNDER CONSTRUCTION
- WIRE
- WIRE UNDER CONSTRUCTION
- ROAD
- ROAD UNDER CONSTRUCTION
- RAILROAD
- RAILROAD UNDER CONSTRUCTION
- AIRWAY
- AIRWAY UNDER CONSTRUCTION
- INDUSTRIAL
- INDUSTRIAL UNDER CONSTRUCTION
- COMMERCIAL
- COMMERCIAL UNDER CONSTRUCTION
- AGRICULTURE
- AGRICULTURE UNDER CONSTRUCTION
- RECREATION
- RECREATION UNDER CONSTRUCTION

*NOT ALL FEATURES EXCEPT TOWNSHIP ROADS AND CULTURE ARE CURRENT AS OF JANUARY 1, 2004.

NOTE: FOR DETAIL OF COUNTY STATE AID HIGHWAYS AND COUNTY ROADS IN INCORPORATED PLACES, SEE MAPS OF MUNICIPALITIES.

