

# 2004 TRUNK HIGHWAY VOLUMES GENERAL HIGHWAY MAP ROCK COUNTY MINNESOTA

PREPARED BY THE  
MINNESOTA DEPARTMENT OF TRANSPORTATION  
OFFICE OF TRANSPORTATION DATA & ANALYSIS  
IN COOPERATION WITH  
U.S. DEPARTMENT OF TRANSPORTATION  
FEDERAL HIGHWAY ADMINISTRATION

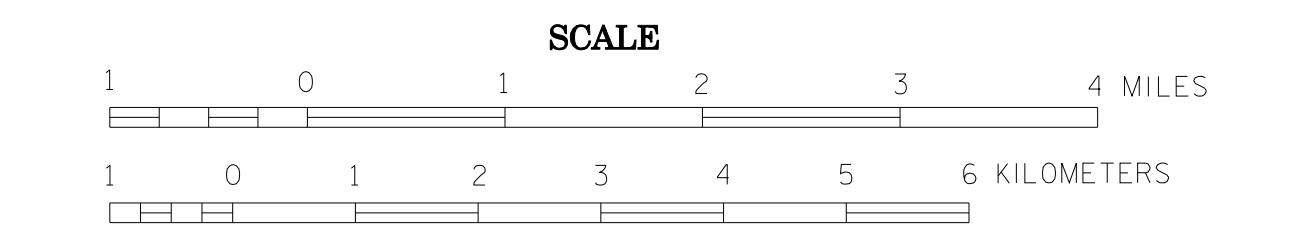

2004  
BASIC DATA - 1977\*

Projection: Minnesota Coordinate System  
South Zone  
Lambert Conformal Conic

Scale: North American Datum of 1983

ROAD AND ROADWAY FEATURES	NAVIGATION
PROTECTED ROAD	RAIL LINES ON NATURAL STREAMS
UNPROTECTED ROAD	RAIL LINES ON ISLAND LINES
MAINTAINED ROAD	RAIL LINES ON LANDING
UNMAINTAINED ROAD	NAVIGABLE STREAM
ROAD	RAIL WITH LOCK
ROAD WITH SIGNAGE	RAIL WITH LIGHTHOUSE
ROAD WITH SIGNAGE AND LIGHTS	RAIL WITH LIGHTHOUSE
ROAD WITH SIGNAGE AND LIGHTS AND TRAFFIC SIGNALS	RAIL WITH LIGHTHOUSE AND TRAFFIC SIGNALS
ROAD WITH SIGNAGE AND LIGHTS AND TRAFFIC SIGNALS AND TRAFFIC SIGNALS	RAIL WITH LIGHTHOUSE AND TRAFFIC SIGNALS AND TRAFFIC SIGNALS
ROAD WITH SIGNAGE AND LIGHTS AND TRAFFIC SIGNALS AND TRAFFIC SIGNALS AND TRAFFIC SIGNALS	RAIL WITH LIGHTHOUSE AND TRAFFIC SIGNALS AND TRAFFIC SIGNALS AND TRAFFIC SIGNALS
ROAD WITH SIGNAGE AND LIGHTS AND TRAFFIC SIGNALS AND TRAFFIC SIGNALS AND TRAFFIC SIGNALS AND TRAFFIC SIGNALS	RAIL WITH LIGHTHOUSE AND TRAFFIC SIGNALS AND TRAFFIC SIGNALS AND TRAFFIC SIGNALS AND TRAFFIC SIGNALS
ROAD WITH SIGNAGE AND LIGHTS AND TRAFFIC SIGNALS AND TRAFFIC SIGNALS AND TRAFFIC SIGNALS AND TRAFFIC SIGNALS AND TRAFFIC SIGNALS	RAIL WITH LIGHTHOUSE AND TRAFFIC SIGNALS AND TRAFFIC SIGNALS AND TRAFFIC SIGNALS AND TRAFFIC SIGNALS AND TRAFFIC SIGNALS

ROAD SYSTEM DESIGNATIONS	RECREATION
INTERNATIONAL TRUNK HIGHWAY	SOFT COURSE OF COUNTRY CLUB
STATE TRUNK HIGHWAY	SOFT COURSE OF COUNTRY CLUB AND GOLF COURSE
COUNTY TRUNK HIGHWAY	SOFT COURSE OF COUNTRY CLUB AND GOLF COURSE AND GOLF COURSE
COUNTY TRUNK HIGHWAY AND COUNTRY TRUNK HIGHWAY	SOFT COURSE OF COUNTRY CLUB AND GOLF COURSE AND GOLF COURSE AND GOLF COURSE
COUNTY TRUNK HIGHWAY AND COUNTRY TRUNK HIGHWAY AND COUNTRY TRUNK HIGHWAY	SOFT COURSE OF COUNTRY CLUB AND GOLF COURSE AND GOLF COURSE AND GOLF COURSE AND GOLF COURSE
COUNTY TRUNK HIGHWAY AND COUNTRY TRUNK HIGHWAY AND COUNTRY TRUNK HIGHWAY AND COUNTRY TRUNK HIGHWAY	SOFT COURSE OF COUNTRY CLUB AND GOLF COURSE AND GOLF COURSE AND GOLF COURSE AND GOLF COURSE AND GOLF COURSE
COUNTY TRUNK HIGHWAY AND COUNTRY TRUNK HIGHWAY AND COUNTRY TRUNK HIGHWAY AND COUNTRY TRUNK HIGHWAY AND COUNTRY TRUNK HIGHWAY	SOFT COURSE OF COUNTRY CLUB AND GOLF COURSE AND GOLF COURSE AND GOLF COURSE AND GOLF COURSE AND GOLF COURSE AND GOLF COURSE
COUNTY TRUNK HIGHWAY AND COUNTRY TRUNK HIGHWAY AND COUNTRY TRUNK HIGHWAY AND COUNTRY TRUNK HIGHWAY AND COUNTRY TRUNK HIGHWAY AND COUNTRY TRUNK HIGHWAY	SOFT COURSE OF COUNTRY CLUB AND GOLF COURSE AND GOLF COURSE AND GOLF COURSE AND GOLF COURSE AND GOLF COURSE AND GOLF COURSE AND GOLF COURSE
COUNTY TRUNK HIGHWAY AND COUNTRY TRUNK HIGHWAY AND COUNTRY TRUNK HIGHWAY AND COUNTRY TRUNK HIGHWAY AND COUNTRY TRUNK HIGHWAY AND COUNTRY TRUNK HIGHWAY AND COUNTRY TRUNK HIGHWAY	SOFT COURSE OF COUNTRY CLUB AND GOLF COURSE AND GOLF COURSE AND GOLF COURSE AND GOLF COURSE AND GOLF COURSE AND GOLF COURSE AND GOLF COURSE AND GOLF COURSE

BOUNDARIES	CITY CENTERS
NATIONAL OR STATE	STATE CAPITAL
COUNTY	COUNTY SEAT
CITY	CITY CENTER
VILLAGE	INCORPORATED CITY CENTER
UNINCORPORATED CITY CENTER	

BOUNDARIES	BOUNDARIES
NATIONAL OR STATE	NATIONAL OR STATE
COUNTY	COUNTY
CITY	CITY
VILLAGE	VILLAGE
UNINCORPORATED CITY CENTER	UNINCORPORATED CITY CENTER

BOUNDARIES	BOUNDARIES
NATIONAL OR STATE	NATIONAL OR STATE
COUNTY	COUNTY
CITY	CITY
VILLAGE	VILLAGE
UNINCORPORATED CITY CENTER	UNINCORPORATED CITY CENTER

BOUNDARIES	BOUNDARIES
NATIONAL OR STATE	NATIONAL OR STATE
COUNTY	COUNTY
CITY	CITY
VILLAGE	VILLAGE
UNINCORPORATED CITY CENTER	UNINCORPORATED CITY CENTER

BOUNDARIES	BOUNDARIES
NATIONAL OR STATE	NATIONAL OR STATE
COUNTY	COUNTY
CITY	CITY
VILLAGE	VILLAGE
UNINCORPORATED CITY CENTER	UNINCORPORATED CITY CENTER

BOUNDARIES	BOUNDARIES
NATIONAL OR STATE	NATIONAL OR STATE
COUNTY	COUNTY
CITY	CITY
VILLAGE	VILLAGE
UNINCORPORATED CITY CENTER	UNINCORPORATED CITY CENTER

BOUNDARIES	BOUNDARIES
NATIONAL OR STATE	NATIONAL OR STATE
COUNTY	COUNTY
CITY	CITY
VILLAGE	VILLAGE
UNINCORPORATED CITY CENTER	UNINCORPORATED CITY CENTER

BOUNDARIES	BOUNDARIES
NATIONAL OR STATE	NATIONAL OR STATE
COUNTY	COUNTY
CITY	CITY
VILLAGE	VILLAGE
UNINCORPORATED CITY CENTER	UNINCORPORATED CITY CENTER

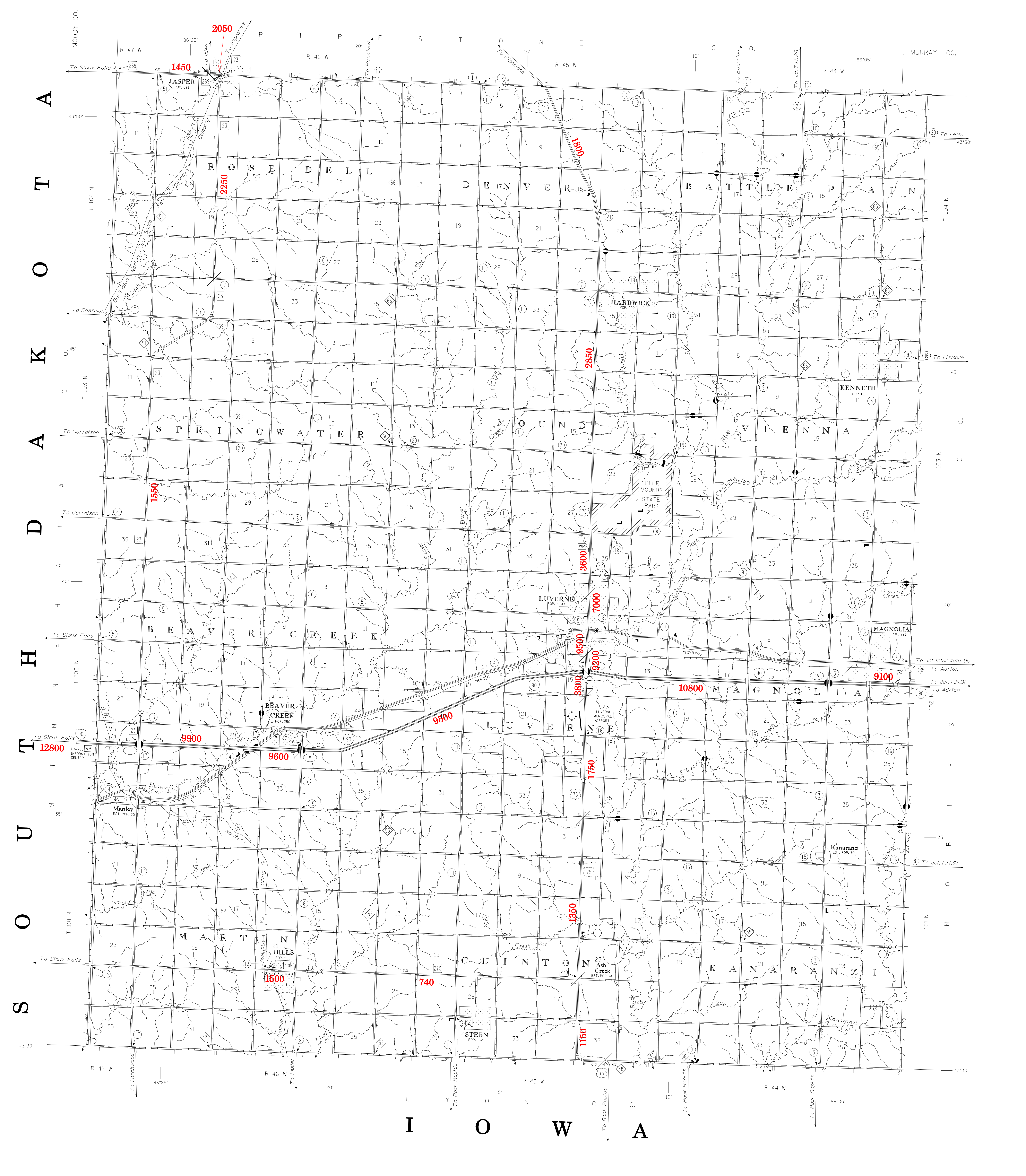

VOLUMES PREPARED BY  
THE OFFICE OF  
TRANSPORTATION DATA & ANALYSIS

NUMERALS INDICATE AVERAGE DAILY  
TRAFFIC VOLUMES ON DESIGNATED ROADS.

**TRUNK HIGHWAY ROUTES ARE 2004 A.A.T.VOLUMES.**

FOR DESIGNATED ROADS :  
// SEGMENT ENDPOINT FOR ALL  
ROADS INTERSECTED BY HATCH  
( = SEGMENT ENDPOINT ONLY FOR  
ROAD SEPARATED FROM INTERSECTING  
ROAD BY ARC

\*NOTE: ALL FEATURES EXCEPT TOWNSHIP ROADS AND  
CITIES ARE CURRENT AS OF JANUARY 1, 2004.

NOTE: FOR DETAIL OF COUNTY STATE AND HIGHWAYS AND COUNTY  
ROADS IN INCORPORATED PLACES, SEE MAPS OF MUNICIPALITIES.

