

# 2004 TRUNK HIGHWAY VOLUMES GENERAL HIGHWAY MAP CASS COUNTY MINNESOTA

PREPARED BY THE  
MINNESOTA DEPARTMENT OF TRANSPORTATION  
OFFICE OF TRANSPORTATION DATA & ANALYSIS  
IN COOPERATION WITH  
U.S. DEPARTMENT OF TRANSPORTATION  
FEDERAL HIGHWAY ADMINISTRATION

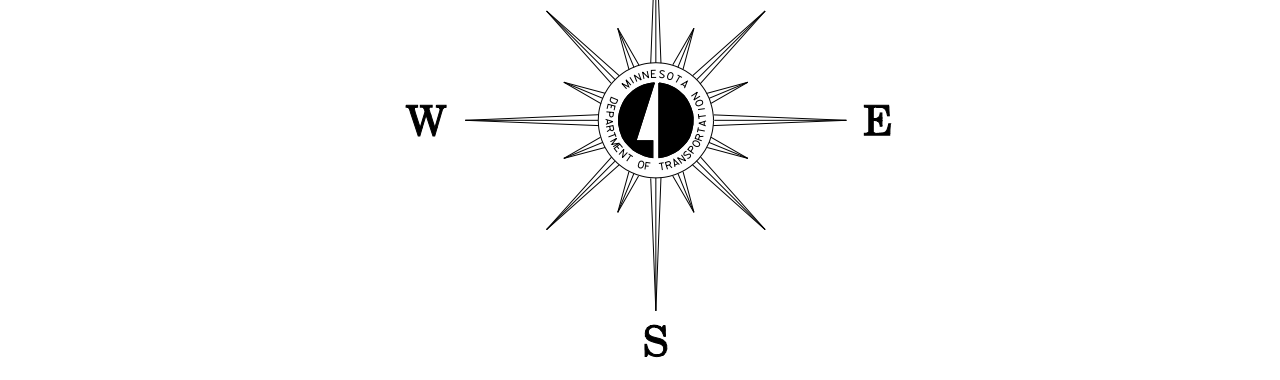

ROAD AND ROADWAY FEATURES	NAVIGATION	CONSERVATION	RECREATION	FARM AND DWELLING UNITS	AIRWAYS	STRUCTURES	BOUNDARIES	DRAINAGE	COMMERCIAL	PUBLIC SERVICE FACILITIES	CITY CENTERS	MISCELLANEOUS MAP FEATURES
FRONTIER ROAD	RAIL LINES ON NATIONAL TRAIL	RAILROADS	STATE OF MINNESOTA	FARM UNIT	STAGE OR SMALL BUSINESS ESTABLISHMENT	STREET CAPITAL	NATIONAL, STATE, COUNTY, CITY, AND TOWNSHIP	SEGMENTED STREAM	HOTEL	POST OFFICE	CITY CENTER	COUNTY, STATE, AND FEDERAL
COMPLETED ROAD	SHIP LINES ON LAKE LINES	RAILROADS	STATE OF MINNESOTA	INDUSTRIAL	STAGE OR SMALL BUSINESS ESTABLISHMENT	CITY CENTER	NATIONAL, STATE, COUNTY, CITY, AND TOWNSHIP	PERMANENT STREAM	RESTAURANT	POST OFFICE	CITY CENTER	COUNTY, STATE, AND FEDERAL
UNCOMPLETED ROAD	SHIP LINES ON LAKE LINES	RAILROADS	STATE OF MINNESOTA	INDUSTRIAL	STAGE OR SMALL BUSINESS ESTABLISHMENT	CITY CENTER	NATIONAL, STATE, COUNTY, CITY, AND TOWNSHIP	PERMANENT STREAM	RESTAURANT	POST OFFICE	CITY CENTER	COUNTY, STATE, AND FEDERAL
UNCOMPLETED ROAD	SHIP LINES ON LAKE LINES	RAILROADS	STATE OF MINNESOTA	INDUSTRIAL	STAGE OR SMALL BUSINESS ESTABLISHMENT	CITY CENTER	NATIONAL, STATE, COUNTY, CITY, AND TOWNSHIP	PERMANENT STREAM	RESTAURANT	POST OFFICE	CITY CENTER	COUNTY, STATE, AND FEDERAL

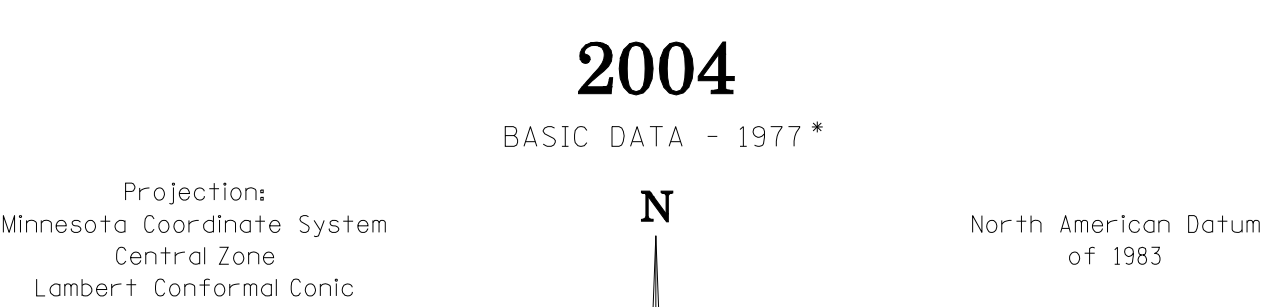
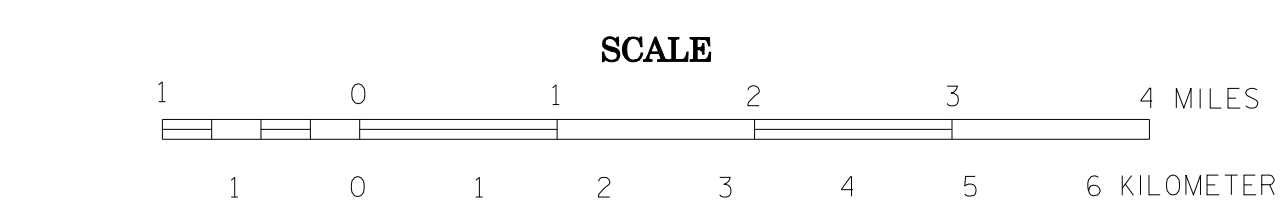
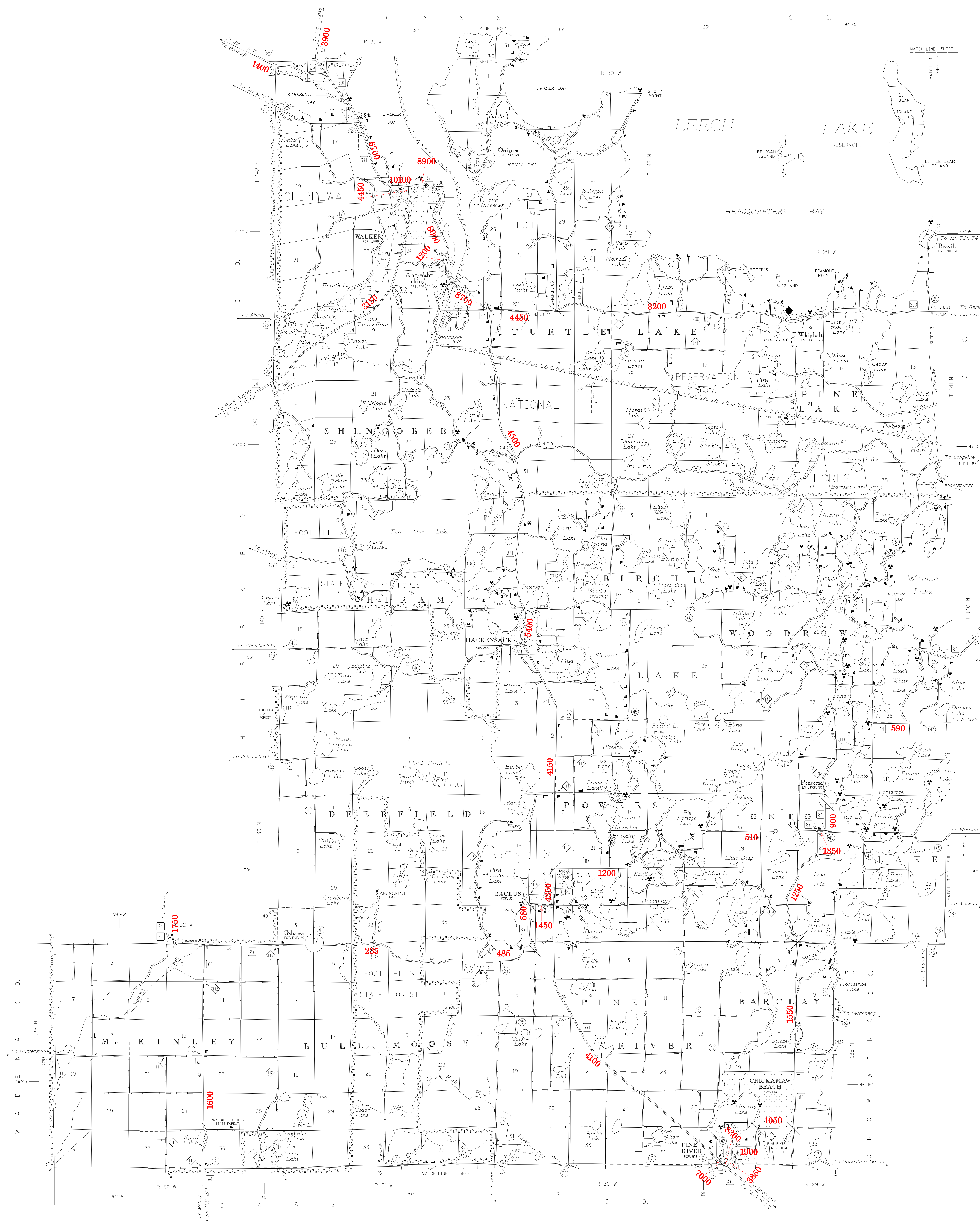

VOLUMES PREPARED BY  
THE OFFICE OF  
TRANSPORTATION DATA & ANALYSIS

NUMERALS INDICATE AVERAGE DAILY  
TRAFFIC VOLUMES ON DESIGNATED ROADS.

TRUNK HIGHWAY ROUTES ARE 2004 A.A.D.T. VOLUMES.

FOR DESIGNATED ROADS :  
/ = SEGMENT ENDPOINT FOR ALL  
ROADS INTERSECTED BY HATCH  
( = SEGMENT ENDPOINT ONLY FOR  
ROAD SEPARATED FROM INTERSECTING  
ROAD BY ARC

\*NOTE: ALL FEATURES EXCEPT TOWNSHIP ROADS AND  
CULTURE ARE CURRENT AS OF JANUARY 1, 2004.  
NOTE: FOR DETAIL OF COUNTY STATE AND HIGHWAYS AND COUNTY  
ROADS IN INCORPORATED PLACES, SEE MAPS OF MUNICIPALITIES.

