

MUNICIPALITY OF
NORTH MANKATO

PREPARED BY THE
MINNESOTA DEPARTMENT OF TRANSPORTATION
PROGRAM SUPPORT GROUP
IN COOPERATION WITH
U.S. DEPARTMENT OF TRANSPORTATION
FEDERAL HIGHWAY ADMINISTRATION

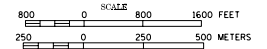

2002
BASIC DATA - 1991

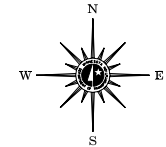

LEGEND

- INTERSTATE TRUNK HIGHWAY.....(I)
- U.S. TRUNK HIGHWAY.....(U)
- STATE TRUNK HIGHWAY.....(S)
- COUNTY STATE AID HIGHWAY.....(C)
- COUNTY ROAD.....(R)
- CORPORATE LIMITS.....(L)
- PUBLIC ROAD.....(P)
- PRIVATE ROAD.....(PR)

**MUNICIPAL STATE AID
STREET SYSTEM**

LEGEND

- MUNICIPAL COUNTY STATE AID STREET.....(M)
- MUNICIPAL STATE AID STREET.....(MS)
- COUNTY STATE AID HIGHWAY.....(CS)
- COUNTY ROAD.....(CR)
- TRUNK HIGHWAY.....(TH)

VOLUMES PREPARED BY
THE OFFICE OF
TRANSPORTATION DATA & ANALYSIS

NUMERALS INDICATE AVERAGE DAILY
TRAFFIC VOLUMES ON DESIGNATED ROADS

FOR DESIGNATED ROADS :
/ - SEGMENT ENDPOINT FOR ALL
ROADS INTERSECTED BY HATCH
(= SEGMENT ENDPOINT ONLY FOR
ROAD SEPARATED FROM INTERSECTING
ROAD BY ARC

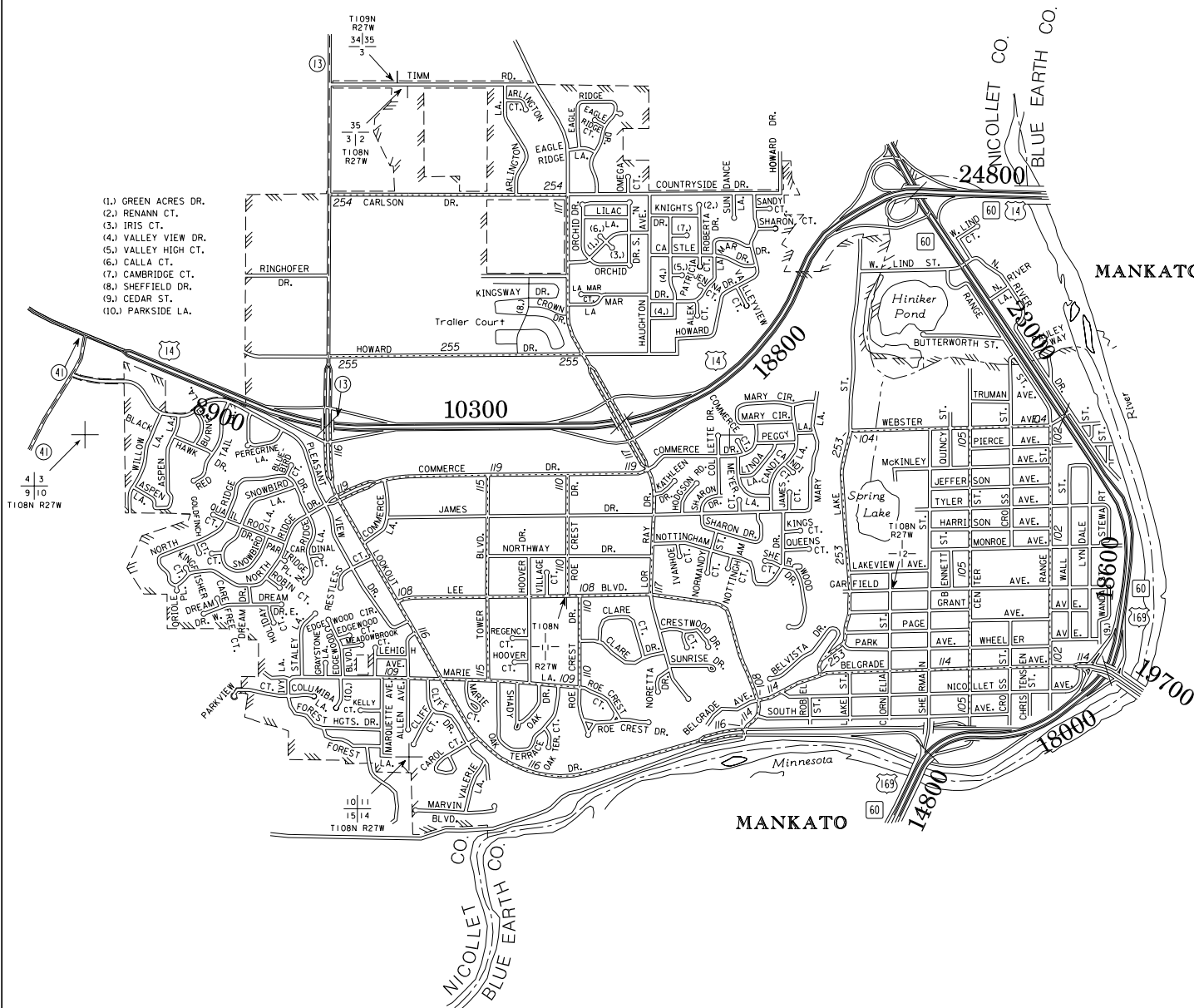

- (1.) GREEN ACRES DR.
- (2.) RENANN CT.
- (3.) IRIS CT.
- (4.) VALLEY VIEW DR.
- (5.) VALLEY HIGH CT.
- (6.) CALLA CT.
- (7.) CAMBRIDGE CT.
- (8.) SHEFFIELD DR.
- (9.) CEDAR ST.
- (10.) PARKSIDE LA.