

2000 TRUNK HIGHWAY VOLUMES

MUNICIPALITY OF
WORTHINGTON

PREPARED BY THE
MINNESOTA DEPARTMENT OF TRANSPORTATION
PROGRAM SUPPORT GROUP
IN COOPERATION WITH
U.S. DEPARTMENT OF TRANSPORTATION
FEDERAL HIGHWAY ADMINISTRATION

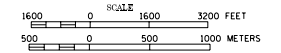

2000
BASIC DATA - 1977

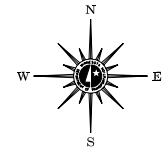

LEGEND

- INTERSTATE TRUNK HIGHWAY..... (I)
- U.S. TRUNK HIGHWAY..... (SH)
- STATE TRUNK HIGHWAY..... (SH)
- COUNTY STATE AID HIGHWAY..... (CSA)
- COUNTY ROAD..... (CR)
- CORPORATE LIMITS..... (---)
- PUBLIC ROAD..... (—)
- PRIVATE ROAD..... (—)

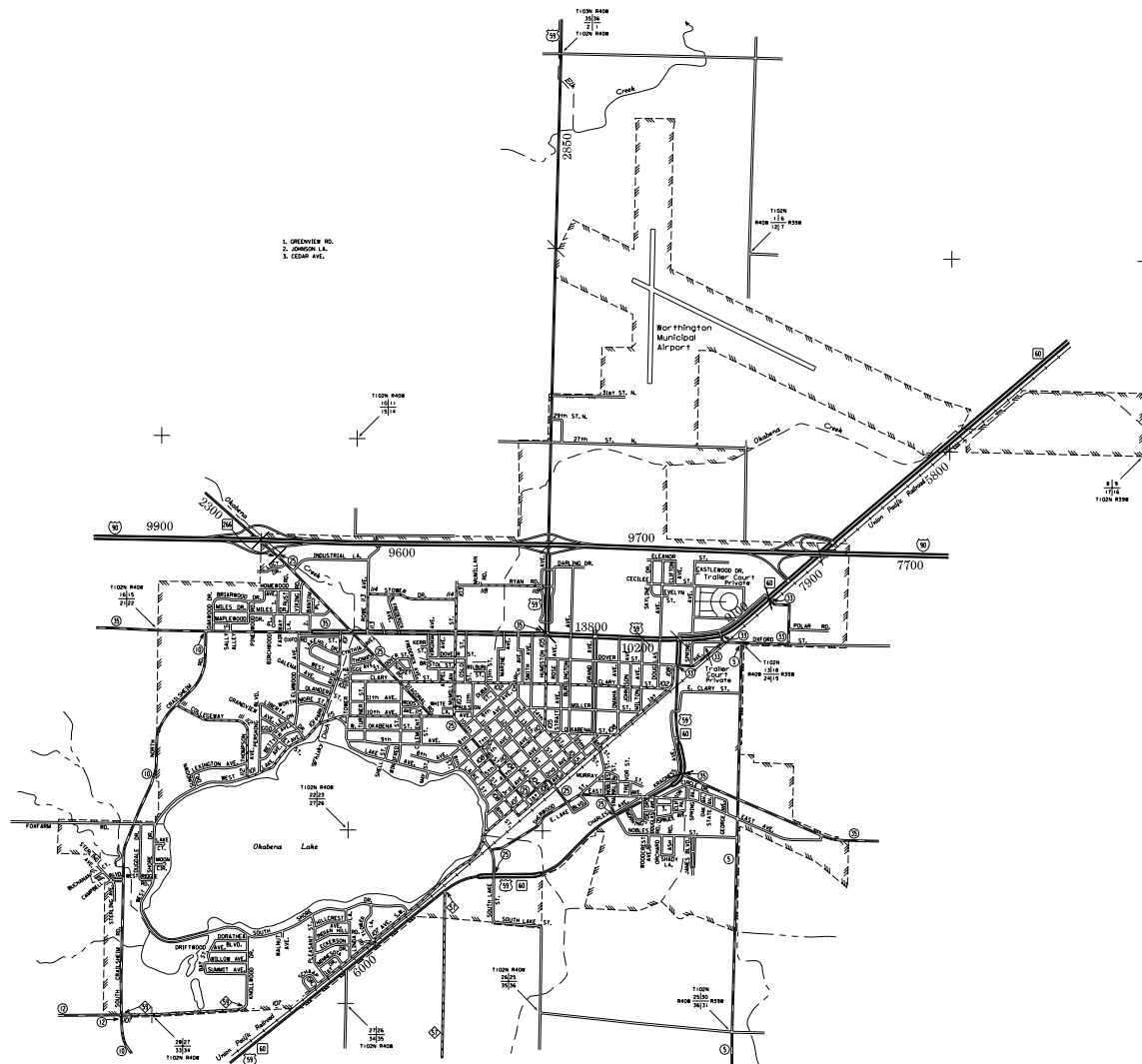

- 1. GREENVIEW RD.
- 2. JOHNSON LA.
- 3. CEDAR AVE.

**MUNICIPAL STATE AID
STREET SYSTEM**

LEGEND

- MUNICIPAL COUNTY STATE AID STREET..... (—)
- MUNICIPAL STATE AID STREET..... (—)
- COUNTY STATE AID HIGHWAY..... (—)
- COUNTY ROAD..... (—)
- TRUNK HIGHWAY..... (—)

VOLUMES PREPARED BY
THE OFFICE OF
TRANSPORTATION DATA & ANALYSIS

NUMERALS INDICATE AVERAGE DAILY
TRAFFIC VOLUMES ON DESIGNATED ROADS

FOR DESIGNATED ROADS :
/ = SEGMENT ENDPOINT FOR ALL
ROADS INTERSECTED BY HATCH
(= SEGMENT ENDPOINT ONLY FOR
ROAD SEPARATED FROM INTERSECTING
ROAD BY ARC