

2008 TRAFFIC VOLUMES GENERAL HIGHWAY MAP LINCOLN COUNTY MINNESOTA

PREPARED BY THE
MINNESOTA DEPARTMENT OF TRANSPORTATION
OFFICE OF TRANSPORTATION DATA & ANALYSIS
IN COOPERATION WITH
U.S. DEPARTMENT OF TRANSPORTATION
FEDERAL HIGHWAY ADMINISTRATION

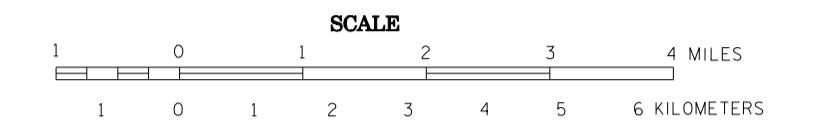

2008
BASIC DATA - 1977*

Projections
Minnesota Coordinate System
South Zone
Lambert Conformal Conic

North American Datum
of 1983

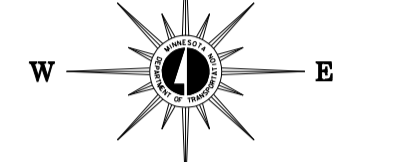

LEGEND

| ROAD AND ROADWAY FEATURES | NAVIGATION |
|--|------------------------------|
| PROJECTED ROAD | RAIL LINES ON NEARBY STREAMS |
| UNIMPROVED ROAD | SHIP LINES ON INLAND LAKES |
| GRAVEL OR GRAVEL ROAD | BOATPIER OR LANDING |
| SOIL SURFACE ROAD | BOAT WITH LOCK |
| GRAVEL OR STONE ROAD | NAVIGABLE STREAM |
| BITUMINOUS ROAD | LANDMARK LIGHT BEACON |
| PAVED ROAD | LIGHTHOUSE |
| ROAD UNDER CONSTRUCTION | |
| ROADS IN LONG-TERM CONTRACT | |
| EXTENSIONS OF LOCAL LINES NOT | |
| PAID BY MUNICIPALITIES AND | |
| PRIVATE ROADS | |
| POINTS BETWEEN WHICH DISTANCES | |
| ARE MEASURED INDICATED THIS | |
| GRADE SEPARATION | |
| FULL TRAFFIC INTERCHANGE | |
| PARTIAL TRAFFIC INTERCHANGES | |
| INDICATING TRAFFIC WORKINGS | |
| ROAD SYSTEM DESIGNATIONS | |
| INTERSTATE TRUNK HIGHWAY | |
| U.S. NUMBERED TRUNK HIGHWAY | |
| STATE NUMBERED TRUNK HIGHWAY | |
| COUNTY STATE AID HIGHWAY | |
| COUNTY STATE AID IN | |
| CONSTRUCTION ROAD | |
| TERMINATION OF DESIGNATED ROAD | |
| INTERSTATE EXIT | |
| GREAT RIVER ROAD | |
| FEDERAL AID INTERSTATE SYSTEM | |
| NATIONAL FOREST HIGHWAY | |
| NATIONAL FOREST HIGHWAY | |
| INDIAN SERVICE ROAD | |
| STATE PARK ROAD | |
| RAILROADS | |
| RAILROADS RUN BY INDIVIDUALS OR BY A SINGLE | |
| OPERATING COMPANY OR BY TRAINS OF ANOTHER | |
| CORPORATE UNDER PREVIOUS RIGHTS | |
| RAILROADS IN AUTHORITY OF TWO OR MORE TRAINS | |
| OR SEPARATELY OPERATED COMPANIES ON | |
| ADJACENT RIGHTS OF WAY | |
| RAILROAD STATION | |
| GRADE CROSSING | |
| UNDESIGNED HIGHWAY BELIEVED | |
| OVERPASS HIGHWAY BRIDGE | |
| AIRWAYS | |
| MILITARY FIELD | |
| COMMERCIAL OR MUNICIPAL FIELD | |
| COMPLETE FACILITIES | |
| LIMITED FACILITIES | |
| LANDING AREA OR STRIP | |
| SCALEWAY BASE | |
| AIRWAY LIGHT BEACON/GENERAL | |
| RADIO RANGE STATION | |
| STRUCTURES | |
| GENERAL SYMBOLS UNDER 20' SPAN | |
| PROTECTION BRIDGE | |
| Other Structures | |
| DAW WITH ROAD LARGE SCALE | |
| DAW WITH ROAD SMALL SCALE | |
| DAW WITHOUT ROAD LARGE SCALE | |
| DAW WITHOUT ROAD SMALL SCALE | |
| LEVEE OR DIRT | |
| LEVEE OR DIRT WITH ROAD | |
| WOOD STRUCTURES 6" TO 20' SPAN | |
| CONCRETE FORD OR SIP | |
| FOOD - ROAD ESTABLISHED | |
| BOUNDARIES | |
| NATIONAL OR STATE | |
| COUNTY | |
| CONGRESSIONAL TOWNSHIP U.S. LAND | |
| CORPORATE LINE | |
| SECTION LINE | |
| CONGESTED AREA | |
| NATIONAL OR STATE PARK | |
| NATIONAL OR STATE FOREST | |
| INDIAN RESERVATION | |
| GAME REFUGE | |
| ADJUTANT | |
| WILDLIFE MANAGEMENT AREA (STATE OR | |
| NATURAL AREA FEDERAL) | |
| WICH LINE BETWEEN ADJOINING SHEETS | |
| OF THE SAME COUNTY | |
| DRAINAGE | |
| INTERMITTENT STREAM | |
| NARROW STREAM | |
| WIDE STREAM | |
| WATER OR DAMFILL | |
| DRAINAGE STOP | |
| LAKE OR POND | |
| NAVIGATION | |
| RAIL LINES ON NEARBY STREAMS | |
| SHIP LINES ON INLAND LAKES | |
| BOATPIER OR LANDING | |
| BOAT WITH LOCK | |
| NAVIGABLE STREAM | |
| LANDMARK LIGHT BEACON | |
| LIGHTHOUSE | |
| CONSERVATION | |
| FOREST RANGER STATION | |
| GAZEBO OR BENCH STATION | |
| NOT PERMANENTLY OCCUPIED | |
| FISH WAREHOUSE | |
| GAME PRESERVE | |
| SEPARATION OR LOOKOUT TOWER | |
| MINIMUM ELEVATION | |
| SMALL POND OF STILL OR SLIGHTLY | |
| PERMANENT FLOW | |
| WATER | |
| MANIPULATED WATERWAY | |
| PUBLIC ACCESS POINT | |
| RECREATION | |
| GOLF COURSE OR COUNTRY CLUB | |
| SWIMMING | |
| ATHLETIC FIELD | |
| BEACH | |
| PUBLIC GROUND | |
| PLAYGROUND/BALLFIELD/ETC. | |
| BATHING BEACH OR SWIMMING POOL | |
| SCENE SITE | |
| CAMP OR LODGE | |
| FARM AND DWELLING UNITS | |
| FARM UNIT | |
| BARNS OR OTHER THAN FARM | |
| BARNS OR DWELLINGS FOR STUDENTS, | |
| WORKERS, WORKERS, ETC. | |
| SEASONAL DWELLING | |
| HOUSE OR GROUP OF HOUSES CLOSELY SPACED | |
| NUMBER ADJUSTED TO SHOW | |
| INDICATED NUMBER OF HOUSES | |
| GET NAME FROM THE LEGEND TO INDICATE | |
| LOCATION OF ANY CULTURAL FEATURE | |
| SHOW OUT OF POSITION | |
| INDUSTRIAL | |
| FACTORY OR INDUSTRIAL PLANT | |
| LIQUOR | |
| STORAGE TANKS, OIL OR GAS | |
| BEET SUGAR | |
| STEEL | |
| QUARTY | |
| STOCKYARD/FEEDLOT | |
| WEEKLY/RESIDENCY OR CHEESE FACTORY | |
| WAREHOUSE | |
| COMMERCIAL | |
| STORE OR SMALL BUSINESS ESTABLISHMENT | |
| HOTEL | |
| THEATRE | |
| RESTAURANT | |
| BARBERSHOP | |
| GREENHOUSE | |
| PUBLIC SERVICE FACILITIES | |
| POST OFFICE | |
| FIRE STATION | |
| MUSEUM | |
| PUBLIC LIBRARY | |
| LANDLORD POINT OF ENTRY | |
| RADIO STATION | |
| SEWAGE DISPOSAL PLANT | |
| NURSING HOME | |
| HOSPITAL | |
| CORRECTIONAL INSTITUTION | |
| CITY CENTERS | |
| STATE CAPITAL | |
| COUNTY SEAT | |
| CITY CENTER | |
| INCORPORATED CITY GENERALIZED | |
| UNINCORPORATED COMMUNITY | |
| MISCELLANEOUS MAP FEATURES | |
| CHAPEL/OTHER RELIGIOUS INSTITUTIONS | |
| CHURCH WITH CEMETERY ADJACENT | |
| PERSONAL-RIDE COURSE/STREET | |
| MOVEMENT CHANNEL | |
| GRANDS PIT | |
| GRAVEL SAND OR WASTEWATER POND | |
| ASPHALT DRIVE | |
| STONE OR CONCRETE DRIVE | |
| STONE OR CONCRETE DRIVE | |
| STATE PATROL SUBSTATION | |
| DEPARTMENT OF TRANSPORTATION DISTRICT OFFICE | |
| FILL HOUSE STATE POINT OF ENTRY OR | |
| WELL EXISTING | |
| NATURAL GAS/PETROLEUM PRODUCTS | |
| PIPELINE NATURAL GAS | |
| PIPELINE PETROLEUM PRODUCTS | |
| PIPELINE WATER | |
| TRANSMISSION LINE OVER OR UNDER | |
| POWER PLANT | |
| TRANSFORMER STATION | |
| TRANSFORMER STATION | |
| TRANSFORMER STATION | |
| LATITUDE AND LONGITUDE INTERSECTION | |
| HISTORIC SITE/STATE OR NATIONAL | |
| OPEN TO THE PUBLIC | |

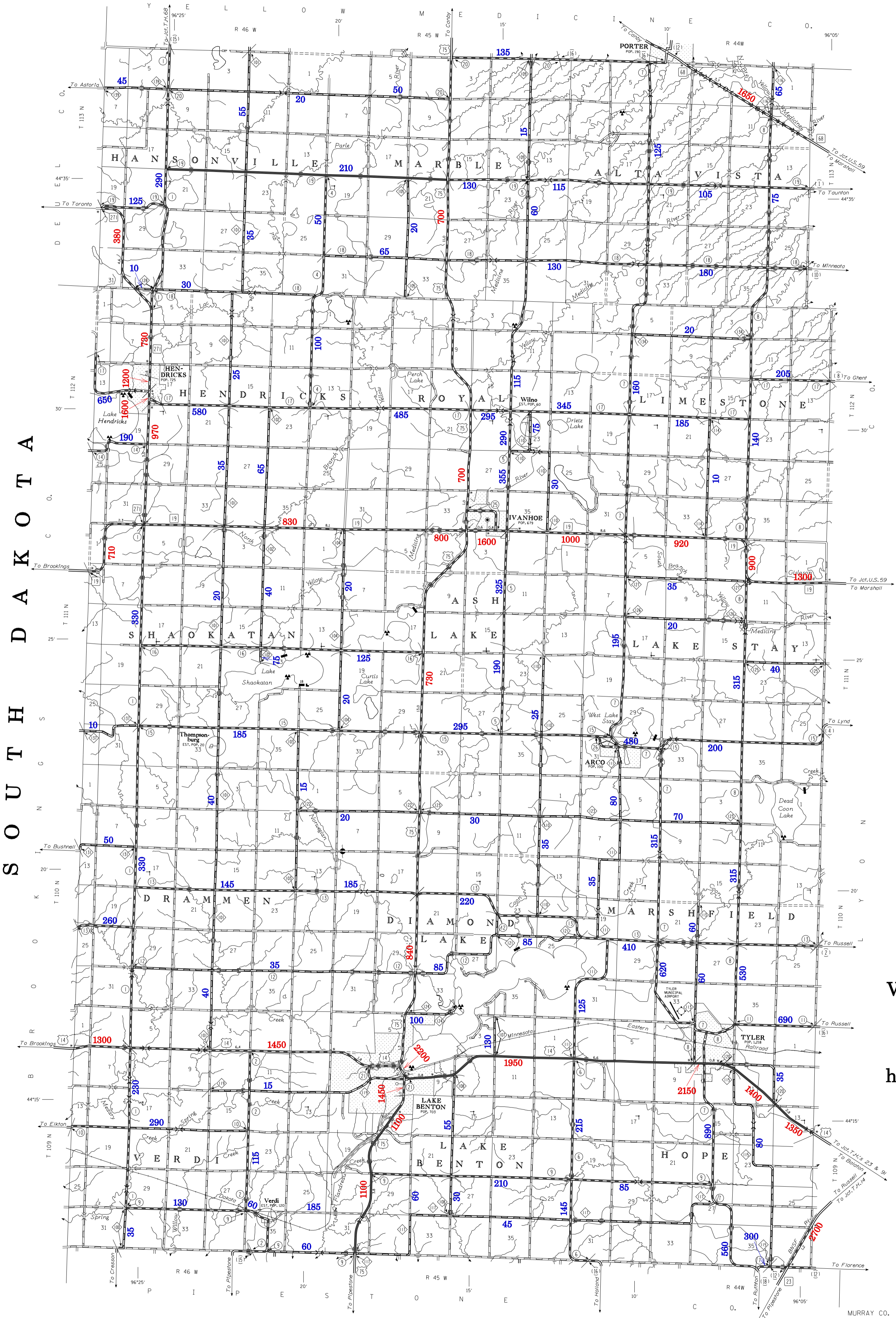

TRAFFIC VOLUMES ARE SUBJECT TO
VARIABILITY AND CONSTRUCTION EFFECTS

FOR MORE INFO VISIT:
<http://www.dot.state.mn.us/traffic/data/html/aadt.html>

VOLUMES PREPARED BY
THE OFFICE OF
TRANSPORTATION DATA & ANALYSIS

NUMERALS INDICATE AVERAGE DAILY
TRAFFIC VOLUMES ON DESIGNATED ROADS.

TRUNK HIGHWAY ROUTES ARE 2008 A.A.D.T. VOLUMES
COUNTY SYSTEM ROADS ARE 2008 A.A.D.T. VOLUMES

FOR DESIGNATED ROADS:
/ = SEGMENT ENDPOINT FOR ALL
ROADS INTERSECTED BY HATCH
(= SEGMENT ENDPOINT ONLY FOR
ROAD SEPARATED FROM INTERSECTING
ROAD BY ARC

*NOTE: ALL FEATURES EXCEPT TOWNSHIP ROADS AND
CULTURE ARE CURRENT AS OF JANUARY 1, 2008.
NOTE: FOR DETAIL OF COUNTY STATE AID HIGHWAYS AND COUNTY
ROADS IN INCORPORATED PLACES, SEE MAPS OF MUNICIPALITIES.

